

F.A.S. RTE.	SECTION	COUNTY	TOTAL SHEETS	SHEET NO.
574	07-00056-00-PV	MENARD	34	23
CONTRACT NO. 3477				
FED. ROAD DIST. NO. ILLINOIS FED. AID PROJECT				

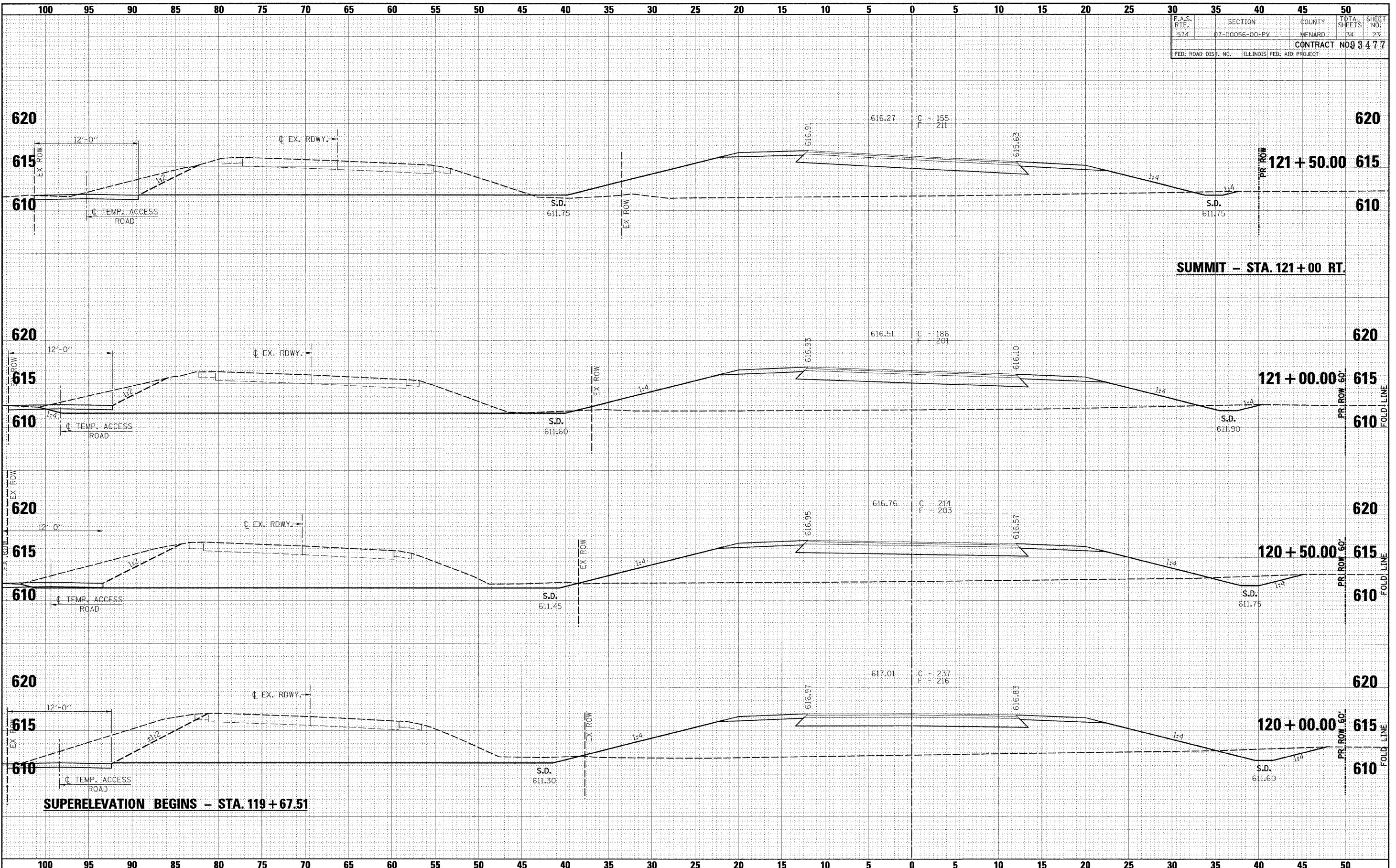

BY	DATE
FINAL SURVEY	
REVISIONS	
NOTE BOOK	
AREAS CHECKED	

BY	DATE
ORIGINAL SURVEY	
REVISIONS	
NOTE BOOK	
AREAS CHECKED	

FILE NAME -
#FILE#

USER NAME = #USER#
PLOT SCALE = #SCALE#
PLOT DATE = #DATE#

DESIGNED -
DRAWN -
CHECKED -
DATE -

REVISED -
REVISED -
REVISED -
REVISED -



Allen Henderson & Associates, Inc.
Civil and Structural Engineers Springfield, IL
62703 Phone: (217)544-8033 IL Design Firm
No. 184-001907

CROSS SECTIONS
SCALE: SHEET NO. OF SHEETS STA. 120+00.00 TO STA. 121+50.00

F.A.S. RTE.	SECTION	COUNTY	TOTAL SHEETS	SHEET NO.
574	07-00056-00-PV	MENARD	34	23
CONTRACT NO.				
FED. ROAD DIST. NO. ILLINOIS FED. AID PROJECT				