

F.A.S. RTE.	SECTION	COUNTY	TOTAL SHEETS	SHEET NO.
569	07-00110-01-SP	LOGAN	26	1
PROJECT NO. HRR-0569(106)		CONTRACT NO. 93479		
FED. ROAD DIST. NO. ...		ILLINOIS	FED. AID PROJECT	

STATE OF ILLINOIS
DEPARTMENT OF TRANSPORTATION
DIVISION OF HIGHWAYS
PROPOSED HIGHWAY PLANS
F.A.S. ROUTE 569 (FIFTH STREET ROAD)

HIGH RISK RURAL ROAD PROGRAM

SECTION 07-00110-01-SP
PROJECT NO. HRR-0569(106)
LOGAN COUNTY
JOB NO. C-96-238-08

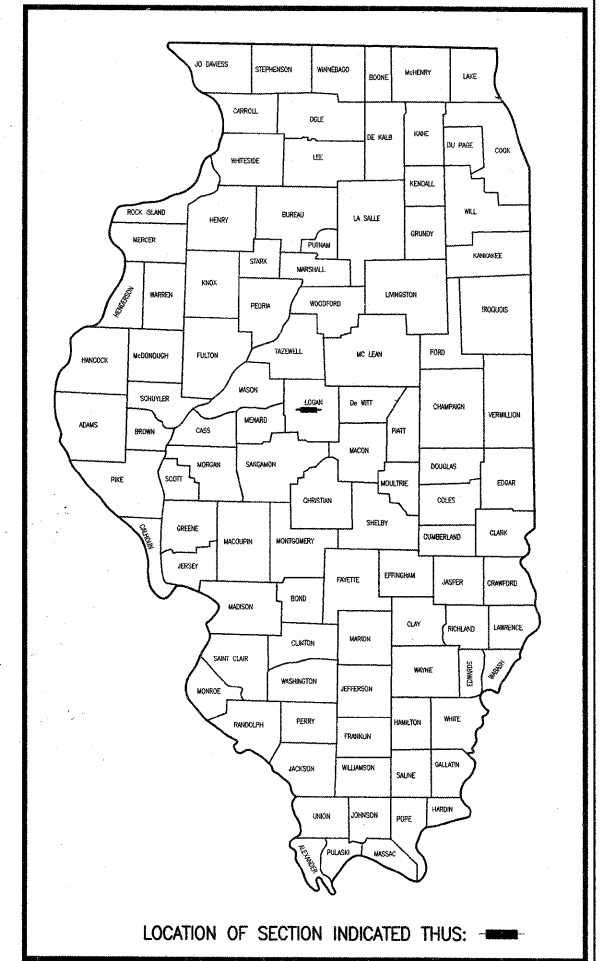

- INDEX OF SHEETS**
- 1 COVER SHEET
 - 2 SUMMARY OF QUANTITIES, TYPICAL SECTIONS & GENERAL NOTES
 - 3 SCHEDULE OF QUANTITIES
 - 4 GEOMETRIC CONTROL
 - 5-10 PLAN & PROFILE SHEETS
 - 11-15 DETAILS
 - 16-19 EROSION CONTROL
 - 20-26 CROSS SECTIONS

- HIGHWAY STANDARDS**
- 000001-05 STANDARD SYMBOLS, ABBREVIATIONS AND PATTERNS
 - 280001-04 TEMPORARY EROSION CONTROL SYSTEMS
 - 542301-02 PRECAST REINFORCED CONCRETE FLARED END SECTION
 - 542311-01 GRATING FOR CONCRETE FLARED END SECTION (FOR 24" THRU 54" PIPE)
 - 701001-02 OFF-RD OPERATIONS, 2L, 2W, MORE THAN 15' AWAY
 - 701006-03 OFF-RD OPERATIONS, 2L, 2W, 15' TO 24" FROM PAVEMENT EDGE
 - 701011-02 OFF-RD MOVING OPERATIONS, 2L, 2W, DAY ONLY
 - 701201-03 LANE CLOSURE, 2L, 2W, DAY ONLY, FOR SPEEDS ≥ 45 MPH
 - 701301-03 LANE CLOSURE, 2L, 2W, SHORT TIME OPERATIONS
 - 701306-02 LANE CLOSURE, 2L, 2W, SLOW MOVING OPERATIONS DAY ONLY FOR SPEEDS ≥ 45 MPH
 - 701311-03 LANE CLOSURE, 2L, 2W MOVING OPERATIONS-DAY ONLY
 - 701901-01 TRAFFIC CONTROL DEVICES
 - B.L.R. 21-8 TYPICAL APPLICATION OF TRAFFIC CONTROL DEVICES FOR CONSTRUCTION ON RURAL LOCAL HIGHWAYS



TOLL FREE
JOINT UTILITY LOCATING INFORMATION FOR EXCAVATORS
(J.U.L.I.E.) TELEPHONE NUMBER
1-800-892-0123

VERIZON NORTH, INC.
110 EAST MONROE STREET
P.O. BOX 2675
BLOOMINGTON, IL 61702
MARY RUTH WILLIS
(309) 827-1617

AMEREN/CILCO
KENT KOWALSKA
(309) 693-4839

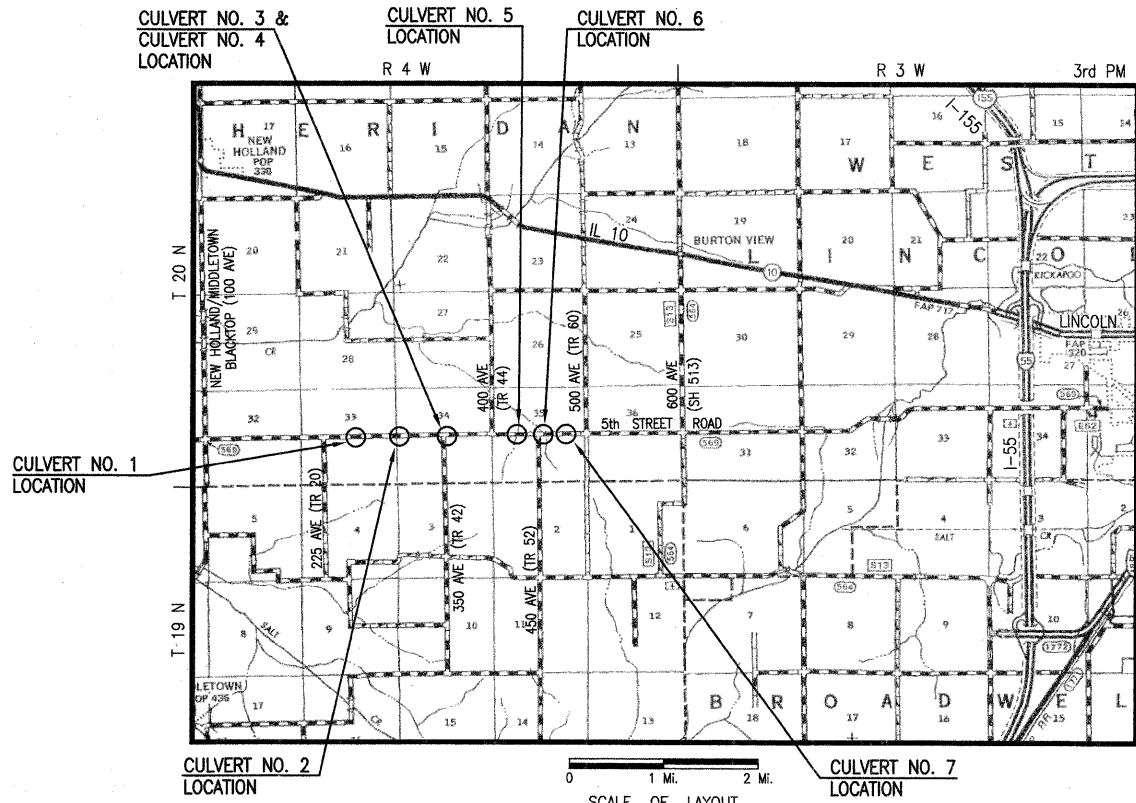

LENGTH OF PROJECT:

CULVERT NO. 1 =	200.00 ft = 0.038 mi
CULVERT NO. 2 =	300.00 ft = 0.057 mi
CULVERT NO. 3 & 4 =	600.00 ft = 0.114 mi
CULVERT NO. 5 =	300.00 ft = 0.057 mi
CULVERT NO. 6 =	160.70 ft = 0.030 mi
CULVERT NO. 7 =	300.00 ft = 0.057 mi

TOTAL LENGTH OF PROJECT = 1,860.70 ft = 0.352 mi

CONTRACT NO. 93479

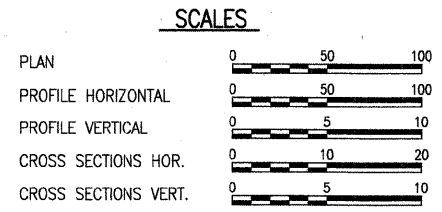

UTILITY NOTE

THE LOCATIONS OF THOSE BURIED AND ABOVEGROUND UTILITIES SHOWN ARE APPROXIMATE, ARE SHOWN FOR CONTRACTOR INFORMATIONAL USE ONLY, AND ARE NOT TO BE REFERENCED FOR CONSTRUCTION PURPOSES. THE IMPLIED PRESENCE OR ABSENCE OF UTILITIES IS NOT TO BE CONSTRUED BY THE OWNER, ENGINEER, CONTRACTOR, OR SUBCONTRACTORS TO BE AN ACCURATE AND COMPLETE REPRESENTATION OF UTILITIES THAT MAY OR MAY NOT EXIST ON THE CONSTRUCTION SITE. BURIED AND ABOVEGROUND UTILITY LOCATION, IDENTIFICATION, AND MARKING ARE THE SOLE RESPONSIBILITY OF THE CONTRACTOR. REROUTING, DISCONNECTION, PROTECTION, ETC. OF ANY UTILITIES MUST BE COORDINATED BETWEEN THE CONTRACTOR, UTILITY COMPANY, AND OWNER. SITE SAFETY, INCLUDING THE AVOIDANCE OF HAZARDS ASSOCIATED WITH BURIED AND ABOVEGROUND UTILITIES, REMAIN THE SOLE RESPONSIBILITY OF THE CONTRACTOR.

PHASE 1 CONSTRUCTION:
CULVERT REPLACEMENTS ACROSS EXISTING ROADWAY, VARIOUS LOCATIONS.

08-08-08

HANSON
Hanson Professional Services Inc.
1525 South Sixth Street, Springfield, IL 62703
Registration No. 184-001084
Phone: 217-788-2450 Fax: 217-788-2503
© Copyright Hanson Professional Services Inc. 2008

LISA D. KRAMER
LICENSED PROFESSIONAL ENGINEER
STATE OF ILLINOIS
062-052150

Lisa D. Kramer
DATE SIGNED: 8/8/08
LIC. EXP. DATE: 11/30/09

AGENCY RESPONSIBLE FOR LETTING

APPROVED: *B. A. Alby* 8/8 20 08
COUNTY ENGINEER

PASSED: *Tommy J. ...* FEB 3 20 09
DISTRICT 6 ENGINEER OF LOCAL ROADS & STREETS

PASSED: *Ken Dehaene* February 2, 20 09
DISTRICT 6 ENGINEER OF CONSTRUCTION

RELEASING FOR BID BASED ON LIMITED REVIEW
Roger J. ... FEB 3 20 09
DISTRICT 4 ENGINEER

STATE OF ILLINOIS
DEPARTMENT OF TRANSPORTATION
PRINTED BY THE AUTHORITY OF THE STATE OF ILLINOIS

LAYOUT 6/30/08
DRAWN 6/30/08
REVIEWED LDK 7/08/08
AUG 04, 2008 1:30 PM
\\072085\0710016\CADD\ROAD\SHEET\C-001\COV.DWG