

F.A.S. RTE.	SECTION	COUNTY	TOTAL SHEETS	SHEET NO.
569	07-00110-01-SP	LOGAN	26	19
PROJECT NO. HRR-0569(106)		CONTRACT NO. 93479		
FED. ROAD DIST. NO. -		ILLINOIS	FED. AID PROJECT	

**EROSION CONTROL NOTES**

THE FOLLOWING PLAN IS INCLUDED TO DIRECT THE CONTRACTOR IN THE PLACEMENT OF TEMPORARY EROSION CONTROL SYSTEMS.

PLACEMENT AND MAINTENANCE OF TEMPORARY EROSION CONTROL SYSTEMS WILL BE UTILIZED THROUGHOUT THE CONSTRUCTION WORK ZONE, AS SOON AS POSSIBLE TO STABILIZE EXPOSED SOILS AND PREVENT ON-SITE DAMAGE. THIS WORK MAY BE CONSTRUCTED OF HAY OR STRAW BALES, SILT FILTER FENCE, SEEDING, MULCH, OR OTHER APPROPRIATE METHODS AND MATERIALS, SEPARATELY OR IN COMBINATION, AS APPROVED, BY THE ENGINEER.

EROSION CONTROL DEVICES SHALL BE IN PLACE AND APPROVED BY THE ENGINEER AS TO PROPER PLACEMENT AND INSTALLATION PRIOR TO BEGINNING OTHER WORK.

THE CONTRACTOR SHALL PLACE PERMANENT SEEDING WITHIN A REASONABLE AMOUNT OF TIME. THE RESIDENT ENGINEER WILL DETERMINE WHEN TEMPORARY EROSION CONTROL SYSTEMS SHOWN IN THE PLAN CAN BE DELETED.

THE WORK SHALL BE COMPLETED IN ACCORDANCE WITH SECTION 280, TEMPORARY EROSION CONTROL, OF THE STANDARD SPECIFICATIONS FOR ROAD AND BRIDGE CONSTRUCTION.

THE CONTRACTOR SHALL PERFORM ALL WORK AS DIRECTED BY THE ENGINEER AND AS SHOWN IN STANDARD 280001.

TEMPORARY EROSION CONTROL SYSTEMS ARE NOTED IN THE EROSION CONTROL PLANS. THE PLAN MAY INCLUDE THE FOLLOWING:

- TEMPORARY DITCH CHECKS - ROLLED EXCELSIOR OR STRAW BALES
- PERIMETER EROSION BARRIER INLET AND PIPE PROTECTION
- TEMPORARY SEEDING AND MULCHING
- PERIMETER EROSION BARRIER TO BE INSTALLED ALONG THE CONSTRUCTION LIMITS.

**PRIOR TO CONSTRUCTION**

PRIOR TO PERFORMING CONSTRUCTION ACTIVITIES RESULTING IN LAND DISTURBANCE, THE CONTRACTOR SHALL INSTALL ITEMS (IF SPECIFIED ON THE PLANS OR AS DIRECTED BY THE ENGINEER) INTENDED TO PREVENT SEDIMENT FROM LEAVING THE CONSTRUCTION SITE. THE ITEMS MAY INCLUDE THE FOLLOWING TEMPORARY EROSION CONTROL SYSTEMS.

- TEMPORARY DITCH CHECKS
- INLET AND PIPE PROTECTION
- PERIMETER EROSION BARRIER

**DURING CONSTRUCTION**

DURING CONSTRUCTION, THE CONTRACTOR SHALL:

CLEAN UP AND GRADE THE WORK AREA TO ELIMINATE CONCENTRATION OF RUNOFF.

INSTALL TEMPORARY DITCH CHECKS AT LOCATIONS SPECIFIED IN THE PLANS OR AS DIRECTED BY THE RESIDENT ENGINEER.

INSTALL INLET PROTECTION AS SPECIFIED IN THE PLANS OR AS DIRECTED BY THE RESIDENT ENGINEER FOR CULVERTS AND INLETS AS THEY ARE INSTALLED AND AS WORK PROCEEDS.

COVER THE OPEN ENDS OF PIPES IN TRENCHES AT THE CLOSE OF EACH WORKING DAY.

MAINTAIN OR REPLACE (IF SPECIFIED BY THE RESIDENT ENGINEER) SEDIMENT CONTROL ITEMS.

THE TEMPORARY EROSION CONTROL SYSTEMS INSTALLED BY THE CONTRACTOR SHALL BE PROPERLY MAINTAINED AS DIRECTED BY THE ENGINEER TO CONTROL SILTATION AT ALL TIMES DURING THE LIFE OF THE CONTRACT. THIS WORK SHALL INCLUDE REPAIR OF THE VARIOUS SYSTEMS, REMOVAL OF TRAPPED SEDIMENT AND CLEANING OF ANY SILT FILTER FABRIC.

IF THE CONTRACTOR FAILS TO MAINTAIN THE TEMPORARY EROSION CONTROL SYSTEMS AS DIRECTED BY THE ENGINEER, THE ENGINEER MAY AT THE EXPIRATION OF A PERIOD OF 48 HOURS, AFTER HAVING GIVEN THE CONTRACTOR WRITTEN NOTICE, PROCEED TO MAINTAIN THE SYSTEMS AS DEEMED NECESSARY, AND THE COST THEREOF WILL BE DEDUCTED FROM ANY COMPENSATION DUE, OR WHICH MAY BECOME DUE TO THE CONTRACTOR UNDER THIS CONTRACT.

IF THE CONTRACTOR FAILS TO MAINTAIN THE TEMPORARY EROSION CONTROL SYSTEMS AS DIRECTED BY THE ENGINEER, THE ENGINEER MAY AT THE EXPIRATION OF A PERIOD OF 48 HOURS, AFTER HAVING GIVEN THE CONTRACTOR WRITTEN NOTICE, PROCEED TO MAINTAIN THE SYSTEMS AS DEEMED NECESSARY, AND THE COST THEREOF WILL BE DEDUCTED FROM ANY COMPENSATION DUE, OR WHICH MAY BECOME DUE TO THE CONTRACTOR UNDER THIS CONTRACT.

**PRIOR TO LANDSCAPING/RESTORATION**

IMMEDIATELY PRIOR TO LANDSCAPING/RESTORATION WORK, THE CONTRACTOR SHALL:

REMOVE AND DISPOSE OF SILT RETAINED BY THE TEMPORARY DITCH CHECKS, REINSTALL TEMPORARY DITCH CHECKS AFTER CLEANING, AND REMOVE AND REPLACE PLUGGED HAY OR STRAW BALES.

**FOLLOWING LANDSCAPING/RESTORATION**

AFTER LANDSCAPING/RESTORATION WORK, THE CONTRACTOR SHALL:

MAINTAIN OR REPLACE (IF SPECIFIED BY THE RESIDENT ENGINEER) SEDIMENT CONTROL ITEMS.

**VEGETATION ESTABLISHED**

AFTER THE VEGETATION IS ESTABLISHED IN THE DISTURBED AREAS, THE CONTRACTOR SHALL:

REMOVE THE REMAINING SEDIMENT CONTROL ITEMS (SEDIMENT BARRIERS, INLET PROTECTION, AND OTHER REMAINING ITEMS).

RESTORE THE AREAS DISTURBED BY THE SEDIMENT CONTROL ITEMS BY PERMANENT SEEDING AND MULCHING.

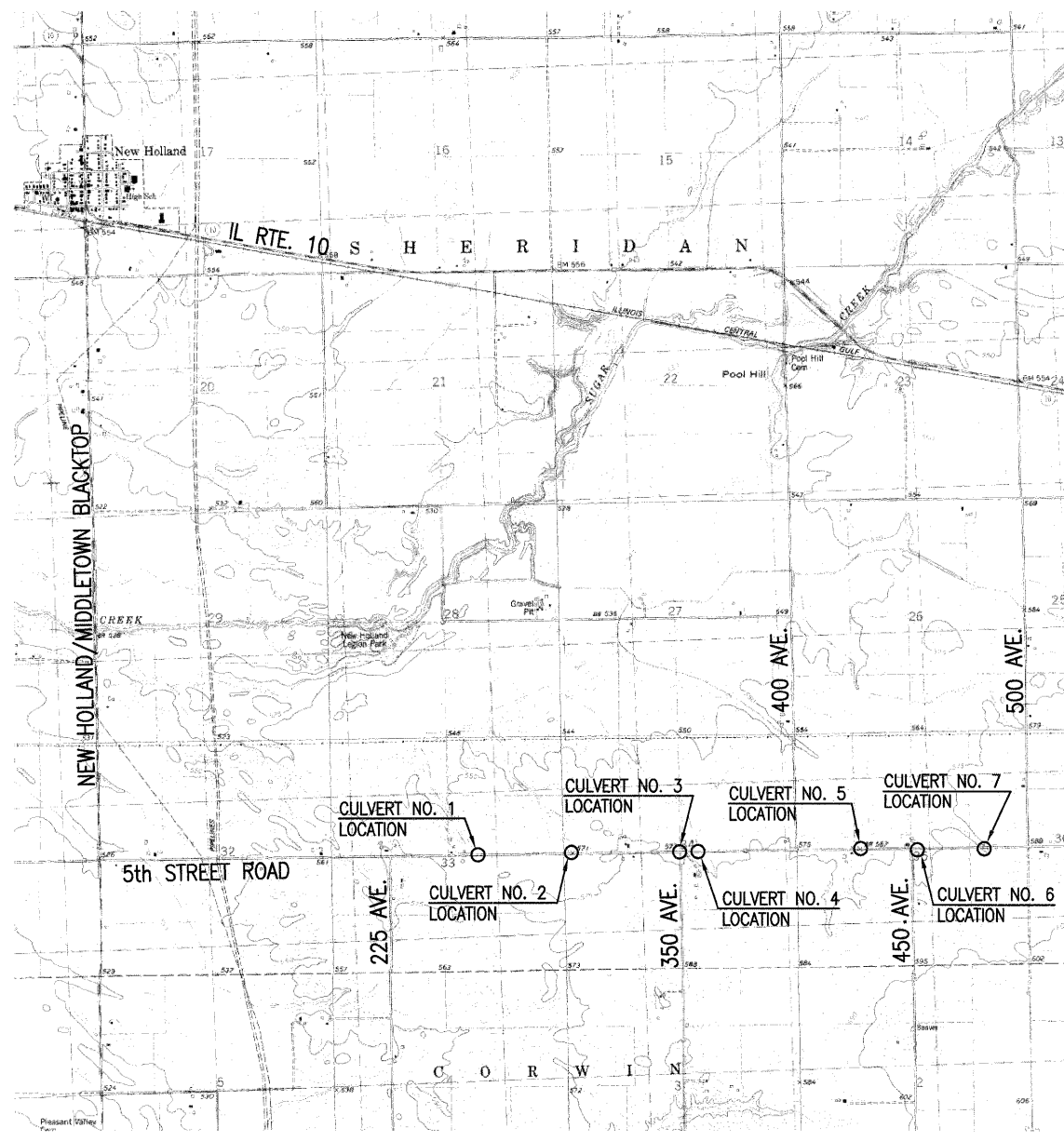

**DRAINAGE TRIBUTARY SKETCH**

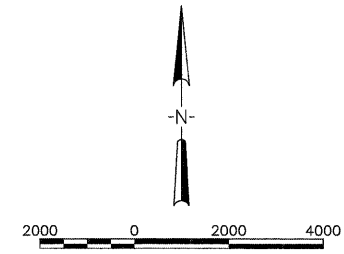

LAYOUT: 6/30/08  
 DRAWN: 7/30/08  
 REVIEWED: 7/29/08  
 AUG 06, 2008 11:15 AM  
 N:\07\0685\0710016\CADD\ROAD\SHEET\0-504ERO.DWG



DESIGNED	-	REVISED	-
DRAWN	-	REVISED	-
CHECKED	-	REVISED	-
DATE	08-08-08	REVISED	-

**STATE OF ILLINOIS  
DEPARTMENT OF TRANSPORTATION**

<b>EROSION CONTROL 5th STREET ROAD LOGAN COUNTY, ILLINOIS</b>	
SCALE: 1"=20'	TO STA.