

SECTION 31, T. 12 N., R. 5 W., 3rd P.M.

PLAN	SURVEYED	DATE
	ALLOTTED	
	NOTED	
	BY	
	CHECKED	
	BY	
	DATE	

PROFILE	SURVEYED	DATE
	ALLOTTED	
	NOTED	
	BY	
	CHECKED	
	BY	
	DATE	

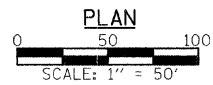
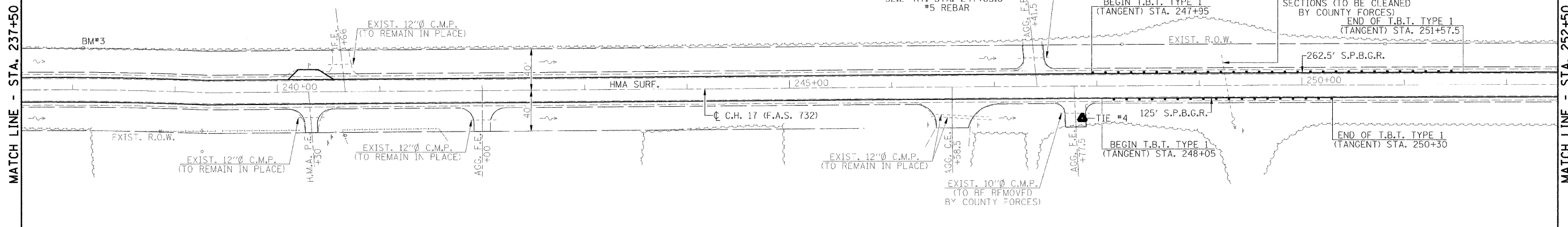

- UTILITIES**
- CONSOLIDATED COMMUNICATIONS
1-800-553-7611
 - AMEREN CIPS
1-888-789-2477
 - CHARTER COMMUNICATIONS
1-217-287-7992
 - ATMOS
1-888-824-3434
 - VILLAGE OF FARMERSVILLE
1-217-227-4169

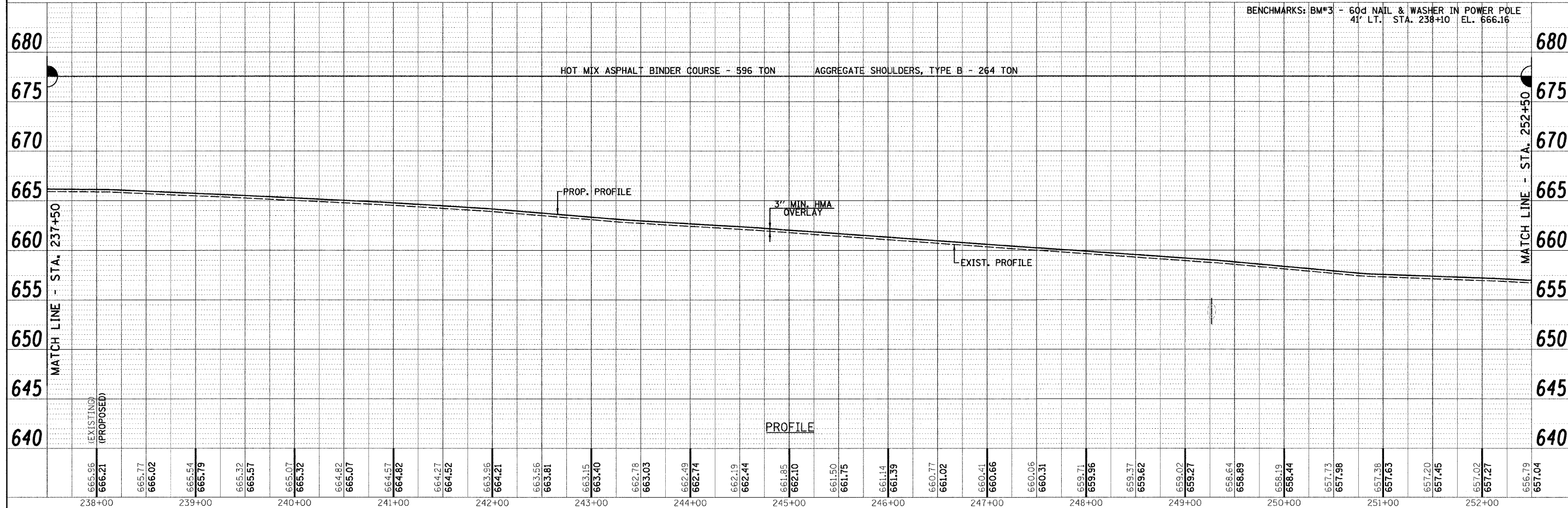

FILE NAME =	USER NAME = #USER*	DESIGNED -	REVISED -	<p>Allen Henderson & Associates, Inc. Civil and Structural Engineers Springfield, IL. 62703 Phone: (217)544-8033 IL Design Firm No. 184-001907</p>	<p>PLAN & PROFILE</p> <p>SCALE: 1" = 50' SHEET NO. OF SHEETS STA. 209+20 TO STA. 342+20</p>		F.A.S. RTE.	SECTION	COUNTY	TOTAL SHEETS	SHEET NO.
		DRAWN -	REVISED -				732	07-00125-02-RS	MONTGOMERY	57	11
		CHECKED -	REVISED -		CONTRACT NO. 93480						
		DATE -	REVISED -				FED. ROAD DIST. NO. ILLINOIS FED. AID PROJECT				

#FILEL4