

STATE OF ILLINOIS
 DEPARTMENT OF TRANSPORTATION
 DIVISION OF HIGHWAYS
 PLANS FOR PROPOSED
STU PROJECT

SECTION 07-00078-00-RS CITY OF OLNEY
 JOB NO. C-97-054-09
 PROJECT NO. M-5051(010)
 FAU 8494 EAST STREET

ROUTE	SECTION	CITY	TOTAL SHEETS	SHEET NO.
FAU 8494	07-00078-00-RS	OLNEY	9	1
CONTRACT NO. 95572		ILLINOIS		

INDEX OF SHEETS

SHEET	ITEM
1	COVER SHEET
2	TYPICAL SECTIONS / SUMMARY OF QUANTITIES
3-9	PLAN & PROFILE
	STANDARD 000001-05
	STANDARD 424001-05
	STANDARD 604061-02
	STANDARD 604086-02
	STANDARD 606001-04
	STANDARD 701006-03
	STANDARD 701301-03
	STANDARD 701501-05
	STANDARD 701801-04
	STANDARD 701901-01

PLAN 0' 20' 40'
 PROFILE HOR. 0' 20' 40'
 PROFILE VERT. 0' 5' 10'

Joint Utility Locating Information for Excavators
 JULIE 1-800-892-0123

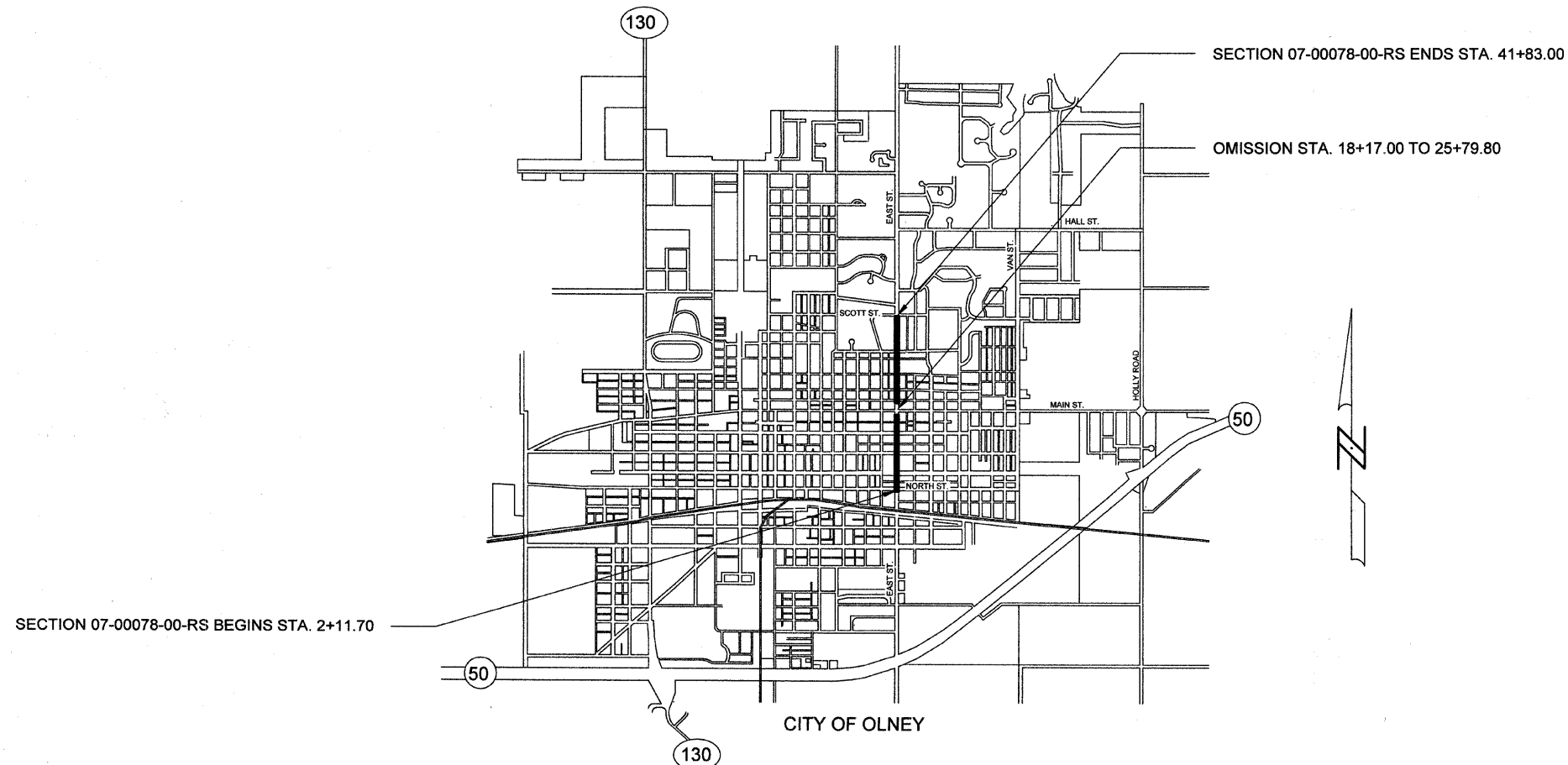
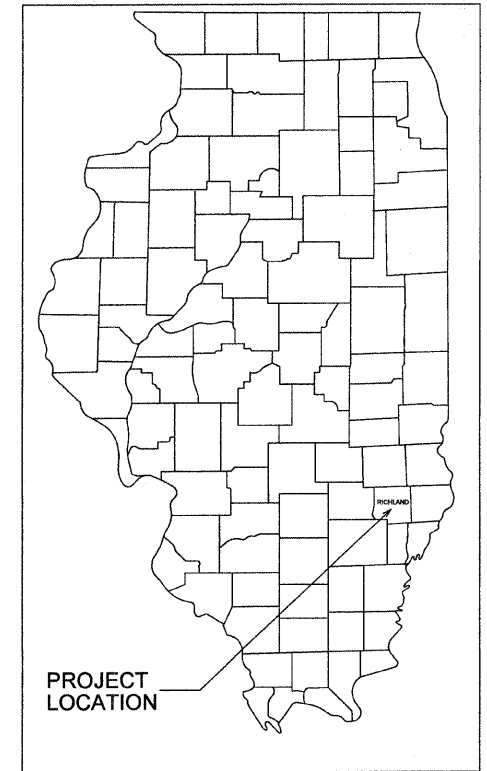

GROSS LENGTH SECTION 07-00078-00-RS = 3971.30 FEET = 0.752 MILE
 OMISSION STA. 18+17.00 TO 25+79.80 = 762.80 FEET = 0.144 MILE
 NET LENGTH SECTION 07-00078-00-RS = 3208.50 FEET = 0.608 MILE

CONTRACT NO. 95572
 URBAN MINOR ARTERIAL
 ADT = 7400
 DESIGN SPEED = 30 M.P.H.

Roger A. Charleston
 Ill. Reg. Prof. Eng. # 291
 2/12/09
 Lic. Expires 11/30/09

CHARLESTON ENGINEERING, INC.
 CONSULTING ENGINEERS
 105 NORTH KITCHELL
 P.O. BOX 397
 OLNEY, ILLINOIS 62450
 (618) 392-0736
 ILLINOIS DEPARTMENT OF PROFESSIONAL REGULATION REGISTRATION #184.003513

APPROVED *February 12th 2009*
Thomas P. Ellender
 MAYOR - CITY OF OLNEY

PASSED *2-19-20-09*
Maureen Kessel
 DISTRICT SEVEN ENGINEER OF
 LOCAL ROADS AND STREETS

Releasing For
 Bid Based on
 Limited Review

2-19-20-09
Roger A. Charleston
 DEPUTY DIRECTOR OF HIGHWAYS
 REGION FOUR ENGINEER

STATE OF ILLINOIS
 DEPARTMENT OF TRANSPORTATION

ROUTE	SECTION	CITY	TOTAL SHEETS	SHEET NO.
FAU 8494	07-00078-00-RS	OLNEY	9	2
CONTRACT NO. 95672		ILLINOIS		

SUMMARY OF QUANTITIES			
CODE NO.	ITEM	UNIT	QUANTITY
35101400	AGGREGATE BASE COURSE, TYPE B	TON	16
40600100	BITUMINOUS MATERIALS (PRIME COAT)	GALLON	1320
40600300	AGGREGATE (PRIME COAT)	TON	28
40600635	LEVELING BINDER (MACHINE METHOD), N70	TON	875
40600982	HOT-MIX ASPHALT SURFACE REMOVAL - BUTT JOINT	SQ YD	492
40600990	TEMPORARY RAMP	SQ YD	492
40603340	HOT-MIX ASPHALT SURFACE COURSE, MIX "D", N70	TON	1110
42400100	PORTLAND CEMENT CONCRETE SIDEWALK 4 INCH	SQ FT	1751
42400800	DETECTABLE WARNINGS	SQ FT	269
44000157	HOT-MIX ASPHALT SURFACE REMOVAL, 2"	SQ YD	12935
44000500	COMBINATION CURB AND GUTTER REMOVAL	FOOT	286
44000600	SIDEWALK REMOVAL	SQ FT	1311
60255500	MANHOLES TO BE ADJUSTED	EACH	18
60266600	VALVE BOXES TO BE ADJUSTED	EACH	14
60402610	GRATES, TYPE 12	EACH	2
60404940	FRAMES AND GRATES, TYPE 23	EACH	5
60405740	FRAMES AND GRATES TO BE REMOVED	EACH	7
60604400	COMBINATION CONCRETE CURB AND GUTTER, TYPE B-6.18	FOOT	286
67100100	MOBILIZATION	L SUM	1
70102620	TRAFFIC CONTROL AND PROTECTION, STANDARD 701501	L SUM	1
70102640	TRAFFIC CONTROL AND PROTECTION, STANDARD 701801	L SUM	1
70103700	TRAFFIC CONTROL COMPLETE	L SUM	1

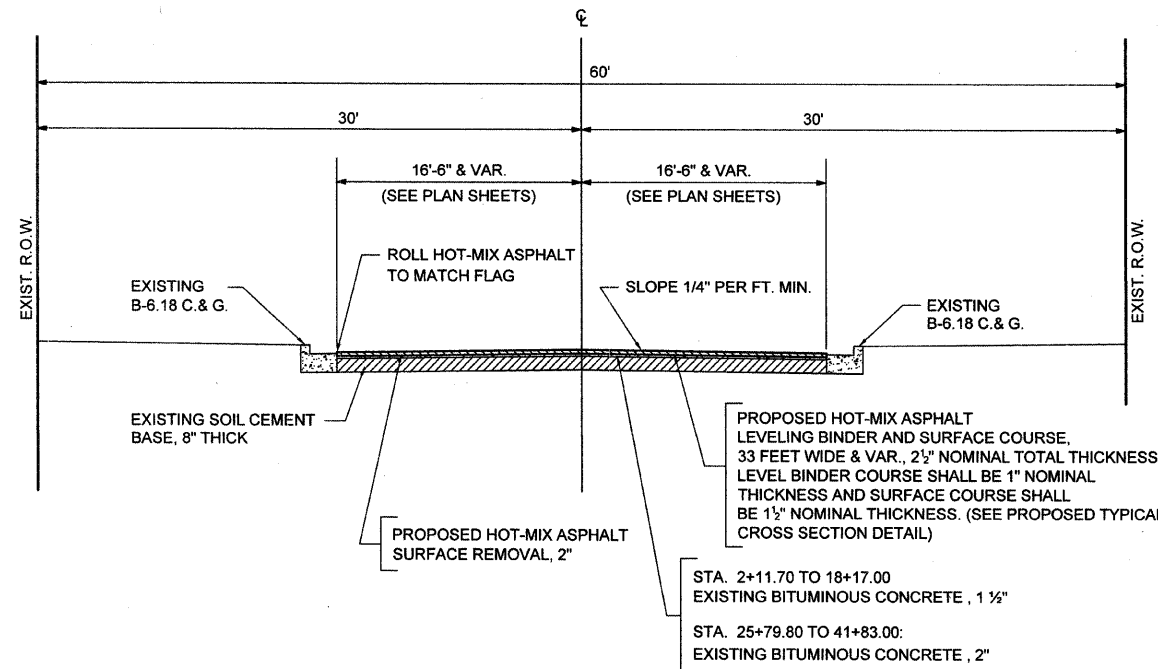

PROPOSED TYPICAL CROSS SECTION

STA. 2+11.70 TO 18+17.00
STA. 25+79.80 TO 41+83.00

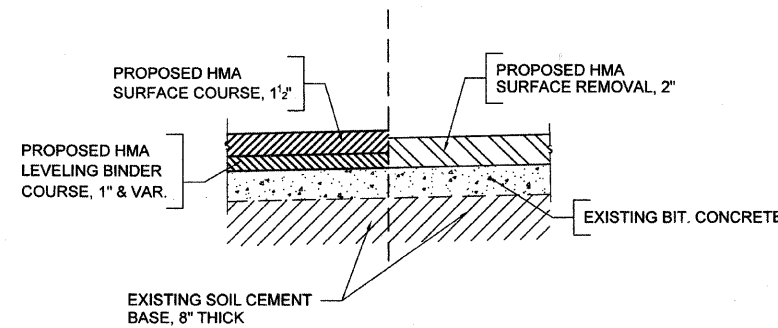

TYPICAL CROSS SECTION DETAIL

STA. 2+11.70 TO 18+17.00
STA. 25+79.80 TO 41+83.00

HOT-MIX ASPHALT

HOT-MIX ASPHALT SURFACE COURSE, MIXTURE "D" N70
PG GRADE: PG 70-22
DESIGN AIR VOIDS: 4.0% @ Ndesign 70
MIXTURE COMPOSITION: IL-9.5
FRICTION AGGREGATE: MIXTURE D

LEVELING BINDER (MACHINE METHOD) N70
PG GRADE: PG 70-22
DESIGN AIR VOIDS: 4.0% @ Ndesign 70
MIXTURE COMPOSITION: IL-9.5
FRICTION AGGREGATE: N/A

PAVEMENT DESIGN DATA

STA. 2+11.70 TO 18+17.00
ADT = 4800 CLASS II
P = 4535
SU = 225
MU = 40
URBAN MINOR ARTERIAL
PAVEMENT TYPE: BIT. CONC. PAVEMENT, 2 1/2"

PAVEMENT DESIGN DATA

STA. 25+79.80 TO 41+83.00
ADT = 7400 CLASS II
P = 6680
SU = 650
MU = 70
URBAN MINOR ARTERIAL
PAVEMENT TYPE: BIT. CONC. PAVEMENT, 2 1/2"

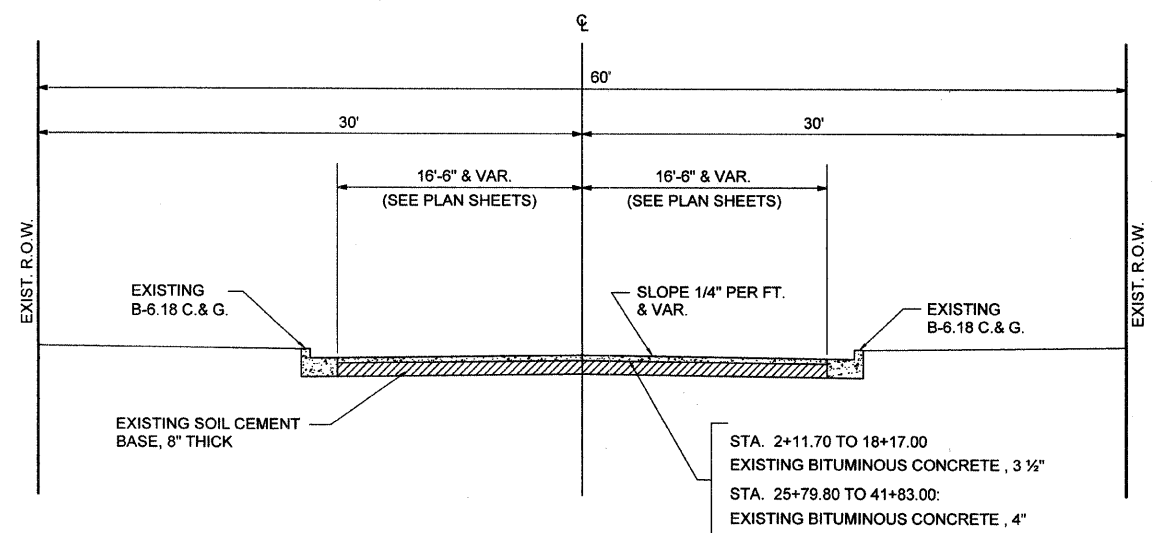

EXISTING TYPICAL CROSS SECTION

STA. 2+11.70 TO 18+17.00
STA. 25+79.80 TO 41+83.00

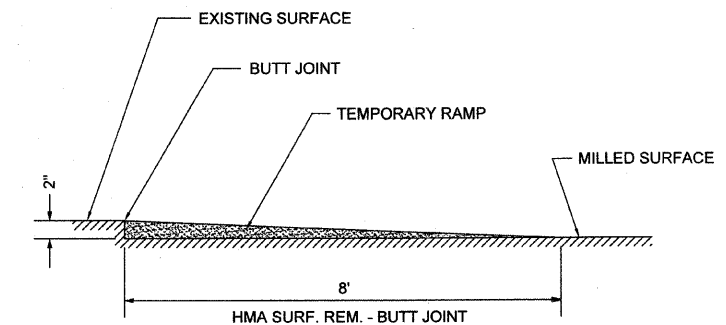

BUTT JOINT / TEMPORARY RAMP DETAIL

STA. 2+11.70 TO 18+17.00
STA. 25+79.80 TO 41+83.00

CHARLESTON ENGINEERING, INC.

CONSULTING ENGINEERS

105 NORTH KITCHELL
P.O. BOX 397
OLNEY, ILLINOIS 62450
(618) 392-0736

ILLINOIS DEPARTMENT OF PROFESSIONAL REGULATION REGISTRATION #184.003513

ROUTE	SECTION	CITY	TOTAL SHEETS	SHEET NO.
FAU 8494	07-00078-00-RS	OLNEY	9	3
CONTRACT NO. 95572		ILLINOIS		

STATION	CURB TYPE	STATION	CURB TYPE
RT. 2+10	B SINGLE	RT. 25+17	B SINGLE
LT. 2+29	B SINGLE	RT. 25+70	A DOUBLE
LT. 2+66	A DOUBLE	RT. 28+92	A DOUBLE
RT. 2+80	B SINGLE	LT. 28+96	A DOUBLE
RT. 6+84	B SINGLE	LT. 29+34	B DOUBLE
LT. 10+85	A DOUBLE	RT. 29+38	A DOUBLE
RT. 10+87	A DOUBLE	RT. 31+94	B SINGLE
RT. 15+52	A DOUBLE	RT. 32+30	B SINGLE

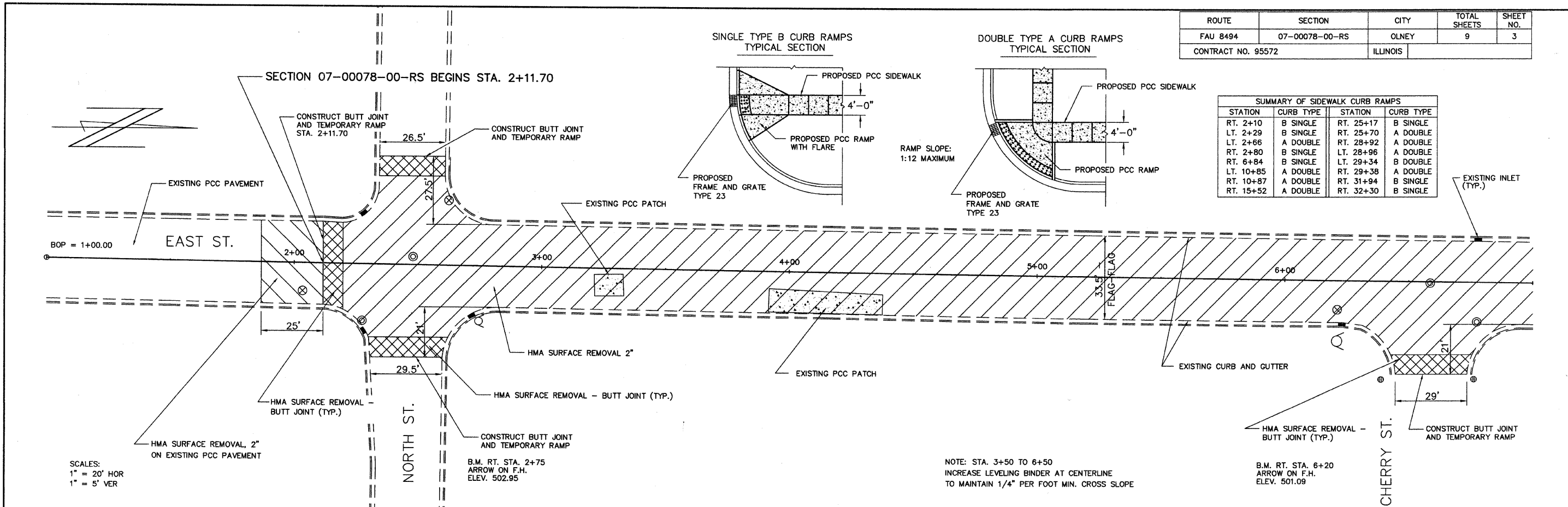

SCALES:
1" = 20' HOR
1" = 5' VER

NOTE: STA. 3+50 TO 6+50
INCREASE LEVELING BINDER AT CENTERLINE
TO MAINTAIN 1/4" PER FOOT MIN. CROSS SLOPE

B.M. RT. STA. 6+20
ARROW ON F.H.
ELEV. 501.09

515	HMA SURFACE REMOVAL, 2"	SQ YD	LEVELING BINDER (MACH. METHOD), N70	TON		DETECTABLE WARNINGS	SQ FT	515						
	STA. 2+11.70 TO 7+00	2075	STA. 2+11.70 TO 7+00	145		RT. STA. 2+11 LT. STA. 2+29 LT. STA. 2+66 RT. STA. 2+80 RT. STA. 6+84	8 8 33 8 8							
510	HMA SURFACE REMOVAL, BUTT JOINT	SQ YD	HMA SURFACE COURSE, MIX "D", N70	TON		COMBINATION CONCRETE CURB & GUTTER, TYPE B-6.18	FOOT	510						
	STA. 2+11.70 LT. & RT. STA. 2+47 RT. STA. 6+59	31 51 27	STA. 2+11.70 TO 7+00	180		RT. STA. 2+11 LT. STA. 2+29 LT. STA. 2+66 RT. STA. 2+80 RT. STA. 6+84	16 16 23 16 16	TOTAL 65						
505		TOTAL 109	VALVE BOXES TO BE ADJUSTED	EACH		FRAME AND GRATE, TYPE 23	EACH	505						
			STA. 2+11.70 TO 7+00	2		LT. STA. 2+29	1							
500						EXISTING PROFILE		500						
495	TEMPORARY RAMP	SQ YD	MANHOLES TO BE ADJUSTED	EACH		SIDEWALK REMOVAL	SQ FT	495						
	STA. 2+11.70 LT. & RT. STA. 2+47 RT. STA. 6+59	31 51 27	STA. 2+11.70 TO 7+00	4		RT. STA. 2+11 LT. STA. 2+29 LT. STA. 2+66 RT. STA. 2+80 RT. STA. 6+84	16 48 106 48 48							
490		TOTAL 109	AGGREGATE BASE COURSE, TYPE B	TON			TOTAL 266	490						
			STA. 2+11.70 TO 7+00	5		PCC SIDEWALK 4 INCH	SQ FT							
485	BIT. MATERIALS (PRIME COAT)	GALLON	COMB. CURB AND GUTTER REMOVAL	FOOT				485						
	STA. 2+11.70 TO 7+00	210	RT. STA. 2+11 LT. STA. 2+29 LT. STA. 2+66 RT. STA. 2+80 RT. STA. 6+84	16 16 23 16 16		RT. STA. 2+11 LT. STA. 2+29 LT. STA. 2+66 RT. STA. 2+80 RT. STA. 6+84	36 108 106 108 108							
480	AGGREGATE (PRIME COAT)	TON					TOTAL 466	480						
	STA. 2+11.70 TO 7+00	4.5	TOTAL 87											
475								475						
470	500.0	500.7	500.6	500.9	500.6	500.2	499.8	499.6	499.4	499.1	498.7	498.2	497.3	470
	1+00	2+00	3+00	4+00	5+00	6+00	7+00							

ROUTE	SECTION	CITY	TOTAL SHEETS	SHEET NO.
FAU 8494	07-00078-00-RS	OLNEY	9	4
CONTRACT NO. 95572		ILLINOIS		

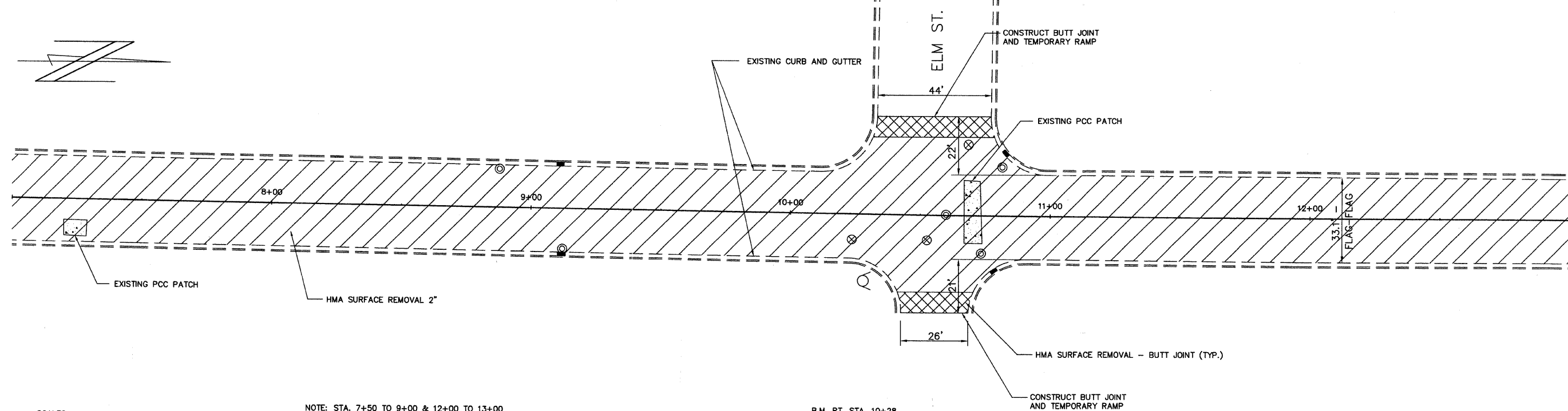

SCALES:
 1" = 20' HOR
 1" = 5' VER

NOTE: STA. 7+50 TO 9+00 & 12+00 TO 13+00
 INCREASE LEVELING BINDER AT CENTERLINE
 TO MAINTAIN 1/4" PER FOOT MIN. CROSS SLOPE

B.M. RT. STA. 10+28
 ARROW ON F.H.
 ELEV. 499.91

515	HMA SURFACE REMOVAL, 2"	SQ YD	HMA SURFACE COURSE, MIX "D", N70	TON	COMBINATION CONCRETE CURB & GUTTER, TYPE B-6.18	FOOT	DETECTABLE WARNINGS	SQ FT	515				
	STA. 7+00 TO 13+00	2355	STA. 7+00 TO 13+00	205	LT. STA. 10+85 RT. STA. 10+87	19 16	LT. STA. 10+85 RT. STA. 10+87	22 17					
510	HMA SURFACE REMOVAL, BUTT JOINT	SQ YD	VALVE BOXES TO BE ADJUSTED	EACH	TOTAL	35	TOTAL	39	510				
	LT. & RT. STA. 10+55	64	STA. 7+00 TO 13+00	3									
505	TEMPORARY RAMP	SQ YD	MANHOLES TO BE ADJUSTED	EACH	SIDEWALK REMOVAL	SQ FT	FRAME AND GRATE, TYPE 23	EACH	505				
	LT. & RT. STA. 10+55	64	STA. 7+00 TO 13+00	5	LT. STA. 10+85 RT. STA. 10+87	93 91	LT. STA. 10+85 RT. STA. 10+87	1 1					
500			EXISTING PROFILE		TOTAL	184	TOTAL	2	500				
495									495				
490	BIT. MATERIALS (PRIME COAT)	GALLON	AGGREGATE BASE COURSE, TYPE B	TON	PCC SIDEWALK 4 INCH	SQ FT			490				
	STA. 7+00 TO 13+00	245	STA. 7+00 TO 13+00	2	LT. STA. 10+85 RT. STA. 10+87	93 91							
485	AGGREGATE (PRIME COAT)	TON	COMB. CURB AND GUTTER REMOVAL	FOOT	TOTAL	184			485				
	STA. 7+00 TO 13+00	5	LT. STA. 10+85 RT. STA. 10+87										
480	LEVELING BINDER (MACH. METHOD), N70	TON		TOTAL					480				
	STA. 7+00 TO 13+00	165		35									
475									475				
470	497.3	496.7	496.2	495.9	495.5	495.7	496.6	497.0	497.1	497.4	497.5	497.5	470
	7+00		8+00		9+00		10+00		11+00		12+00		13+00

ROUTE	SECTION	CITY	TOTAL SHEETS	SHEET NO.
FAU 8494	07-00078-00-RS	OLNEY	9	5
CONTRACT NO. 95572		ILLINOIS		

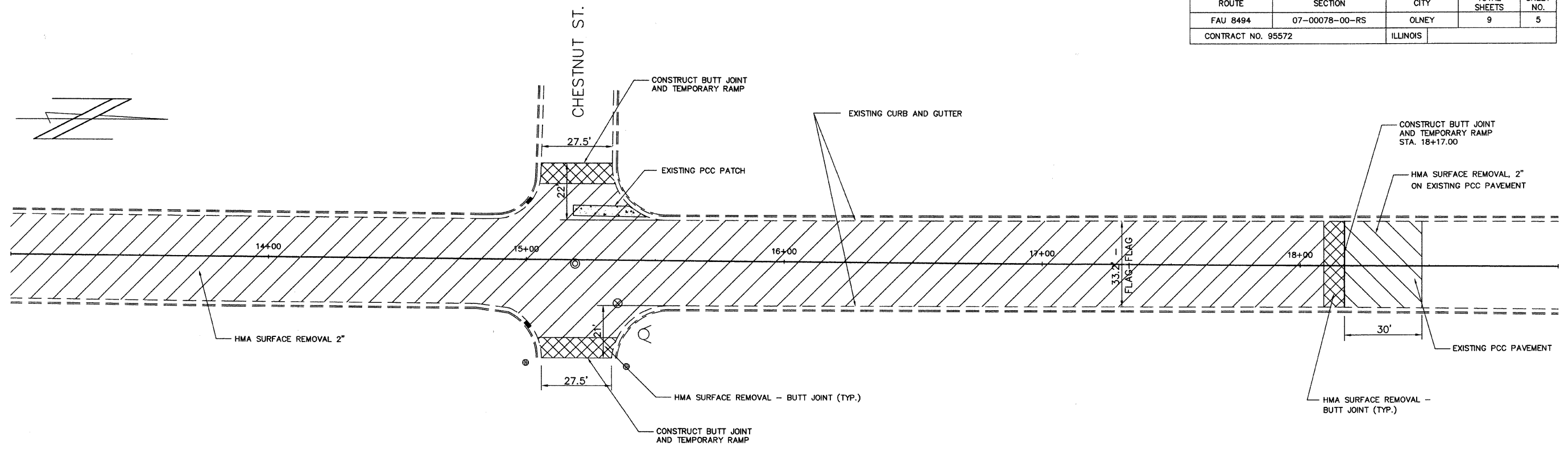

SCALES:
 1" = 20' HOR
 1" = 5' VER

B.M. RT. STA. 15+45
 ARROW ON F.H.
 ELEV. 498.81

NOTE: STA. 16+00 TO 18+17
 INCREASE LEVELING BINDER AT CENTERLINE
 TO MAINTAIN 1/4" PER FOOT MIN. CROSS SLOPE

515		HMA SURFACE REMOVAL, 2"	SQ YD		LEVELING BINDER (MACH. METHOD), N70	TON		COMBINATION CONCRETE CURB & GUTTER, TYPE B-6.18	FOOT	515				
		STA. 13+00 TO 19+00	2105		STA. 13+00 TO 19+00	125		RT. STA. 15+52	20					
510		HMA SURFACE REMOVAL, BUTT JOINT	SQ YD		HMA SURFACE COURSE, MIX "D", N70	TON		SIDEWALK REMOVAL	SQ FT	510				
		LT. & RT. STA. 15+20 STA. 18+17	51 30 81		STA. 13+00 TO 19+00	175		RT. STA. 15+52	121					
		TOTAL	81											
505					VALVE BOXES TO BE ADJUSTED	EACH		PCC SIDEWALK 4 INCH	SQ FT	505				
					STA. 13+00 TO 19+00	1		RT. STA. 15+52	121					
500		EXISTING PROFILE								500				
495										495				
490		TEMPORARY RAMP	SQ YD		MANHOLES TO BE ADJUSTED	EACH		DETECTABLE WARNINGS	SQ FT	490				
		LT. & RT. STA. 15+20 STA. 18+17	51 30 81		STA. 13+00 TO 19+00	1		RT. STA. 15+52	29					
		TOTAL	81											
485		BIT. MATERIALS (PRIME COAT)	GALLON		AGGREGATE BASE COURSE, TYPE B	TON				485				
		STA. 13+00 TO 19+00	210		STA. 13+00 TO 19+00	1								
480		AGGREGATE (PRIME COAT)	TON		COMB. CURB AND GUTTER REMOVAL	FOOT				480				
		STA. 13+00 TO 19+00	4.5		RT. STA. 15+52	20								
475										475				
470	497.5	497.3	497.1	496.9	496.7	496.5	496.3	496.0	495.8	495.6	495.5	494.9	494.1	470
	13+00		14+00		15+00		16+00		17+00		18+00		19+00	

ROUTE	SECTION	CITY	TOTAL SHEETS	SHEET NO.
FAU 8494	07-00078-00-RS	OLNEY	9	6
CONTRACT NO. 95572		ILLINOIS		

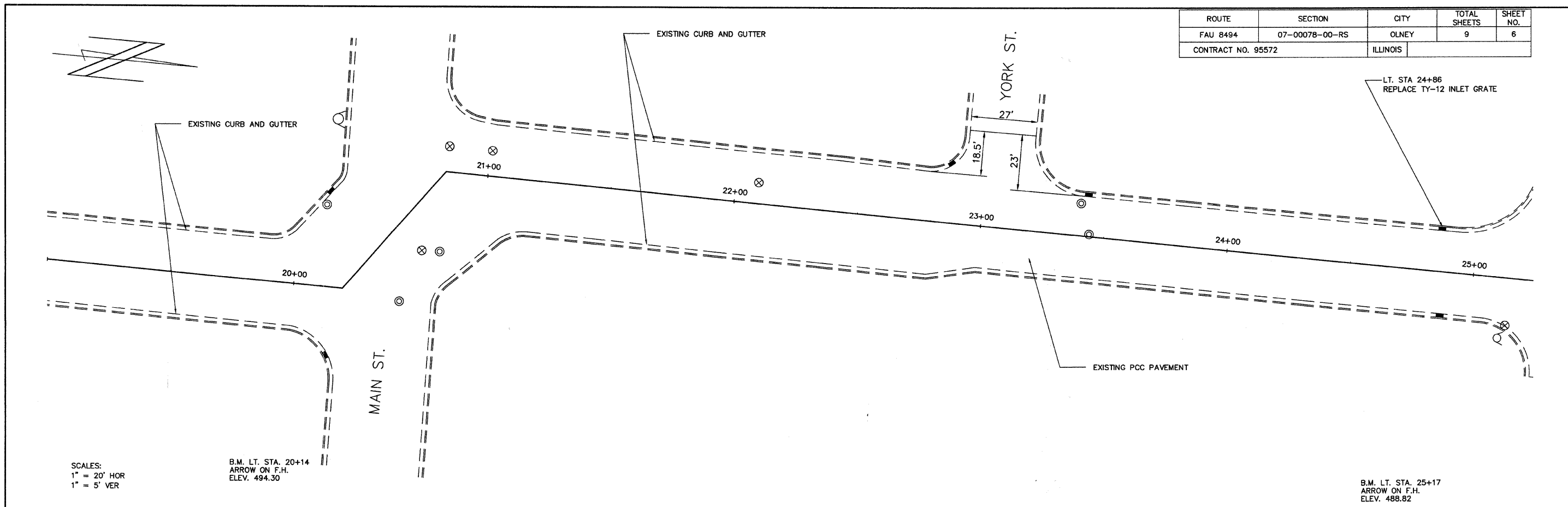

SCALES:
 1" = 20' HOR
 1" = 5' VER

B.M. LT. STA. 20+14
 ARROW ON F.H.
 ELEV. 494.30

B.M. LT. STA. 25+17
 ARROW ON F.H.
 ELEV. 488.82

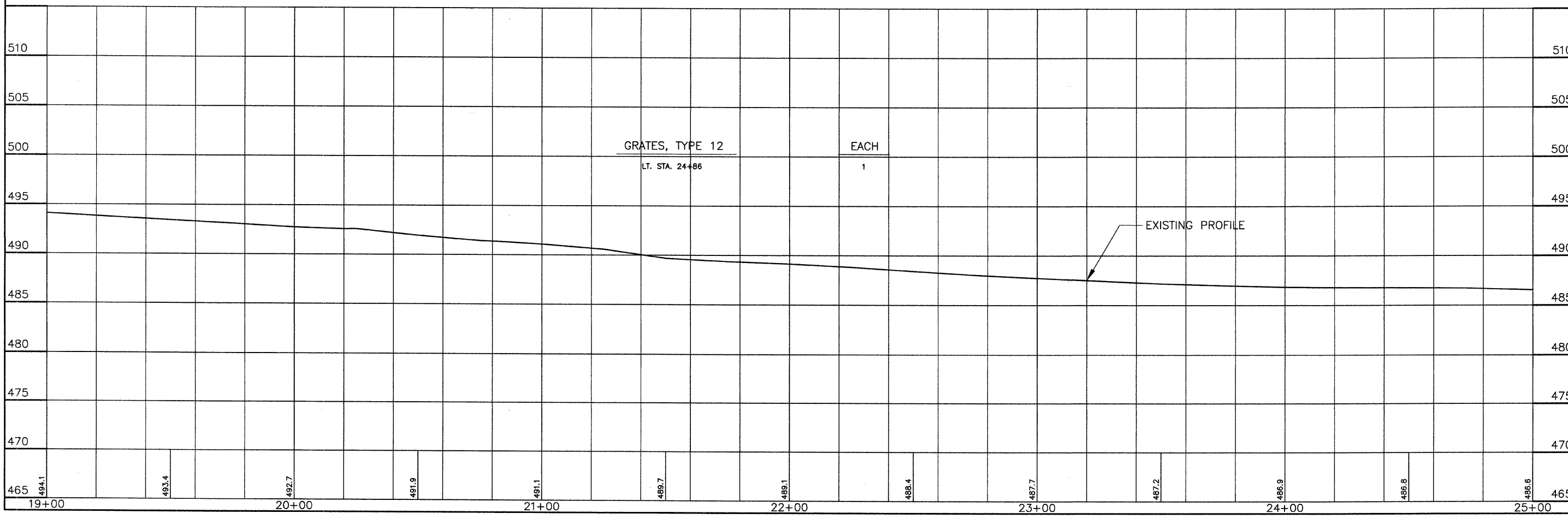

ROUTE	SECTION	CITY	TOTAL SHEETS	SHEET NO.
FAU 8494	07-00078-00-RS	OLNEY	9	9
CONTRACT NO. 95572		ILLINOIS		

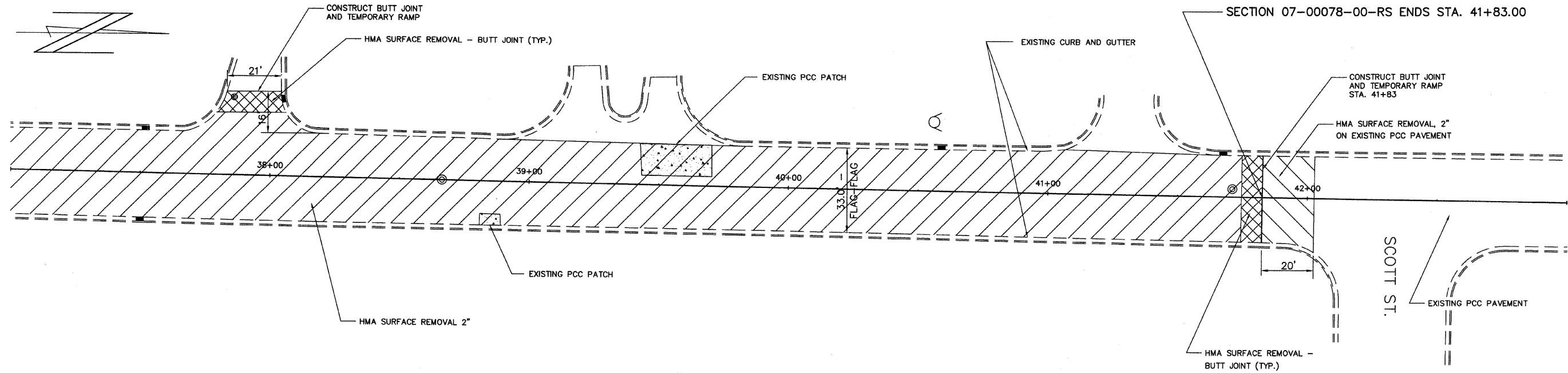

SCALES:
1" = 20' HOR
1" = 5' VER

NOTE: STA. 37+00 TO 41+83
INCREASE LEVELING BINDER AT CENTERLINE
TO MAINTAIN 1/4" PER FOOT MIN. CROSS SLOPE

B.M. LT. STA. 40+52
ARROW ON F.H.
ELEV. 481.80

495		HMA SURFACE REMOVAL, 2"	SQ YD		BIT. MATERIALS (PRIME COAT)	GALLON		495						
		STA. 37+00 TO 41+83.00	1860		STA. 37+00 TO 41+83.00	185								
490					AGGREGATE (PRIME COAT)	TON		490						
					STA. 37+00 TO 41+83.00	4								
485		EXISTING PROFILE			LEVELING BINDER (MACH. METHOD), N70	TON		485						
					STA. 37+00 TO 41+83.00	150								
480								480						
475		HMA SURFACE REMOVAL, BUTT JOINT	SQ YD					475						
		LT. STA. 37+92 STA. 41+83	21 30											
		TOTAL	51											
470					HMA SURFACE COURSE, MIX "D", N70	TON		470						
					STA. 37+00 TO 41+83.00	155								
465		TEMPORARY RAMP	SQ YD		MANHOLES TO BE ADJUSTED	EACH		465						
		LT. STA. 37+92 STA. 41+83	21 30		STA. 37+00 TO 41+83.00	2								
		TOTAL	51											
460								460						
455								455						
450	484.5	483.9	483.2	482.7	481.8	481.0	480.0	479.0	478.1	477.1	476.1	475.4	474.6	450
	37+00	38+00	39+00	40+00	41+00	42+00	43+00							