

ROUTE NO.	SECTION	COUNTY	TOTAL SHEETS	SHEET NO.
FAS 824	05-00183-00-BR	JEFFERSON	23	1
FED. ROAD DIST. NO.		ILLINOIS CONTRACT NO. 99361		

STATE OF ILLINOIS
DEPARTMENT OF TRANSPORTATION
DIVISION OF HIGHWAYS

**PLANS FOR PROPOSED
HIGHWAY BRIDGE PROGRAM**

INDEX OF SHEETS

SHEET NO.	DESCRIPTION
1.	COVER SHEET
2.	SUMMARY OF QUANTITIES AND GENERAL NOTES
3.	SCHEDULE OF QUANTITIES
4.-5.	TYPICAL SECTIONS AND MISC. DETAILS
6.	PLAN AND PROFILE
7.	PAVEMENT MARKING SHEET
8.-15.	STATION CROSS SECTIONS
16.-22.	BRIDGE PLANS
23.	BORINGS

HIGHWAY STANDARDS

000001-05	STANDARD SYMBOLS, ABBREVIATIONS, AND PATTERNS
515001-03	NAME PLATE FOR BRIDGES
542301-02	PRECAST REINFORCED CONCRETE FLARED END SECTION
630001-08	STEEL PLATE BEAM GUARDRAIL
630301-05	SHOULDER WIDENING FOR TYPE 1, (SPECIAL) GUARDRAIL TERMINALS
635006-03	REFLECTOR AND TERMINAL MARKER PLACEMENT
635011-02	REFLECTOR MARKER AND MOUNTING DETAILS
701901-01	TRAFFIC CONTROL DEVICES
BLR 21-8	TYPICAL APPLICATION OF TRAFFIC CONTROL; DEVICES FOR CONSTRUCTION ON RURAL LOCAL HIGHWAYS
BLR 27-1	TRAFFIC BARRIER TERMINAL TYPE 5A

UTILITIES

ELECTRIC:

TRI-COUNTY ELECTRIC COOPERATIVE
P.O. BOX 309
MT. VERNON, IL 62864
ATTN: SUE ECHOLS
618-224-5151

TELEPHONE:

FRONTIER COMMUNICATIONS
300 LONE OAK ROAD
PADUCAH, KY 42001

WATER:

REND LAKE INTERCITY WATER SYSTEM
PO BOX 907
BENTON, IL 62812
ATTN: ARNOLD EGGLESTON

PROJECT BRS-824(104)
SECTION 05-00183-00-BR
JEFFERSON COUNTY
FAS 824 / C.H. 42 / SPRING GARDEN ROAD
PROPOSED STRUCTURE 041-3743
JOB C-99-573-06

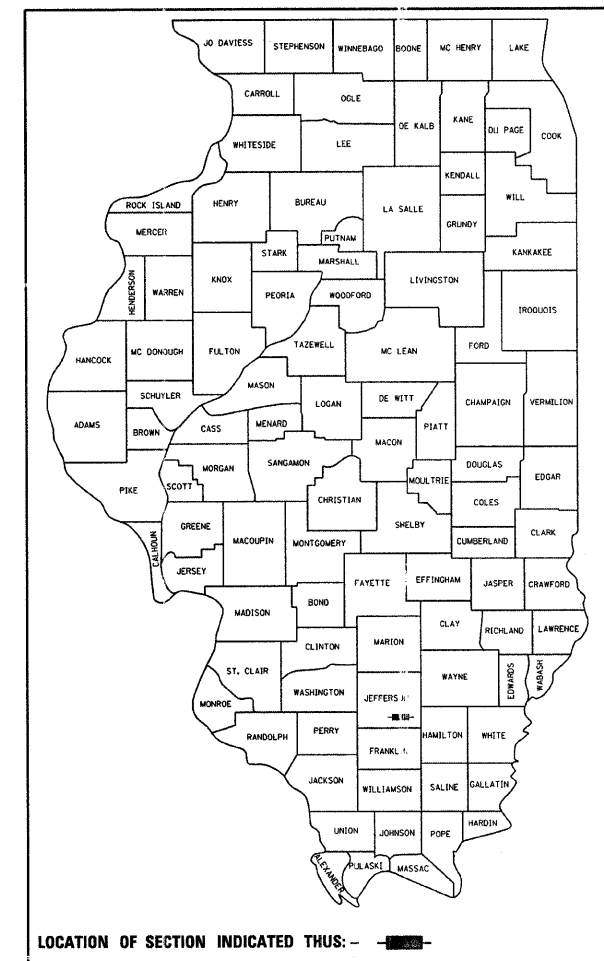

DESIGN DESIGNATION

FUNCTIONAL CLASSIFICATION: LOCAL ROAD
DESIGN SPEED: 40 MPH
DESIGN TRAFFIC: 360 ADT (2008)
DESIGN GUIDELINES: 3R

IMPROVEMENT ENDS
STATION 12+90.00

STA. 9+95
PRECAST PRESTRESSED CONCRETE DECK BEAM
BRIDGE. SINGLE SPAN @ 80'-0"
27'-0" RDWY.; SKEW = 25°
EXISTING STRUCTURE NO. 041-3012
PROPOSED STRUCTURE NO. 041-3743

IMPROVEMENT BEGINS
STATION 7+10.00

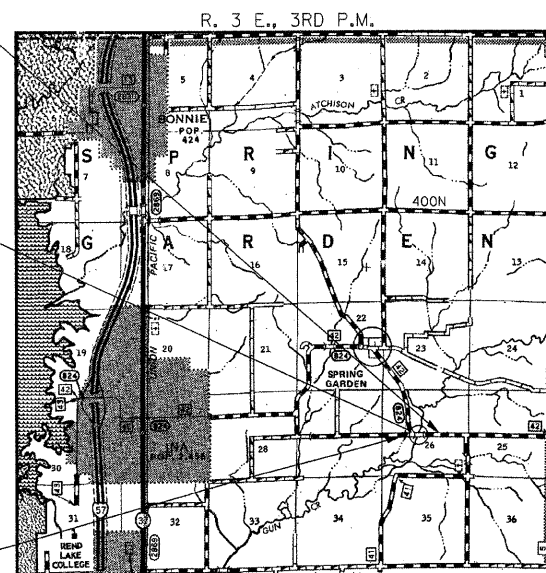

LOCATION MAP

APPROXIMATE SCALE: 0 1 MILE
NET LENGTH OF SECTION = 580 FEET = 0.110 MILES

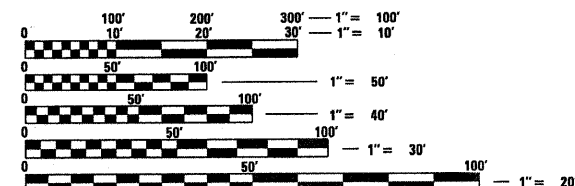

FULL SIZE PLANS HAVE BEEN PREPARED USING STANDARD ENGINEERING SCALES. REDUCED SIZED PLANS WILL NOT CONFORM TO STANDARD SCALES. IN MAKING MEASUREMENTS ON REDUCED PLANS, THE ABOVE SCALES MAY BE USED.

CONTRACT NO. 99361

JEFFERSON COUNTY

SECTION 05-00183-00-BR



JEFFERSON COUNTY HIGHWAY DEPT.	
APPROVED	2-11 20 09 <i>Steve Schmale</i> COUNTY ENGINEER
PASSED	2-20 20 09 <i>Robert W. Melcher</i> DISTRICT NINE ENGINEER OF LOCAL ROADS & STREETS
Released For Bid Based on Limited Review	2-20 20 09 <i>Mary C. Lame</i> DEPUTY DIRECTOR OF HIGHWAYS REGION FIVE ENGINEER STATE OF ILLINOIS DEPARTMENT OF TRANSPORTATION

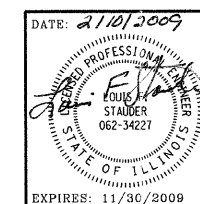

HAMPTON, LENZINI & RENWICK, INC.
CIVIL & STRUCTURAL ENGINEERS
LAND SURVEYORS
3085 STEVENSON DRIVE, SUITE 201
SPRINGFIELD, ILLINOIS 62703
(217) 540-3400
ELGIN • SPRINGFIELD
PROJECT NUMBER: 08.0129.130 DATE: 02/08/09

EXPIRES: 11/30/2009