

INDEX OF SHEETS

SHEET NO.	DESCRIPTION
1	COVER
2	GENERAL NOTES
3	SUMMARY OF QUANTITIES
4	ALIGNMENT, TIES, AND BENCHMARKS
5	SITE PLAN
6	CONSTRUCTION AND SAFETY PLAN
7	CONSTRUCTION AND SAFETY NOTES
8	CONSTRUCTION PHASING - STAGE I
9	CONSTRUCTION PHASING - STAGE I DETAILS
10-11	CONSTRUCTION PHASING - STAGE II
12	CONSTRUCTION PHASING - STAGE II DETAILS
13-14	CONSTRUCTION PHASING - STAGE III
15	CONSTRUCTION PHASING - STAGE III DETAILS
16	CONSTRUCTION PHASING - STAGE IV
17	EXISTING TYPICAL SECTION - PYOTT ROAD
18-20	PROPOSED TYPICAL SECTIONS - PYOTT ROAD
21-22	PROPOSED TYPICAL SECTIONS - AIRPORT ROAD
23	PROPOSED TYPICAL SECTIONS - ATHANS AND ENTRANCE DRIVEWAYS
24-26	REMOVAL PLAN
27-29	PYOTT ROAD PLAN AND PROFILE
30-31	PROPOSED BICYCLE PATH PLAN AND PROFILE
32	PROPOSED AIRPORT ROAD AND ATHANS DRIVEWAY ACCESS PLAN AND PROFILE
33	DRIVEWAY PLAN AND PROFILES
34-35	PYOTT ROAD SUPERELEVATION DETAILS
36	AIRPORT ROAD SUPERELEVATION DETAILS
37	PROPOSED PYOTT INTERSECTION PLAN AND ELEVATION DETAIL
38	EXISTING PYOTT AND AIRPORT ROAD INTERSECTION PLAN AND ELEVATION DETAIL
39	PROPOSED VEHICLE TURNAROUND PLAN AND ELEVATION DETAIL
40-42	PROPOSED PYOTT ROAD PAVEMENT MARKING AND SIGNING PLAN
43-46	DRAINAGE PLANS
47	PYOTT ROAD DRAINAGE DETAILS
48	DRAINAGE SCHEDULE
49-86	CROSS SECTIONS PROPOSED PYOTT ROAD
87-91	CROSS SECTIONS PROPOSED AIRPORT ROAD
92-93	CROSS SECTIONS PROPOSED ATHANS ROAD
94-98	CROSS SECTIONS PROPOSED BIKE PATH
99-118	CROSS SECTIONS EXISTING PYOTT ROAD
119-122	PYOTT ROAD EROSION CONTROL PLANS
123-124	PYOTT ROAD EROSION CONTROL DETAILS

# PLANS FOR PROPOSED RELOCATION OF PYOTT ROAD PHASE II, GRADING AND PAVING

## VILLAGE OF LAKE IN THE HILLS MCHENRY COUNTY, ILLINOIS

### AIP PROJECT NO. 3-17-0112-B10 IDA PROJECT NO. 3CK-3807

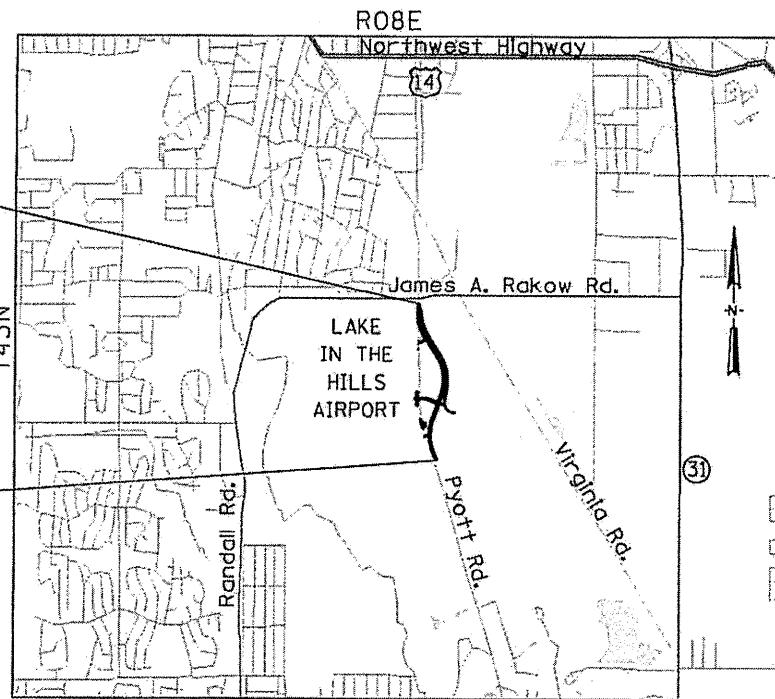

PYOTT ROAD  
END IMPROVEMENT  
STA. 47+30

PYOTT ROAD  
BEGIN IMPROVEMENT  
STA. 10+70

ALGONQUIN TOWNSHIP  
LOCATION MAP

N. T. S.

GROSS AND NET LENGTH OF PROJECT = 3660 FT

TRAFFIC DATA

PYOTT ROAD: 2005 ADT = 12,100  
 POSTED SPEED LIMIT:  
 PYOTT ROAD = 45 MPH  
 ENTRANCE ROADS = 15 MPH  
 DESIGN SPEED:  
 PYOTT ROAD = 50 MPH

**ILLINOIS DEPARTMENT OF TRANSPORTATION  
STANDARD DRAWINGS**

- BD 01 DISTRICT 1 STANDARDS - DRIVEWAY DETAILS DISTANCE BETWEEN R.O.W. AND FACE OF CURB & EDGE OF SHOULDER >= 15'
- BD 02 DISTRICT 1 STANDARDS - DRIVEWAY DETAILS DISTANCE BETWEEN R.O.W. AND FACE OF CURB < 15'
- BD 32 DISTRICT 1 STANDARDS - BUTT JOINTS AND HMA TAPER DETAILS (MODIFIED)
- TC 10 DISTRICT 1 STANDARDS - TRAFFIC CONTROL AND PROTECTION FOR SIDE ROADS, INTERSECTIONS AND DRIVEWAYS
- TC 11 DISTRICT 1 STANDARDS - RAISED REFLECTIVE PAVEMENT MARKERS (SNOW PLOW RESISTANT)
- TC 13 DISTRICT 1 STANDARDS - TYPICAL PAVEMENT MARKINGS
- TC 22 DISTRICT 1 STANDARDS - ARTERIAL ROAD INFORMATION SIGN
- TC 26 DISTRICT 1 STANDARDS - DRIVEWAY ENTRANCE SIGNING
- 701001-02 OFF-RD OPERATIONS, 2L, 2W, MORE THAN 15' AWAY
- 701006-03 OFF-RD OPERATIONS, 2L, 2W, 15' TO 2' FROM PAVEMENT EDGE
- 701301-03 LANE CLOSURE, 2L, 2W, SHORT TIME OPERATIONS
- 701306-02 LANE CLOSURE, 2L, 2W, SLOW MOVING OPERATIONS DAY ONLY, FOR SPEEDS >= 45 MPH
- 701311-03 LANE CLOSURE, 2L, 2W, MOVING OPERATIONS - DAY ONLY
- 701501-05 URBAN LANE CLOSURE, 2L, 2W, UNDIVIDED
- 701502-03 URBAN LANE CLOSURE, 2L, 2W, WITH BIDIRECTIONAL LEFT TURN LANE
- 701901-01 TRAFFIC CONTROL DEVICES

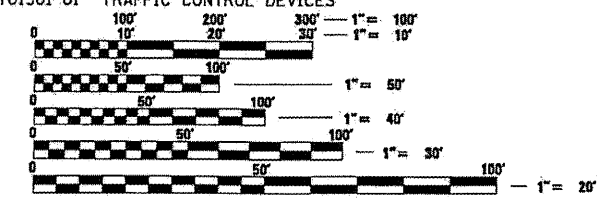

FULL SIZE PLANS HAVE BEEN PREPARED USING STANDARD ENGINEERING SCALES. REDUCED SIZED PLANS WILL NOT CONFORM TO STANDARD SCALES. IN MAKING MEASUREMENTS ON REDUCED PLANS, THE ABOVE SCALES MAY BE USED.

J.U.L.I.E.  
JOINT UTILITY LOCATION INFORMATION FOR EXCAVATION  
1-800-892-0123  
OR 811

Hanson Professional Services, Inc.  
Suite 200, 815 Commerce Drive  
Oak Brook, Illinois 60523  
© Copyright Hanson Professional Services Inc. 2009



MARCH 20, 2009

Becky L. Hobson, P.E.



Hanson Professional Services Inc.  
Suite 200, 815 Commerce Drive  
Oak Brook, Illinois 60523  
© Copyright Hanson Professional Services Inc. 2009