

Hanson Professional Services Inc.
 Suite 200, 815 Commerce Drive
 Oak Brook, Illinois 60521
 © Copyright Hanson Professional Services Inc. 2008

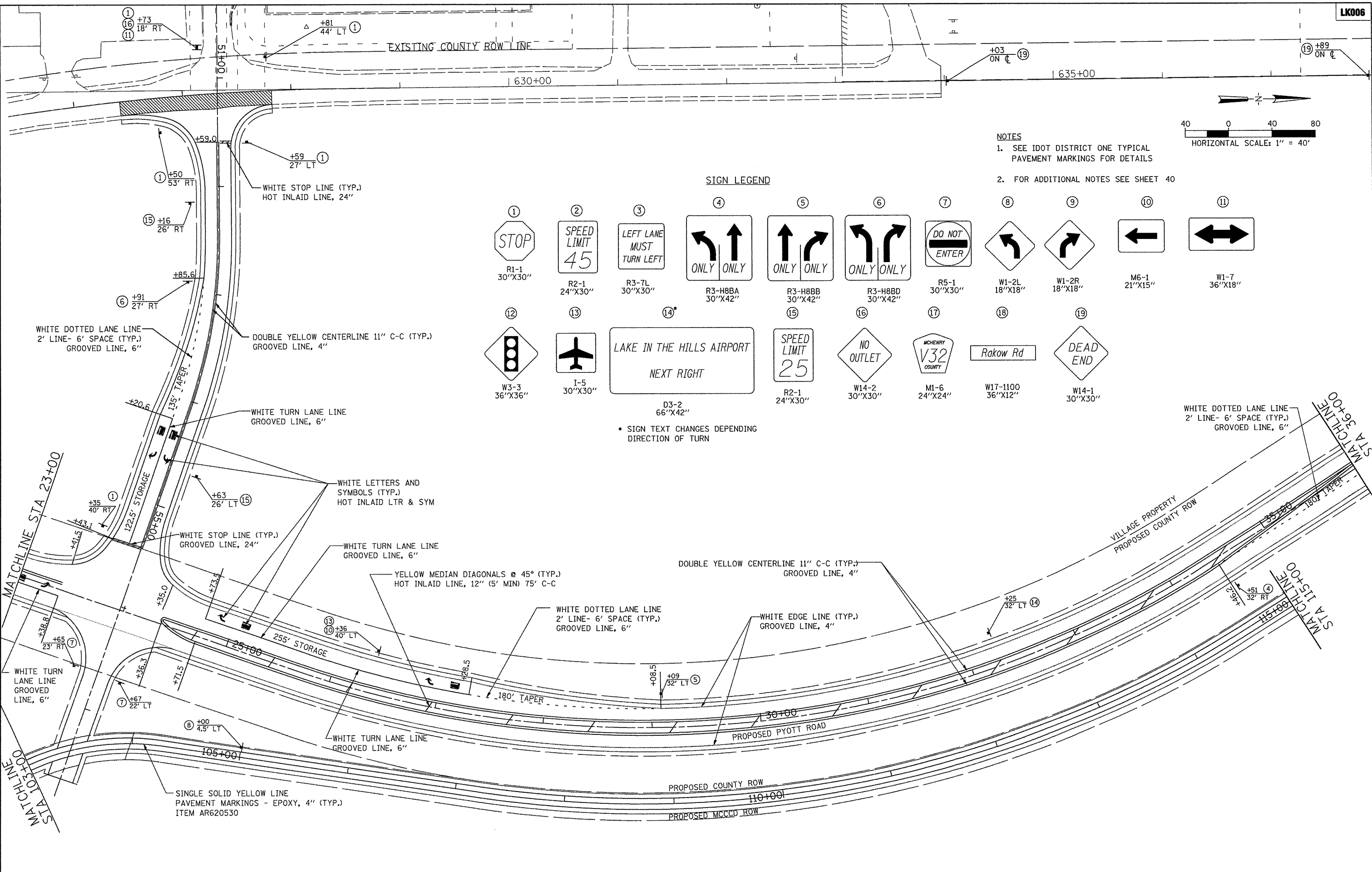

SIGN LEGEND

① STOP R1-1 30"X30"	② SPEED LIMIT 45 R2-1 24"X30"	③ LEFT LANE MUST TURN LEFT R3-7L 30"X30"	④ ONLY ONLY R3-H8BA 30"X42"	⑤ ONLY ONLY R3-H8BB 30"X42"	⑥ ONLY ONLY R3-H8BD 30"X42"	⑦ DO NOT ENTER R5-1 30"X30"	⑧ W1-2L 18"X18"	⑨ W1-2R 18"X18"	⑩ M6-1 21"X15"	⑪ W1-7 36"X18"
⑫ W3-3 36"X36"	⑬ I-5 30"X30"	⑭ LAKE IN THE HILLS AIRPORT NEXT RIGHT D3-2 66"X42"	⑮ SPEED LIMIT 25 R2-1 24"X30"	⑯ NO OUTLET W14-2 30"X30"	⑰ MCHENRY V32 COUNTY M1-6 24"X24"	⑱ Rakow Rd W17-1100 36"X12"	⑲ DEAD END W14-1 30"X30"			

* SIGN TEXT CHANGES DEPENDING DIRECTION OF TURN

NOTES
 1. SEE IDOT DISTRICT ONE TYPICAL PAVEMENT MARKINGS FOR DETAILS
 2. FOR ADDITIONAL NOTES SEE SHEET 40

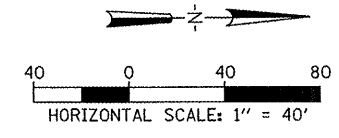

FILE NAME = I:\05Jobs\08841\0588821\Civil Part B\Sheet\C-7PMK-PP2.mht	USER NAME = Blair01219	DESIGNED - DSY	REVISED -	VILLAGE OF LAKE IN THE HILLS, ILLINOIS	PROPOSED PYOTT ROAD PAVEMENT MARKING AND SIGNING PLAN	COUNTY	TOTAL SHEETS	SHEET NO.
PLOT SCALE = 80.0000' / IN.	CHECKED - BLB	REVISED -	MCHENRY			143	41	
PLOT DATE = 02/26/2009, 11:11 AM	DATE - 05/21/08	REVISED -	AIP NO. 3-17-0112-B10 ILLINOIS IDA NO. 3CX-3807					
SCALE: 1"=40'								