

DATE	
BY	
FINAL SURVEY	
NO. 1	
NO. 2	
NO. 3	
NO. 4	
NO. 5	
NO. 6	
NO. 7	
NO. 8	
NO. 9	
NO. 10	
NO. 11	
NO. 12	
NO. 13	
NO. 14	
NO. 15	
NO. 16	
NO. 17	
NO. 18	
NO. 19	
NO. 20	
NO. 21	
NO. 22	
NO. 23	
NO. 24	
NO. 25	
NO. 26	
NO. 27	
NO. 28	
NO. 29	
NO. 30	
NO. 31	
NO. 32	
NO. 33	
NO. 34	
NO. 35	
NO. 36	
NO. 37	
NO. 38	
NO. 39	
NO. 40	
NO. 41	
NO. 42	
NO. 43	
NO. 44	
NO. 45	
NO. 46	
NO. 47	
NO. 48	
NO. 49	
NO. 50	
NO. 51	
NO. 52	
NO. 53	
NO. 54	
NO. 55	
NO. 56	
NO. 57	
NO. 58	
NO. 59	
NO. 60	
NO. 61	
NO. 62	
NO. 63	
NO. 64	
NO. 65	
NO. 66	
NO. 67	
NO. 68	
NO. 69	
NO. 70	
NO. 71	
NO. 72	
NO. 73	
NO. 74	
NO. 75	
NO. 76	
NO. 77	
NO. 78	
NO. 79	
NO. 80	
NO. 81	
NO. 82	
NO. 83	
NO. 84	
NO. 85	
NO. 86	
NO. 87	
NO. 88	
NO. 89	
NO. 90	
NO. 91	
NO. 92	
NO. 93	
NO. 94	
NO. 95	
NO. 96	
NO. 97	
NO. 98	
NO. 99	
NO. 100	
NO. 101	
NO. 102	
NO. 103	
NO. 104	
NO. 105	
NO. 106	
NO. 107	
NO. 108	
NO. 109	
NO. 110	
NO. 111	
NO. 112	
NO. 113	
NO. 114	
NO. 115	
NO. 116	
NO. 117	
NO. 118	
NO. 119	
NO. 120	
NO. 121	
NO. 122	
NO. 123	
NO. 124	
NO. 125	
NO. 126	
NO. 127	
NO. 128	
NO. 129	
NO. 130	
NO. 131	
NO. 132	
NO. 133	
NO. 134	
NO. 135	
NO. 136	
NO. 137	
NO. 138	
NO. 139	
NO. 140	
NO. 141	
NO. 142	
NO. 143	
NO. 144	
NO. 145	
NO. 146	
NO. 147	
NO. 148	
NO. 149	
NO. 150	
NO. 151	
NO. 152	
NO. 153	
NO. 154	
NO. 155	
NO. 156	
NO. 157	
NO. 158	
NO. 159	
NO. 160	
NO. 161	
NO. 162	
NO. 163	
NO. 164	
NO. 165	
NO. 166	
NO. 167	
NO. 168	
NO. 169	
NO. 170	
NO. 171	
NO. 172	
NO. 173	
NO. 174	
NO. 175	
NO. 176	
NO. 177	
NO. 178	
NO. 179	
NO. 180	
NO. 181	
NO. 182	
NO. 183	
NO. 184	
NO. 185	
NO. 186	
NO. 187	
NO. 188	
NO. 189	
NO. 190	
NO. 191	
NO. 192	
NO. 193	
NO. 194	
NO. 195	
NO. 196	
NO. 197	
NO. 198	
NO. 199	
NO. 200	

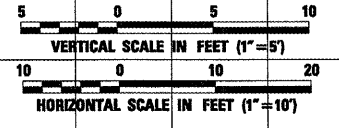

DATE	
BY	
ORIGINAL SURVEY	
NO. 1	
NO. 2	
NO. 3	
NO. 4	
NO. 5	
NO. 6	
NO. 7	
NO. 8	
NO. 9	
NO. 10	
NO. 11	
NO. 12	
NO. 13	
NO. 14	
NO. 15	
NO. 16	
NO. 17	
NO. 18	
NO. 19	
NO. 20	
NO. 21	
NO. 22	
NO. 23	
NO. 24	
NO. 25	
NO. 26	
NO. 27	
NO. 28	
NO. 29	
NO. 30	
NO. 31	
NO. 32	
NO. 33	
NO. 34	
NO. 35	
NO. 36	
NO. 37	
NO. 38	
NO. 39	
NO. 40	
NO. 41	
NO. 42	
NO. 43	
NO. 44	
NO. 45	
NO. 46	
NO. 47	
NO. 48	
NO. 49	
NO. 50	
NO. 51	
NO. 52	
NO. 53	
NO. 54	
NO. 55	
NO. 56	
NO. 57	
NO. 58	
NO. 59	
NO. 60	
NO. 61	
NO. 62	
NO. 63	
NO. 64	
NO. 65	
NO. 66	
NO. 67	
NO. 68	
NO. 69	
NO. 70	
NO. 71	
NO. 72	
NO. 73	
NO. 74	
NO. 75	
NO. 76	
NO. 77	
NO. 78	
NO. 79	
NO. 80	
NO. 81	
NO. 82	
NO. 83	
NO. 84	
NO. 85	
NO. 86	
NO. 87	
NO. 88	
NO. 89	
NO. 90	
NO. 91	
NO. 92	
NO. 93	
NO. 94	
NO. 95	
NO. 96	
NO. 97	
NO. 98	
NO. 99	
NO. 100	
NO. 101	
NO. 102	
NO. 103	
NO. 104	
NO. 105	
NO. 106	
NO. 107	
NO. 108	
NO. 109	
NO. 110	
NO. 111	
NO. 112	
NO. 113	
NO. 114	
NO. 115	
NO. 116	
NO. 117	
NO. 118	
NO. 119	
NO. 120	
NO. 121	
NO. 122	
NO. 123	
NO. 124	
NO. 125	
NO. 126	
NO. 127	
NO. 128	
NO. 129	
NO. 130	
NO. 131	
NO. 132	
NO. 133	
NO. 134	
NO. 135	
NO. 136	
NO. 137	
NO. 138	
NO. 139	
NO. 140	
NO. 141	
NO. 142	
NO. 143	
NO. 144	
NO. 145	
NO. 146	
NO. 147	
NO. 148	
NO. 149	
NO. 150	
NO. 151	
NO. 152	
NO. 153	
NO. 154	
NO. 155	
NO. 156	
NO. 157	
NO. 158	
NO. 159	
NO. 160	
NO. 161	
NO. 162	
NO. 163	
NO. 164	
NO. 165	
NO. 166	
NO. 167	
NO. 168	
NO. 169	
NO. 170	
NO. 171	
NO. 172	
NO. 173	
NO. 174	
NO. 175	
NO. 176	
NO. 177	
NO. 178	
NO. 179	
NO. 180	
NO. 181	
NO. 182	
NO. 183	
NO. 184	
NO. 185	
NO. 186	
NO. 187	
NO. 188	
NO. 189	
NO. 190	
NO. 191	
NO. 192	
NO. 193	
NO. 194	
NO. 195	
NO. 196	
NO. 197	
NO. 198	
NO. 199	
NO. 200	

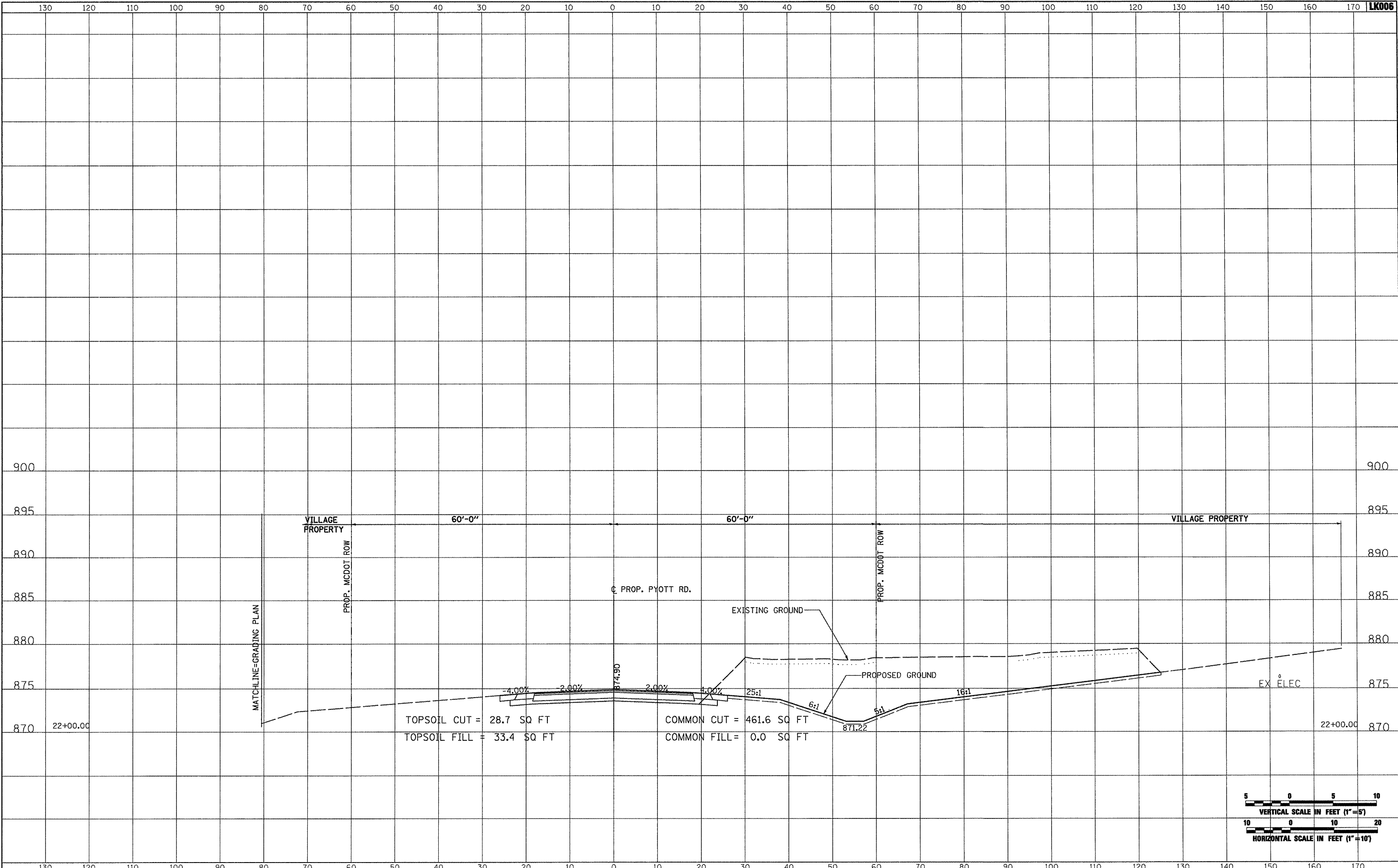

FILE NAME = I:\05Jobs\00841\0586021\Civil Part B\Sheets\CROSSSECTIONS.sh	USER NAME = Blain01219	DESIGNED - BLB	REVISIED -	<b>VILLAGE OF LAKE IN THE HILLS, ILLINOIS</b>	<b>CROSS SECTIONS PROPOSED PYOTT ROAD</b>	COUNTY	TOTAL SHEETS	SHEET NO.
PLOT SCALE = 28.0000' / IN.	CHECKED - LDH	REVISIED -	MCHENRY			143	66	
PLOT DATE = 02/25/2009, 01:51 PM	DATE - 05/21/08	REVISIED -	FEDERAL AIP, NO. 3-17-0112-B10 ILLINOIS IDA NO. 3CK-3807					
SCALE: AS SHOWN			STA. 22+00.00 TO STA. 22+00.00					