

DATE	
BY	
SURVEYED	
PLOTTED	
TEMPLATE	
NOTE BOOK	
AREAS CHECKED	

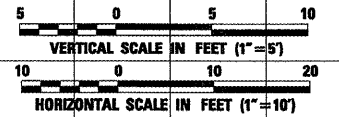

DATE	
BY	
ORIGINAL SURVEY	
PLOTTED	
TEMPLATE	
NOTE BOOK	
AREAS CHECKED	

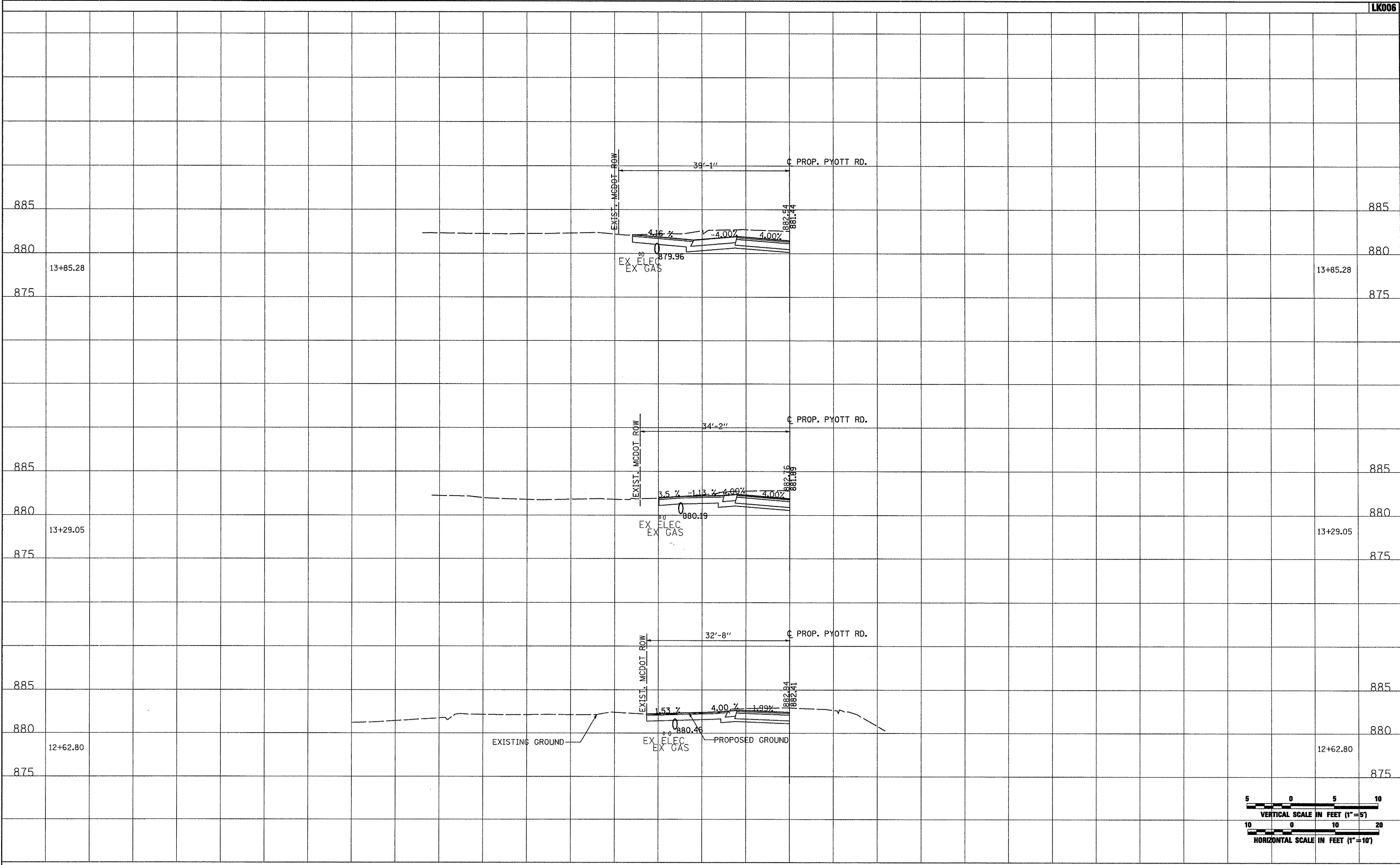

FILE NAME = I:\05Jobs\00841\0588021\Civil Part B\Sheets\CROSSSECTIONS.shx	USER NAME = Blsr01219	DESIGNED - BLB	REVISED -	VILLAGE OF LAKE IN THE HILLS, ILLINOIS	CROSS SECTIONS PROPOSED PYOTT ROAD	COUNTY	TOTAL SHEETS	SHEET NO.
PLOT SCALE = 20.0000' / IN.	DRAWN - CBP	REVISED -	MCHENRY			143	86	
PLOT DATE = 02/25/2009, 01:52 PM	CHECKED - LDH	REVISED -	FEDERAL AIP, NO. 3-17-0112-B10 ILLINOIS IDA NO. 3CK-3807					
DATE - 05/21/08	REVISED -	SCALE: AS SHOWN	STA.			TO STA.		