

DATE	
BY	
FINAL SURVEY	SURVEYED
NOTE BOOK NO.	PLOTTED
	TEMPLATE
	AREAS CHECKED

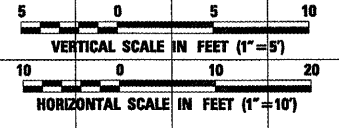

DATE	
BY	
ORIGINAL SURVEY	SURVEYED
NOTE BOOK NO.	PLOTTED
	TEMPLATE
	AREAS CHECKED

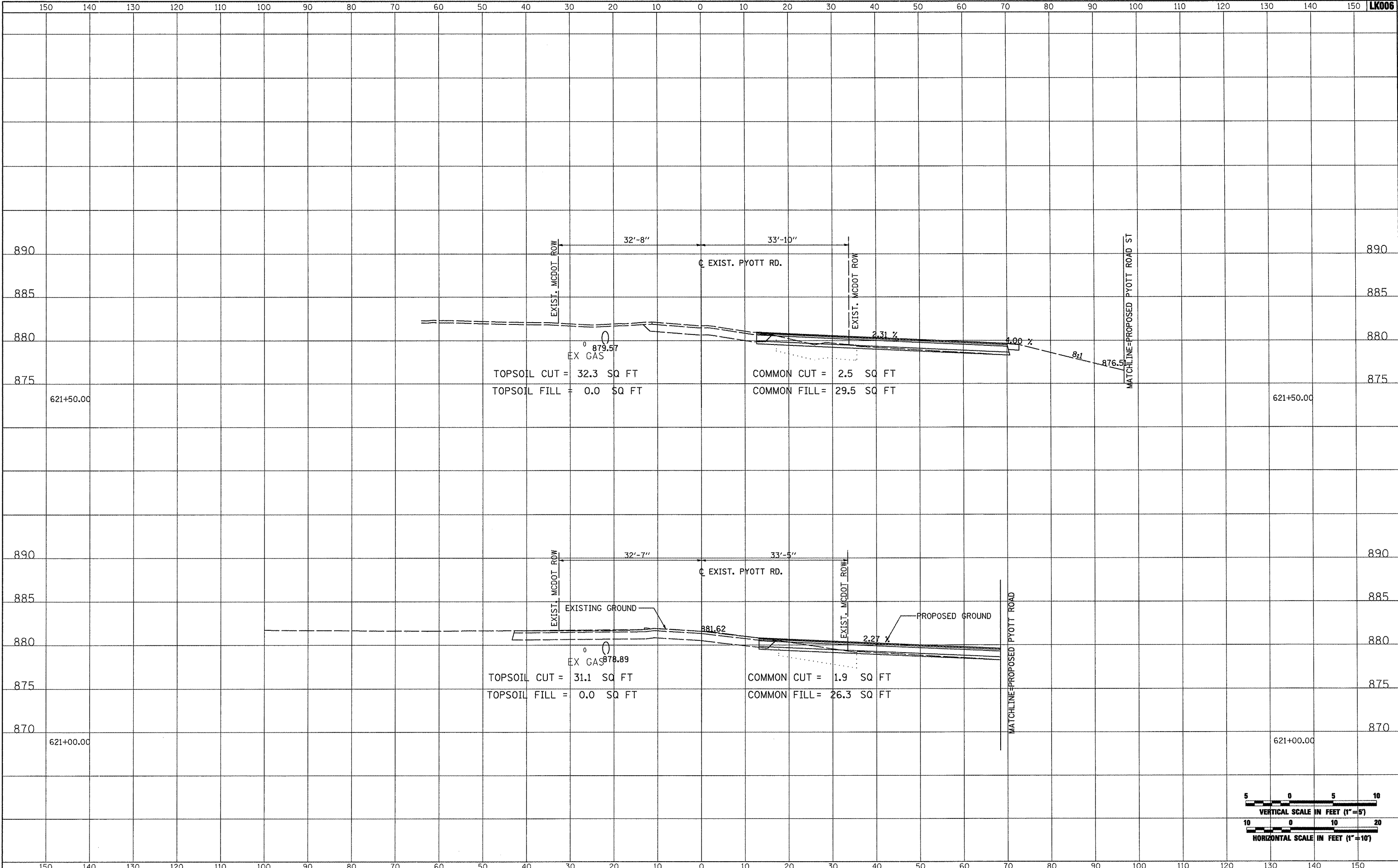

FILE NAME =	USER NAME = Blair01219	DESIGNED - BLB	REVISED -	VILLAGE OF LAKE IN THE HILLS, ILLINOIS	CROSS SECTIONS EXISTING PYOTT ROAD		COUNTY	TOTAL SHEETS	SHEET NO.
U:\05_jobs\00841\05b8021\civil part b\sheets\CROSSSECTIONS_Cur_Pyott.tst		DRAWN - CBP	REVISED -		MCHENRY	143	100		
PLOT SCALE = 20.0000' / IN.		CHECKED - LDH	REVISED -						
PLOT DATE = 02/25/2009, 01:53 PM		DATE - 05/21/08	REVISED -						
				SCALE: AS SHOWN	STA. 621+00.00 TO STA. 621+50.00	FEDERAL AIP, NO. 3-17-0112-B10 ILLINOIS IDA NO. 3CK-3807			