

STATE OF ILLINOIS
DEPARTMENT OF TRANSPORTATION
DIVISION OF HIGHWAYS

F.A.P. RTE.	SECTION	COUNTY	TOTAL SHEETS	SHEET NO.
91/820	51-1N	COLES	5	1
		ILLINOIS	CONTRACT NO. 74716	

FOR INDEX OF SHEETS, SEE SHEET NO. 2

**PROPOSED
HIGHWAY PLANS**

FAP ROUTE 91 / FAP ROUTE 820 (ILL 16 / ILL 130)
SECTION 51-1N

MEDIAN AND CURB & GUTTER REPAIR
COLES COUNTY

D-97-021-15

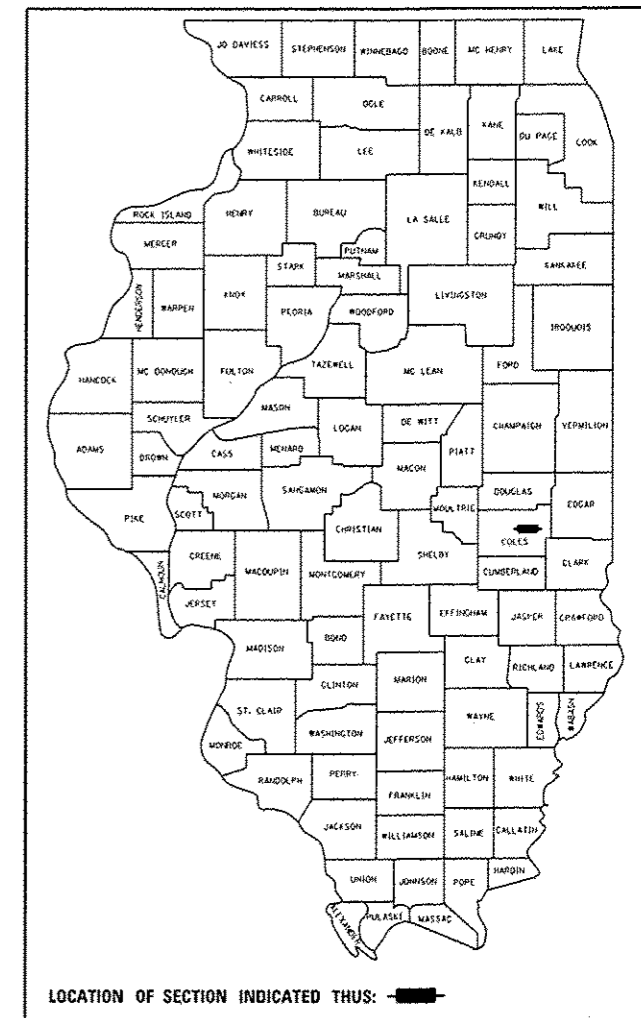

C-97-039-15

ADT:
ILL 16 WEST OF ILL 130: 17,900
ILL 16 EAST OF ILL 130: 13,000
ILL 130 NORTH OF ILL 16: 11,100

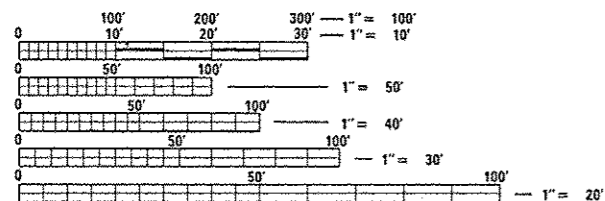
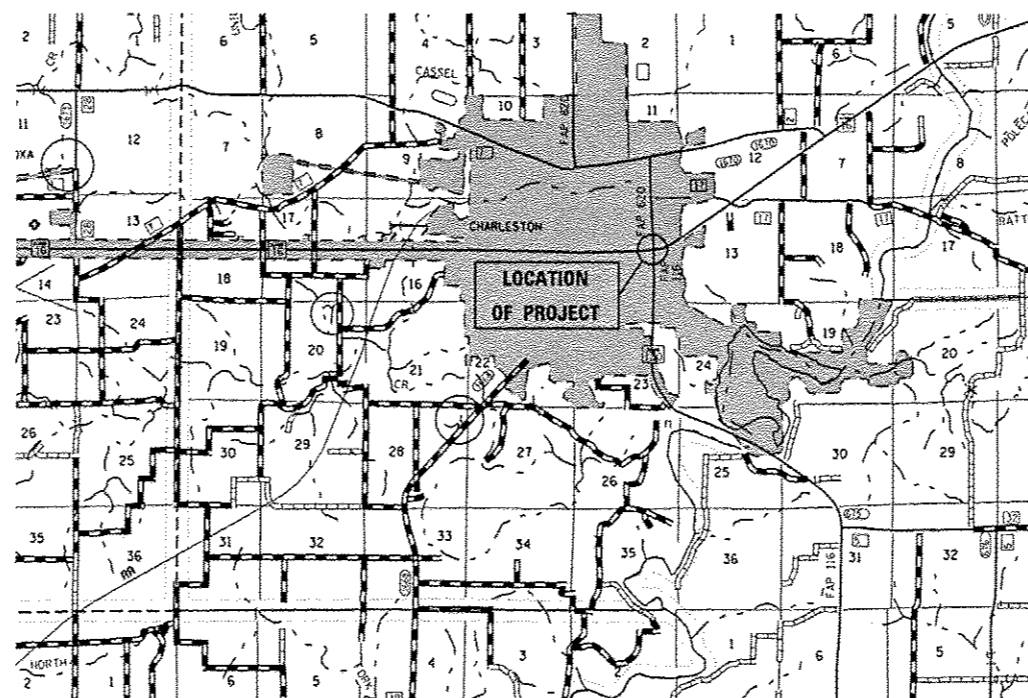

FULL SIZE PLANS HAVE BEEN PREPARED USING STANDARD ENGINEERING SCALES. REDUCED SIZED PLANS WILL NOT CONFORM TO STANDARD SCALES. IN MAKING MEASUREMENTS ON REDUCED PLANS, THE ABOVE SCALES MAY BE USED.

J.U.L.I.E.
JOINT UTILITY LOCATION INFORMATION FOR EXCAVATION
1-800-892-0123
OR 811

PROJECT ENGINEER MARK DAUGHERTY
PROJECT MANAGER JOYCE HEMMEN

GROSS LENGTH = 983 FT. = 0.186 MILE
NET LENGTH = 983 FT. = 0.186 MILE

CONTRACT NO. 74716

STATE OF ILLINOIS
DEPARTMENT OF TRANSPORTATION
DIVISION OF HIGHWAYS

SUBMITTED FEBRUARY 6 20 15
Roger L. Driskell
DEPUTY DIRECTOR OF HIGHWAYS, REGION ENGINEER

Mar 20 20 15
John D. Baranzelli P.E.
ENGINEER OF DESIGN AND ENVIRONMENT

Mar 20 20 15
Omer Osman P.E.
DIRECTOR OF HIGHWAYS, CHIEF ENGINEER

PRINTED BY THE AUTHORITY
OF THE STATE OF ILLINOIS

GENERAL NOTES

THIS SECTION SHALL BE CONSTRUCTED IN ACCORDANCE WITH THE PLANS, THE "STANDARD SPECIFICATIONS FOR ROAD AND BRIDGE CONSTRUCTION", ADOPTED JANUARY 1, 2012; THE "SUPPLEMENTAL SPECIFICATIONS AND RECURRING SPECIAL PROVISIONS" INDICATED ON THE CHECK SHEET, AND THE SPECIAL PROVISIONS INCLUDED IN THE PROPOSAL.

THIS PROJECT IS LOCATED AT THE INTERSECTION OF IL 16 & IL 130 IN THE CITY OF CHARLESTON, IN COLES COUNTY. THE WORK INCLUDED IN THIS SECTION CONSISTS OF THE REMOVAL OF THE EXISTING DOWELED MEDIAN ON THE EAST AND WEST LEGS ON ROUTE 16 AND THE NORTH LEG ON ROUTE 130. IT WILL BE REPLACED WITH CONCRETE MEDIAN, TYPE SB-6.06, CONCRETE MEDIAN SURFACE AND CC&G TYPE B 6.06.

THE TOTAL QUANTITY OF THERMOPLASTIC PAVEMENT MARKING - LINE 4" CONSISTS OF 1952 FEET OF YELLOW.

THE CENTERLINE AND STATIONING SHOWN WERE DEVELOPED FROM PREVIOUS PLANS AND ARE TO BE USED AS REFERENCE ONLY. THE EXISTING MEDIAN SHALL BE REPLACED IN ITS EXACT LOCATION.

A RAMPED NOSE SHALL BE CONSTRUCTED 6' IN LENGTH AT EACH END OF EACH MEDIAN PER HIGHWAY STANDARD 606301. THE AREAS OF RAMPED NOSES WILL BE INCLUDED IN THE COST OF CONCRETE MEDIAN, TYPE SB-6.06.

MEDIAN REMOVAL SHALL CONSIST OF CONSTRUCTING A FULL-DEPTH SAWCUT A MINIMUM OF 6" FROM THE FACE OF EXISTING CURB AND REMOVING ALL PAVEMENT, MEDIAN AND CURB & GUTTER WITHIN THE LIMITS OF THE SAW CUTS AS SHOWN ON THE PLANS.

THE LONGITUDINAL JOINT TIE BARS (NO. 6) SHALL BE 30" IN LENGTH AND WILL BE SPACED AT 24" CENTERS.

INDEX OF SHEETS

- 1 COVER SHEET
- 2 INDEX OF SHEETS AND GENERAL NOTES
- 3 SUMMARY OF QUANTITIES
- 4 TYPICAL SECTIONS
- 5 PLAN SHEET

THE FOLLOWING STANDARDS ARE A PART OF THESE PLANS AND ARE INCLUDED AFTER SHEET 5:

- 000001-06 STANDARD SYMBOLS, ABBREVIATIONS AND PATTERNS
- 001001-02 AREAS OF REINFORCEMENT BARS
- 001006 DECIMAL OF INCH PER FOOT
- 420001-08 PAVEMENT JOINTS
- 606001-06 CONCRETE CURB TYPE B AND COMBINATION CONCRETE CURB AND GUTTER
- 606301-04 PC CONCRETE ISLAND AND MEDIANS
- 701602-07 URBAN LANE CLOSURE, MULTILANE, 2W WITH BIDIRECTIONAL LEFT TURN LANE
- 701701-09 URBAN LANE CLOSURE, MULTILANE INTERSECTION
- 701901-04 TRAFFIC CONTROL DEVICES
- 780001-05 TYPICAL PAVEMENT MARKINGS
- 782001 PRISMATIC CURB REFLECTORS

FILE NAME =	USER NAME = atoffennk	DESIGNED -	REVISED -	STATE OF ILLINOIS DEPARTMENT OF TRANSPORTATION	GENERAL NOTES AND INDEX OF SHEETS	F.A.P. RTE.	SECTION	COUNTY	TOTAL SHEETS	SHEET NO.
z:\p\work\pdsdot\atoffennk\08423011\07	4716-sht-genote.dgn	DRAWN -	REVISED -			•	51-IN	COLES	5	2
	PLOT SCALE = 1/8" = 1'-0"	CHECKED -	REVISED -			• 91/820				CONTRACT NO. 74716
Default	PLOT DATE = 2/6/2015	DATE -	REVISED -			SCALE:	SHEET OF	SHEETS	STA. TO STA.	ILLINOIS FED. AID PROJECT

SUMMARY OF QUANTITIES			URBAN TOTAL QUANTITIES	CONSTRUCTION TYPE CODE		
CODE NO	ITEM	UNIT		0005 100% STATE		
31101900	SUBBASE GRANULAR MATERIAL, TYPE C	TON	191	191		
44003100	MEDIAN REMOVAL	SO FT	5008	5008		
44213204	TIE BARS 3/4"	EACH	972	972		
60603500	COMBINATION CONCRETE CURB AND GUTTER, TYPE B-6.06	FOOT	610	610		
60618300	CONCRETE MEDIAN SURFACE, 4 INCH	SO FT	2141	2141		
60619200	CONCRETE MEDIAN, TYPE SB-6.06	SO FT	2376	2376		
67000500	ENGINEER'S FIELD OFFICE, TYPE B	CAL MO	2	2		
67100100	MOBILIZATION	L SUM	1	1		
70102632	TRAFFIC CONTROL AND PROTECTION, STANDARD 701602	L SUM	1	1		
70102635	TRAFFIC CONTROL AND PROTECTION, STANDARD 701701	L SUM	1	1		
70103815	TRAFFIC CONTROL SURVEILLANCE	CAL DA	15	15		
* 78000200	THERMOPLASTIC PAVEMENT MARKING - LINE 4"	FOOT	1952	1952		
* 78200300	PRISMATIC CURB REFLECTOR	EACH	93	93		

SUMMARY OF QUANTITIES			URBAN TOTAL QUANTITIES	CONSTRUCTION TYPE CODE		
CODE NO	ITEM	UNIT		0005 100% STATE		
X7015005	CHANGEABLE MESSAGE SIGN	CAL DA	56	56		

14

* SPECIALTY ITEM

FILE NAME =	USER NAME = staffennk	DESIGNED -	REVISED -	STATE OF ILLINOIS DEPARTMENT OF TRANSPORTATION	SUMMARY OF QUANTITIES	F.A.P. RTE.	SECTION	COUNTY	TOTAL SHEETS	SHEET NO.
c:\nowork\p\ridoch\staffennk\2423811\07	4716-sh-500.dgn	DRAWN -	REVISED -			51-IN	COLES	5	3	
Defaults	PLOT SCALE = 1/8" = 1'-0"	CHECKED -	REVISED -			*91/820	CONTRACT NO. 74716			
	PLOT DATE = 2/6/2015	DATE -	REVISED -			ILLINOIS FED. AID PROJECT				

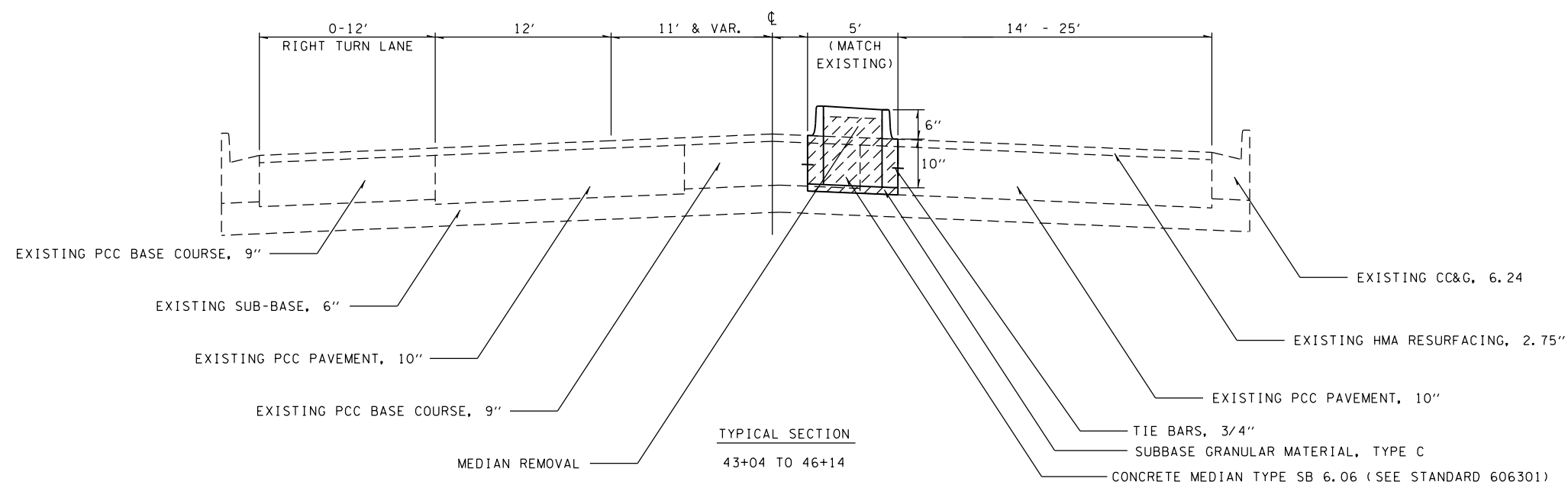
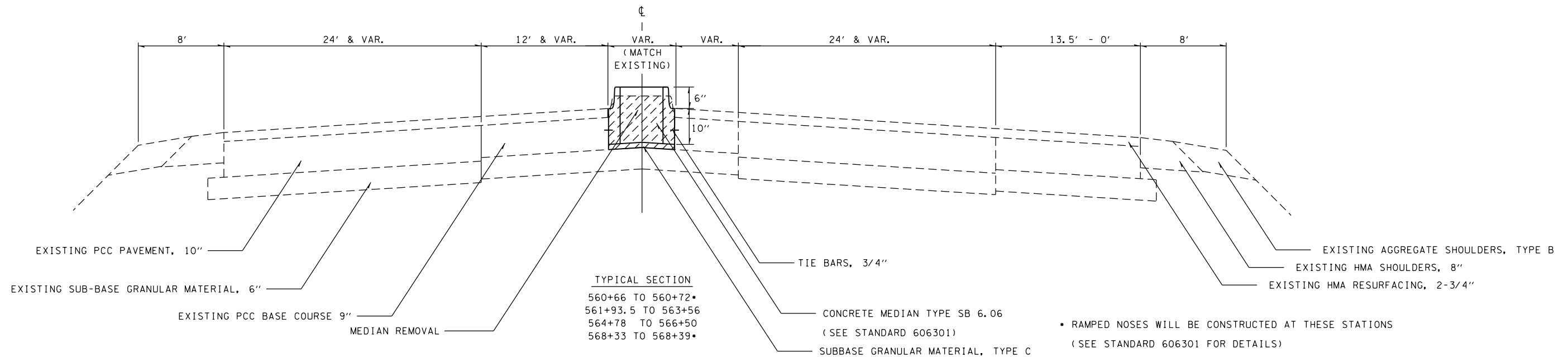
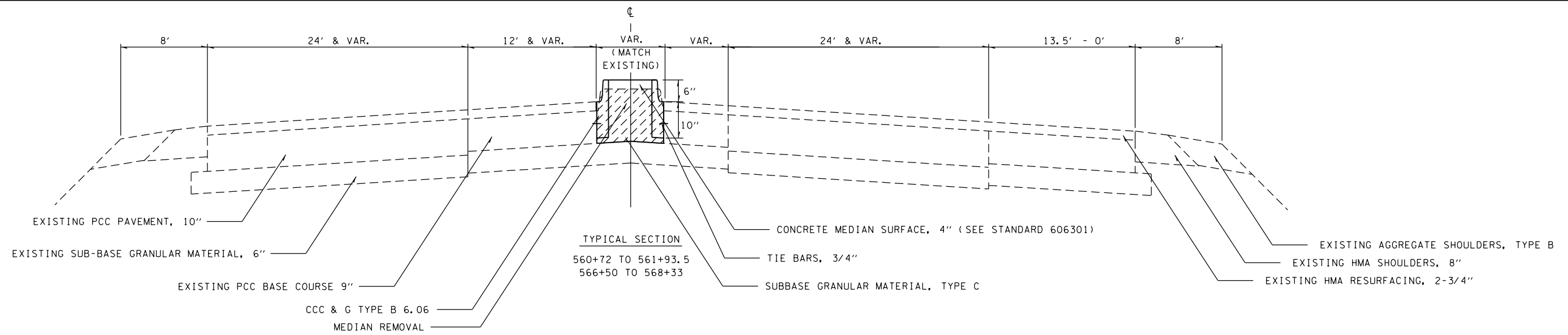

FILE NAME =	USER NAME = steffenmk	DESIGNED -	REVISED -
c:\pw\work\p\id\dot\stevfenmk\d0423011\07	4716-sh-typical.dgn	DRAWN -	REVISED -
Default	PLOT SCALE = 100.0000' / in.	CHECKED -	REVISED -
	PLOT DATE = 2/6/2015	DATE -	REVISED -

**STATE OF ILLINOIS
DEPARTMENT OF TRANSPORTATION**

TYPICAL SECTIONS			
SCALE:	SHEET	OF SHEETS	STA. TO STA.

F.A.P. RTE.	SECTION	COUNTY	TOTAL SHEETS	SHEET NO.
• 91/820	51-IN	COLES	5	4
ILLINOIS FED. AID PROJECT			CONTRACT NO. 74716	

MEDIAN REMOVAL SCHEDULE

LOCATION		QUANTITY
ROUTE	STATION TO STATION	SQ FT
IL 16	560+66.0 563+56.0	1323
	564+78.0 568+39.0	2154
IL 130	43+04.0 46+14.0	1531
	TOTAL	5008

CONCRETE MEDIAN, TYPE SB-6.06 SCHEDULE

LOCATION		QUANTITY
ROUTE	STATION TO STATION	SQ FT
IL 16	560+66.0 560+72.0	29
	561+93.5 563+56.0	333
	564+78.0 566+50.0	455
	568+33.0 568+39.0	28
IL 130	43+04.0 46+14.0	1531
	TOTAL	2376

CONCRETE MEDIAN SURFACE, 4" SCHEDULE

LOCATION		QUANTITY
ROUTE	STATION TO STATION	SQ FT
IL 16	560+72.0 561+93.5	639
	566+50.0 568+33.0	1502
	TOTAL	2141

COMBINATION CONCRETE CURB AND GUTTER, TYPE B 6.06 SCHEDULE

LOCATION		QUANTITY	
ROUTE	SIDE	STATION TO STATION	FOOT
IL 16	LT	560+72.0 561+93.5	121
	RT	560+72.0 561+93.5	122
	LT	566+50.0 568+33.0	184
	RT	566+50.0 568+33.0	183
		TOTAL	610

TIE BARS 3/4" SCHEDULE

LOCATION		LENGTH	QUANTITY
ROUTE	STATION TO STATION	FOOT	EACH
IL 16	560+66.0 563+56.0	589	294.5
	564+78.0 568+39.0	728	364
IL 130	43+04.0 46+14.0	626	313
	TOTAL		972

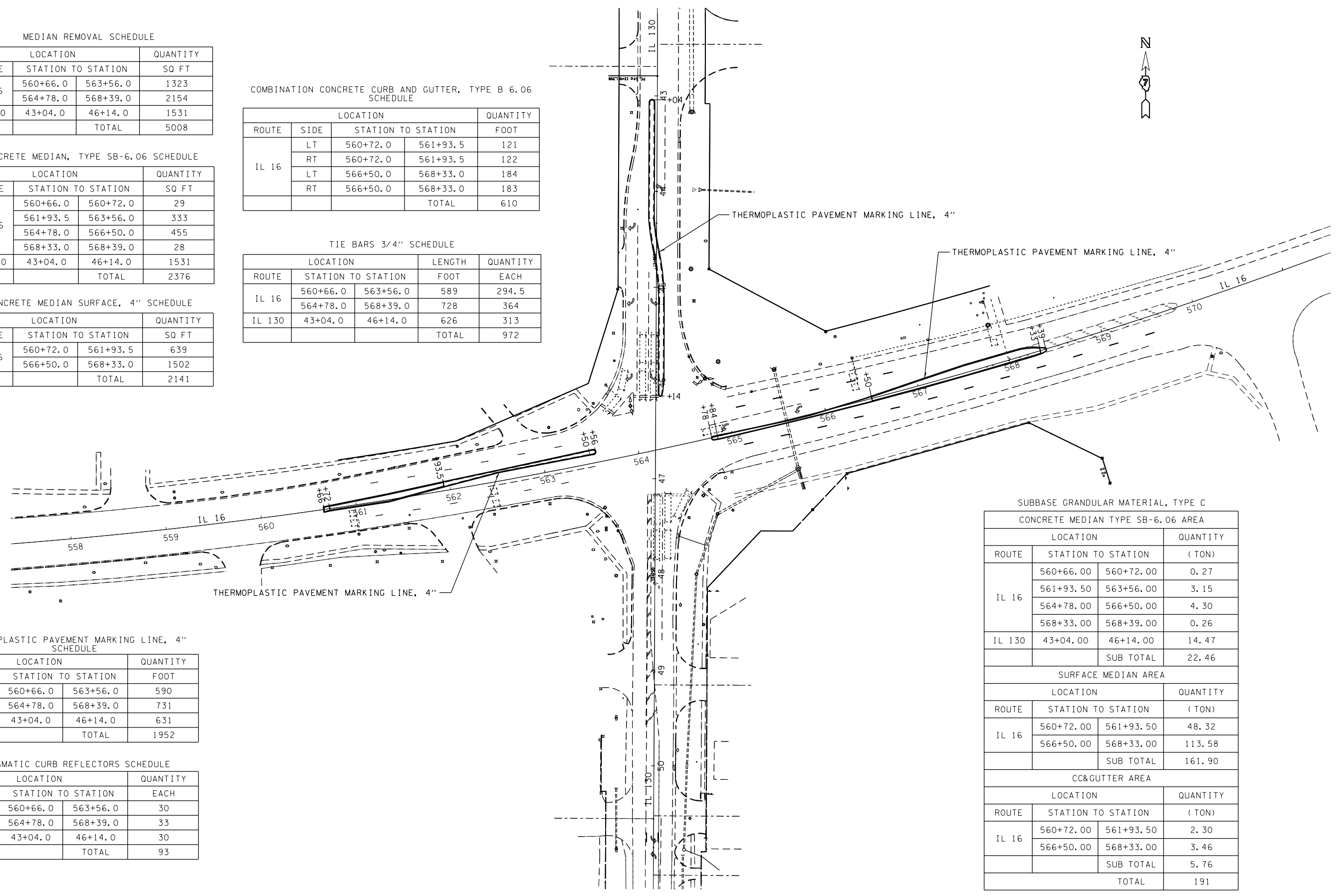

THERMOPLASTIC PAVEMENT MARKING LINE, 4" SCHEDULE

LOCATION		QUANTITY
ROUTE	STATION TO STATION	FOOT
IL 16	560+66.0 563+56.0	590
	564+78.0 568+39.0	731
IL 130	43+04.0 46+14.0	631
	TOTAL	1952

PRISMATIC CURB REFLECTORS SCHEDULE

LOCATION		QUANTITY
ROUTE	STATION TO STATION	EACH
IL 16	560+66.0 563+56.0	30
	564+78.0 568+39.0	33
IL 130	43+04.0 46+14.0	30
	TOTAL	93

SUBBASE GRANULAR MATERIAL, TYPE C

CONCRETE MEDIAN TYPE SB-6.06 AREA		QUANTITY
ROUTE	STATION TO STATION	(TON)
IL 16	560+66.00 560+72.00	0.27
	561+93.50 563+56.00	3.15
	564+78.00 566+50.00	4.30
	568+33.00 568+39.00	0.26
IL 130	43+04.00 46+14.00	14.47
	SUB TOTAL	22.46

SURFACE MEDIAN AREA

LOCATION		QUANTITY
ROUTE	STATION TO STATION	(TON)
IL 16	560+72.00 561+93.50	48.32
	566+50.00 568+33.00	113.58
	SUB TOTAL	161.90

CC&GUTTER AREA

LOCATION		QUANTITY
ROUTE	STATION TO STATION	(TON)
IL 16	560+72.00 561+93.50	2.30
	566+50.00 568+33.00	3.46
	SUB TOTAL	5.76
	TOTAL	191

FILE NAME =	USER NAME = steffenmk	DESIGNED -	REVISED -
c:\pwork\pwork\stev\stev\mk\d0423011\074716-shr-plan.dgn		DRAWN -	REVISED -
Default	PLOT SCALE = 100.0000' / 1"	CHECKED -	REVISED -
	PLOT DATE = 2/6/2015	DATE -	REVISED -

STATE OF ILLINOIS
DEPARTMENT OF TRANSPORTATION

SCALE: SHEET OF SHEETS STA. TO STA.

PLAN SHEET

F.A. RTE.	SECTION	COUNTY	TOTAL SHEETS	SHEET NO.
• 91/820	51-IN	COLES	5	5
CONTRACT NO. 74716			ILLINOIS FED. AID PROJECT	