

STATE OF ILLINOIS
DEPARTMENT OF TRANSPORTATION
DIVISION OF HIGHWAYS

F. A. ID. NO.	SECTION	COUNTY	TOTAL SHEETS	SHEET NO.
12-00020-00-SW	COOK	25	1	
STA.		TO STA.		
FED. ROAD DIST. NO.	ILLINOIS	FED. AID PROJECT	SRTS-4009(256)	

CONTRACT #61B29

PLANS FOR PROPOSED FEDERAL AID HIGHWAY

OLMSTED LANE
BLACKHAWK DRIVE TO WESTERN AVENUE
BLACKHAWK DRIVE
OLMSTED LANE TO AMHERST LANE
SIDEWALK INSTALLATION
PROJECT NO.: SRTS-4009(256)
SECTION NO.: 12-00020-00-SW
VILLAGE of UNIVERSITY PARK
WILL COUNTY
JOB NO.: C-91-377-13



INDEX OF SHEETS

1. COVER SHEET, INDEX OF SHEETS & HIGHWAY STANDARDS
2. SUMMARY OF QUANTITIES & GENERAL NOTES
3. TYPICAL SECTIONS
- 4.-7. SIDEWALK PLAN & PROFILE
- 8.-10. IDOT DISTRICT 1 STANDARD DETAILS
11. SAFETY FLASHERS DETAILS
- 12.-25. OLMSTED LANE AND BLACKHAWK DRIVE CROSS SECTIONS

HIGHWAY STANDARDS

- 000001-06 STANDARD SYMBOLS, ABBREVIATIONS AND PATTERNS
- 424001-08 PERPENDICULAR CURB RAMPS
- 424011-02 CORNER PARALLEL CURB RAMPS FOR SIDEWALKS
- 424016-02 MID-BLOCK CURB AND RAMPS FOR SIDEWALKS
- 701501-06 URBAN LANE CLOSURE, 2L, 2W, UNDIVIDED
- 701801-05 SIDEWALK, CORNER OR CROSSWALK CLOSURE
- 701901-04 TRAFFIC CONTROL DEVICES

<u>OLMSTED LANE</u>	
2015 ADT -	500
POSTED SPEED LIMIT -	25 mph
DESIGN DESIGNATION -	LOCAL
<u>BLACKHAWK DRIVE</u>	
2015 ADT -	800
POSTED SPEED LIMIT -	25 mph
DESIGN DESIGNATION -	LOCAL

SCALES

PLAN -	1"=50'
PROFILE HORIZ. -	1"=50'
PROFILE VERT. -	1"=5'
CROSS SECTIONS -	1"=10'

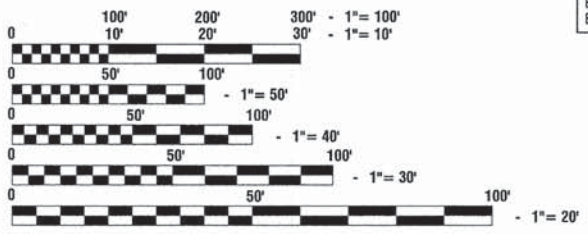

FULL SIZE PLANS HAVE BEEN PREPARED USING STANDARD ENGINEERING SCALES, REDUCED SIZED PLANS WILL NOT CONFORM TO STANDARD SCALES, IN MAKING MEASUREMENTS ON REDUCED PLANS, THE ABOVE SCALES MAY BE USED.

J. U. L. I. E.
JOINT UTILITY LOCATION INFORMATION FOR EXCAVATION
1-800-892-0123 or 811



LOCATION MAP
GROSS LENGTH=3,294 FEET=0.62 MILES
NET LENGTH=3,294 FEET=0.62 MILES

STATE OF ILLINOIS DEPARTMENT OF TRANSPORTATION
DIVISION OF HIGHWAYS

Approved: *William J. [Signature]*
Mayor, Village of UNIVERSITY PARK

Passed: FEBRUARY 18, 2015
[Signature] CHRISTOPHER HOLT
District 1 Engineer of Local Roads & Streets

Released for Bid Based on Limited Review: February 18 2015
John Fortmann [Signature]
Deputy Director of Highways, Region 1 Engineer

PRINTED BY THE AUTHORITY OF THE STATE OF ILLINOIS

PREPARED BY OR UNDER THE DIRECT SUPERVISION OF:
[Signature]
1/26/2015

I.D.O.T. FEDERAL AID DESIGN ENGINEER: FAWAD AQUEEL, P.E. 847-705-4021, SCHAMBURG, IL
CONSULTANTS: ROBINSON ENGINEERING, LTD. 708-331-6700

CONTRACT NO. 61B29

SUMMARY OF QUANTITIES					CONSTRUCTION TYPE CODE
S.I.	CODE NO.	PAY ITEM	UNIT	QUAN	0021
	35101598	AGGREGATE BASE COURSE, TYPE B 3"	SQ YD	2300	2300
	42400200	PORTLAND CEMENT CONCRETE SIDEWALK 5 INCH	SQ FT	20600	20600
	42400300	PORTLAND CEMENT CONCRETE SIDEWALK 6 INCH	SQ FT	60	60
	42400800	DETECTABLE WARNINGS	SQ FT	40	40
	44000200	DRIVEWAY PAVEMENT REMOVAL	SQ YD	52	52
	60266600	VALVE BOXES TO BE ADJUSTED	EACH	2	2
	60300105	FRAMES AND GRATES TO BE ADJUSTED	EACH	5	5
	67100100	MOBILIZATION	L SUM	1	1
	70102620	TRAFFIC CONTROL AND PROTECTION, STANDARD 701501	L SUM	1	1
	70102640	TRAFFIC CONTROL AND PROTECTION, STANDARD 701801	L SUM	1	1
	X2020410	EARTH EXCAVATION (SPECIAL)	CU YD	792	792
	XX006344	SEEDING (COMPLETE)	SQ YD	1365	1365
	XX008200	STABILIZED DRIVEWAY PAVEMENT	SQ YD	52	52
*	Z0033064	SOLAR EQUIPMENT	EACH	5	5

* - INDICATES SPECIALTY ITEMS

GENERAL NOTES

- BEFORE STARTING ANY EXCAVATION THE CONTRACTOR SHALL CALL "J.U.L.I.E." AT (800) 892-0123 OR 811 AND (312) 744-7000 FOR FIELD LOCATIONS OF BURIED ELECTRIC, TELEPHONE AND GAS UTILITIES. (48 HOUR NOTIFICATION REQUIRED)
- UTILITIES INDICATED ON THE PLANS ARE PROVIDED FOR THE CONTRACTOR'S USE AND ARE BASED UPON INFORMATION AVAILABLE AT THE TIME OF THE ADVERTISEMENT FOR BIDS. THE OWNER AND ENGINEER DO NOT GUARANTEE THE ACCURACY OF UTILITY INFORMATION.
- IT SHALL BE THE CONTRACTOR'S RESPONSIBILITY TO VERIFY ALL DIMENSIONS AND CONDITIONS EXISTING IN THE FIELD PRIOR TO CONSTRUCTION AND ORDERING OF MATERIALS.
- THE THICKNESS OF HMA MIXTURE STATED IN THE SPECIFICATIONS IS THE NOMINAL THICKNESS. DEVIATIONS FROM THE NOMINAL THICKNESS WILL BE PERMITTED WHEN SUCH DEVIATIONS OCCUR DUE TO IRREGULARITIES IN THE EXISTING SURFACE OR BASE ON WHICH THE HMA SURFACE IS PLACED.
- THE REMOVAL AND/OR REPLACEMENT OF ANY DRIVEWAYS, PAVEMENT, CURB, SIDEWALK, ETC. SHALL BE ACCOMPLISHED BY MEANS OF A SAW CUT JOINT, AT THE DIRECTION OF THE ENGINEER. THIS WORK WILL NOT BE PAID FOR SEPARATELY, BUT SHALL BE INCLUDED IN THE UNIT PRICE FOR THE ITEM BEING REMOVED
- ANY LOOSE MATERIAL DEPOSITED IN THE FLOW LINE OF DITCHES, GUTTERS OR OTHER DRAINAGE STRUCTURES SHALL BE REMOVED BY THE END OF EACH DAY BY THE CONTRACTOR AT THEIR EXPENSE.

FILE NAME = 13345-02-QUAN-01 - IDOT P01

USER NAME =	DESIGNED -- ERR	REVISED --
	CHECKED --	REVISED --
PLOT SCALE =	DRAWN -- MED	REVISED --
PLOT DATE = 7-11-14	CHECKED -- AG	REVISED --

STATE OF ILLINOIS
DEPARTMENT OF TRANSPORTATION

OLMSTEAD LANE AND BLACKHAWK DRIVE SAFE ROUTES TO SCHOOL SUMMARY OF QUANTITIES & GENERAL NOTES			F.A.U. RTE.	SECTION	COUNTY	TOTAL SHEETS	SHEET NO.
				12-00020-00-SW	COOK	25	2
SCALE:			SHEET NO. 2 OF 25 SHEETS		STA.	TO STA.	
			FED. ROAD DIST. NO. 1		ILLINOIS	FED. AID PROJECT SRTS-4009(256)	

CONTRACT NO. 61B29

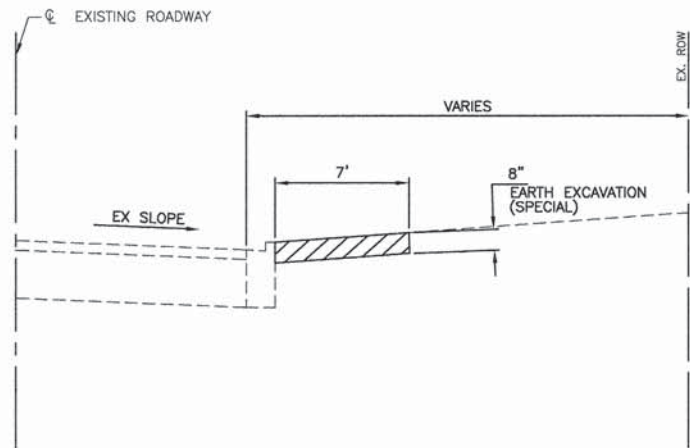

EXISTING TYPICAL SECTION
OLMSTED LANE - STA 104+00 TO 126+44

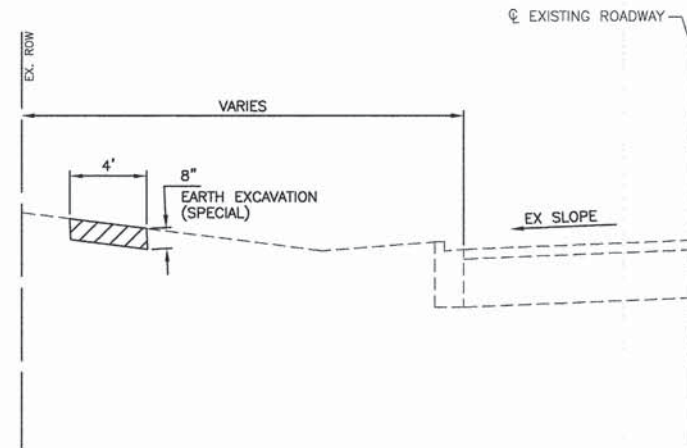

EXISTING TYPICAL SECTION
BLACKHAWK DRIVE - STA. 200+00 TO STA. 210+50

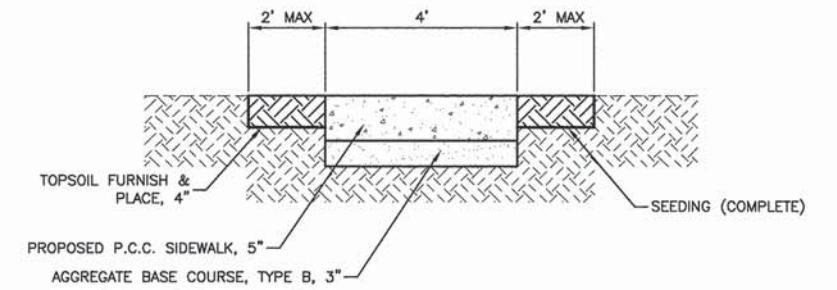

PROPOSED SIDEWALK DETAIL THROUGH PARKWAY (TYP.)
BLACKHAWK DRIVE

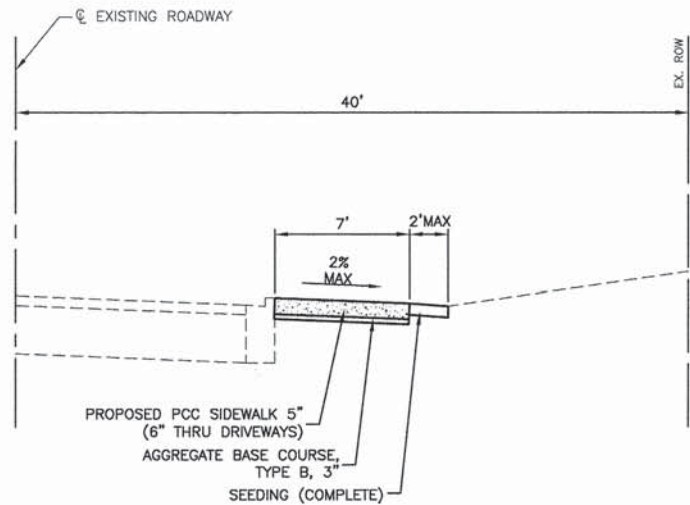

PROPOSED TYPICAL SECTION
OLMSTED LANE - STA 104+00 TO 126+44

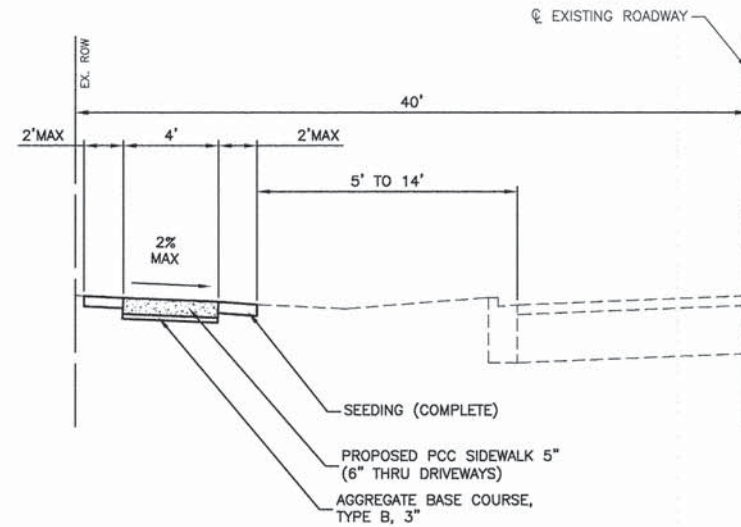

PROPOSED TYPICAL SECTION
BLACKHAWK DRIVE - STA. 200+00 TO STA. 210+50

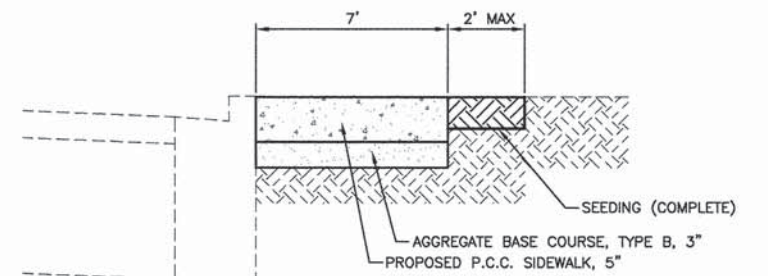

PROPOSED SIDEWALK DETAIL THROUGH PARKWAY (TYP.)
OLMSTED LANE

HOT-MIX ASPHALT MIXTURE REQUIREMENTS

MIXTURE TYPE	AIR VOIDS
STABILIZED DRIVEWAY PAVEMENT	
HOT MIX ASPHALT SURFACE COURSE, MIX "D", N50(IL-9.5mm); 2-1/2"	4% @ 50 Gyr.

NOTE:
THE UNIT WEIGHT USED TO CALCULATE ALL HOT-MIX ASPHALT SURFACE MIXTURE QUANTITIES IS 112 LBS/SY/IN.

THE "AC TYPE" FOR POLYMERIZED HMA MIXES SHALL BE "SBS/SBA PG 76-22" AND FOR NON-POLYMERIZED HMA, THE "AC TYPE" SHALL BE PG 64-22 UNLESS MODIFIED BY DISTRICT ONE SPECIAL PROVISIONS.

FILE NAME = 13345-02-TYPX-01 - TYP01

USER NAME =	DESIGNED -- ERR	REVISED --
	CHECKED --	REVISED --
PLOT SCALE =	DRAWN -- MED	REVISED --
PLOT DATE = 7-11-14	CHECKED -- AG	REVISED --

STATE OF ILLINOIS
DEPARTMENT OF TRANSPORTATION

OLMSTED LANE AND BLACKHAWK DRIVE
SAFE ROUTES TO SCHOOL
TYPICAL CROSS SECTIONS

SCALE: SHEET NO. 3 OF 25 SHEETS STA. TO STA.

F.A.U. RTE.	SECTION	COUNTY	TOTAL SHEETS	SHEET NO.
	12-00020-00-SW	COOK	25	3
FED. ROAD DIST. NO. 1 ILLINOIS FED. AID PROJECT SRTS-4009(256)			CONTRACT NO. 61B29	



DATE	
BY	
PLAN	
DATE	
BY	
PROFILE	
DATE	
BY	

DATE	
BY	
PROFILE	
DATE	
BY	

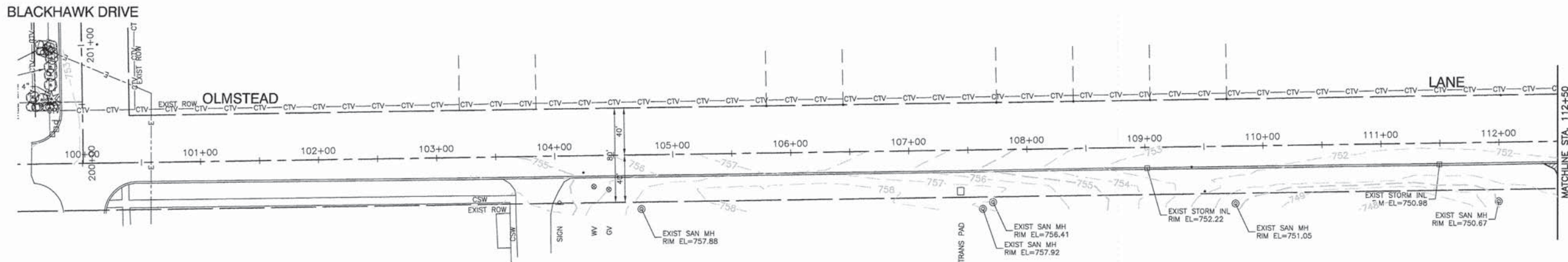

EXISTING CONDITIONS AND REMOVAL PLAN

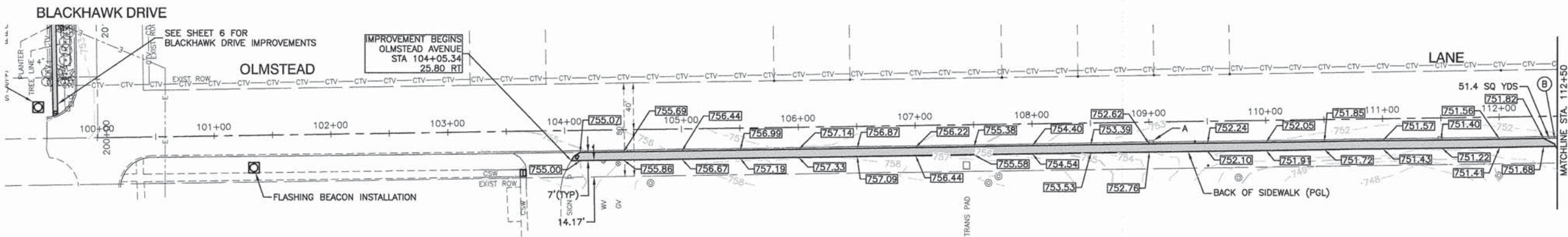

PROPOSED IMPROVEMENT PLAN

BENCH MARK:

NORTH EAST CORNER OF TRANSFORMER PAD SOUTH SIDE OF OLMSTEAD LANE
 STA. 107+78'
 ELEVATION = 757.75'

- LEGEND**
- SIDEWALK REMOVAL
 - DRIVEWAY PAVEMENT REMOVAL
 - PORTLAND CEMENT CONCRETE SIDEWALK, 5" (6" THROUGH DRIVEWAYS) AGGREGATE BASE COURSE, TYPE B, 3"
 - DETECTABLE WARNINGS
 - ADJUST VALVE BOX STRUCTURE ADJUST FRAMES & GRATES
 - STABILIZED DRIVEWAY PAVEMENT
 - PCC DRIVEWAY PAVEMENT, 6"
 - SOLAR FLASHER, TO COMPLY WITH MUTCD STANDARD

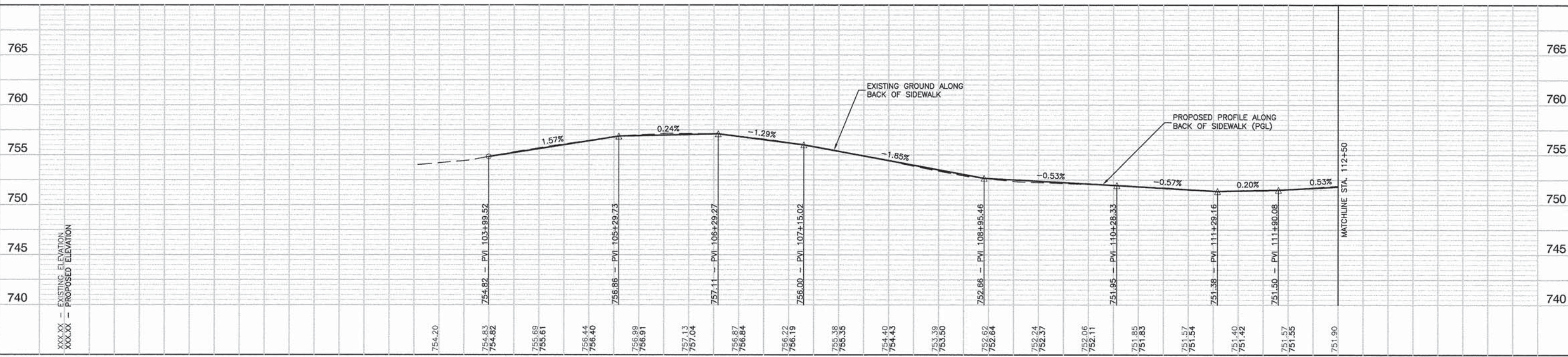

FILE NAME = 13345-02-PLPR-01 - IDOT PLPR01	USER NAME =	DESIGNED - ERR	REVISED -	STATE OF ILLINOIS DEPARTMENT OF TRANSPORTATION	OLMSTEAD LANE SAFE ROUTES TO SCHOOL PLAN & PROFILE		F.A.U. RTE.	SECTION	COUNTY	TOTAL SHEETS	SHEET NO.	
		CHECKED -	REVISED -		SCALE: H 1"=50' V 1"=5'	SHEET NO. 4	OF 25 SHEETS	STA.	TO STA.	COOK	25	4
		DRAWN - MED	REVISED -		CONTRACT NO. 61B29							
		CHECKED - AG	REVISED -		FED. ROAD DIST. NO. 1 ILLINOIS FED. AID PROJECT SRTS-4009(258)							

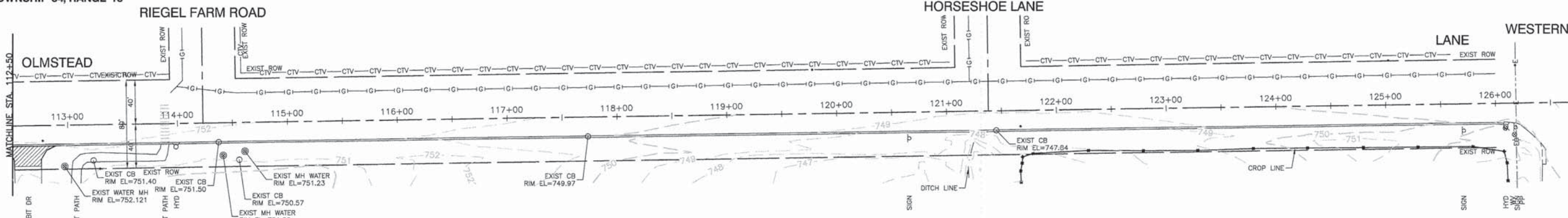

EXISTING CONDITIONS AND REMOVAL PLAN

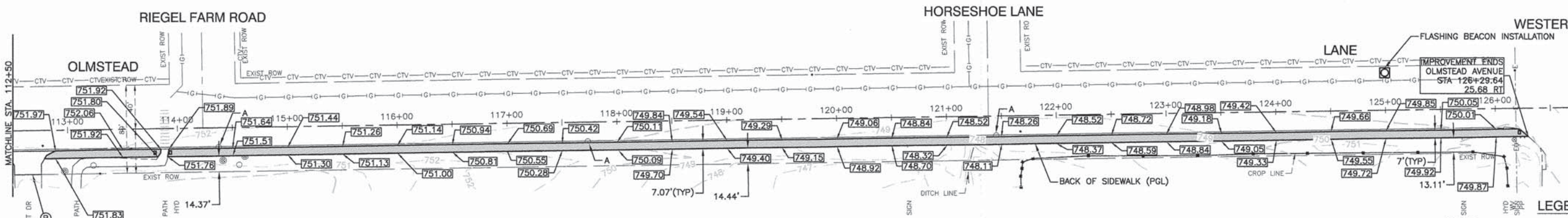

PROPOSED IMPROVEMENT PLAN

- LEGEND**
- SIDEWALK REMOVAL
 - DRIVEWAY PAVEMENT REMOVAL
 - PORTLAND CEMENT CONCRETE SIDEWALK, 5" (6" THROUGH DRIVEWAYS) AGGREGATE BASE COURSE, TYPE B, 3"
 - DETECTABLE WARNINGS
 - ADJUST VALVE BOX STRUCTURE ADJUST FRAMES & GRATES
 - STABILIZED DRIVEWAY PAVEMENT
 - PCC DRIVEWAY PAVEMENT, 6"
 - SOLAR FLASHER, TO COMPLY WITH MUTCD STANDARD

BENCH MARK:
 WATER HYDRANT AT SOUTHWEST CORNER OF RIEGEL FARM ROAD AND OLMSTEAD AVENUE
 ELEVATION = 751.55'

DATE	
BY	
PLAN	SURVEYED
	ALIGNED
	CHECKED
	RT. OF WAY CHECKED
	NO. DOD FILE NAME

DATE	
BY	
PROFILE	SURVEYED
	GRADES CHECKED
	B.M. NOTED

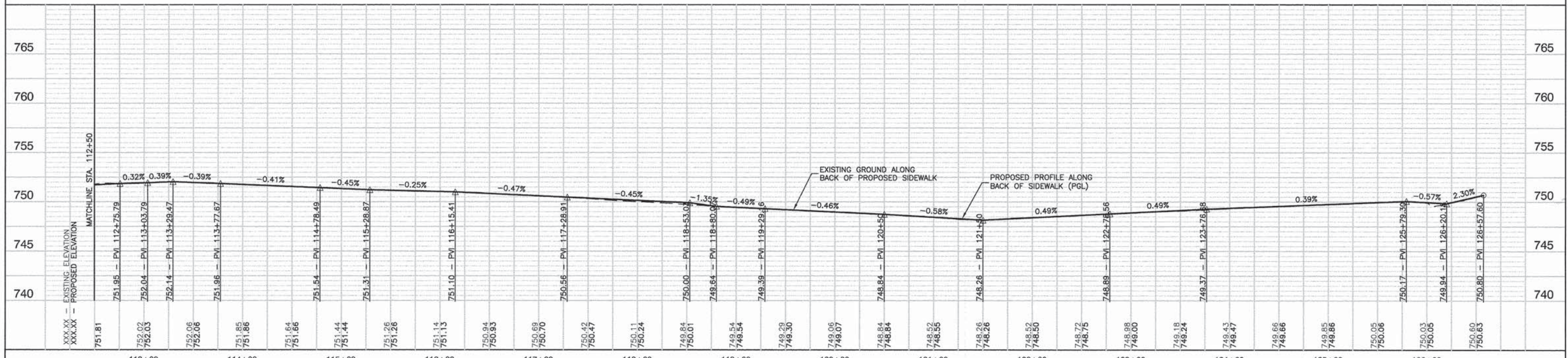

FILE NAME = 13345-02-PLPR-01 - IDOT PLPR02	USER NAME =	DESIGNED -- ERR	REVISED --	STATE OF ILLINOIS DEPARTMENT OF TRANSPORTATION	OLMSTEAD LANE SAFE ROUTES TO SCHOOL PLAN & PROFILE			F.A.U. RTE.	SECTION	COUNTY	TOTAL SHEETS	SHEET NO.
	PLOT SCALE =	CHECKED --	REVISED --		SCALE: H 1"=50' V 1"=5'			12-00020-00-SW	COOK	25	5	
	PLOT DATE = 7-11-14	DRAWN -- MED	REVISED --		SHEET NO. 5 OF 25 SHEETS			STA.	TO STA.	CONTRACT NO. 61B29		
		CHECKED -- AG	REVISED --		SCALE: H 1"=50' V 1"=5'			FED. ROAD DIST. NO. 1	ILLINOIS	FED. AID PROJECT	SRTS-4009(256)	

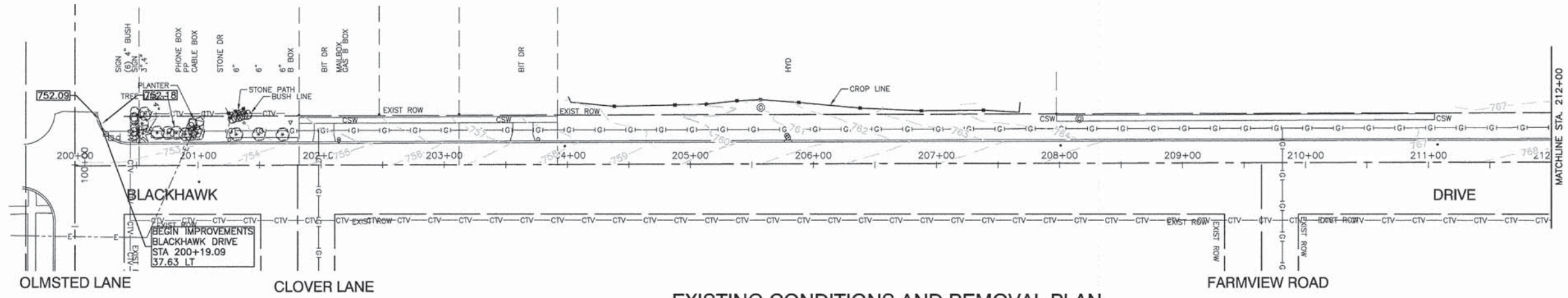

EXISTING CONDITIONS AND REMOVAL PLAN

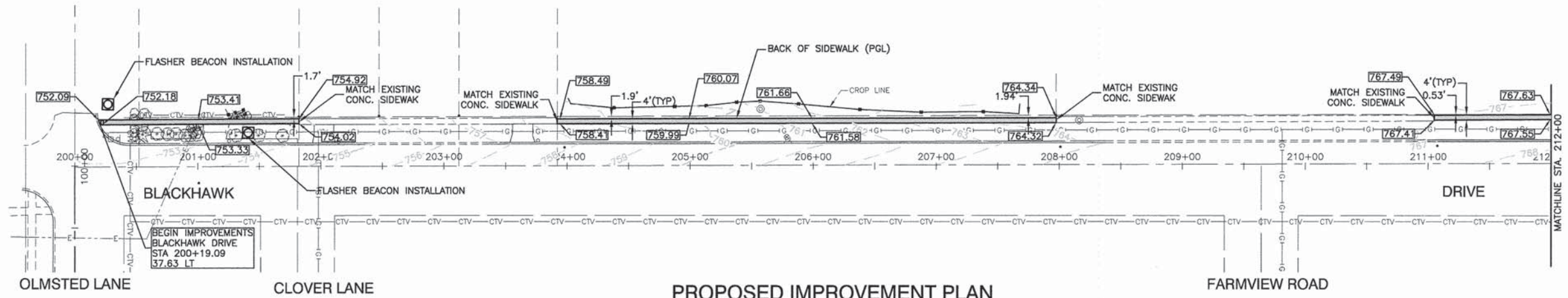

PROPOSED IMPROVEMENT PLAN

LEGEND

- SIDEWALK REMOVAL
- DRIVEWAY PAVEMENT REMOVAL
- PORTLAND CEMENT CONCRETE SIDEWALK, 5" (6" THROUGH DRIVEWAYS) AGGREGATE BASE COURSE, TYPE B, 3"
- DETECTABLE WARNINGS
- ADJUST VALVE BOX STRUCTURE ADJUST FRAMES & GRATES
- STABILIZED DRIVEWAY PAVEMENT
- PCC DRIVEWAY PAVEMENT, 6"
- SOLAR FLASHER, TO COMPLY WITH MUTCD STANDARD

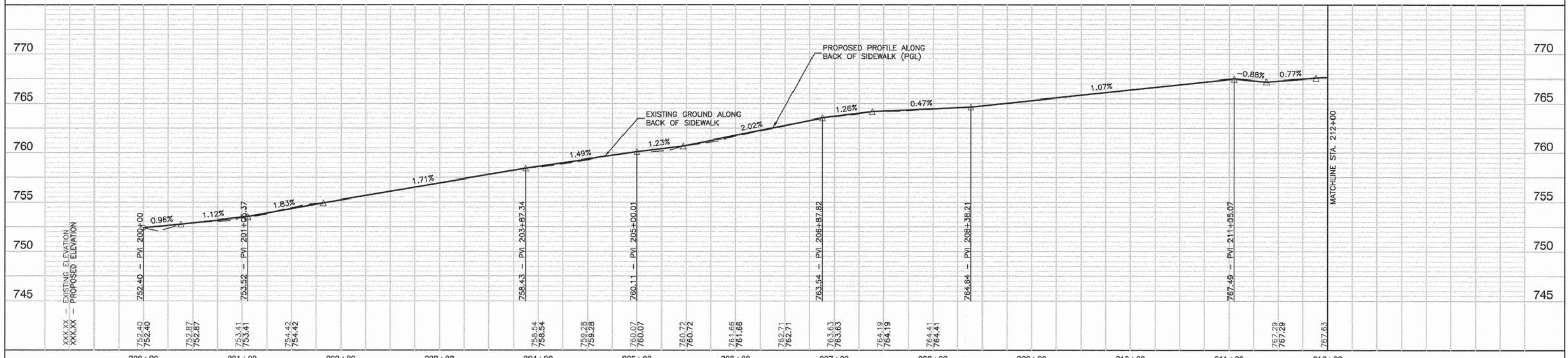

FILE NAME = 13845-02-PLPR-01 - IDOT PLPR03	USER NAME =	DESIGNED -- ERR	REVISED --	STATE OF ILLINOIS DEPARTMENT OF TRANSPORTATION	BLACKHAWK DRIVE SAFE ROUTES TO SCHOOL PLAN & PROFILE			F.A.U. RTE.	SECTION	COUNTY	TOTAL SHEETS	SHEET NO.
	PLOT SCALE =	CHECKED --	REVISED --		12-00020-00-SW	COOK	25	6				
	PLOT DATE = 7-11-14	DRAWN -- MED	REVISED --		SCALE: H 1"=50' V 1"=5'			SHEET NO. 6 OF 25 SHEETS		STA. TO STA.		
		CHECKED -- AG	REVISED --		FED. ROAD DIST. NO. 1 ILLINOIS			FED. AID PROJECT SRTS-4009(256)				

PLAN

DATE	BY

SURVEYED
ALIGNMENT CHECKED
RT. OF WAY CHECKED
NO. _____
DOD FILE NAME

PROFILE

DATE	BY

SURVEYED
GRADES CHECKED
B.M. NOTED



DATE	
BY	
SUBMITTED	
PLANNED	
ALIGNED	
CHECKED	
FILE NAME	

DATE	
BY	
SUBMITTED	
PLANNED	
GRADES	
CHECKED	
B.M. NOTED	

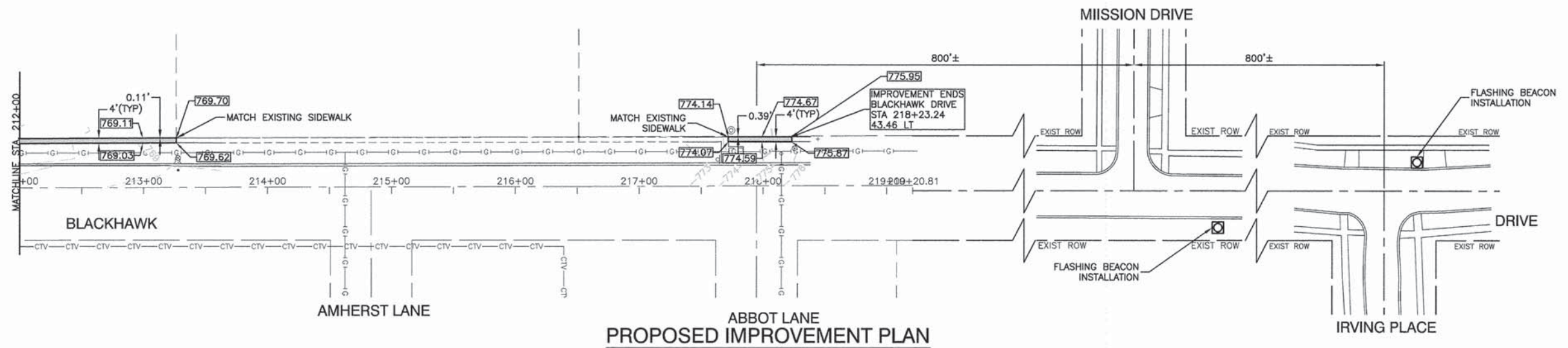
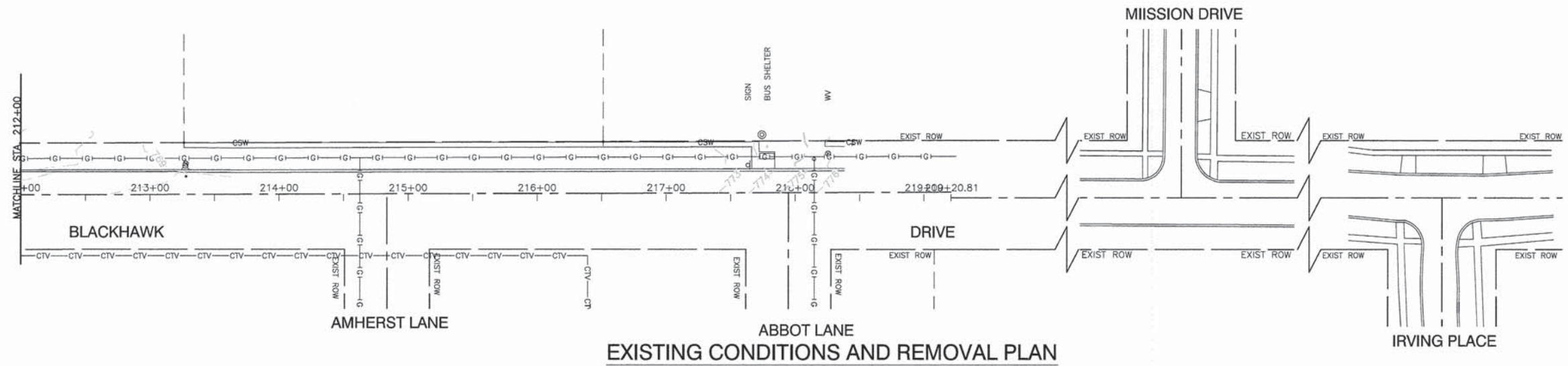

LEGEND

- SIDEWALK REMOVAL
- DRIVEWAY PAVEMENT REMOVAL
- PORTLAND CEMENT CONCRETE SIDEWALK, 5" (6" THROUGH DRIVEWAYS) AGGREGATE BASE COURSE, TYPE B, 3"
- DETECTABLE WARNINGS
- ADJUST VALVE BOX STRUCTURE ADJUST FRAMES & GRATES
- STABILIZED DRIVEWAY PAVEMENT
- PCC DRIVEWAY PAVEMENT, 6"
- SOLAR FLASHER, TO COMPLY WITH MUTCD STANDARD

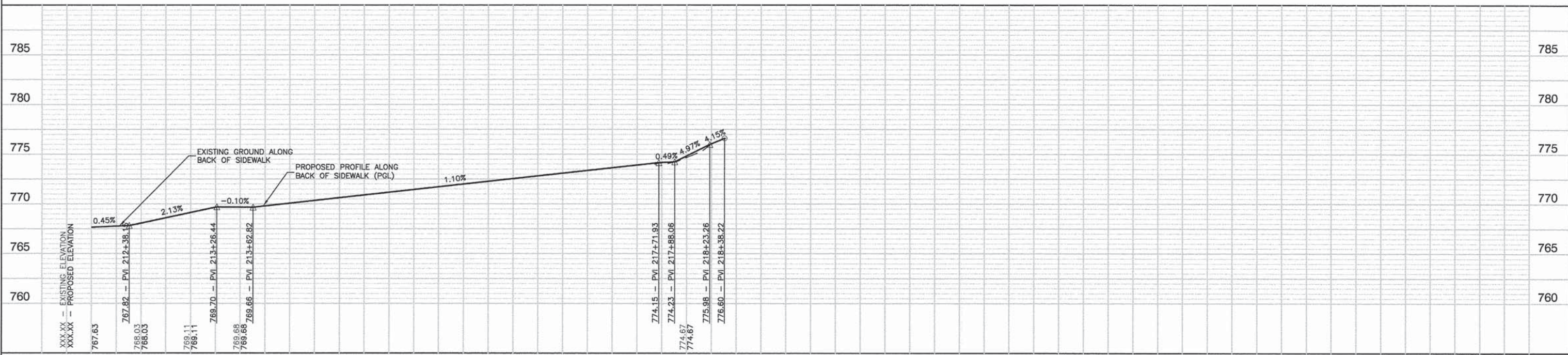

FILE NAME = 13345-02-PLPR01 - IDOT PLPR04

USER NAME =	DESIGNED - ERR	REVISED -
PLOT SCALE =	CHECKED -	REVISED -
PLOT DATE = 7-11-14	DRAWN - MED	REVISED -
	CHECKED - AG	REVISED -

STATE OF ILLINOIS
DEPARTMENT OF TRANSPORTATION

BLACKHAWK DRIVE SAFE ROUTES TO SCHOOL PLAN & PROFILE		F.A.U. RTE.	SECTION	COUNTY	TOTAL SHEETS	SHEET NO.
			12-00020-00-SW	COOK	25	7
SCALE: H 1"=50' V 1"=5'		SHEET NO. 7 OF 25 SHEETS		STA. TO STA.		

FED. ROAD DIST. NO. 1	ILLINOIS	FED. AID PROJECT	SRTS-4009(250)
-----------------------	----------	------------------	----------------

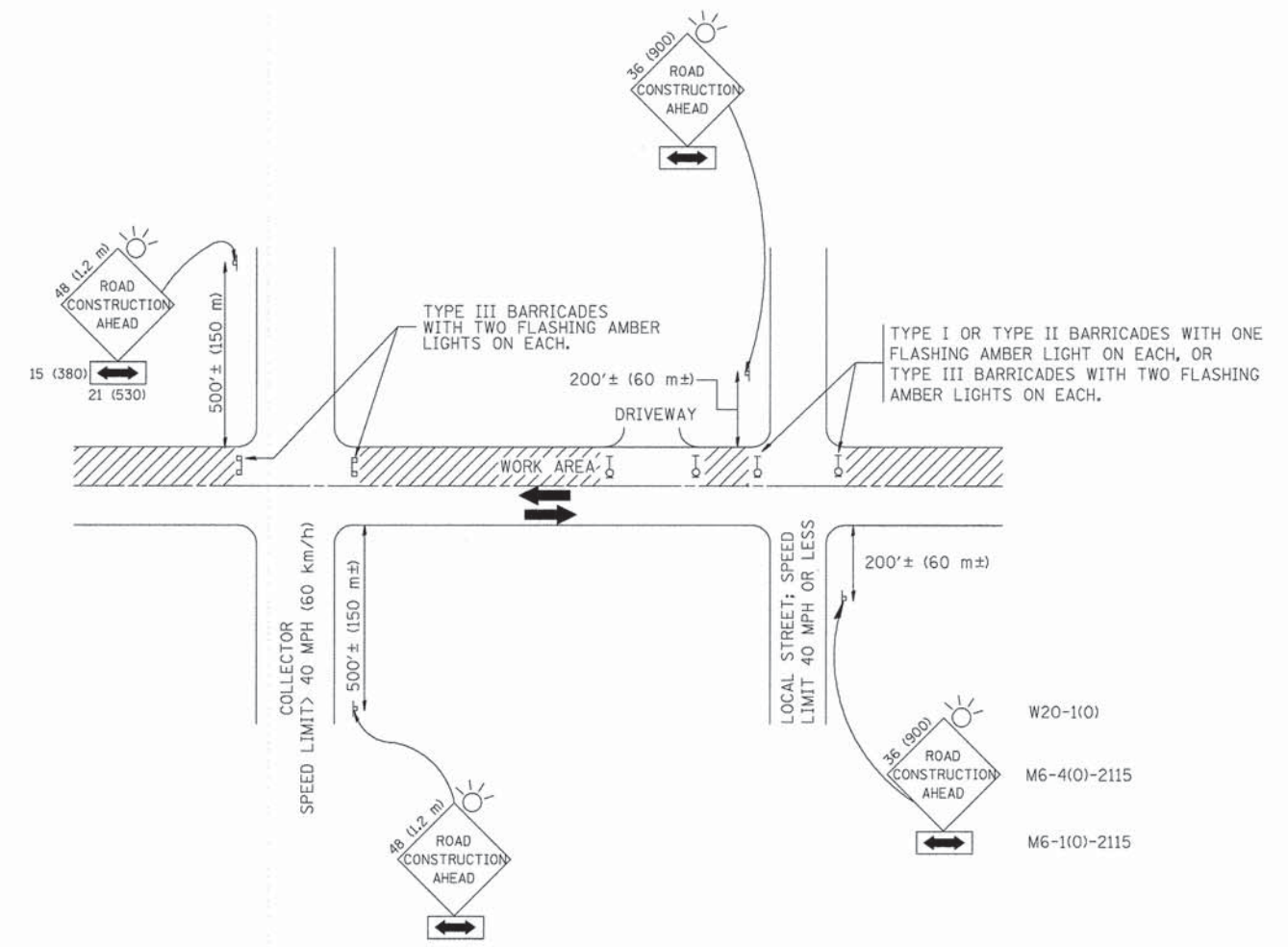

TRAFFIC CONTROL AND PROTECTION FOR SIDE ROADS, INTERSECTIONS, AND DRIVEWAYS

NOTES:

- A. FOR NO LANE RESTRICTION ON THE SIDE ROAD OR DRIVEWAYS
 1. SIDE ROAD WITH A SPEED LIMIT OF 40 MPH (60 km/h) OR LESS AS SHOWN ON THE DRAWING AND AS DIRECTED BY THE ENGINEER:
 - a) ONE **ROAD CONSTRUCTION AHEAD** SIGN 36 x 36 (900x900) WITH A FLASHER AND FLAG MOUNTED ON IT APPROXIMATELY 200' (60 m) IN ADVANCE OF THE MAIN ROUTE.
 - b) THE CLOSED PORTION OF THE MAIN ROUTE SHALL BE PROTECTED BY BLOCKING WITH TYPE I, TYPE II OR TYPE III BARRICADES, 1/3 OF THE CROSS SECTION OF THE CLOSED PORTION.
 2. SIDE ROAD WITH A SPEED LIMIT GREATER THAN 40 MPH (60 km/h) AS SHOWN ON THE DRAWING AND AS DIRECTED BY THE ENGINEER:
 - a) ONE **ROAD CONSTRUCTION AHEAD** SIGN 48 x 48 (1.2 m x 1.2 m) WITH A FLASHER MOUNTED ON IT APPROXIMATELY 500' (150 m) IN ADVANCE OF THE MAIN ROUTE.
 - b) THE CLOSED PORTION OF THE MAIN ROUTE SHALL BE PROTECTED BY BLOCKING WITH TYPE III BARRICADES, 1/2 OF THE CROSS SECTION OF THE CLOSED PORTION.
 3. WHEN THE SIDE ROAD LIES BETWEEN THE BEGINNING OF THE MAINLINE SIGNING AND THE WORK ZONE, A SINGLE HEADED ARROW (M6-1) SHALL BE USED IN LIEU OF THE DOUBLE HEADED ARROW (M6-4).
- B. FOR A LANE CLOSURE ON A SIDE ROAD OR DRIVEWAY:

USE APPLICABLE PORTIONS OF THE TYPICAL APPLICATION OF TRAFFIC CONTROL DEVICES (STD. 701501, STD. 701606 OR THE APPROPRIATE STANDARD). THE SPACING OF SIGNS AND BARRICADES SHALL BE ADJUSTED FOR FIELD CONDITIONS AS DIRECTED BY THE ENGINEER. THE DIRECTIONAL ARROW SHALL BE COVERED OR REMOVED WHEN NO LONGER CONSISTENT WITH THE SIDE ROAD LANE CLOSURE.
- C. ADVANCE WARNING SIGNS ARE TO BE OMITTED ON DRIVEWAY UNLESS OTHERWISE NOTED.
- D. THE TRAFFIC CONTROL AND PROTECTION FOR SIDE ROADS, INTERSECTIONS, AND DRIVEWAYS SHALL BE INCIDENTAL TO THE COST OF SPECIFIED TRAFFIC CONTROL STANDARDS OR ITEMS.

All dimensions are in millimeters (inches) unless otherwise shown.

FILE NAME = 13345-02-DTLS-01 - TC-10	USER NAME = geglianobt	DESIGNED -- LHA	REVISED -- J. OBERLE 10-18-95
	PLOT SCALE = 58.000 ' / IN.	CHECKED --	REVISED -- A. HOUSEH 03-06-96
	PLOT DATE = 1/4/2008	DRAWN --	REVISED -- A. HOUSEH 10-15-96
		CHECKED -- 06-89	REVISED -- T. RAMMACHER 01-06-00

STATE OF ILLINOIS
DEPARTMENT OF TRANSPORTATION

TRAFFIC CONTROL AND PROTECTION FOR SIDE ROADS, INTERSECTIONS, AND DRIVEWAYS		F.A.U. RTE.	SECTION	COUNTY	TOTAL SHEETS	SHEET NO.
		---	12-00020-00-SW	COOK	25	8
SCALE:		SHEET NO. 8 OF 25 SHEETS		STA.	TO STA.	
		FED. ROAD DIST. NO. 1	ILLINOIS	FED. AID PROJECT	SRTS-4009(256)	

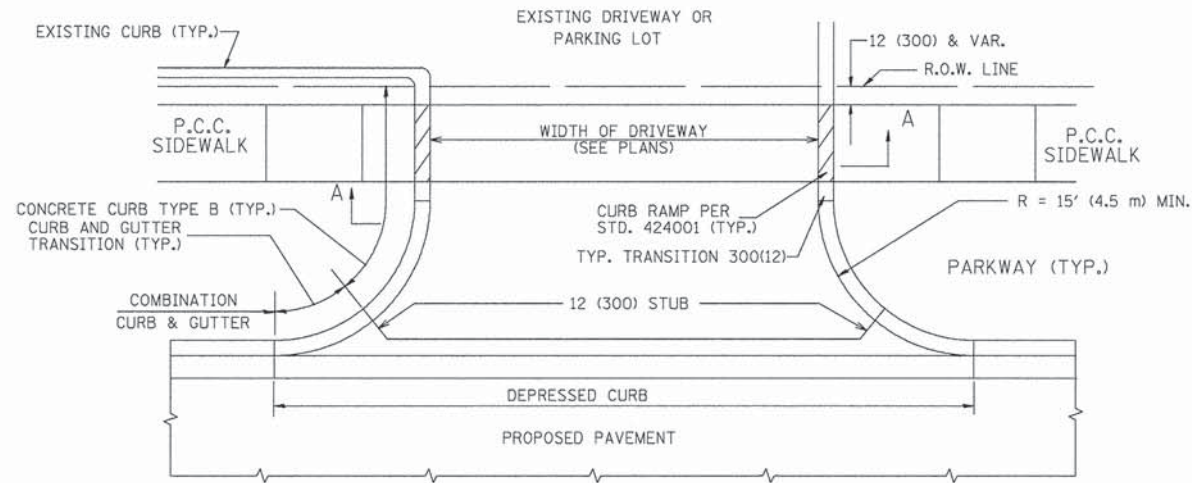

WITH CONCRETE CURB, TYPE B

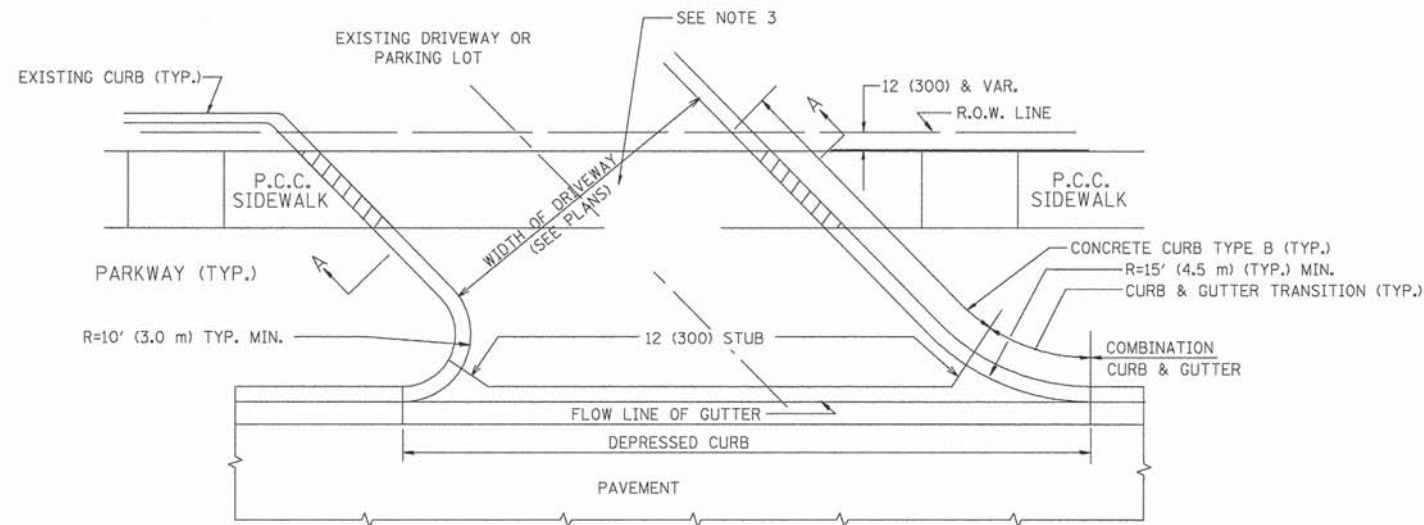

WITH CONCRETE CURB, TYPE B

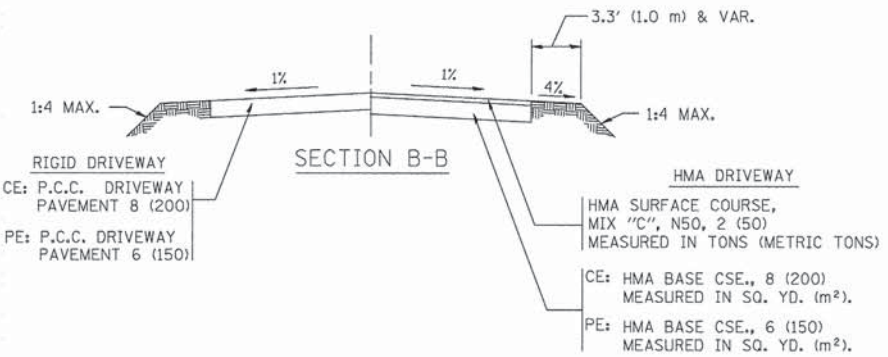
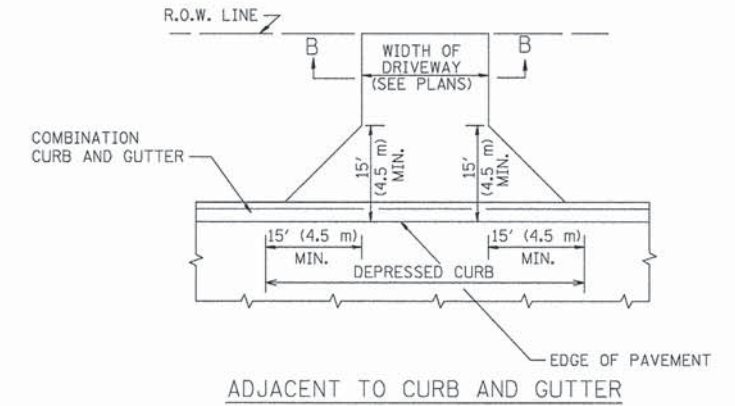
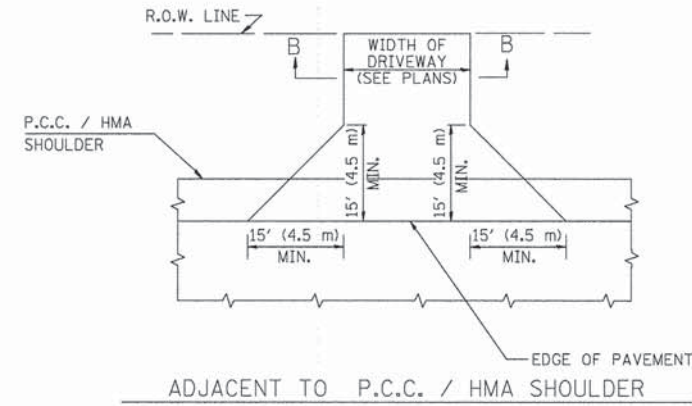

RURAL FIELD ENTRANCE (FE)
 HMA SURFACE COURSE,
 MIX "C", N50, 2 (50)
 MEASURED IN TONS (METRIC TONS)
 AGGREGATE BASE CSE., TYPE B, 8 (200)
 MEASURED IN SQ. YD. (m²).

GENERAL NOTES:

DRIVEWAY SLOPES, LOCATIONS, & GEOMETRIC LAYOUT SHALL BE IN ACCORDANCE WITH THE LATEST EDITION OF THE "HANDBOOK FOR POLICY ON PERMITS FOR ACCESS DRIVEWAYS TO STATE HIGHWAYS". FOR FURTHER LAYOUT REQUIREMENTS, REFER TO ILLUSTRATIONS IN THE PERMIT HANDBOOK. DRIVEWAYS SHALL BE REPLACED IN KIND, UNLESS OTHERWISE NOTED ON THE PLANS.

COMMERCIAL DRIVEWAYS SHALL BE CONSTRUCTED WITH CONCRETE CURB, TYPE B RETURNS EXCEPT WHEN THE SIDEWALK EDGE IS 4 FEET (1.2 METERS) OR LESS FROM THE BACK OF CURB, CONSTRUCT A FLARE DRIVEWAY WITHOUT CURB.

THE RESIDENT ENGINEER SHALL CONTACT THE TRAFFIC PERMIT OFFICE AT 847/ 705-4131 FOR ANY QUESTIONS ON DRIVEWAYS SHOWN IN THE PLANS; SPECIFICALLY IN REFERENCE TO ADDITIONAL AND/OR RELOCATION/REMOVAL OF A DRIVEWAY.

COMBINATION CONCRETE CURB & GUTTER SHALL BE MEASURED STRAIGHT ACROSS THE DRIVEWAY. NO ADDITIONAL COMPENSATION WILL BE ALLOWED FOR THE CURB & GUTTER TRANSITION.

1 (25) PREFORMED EXPANSION JOINT FILLER WILL NOT BE PAID SEPARATELY, BUT SHALL BE CONSIDERED INCLUDED IN THE COST OF THE P.C.C. DRIVEWAY PAVEMENT OR P.C.C. SIDEWALK.

WHEN THE P.C.C. SIDEWALK EXTENDS THROUGH THE DRIVEWAY, THE THICKNESS OF THE SIDEWALK IN THE DRIVEWAY AREA SHALL BE THE SAME AS THE DRIVEWAY THICKNESS. SIDEWALK WILL BE PAID FOR AS P.C.C. SIDEWALK OF THE THICKNESS SPECIFIED. SIDEWALK CROSS SLOPE THRU DRIVEWAY AREA TO BE A MAXIMUM OF 1:50.

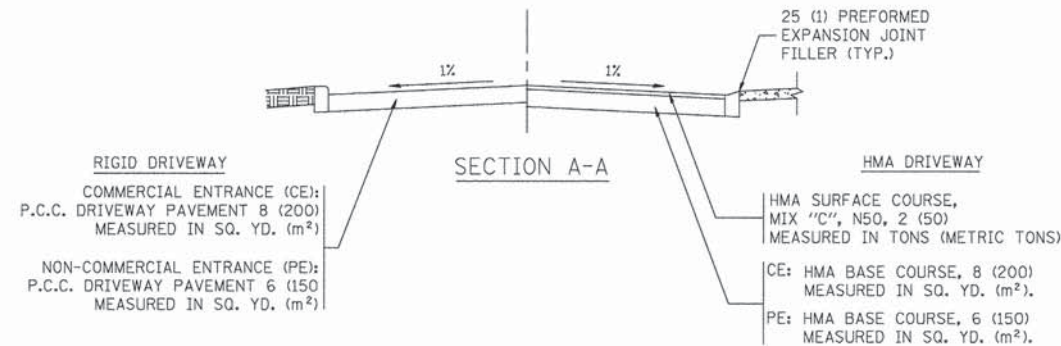

FILE NAME = 13345-02-DTLS-01 - BD-01

USER NAME = gegl.enobt

DESIGNED -- LHA

REVISED -- J. OBERLE 10-18-95

CHECKED --

CHECKED --

REVISED -- A. HOUSEH 03-06-96

PLOT SCALE = 50,000' / 1" =

DRAWN --

REVISED -- A. HOUSEH 10-15-96

PLOT DATE = 1/4/2008

CHECKED -- 06-89

REVISED -- T. RAMMACH 01-06-00

STATE OF ILLINOIS
 DEPARTMENT OF TRANSPORTATION

DRIVEWAY DETAILS - DISTANCE BETWEEN R.O.W.
 AND FACE OF CURB & EDGE OF SHOULDER >= 15' (4.5 m)

SCALE: SHEET NO. 9 OF 25 SHEETS STA. TO STA.

F.A.U. RTE.	SECTION	COUNTY	TOTAL SHEETS	SHEET NO.
	12-00020-00-SW	COOK	25	9
BD0156-07 (BD-01)				
FED. ROAD DIST. NO. 1 ILLINOIS			FED. AID PROJECT SRTS-4009(256)	

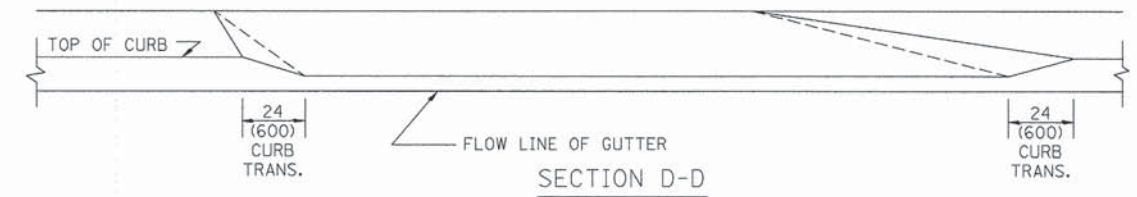
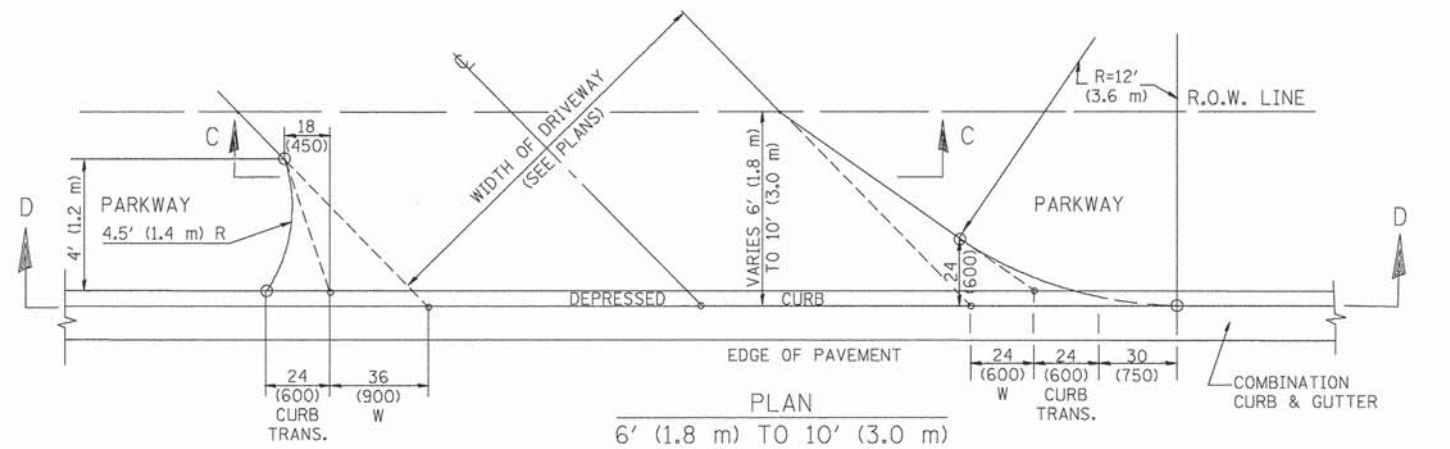
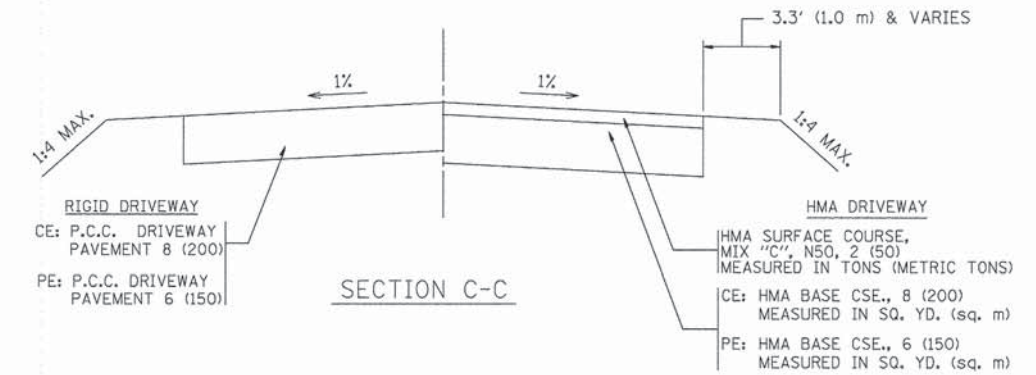
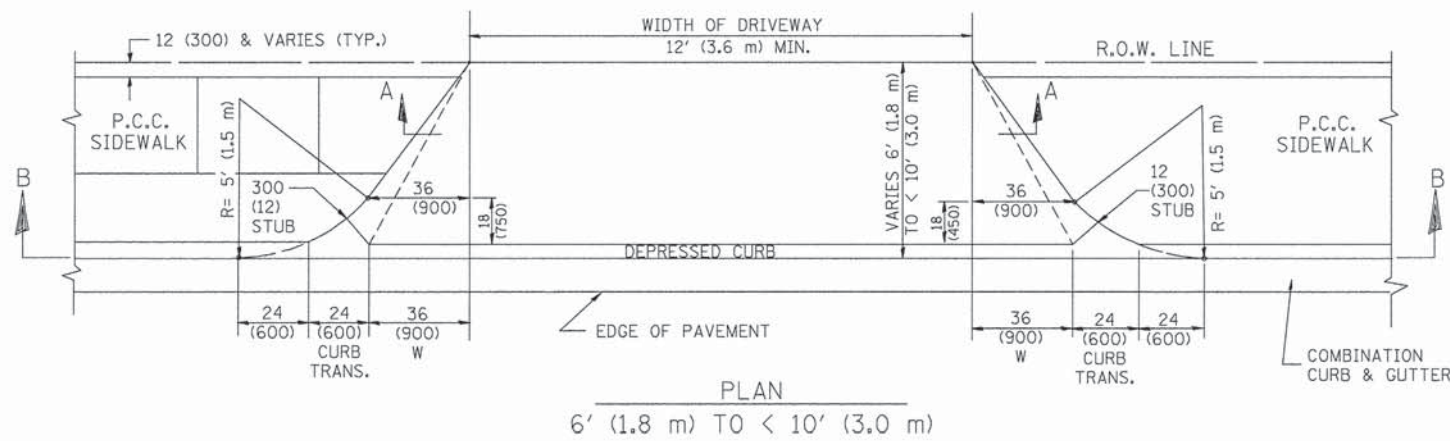
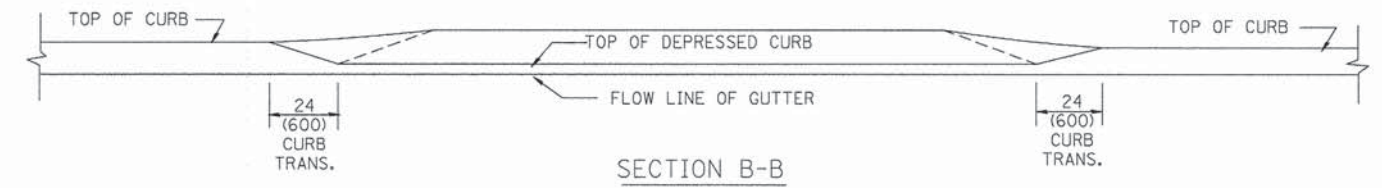
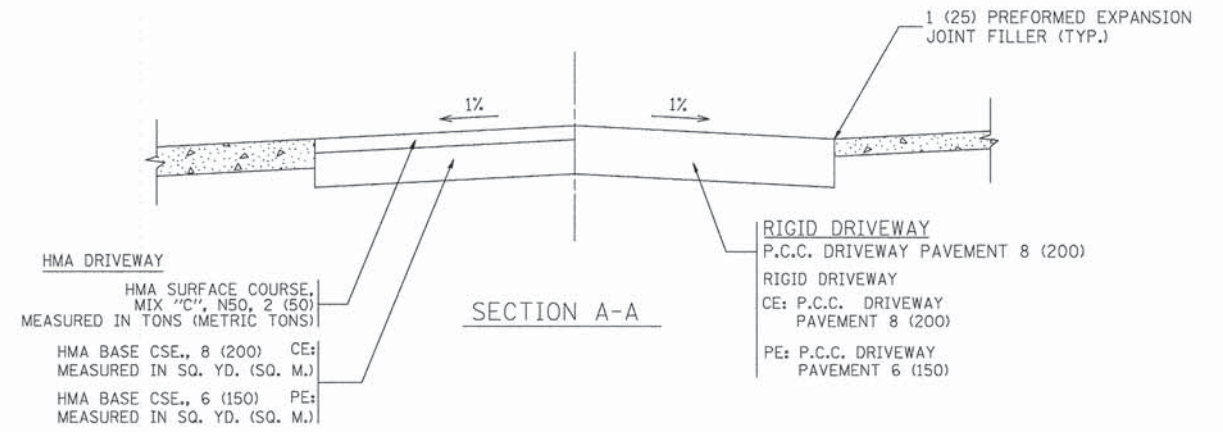
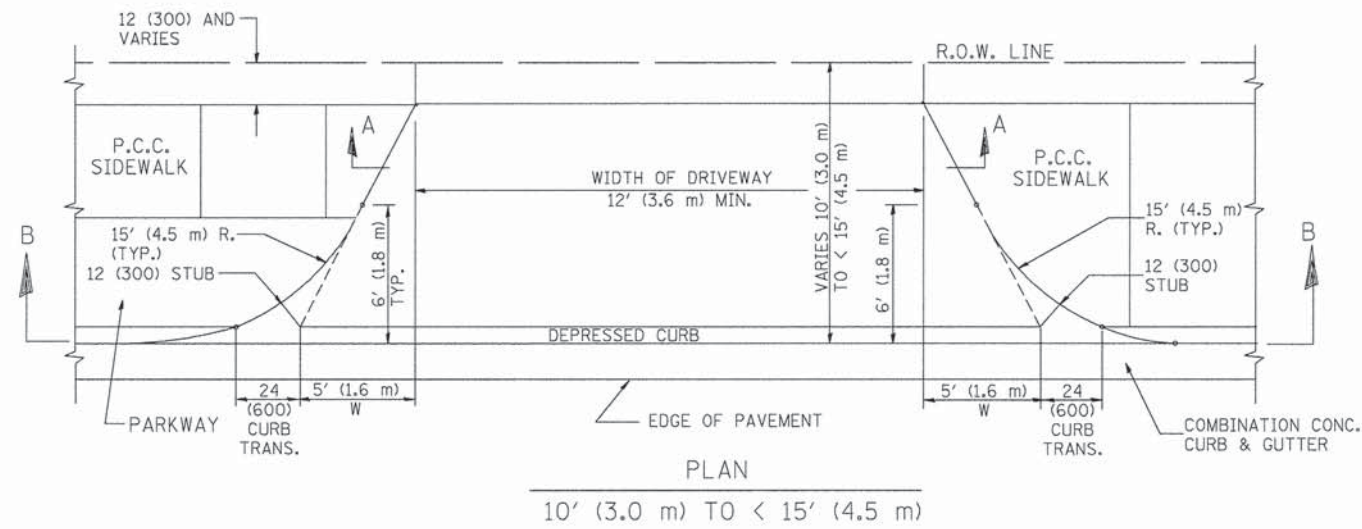

GENERAL NOTES

DRIVEWAY SLOPES, LOCATIONS, & GEOMETRIC LAYOUT SHALL BE IN ACCORDANCE WITH THE LATEST EDITION OF THE "HANDBOOK FOR POLICY ON PERMITS FOR ACCESS DRIVEWAYS TO STATE HIGHWAYS". FOR FURTHER LAYOUT REQUIREMENTS, REFER TO ILLUSTRATION 10 IN THE PERMIT HANDBOOK. WHERE SIDEWALKS EXIST, DRIVEWAYS SHALL BE REPLACED WITH RIGID PAVEMENT. WHERE NO SIDEWALKS EXIST, DRIVEWAYS SHALL BE REPLACED IN KIND. SIDEWALK CROSS SLOPE THRU DRIVEWAY AREA TO BE A MAXIMUM OF 1:50.

WHEN THE DISTANCE BETWEEN R.O.W. AND THE BACK OF CURB IS EQUAL TO OR LESS THAN 8' (2.4 m), THE P.C.C. SIDEWALK SHALL EXTEND TO THE BACK OF CURB.

THE RESIDENT ENGINEER SHALL CONTACT THE TRAFFIC PERMIT OFFICE AT 847/ 705-4131 FOR ANY QUESTIONS ON DRIVEWAYS SHOWN IN THE PLANS; SPECIFICALLY IN REFERENCE TO ADDITIONAL AND/OR RELOCATION/REMOVAL OF A DRIVEWAY.

COMBINATION CONCRETE CURB & GUTTER SHALL BE MEASURED STRAIGHT ACROSS THE DRIVEWAY. NO ADDITIONAL COMPENSATION WILL BE ALLOWED FOR THE CURB & GUTTER TRANSITION.

THE 1 (25) PREFORMED EXPANSION JOINT FILLER WILL NOT BE PAID SEPARATELY, BUT SHALL BE CONSIDERED INCLUDED IN THE COST OF THE P.C.C. DRIVEWAY PAVEMENT OR P.C.C. SIDEWALK.

"W" VARIES FROM 36 (900) TO 5' (1.5 m) PROPORTIONAL TO THE LENGTH (L), FROM 6' (1.8 m) TO 10' (3 m).

ALL DIMENSIONS ARE IN INCHES (MILLIMETERS) UNLESS OTHERWISE NOTED.

FILE NAME = 13345-02-DTLS-01 - BD-02

USER NAME = geglanoht

DESIGNED - LHA

REVISED - J. OBERLE 10-18-95

CHECKED -

REVISOR - A. HOUSEH 03-06-96

REVISED - A. HOUSEH 10-15-96

PLOT SCALE = 5/8" = 1' / IN.

DRAWN -

REVISED - T. RAMMACHER 01-06-00

PLOT DATE = 1/4/2008

CHECKED - 06-89

REVISED -

STATE OF ILLINOIS
DEPARTMENT OF TRANSPORTATION

DRIVEWAY DETAILS
DISTANCE BETWEEN ROW AND FACE OF CURB < 15' (4.5 m)

SCALE: SHEET NO. 10 OF 25 SHEETS STA. TO STA.

F.A.U. RTE.	SECTION	COUNTY	TOTAL SHEETS	SHEET NO.
12-00020-00-SW	COOK	25	10	
BD400-02 (BD-02)		CONTRACT NO. 61B29		
FED. ROAD DIST. NO. 1 ILLINOIS		FED. AID PROJECT SRTS-4009(256)		

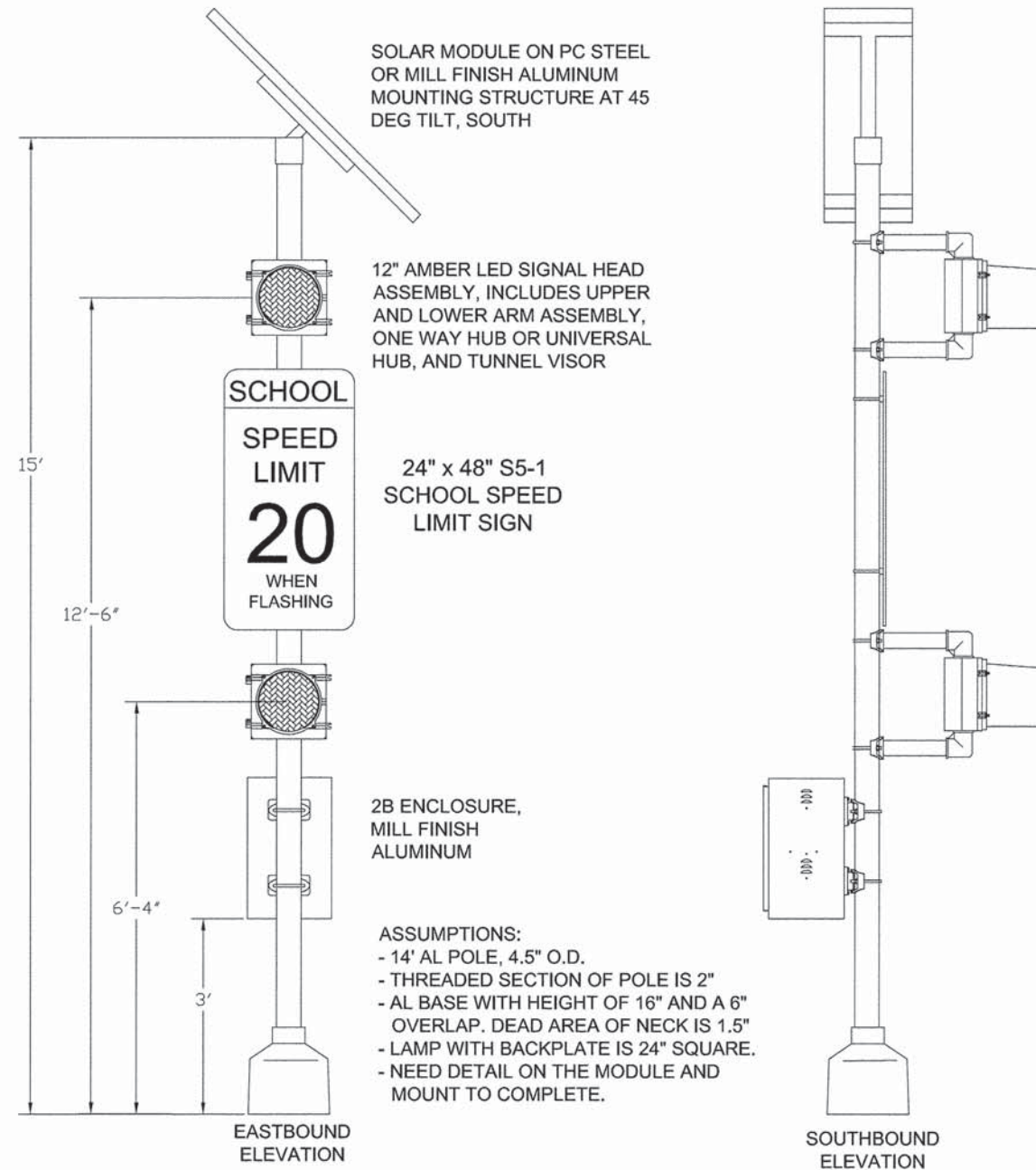

FILE NAME = 13345-02-DTLS-01 - IDOT P01

USER NAME =	DESIGNED — ERR	REVISED —
	CHECKED —	REVISED —
PLOT SCALE =	DRAWN — ACAD	REVISED —
PLOT DATE = 7-11-14	CHECKED — ACAD	REVISED —

STATE OF ILLINOIS
DEPARTMENT OF TRANSPORTATION

SAFE ROUTES TO SCHOOL OLMSTEAD LANE AND BLACKHAWK DRIVE SAFETY FLASHER DETAILS	
SCALE: —	SHEET NO. 11 OF 25 SHEETS STA. TO STA.

F.A.U. RTE.	SECTION	COUNTY	TOTAL SHEETS	SHEET NO.
—	12-00020-00-SW	COOK	25	11
CONTRACT NO. 61B29				
FED. ROAD DIST. NO. 1 ILLINOIS FED. AID PROJECT SRTS-4009(256)				

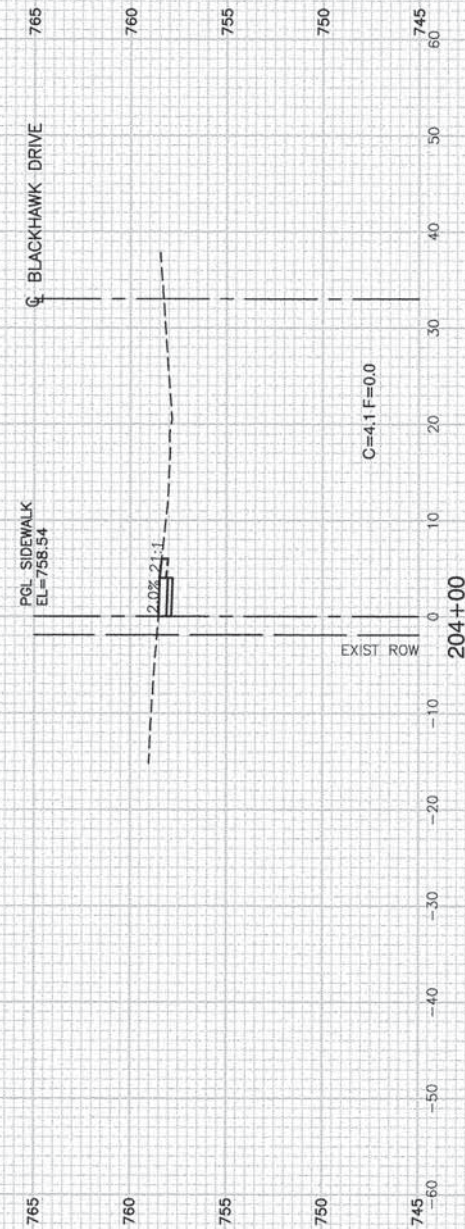
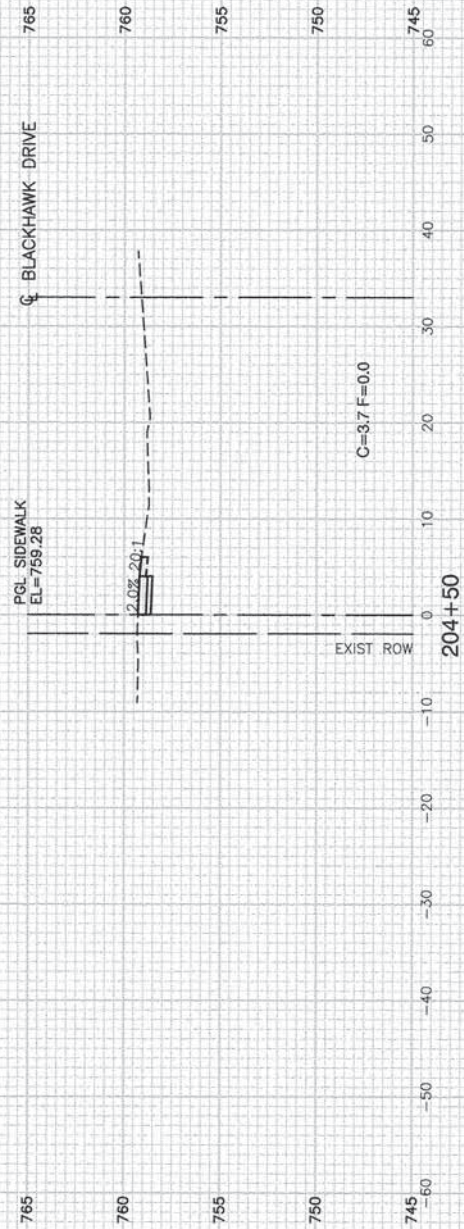
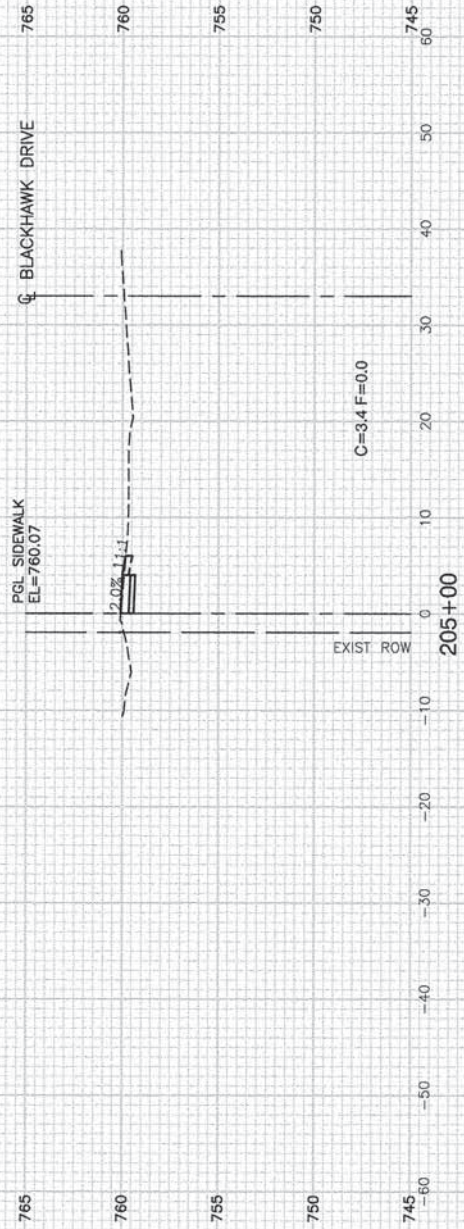

FILE NAME = 13345-02-XSECT-01 - IDOT P01

USER NAME =
 PLOT SCALE =
 PLOT DATE = 7-11-14

DESIGNED -- ERR
 CHECKED --
 DRAWN -- ACAD
 CHECKED -- ACAD

REVISED --
 REVISED --
 REVISED --
 REVISED --

STATE OF ILLINOIS
 DEPARTMENT OF TRANSPORTATION

OLMSTEAD LANE AND BLACKHAWK DRIVE
 SAFE ROUTES TO SCHOOL
 BLACKHAWK DRIVE CROSS SECTIONS

F.A.U. RTE.	SECTION	COUNTY	TOTAL SHEETS	SHEET NO.
---	12-00020-00-SW	COOK	25	12
CONTRACT NO. 61B29				
FED. ROAD DIST. NO. 1 ILLINOIS FED. AID PROJECT SRTS-4009(256)				

SCALE: SHEET NO. 12 OF 25 SHEETS STA. TO STA.

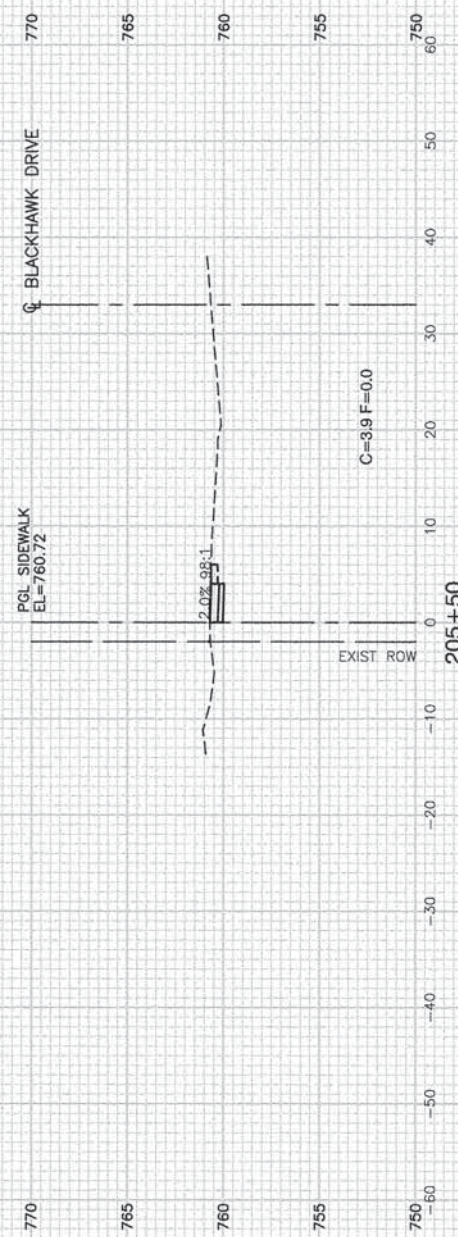
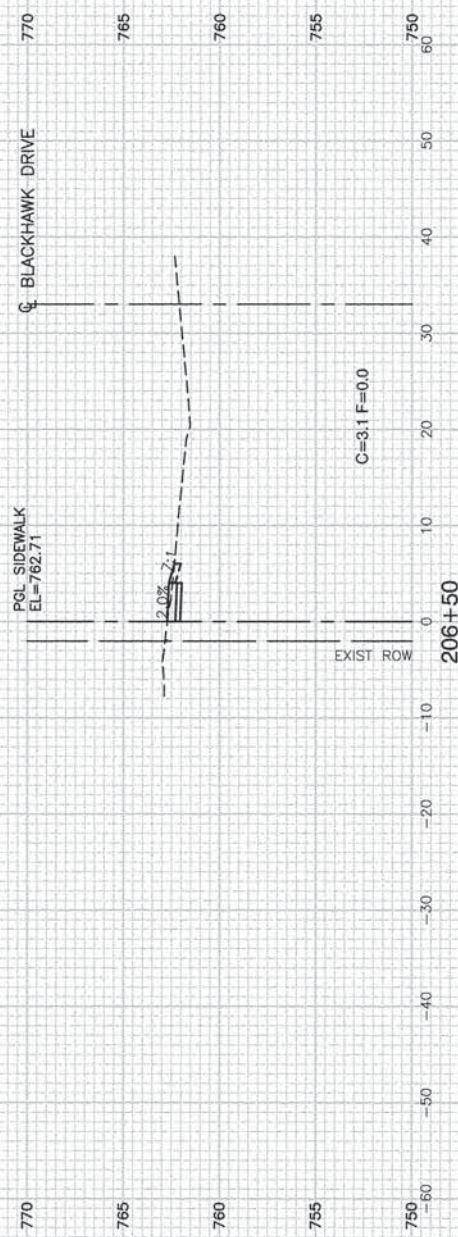
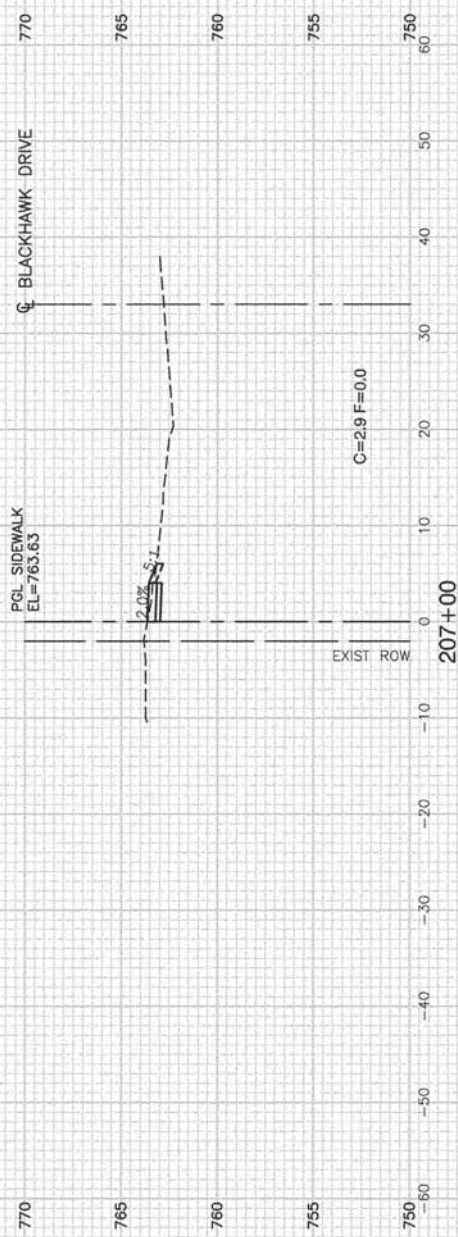

FILE NAME = 13345-02-XSECT-01 - IDOT P01 (2)

USER NAME =	DESIGNED -- ERR	REVISED --
	CHECKED --	REVISED --
PLOT SCALE =	DRAWN -- ACAD	REVISED --
PLOT DATE = 7-11-14	CHECKED -- ACAD	REVISED --

STATE OF ILLINOIS
DEPARTMENT OF TRANSPORTATION

OLMSTEAD LANE AND BLACKHAWK DRIVE
SAFE ROUTES TO SCHOOL
BLACKHAWK DRIVE CROSS SECTIONS

SCALE: SHEET NO. 13 OF 25 SHEETS STA. TO STA.

F.A.U. RTE.	SECTION	COUNTY	TOTAL SHEETS	SHEET NO.
	12-00020-00-SW	COOK	25	13
FED. ROAD DIST. NO. 1 ILLINOIS FED. AID PROJECT SRTS-4009(256)			CONTRACT NO. 61B29	

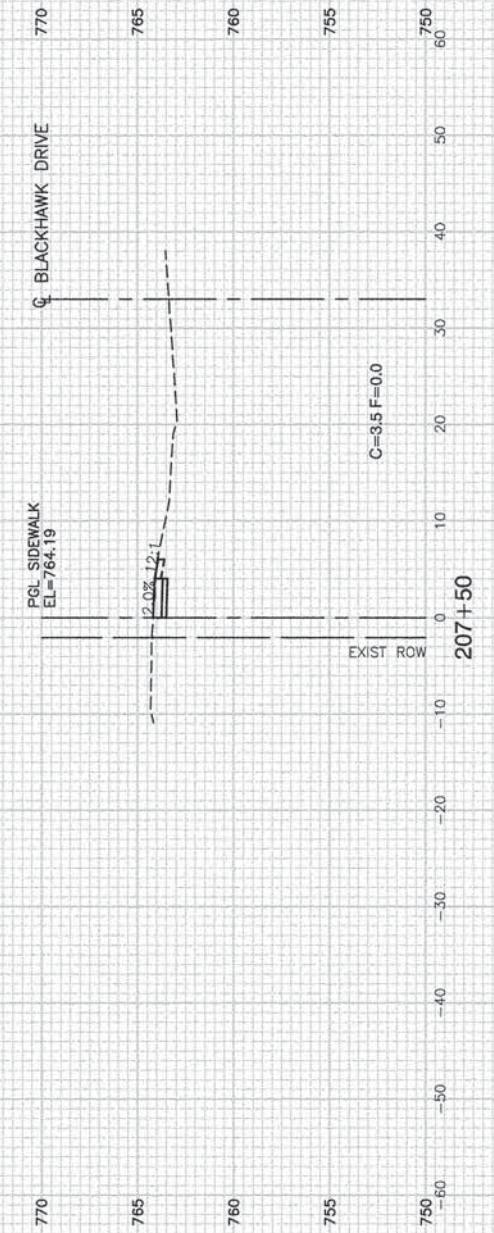
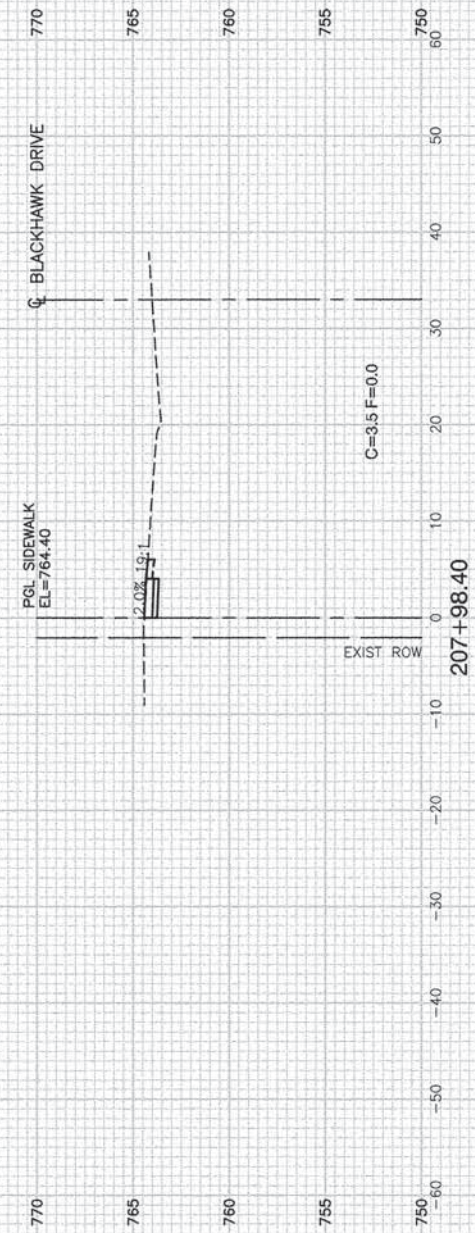
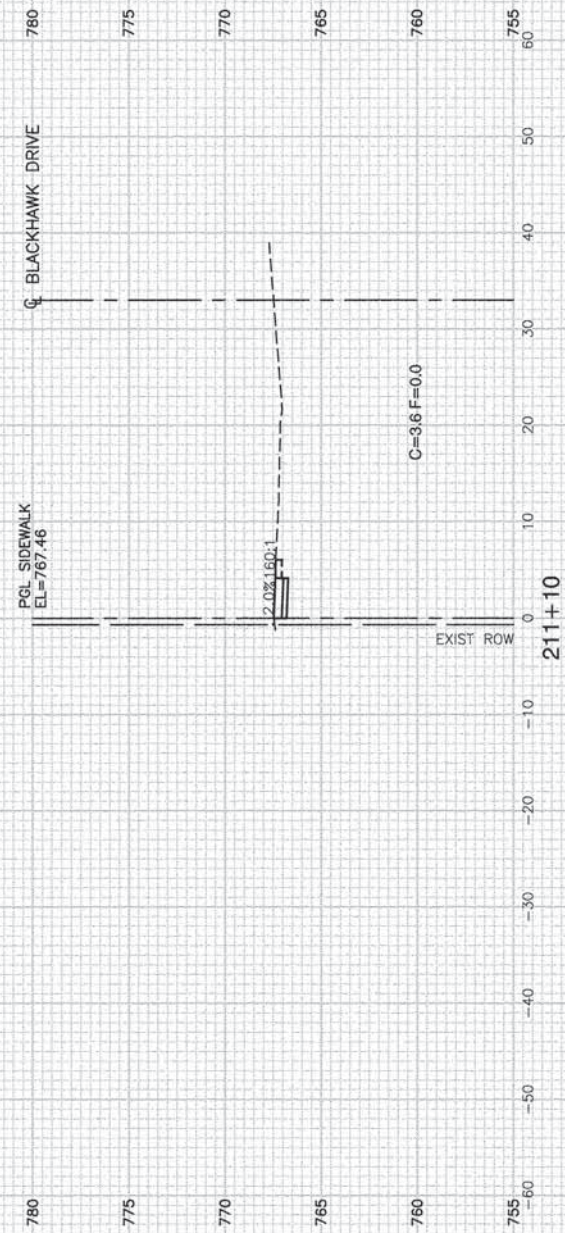

FILE NAME = 13345-02-XSECT-01 - IDOT P01 (3)

USER NAME =	DESIGNED -- ERR	REVISED --
PLOT SCALE =	CHECKED --	REVISED --
PLOT DATE = 7-11-14	DRAWN -- ACAD	REVISED --
	CHECKED -- ACAD	REVISED --

STATE OF ILLINOIS
DEPARTMENT OF TRANSPORTATION

OLMSTEAD LANE AND BLACKHAWK DRIVE
SAFE ROUTES TO SCHOOL
BLACKHAWK DRIVE CROSS SECTIONS

SCALE: SHEET NO. 14 OF 25 SHEETS STA. TO STA.

F.A.U. RTE.	SECTION	COUNTY	TOTAL SHEETS	SHEET NO.
	12-00020-00-SW	COOK	25	14
CONTRACT NO. 61B29				
FED. ROAD DIST. NO. 1 ILLINOIS FED. AID PROJECT SRTS-4009(256)				

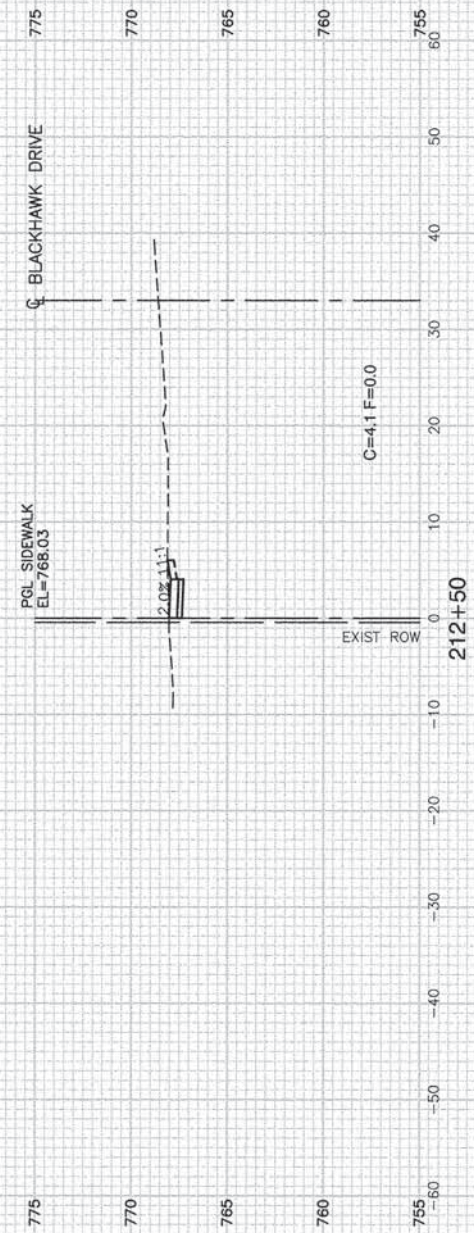
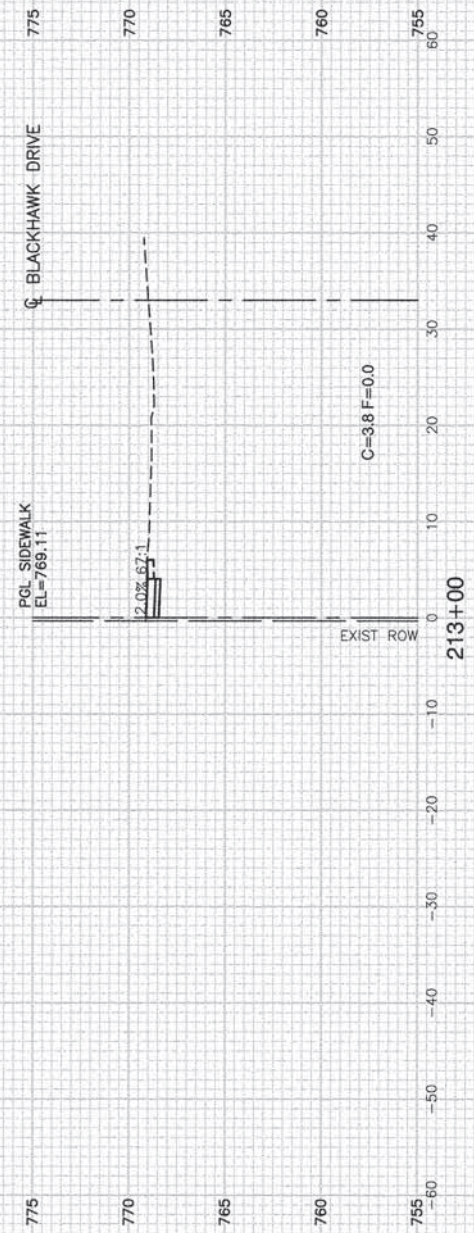
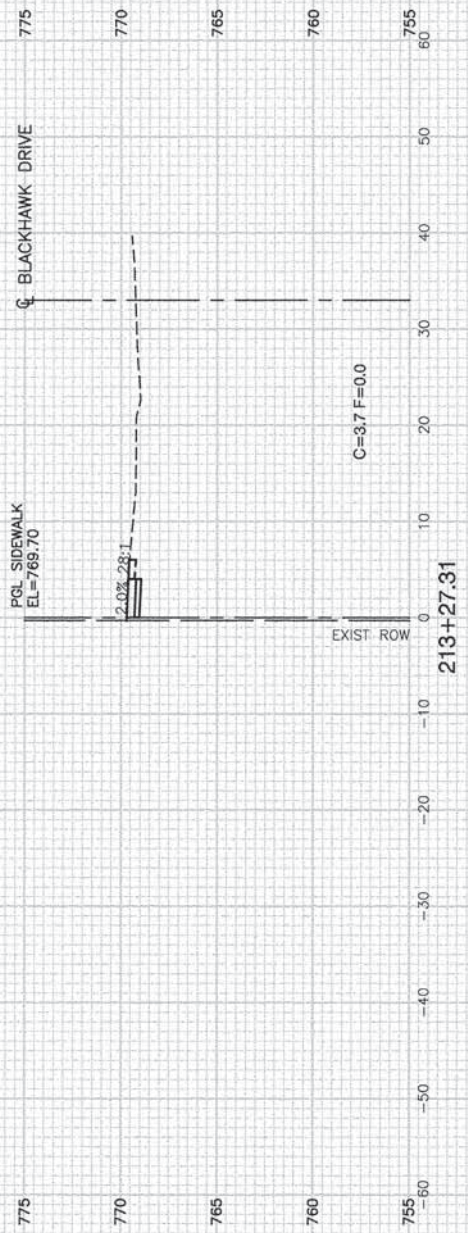

FILE NAME = 13345-02-XSECT-01 - IDOT P01 (4)

USER NAME =
 PLOT SCALE =
 PLOT DATE = 7-11-14

DESIGNED -- ERR
 CHECKED --
 DRAWN -- ACAD
 CHECKED -- ACAD

REVISED --
 REVISED --
 REVISED --
 REVISED --

STATE OF ILLINOIS
 DEPARTMENT OF TRANSPORTATION

OLMSTEAD LANE AND BLACKHAWK DRIVE
 SAFE ROUTES TO SCHOOL
 BLACKHAWK DRIVE CROSS SECTIONS

F.A.U. RTE.	SECTION	COUNTY	TOTAL SHEETS	SHEET NO.
	12-00020-00-SW	COOK	25	15
FED. ROAD DIST. NO. 1 ILLINOIS FED. AID PROJECT SRTS-4009(256)			CONTRACT NO. 61B29	

SCALE: SHEET NO. 15 OF 25 SHEETS STA. TO STA.

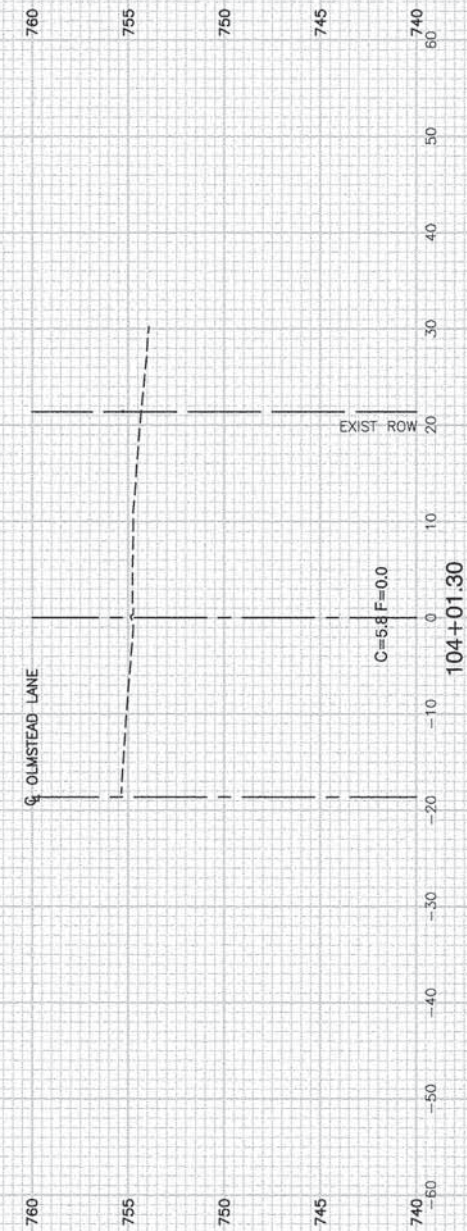
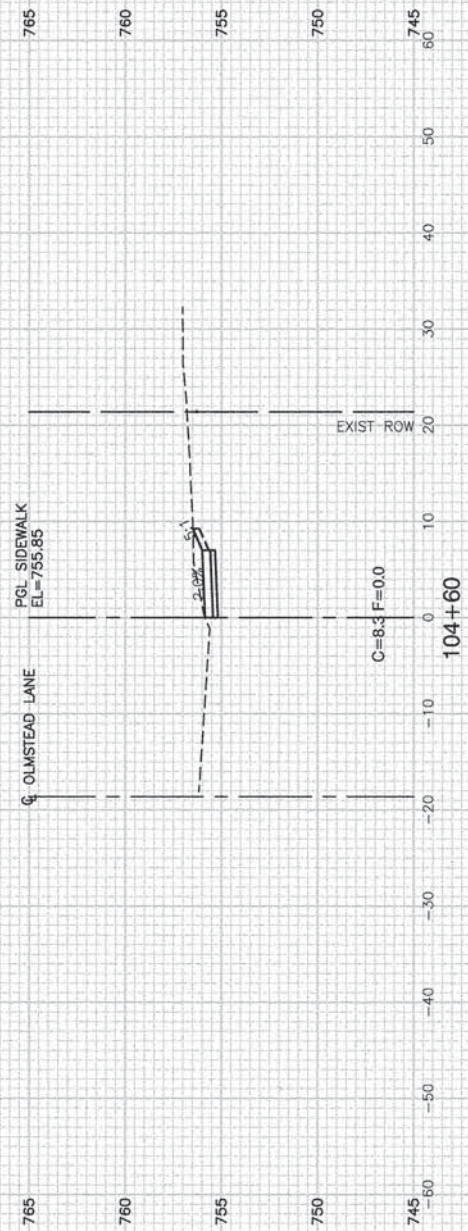
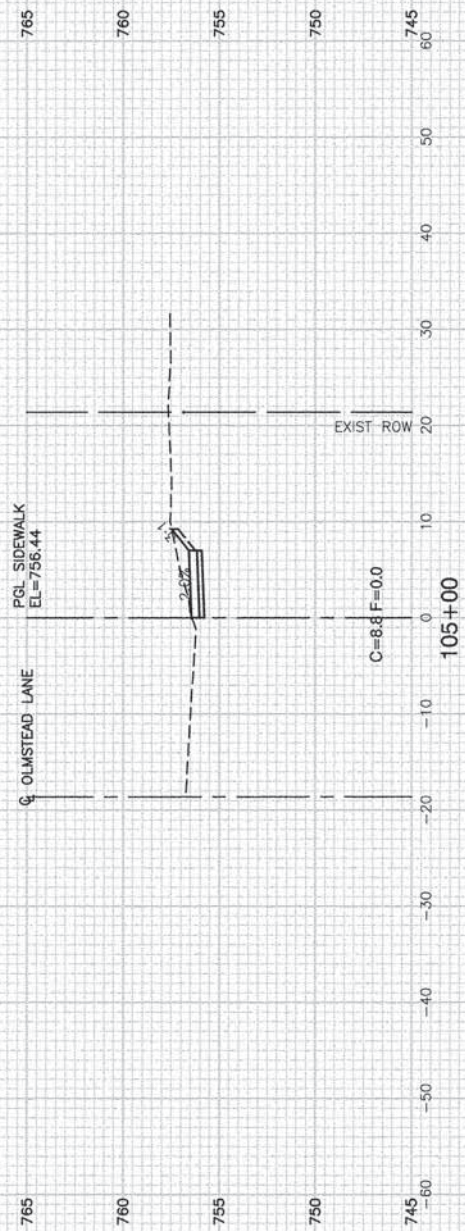

FILE NAME = 13345-02-XSECT-01 - IDOT P01 (5)

USER NAME =
 PLOT SCALE =
 PLOT DATE = 7-11-14

DESIGNED -- ERR
 CHECKED --
 DRAWN -- ACAD
 CHECKED -- ACAD

REVISED --
 REVISED --
 REVISED --
 REVISED --

STATE OF ILLINOIS
 DEPARTMENT OF TRANSPORTATION

OLMSTEAD LANE AND BLACKHAWK DRIVE
 SAFE ROUTES TO SCHOOL
 OLMSTEAD LANE CROSS SECTIONS

SCALE: SHEET NO. 16 OF 25 SHEETS STA. TO STA.

F.A.U. RTE.	SECTION	COUNTY	TOTAL SHEETS	SHEET NO.
---	12-00020-00-SW	COOK	25	16
FED. ROAD DIST. NO. 1 ILLINOIS FED. AID PROJECT SRTS-4009(256)			CONTRACT NO. 61B29	

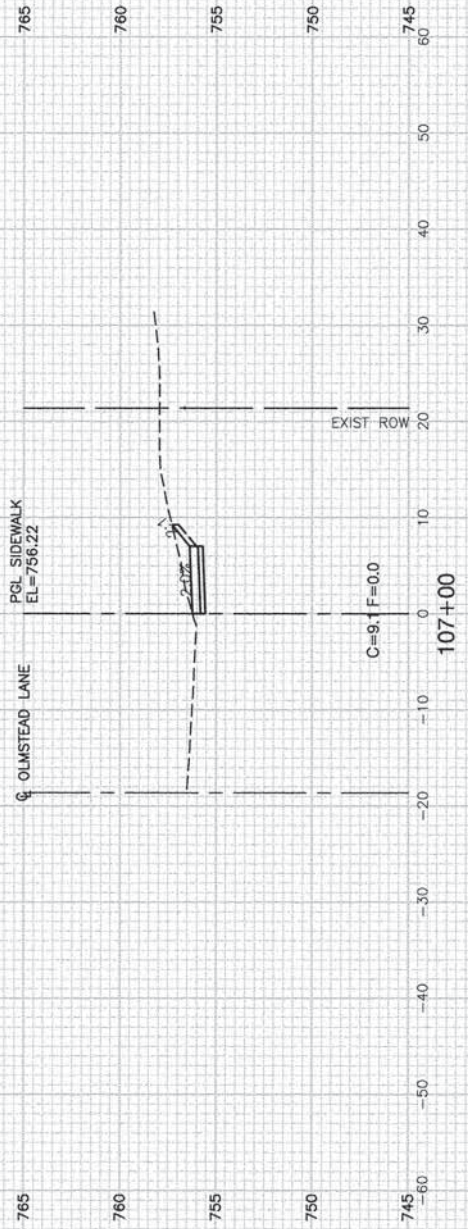

FILE NAME = 13345-02-XSECT-01 - IDOT P01 (6)

USER NAME =	DESIGNED -- ERR	REVISED --
	CHECKED --	REVISED --
PLOT SCALE =	DRAWN -- ACAD	REVISED --
PLOT DATE = 7-11-14	CHECKED -- ACAD	REVISED --

STATE OF ILLINOIS
DEPARTMENT OF TRANSPORTATION

OLMSTEAD LANE AND BLACKHAWK DRIVE
SAFE ROUTES TO SCHOOL
OLMSTEAD LANE CROSS SECTIONS

SCALE: SHEET NO. 17 OF 25 SHEETS STA. TO STA.

F.A.U. RTE.	SECTION	COUNTY	TOTAL SHEETS	SHEET NO.
--	12-00020-00-SW	COOK	25	17
FED. ROAD DIST. NO. 1 ILLINOIS			CONTRACT NO. 61B29	
FED. AID PROJECT			SRTS-4009(256)	

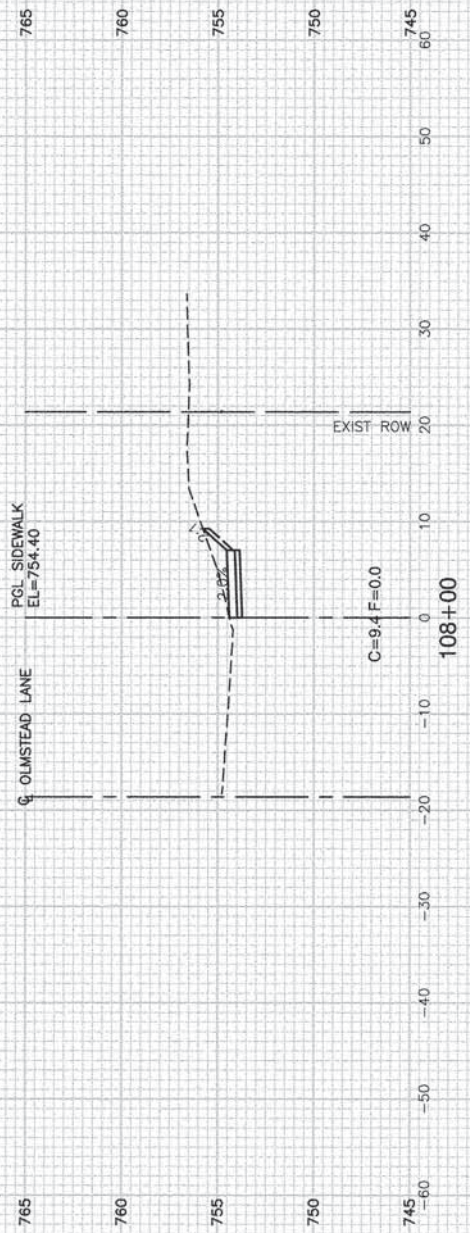
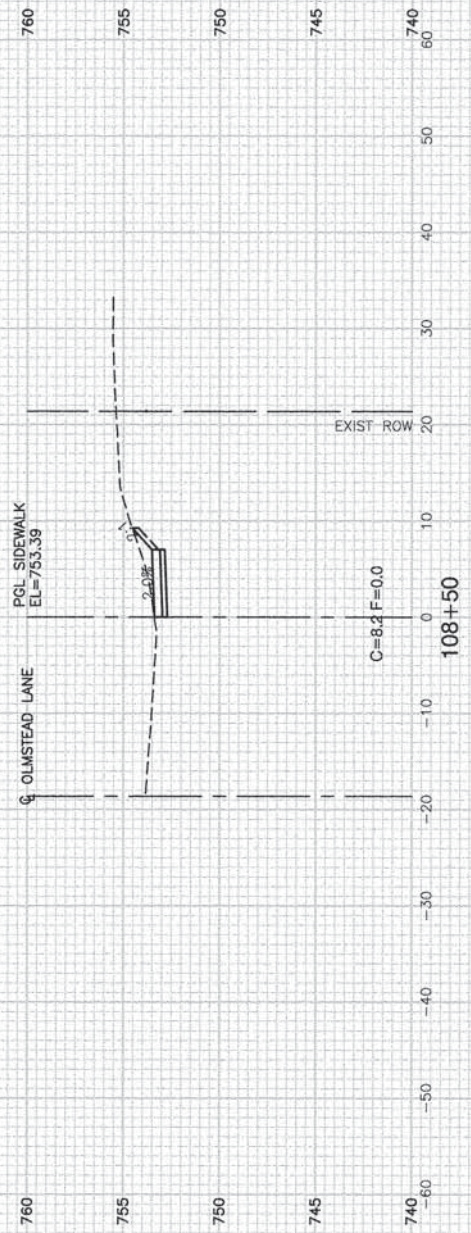

FILE NAME = 13345-02-XSECT-01 - IDOT P01 (7)

USER NAME =
 PLOT SCALE =
 PLOT DATE = 7-11-14

DESIGNED - ERR
 CHECKED - ---
 DRAWN - ACAD
 CHECKED - ACAD

REVISED -
 REVISED -
 REVISED -
 REVISED -

STATE OF ILLINOIS
 DEPARTMENT OF TRANSPORTATION

OLMSTEAD LANE AND BLACKHAWK DRIVE
 SAFE ROUTES TO SCHOOL
 OLMSTEAD LANE CROSS SECTIONS

SCALE: SHEET NO. 18 OF 25 SHEETS STA. TO STA.

F.A.U. RTE.	SECTION	COUNTY	TOTAL SHEETS	SHEET NO.
---	12-00020-00-SW	COOK	25	18
CONTRACT NO. 61B29				
FED. ROAD DIST. NO. 1 ILLINOIS FED. AID PROJECT SRTS-4009(256)				

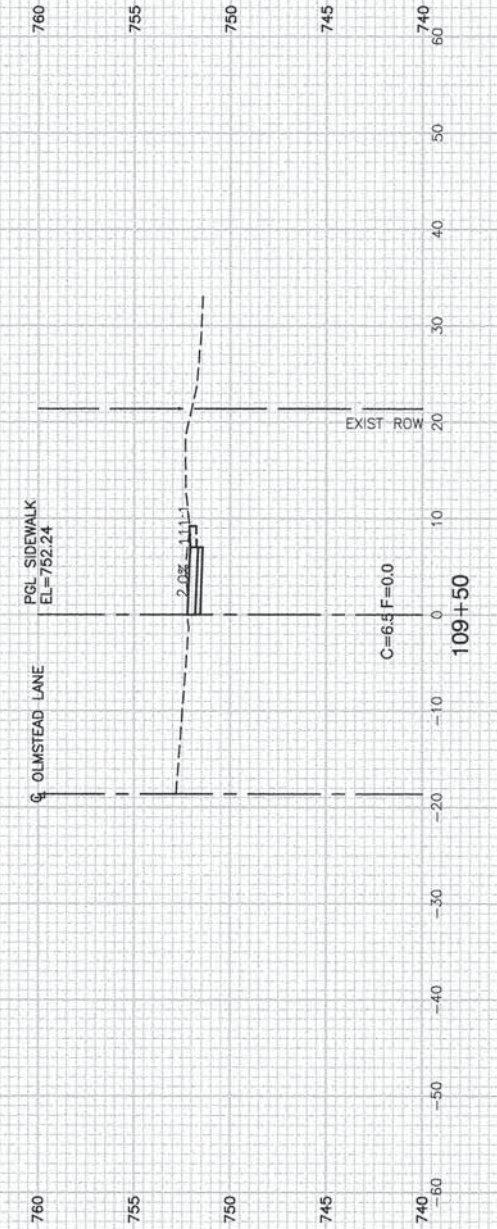
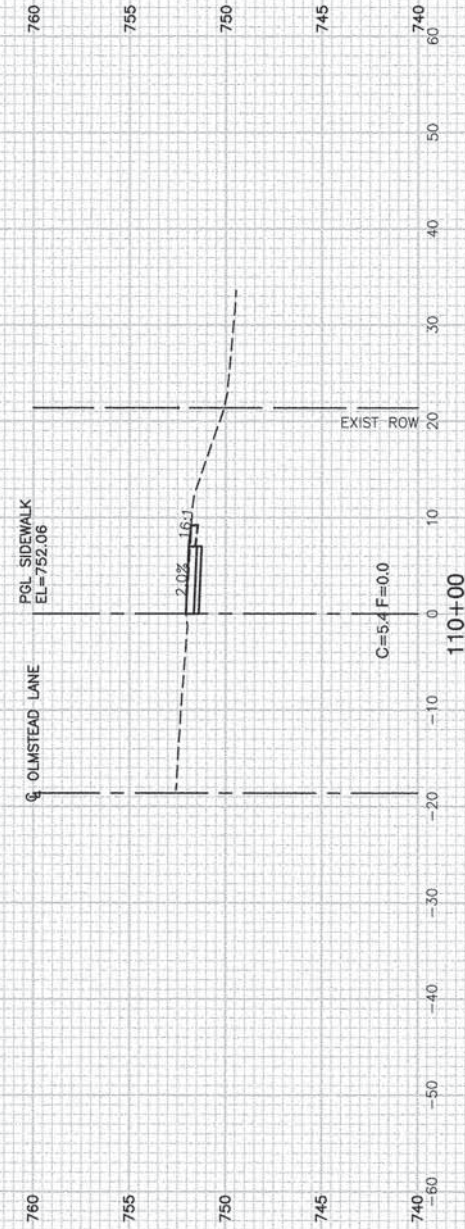
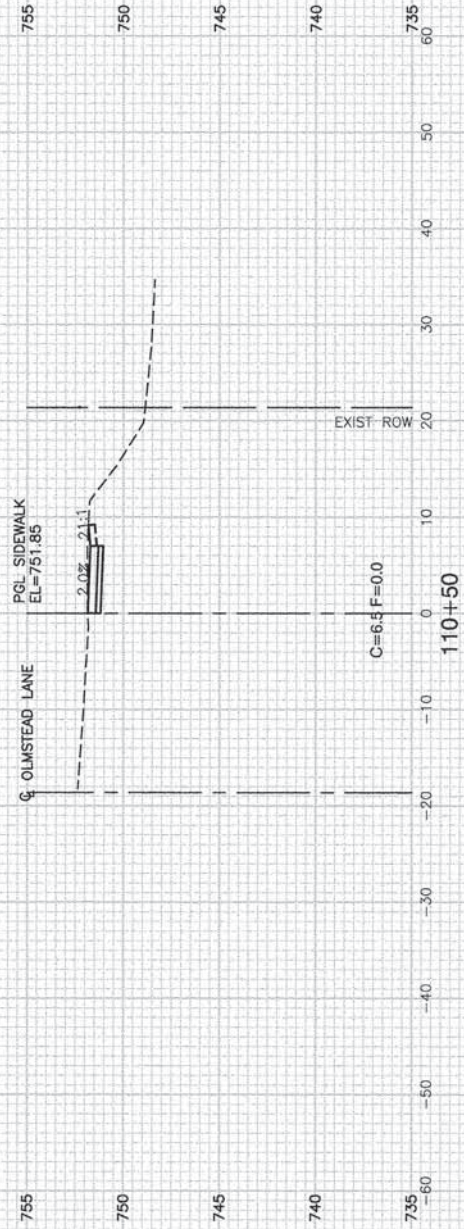
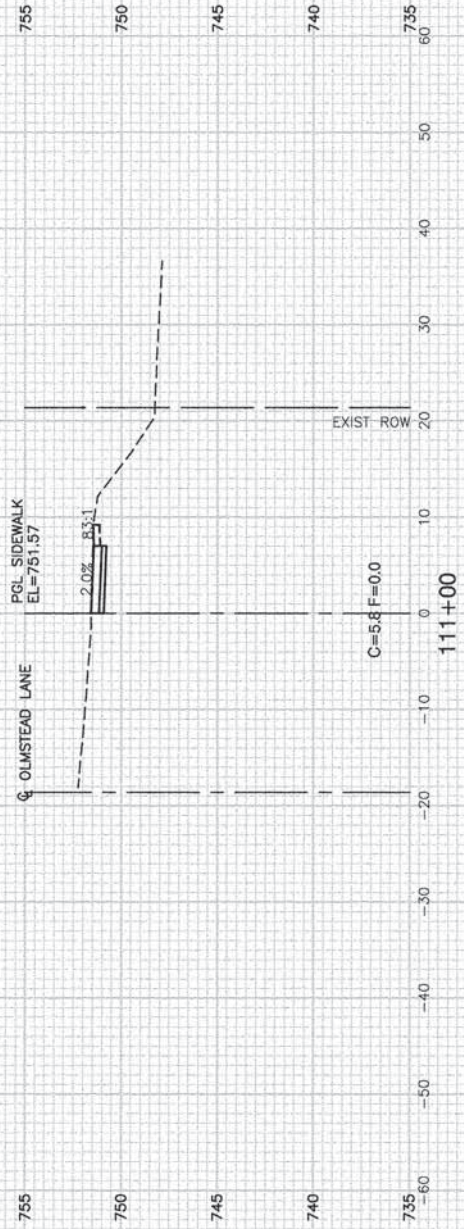

FILE NAME = 13345-02-XSECT-01 - IDOT P01 (8)

USER NAME =
 PLOT SCALE =
 PLOT DATE = 7-11-14

DESIGNED -- ERR
 CHECKED --
 DRAWN -- ACAD
 CHECKED -- ACAD

REVISED --
 REVISED --
 REVISED --
 REVISED --

STATE OF ILLINOIS
 DEPARTMENT OF TRANSPORTATION

OLMSTEAD LANE AND BLACKHAWK DRIVE
 SAFE ROUTES TO SCHOOL
 OLMSTEAD LANE CROSS SECTIONS

F.A.U. RTE.	SECTION	COUNTY	TOTAL SHEETS	SHEET NO.
---	12-00020-00-SW	COOK	25	19
FED. ROAD DIST. NO. 1 ILLINOIS FED. AID PROJECT SRTS-4009(256)			CONTRACT NO. 61B29	

SCALE: SHEET NO. 19 OF 25 SHEETS STA. TO STA.

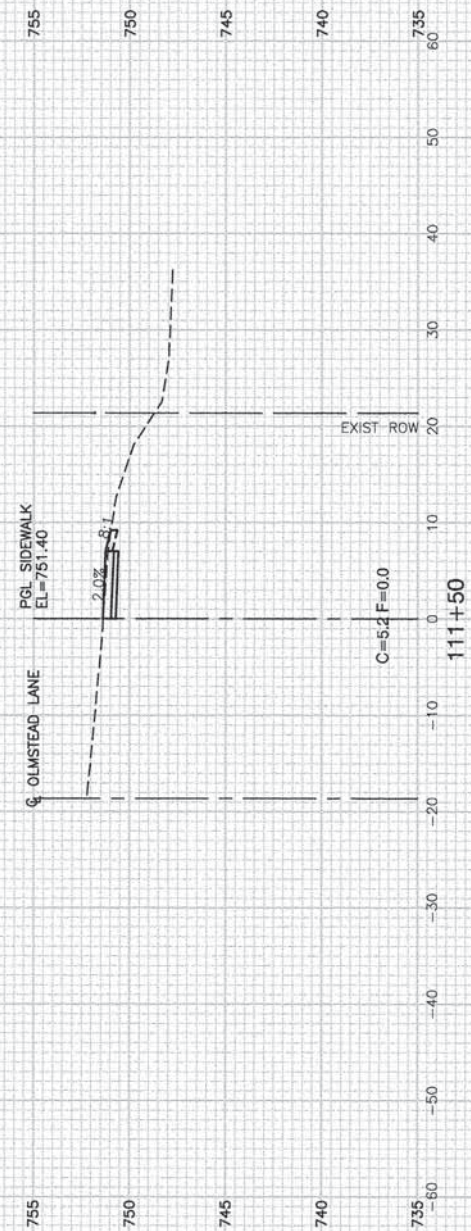
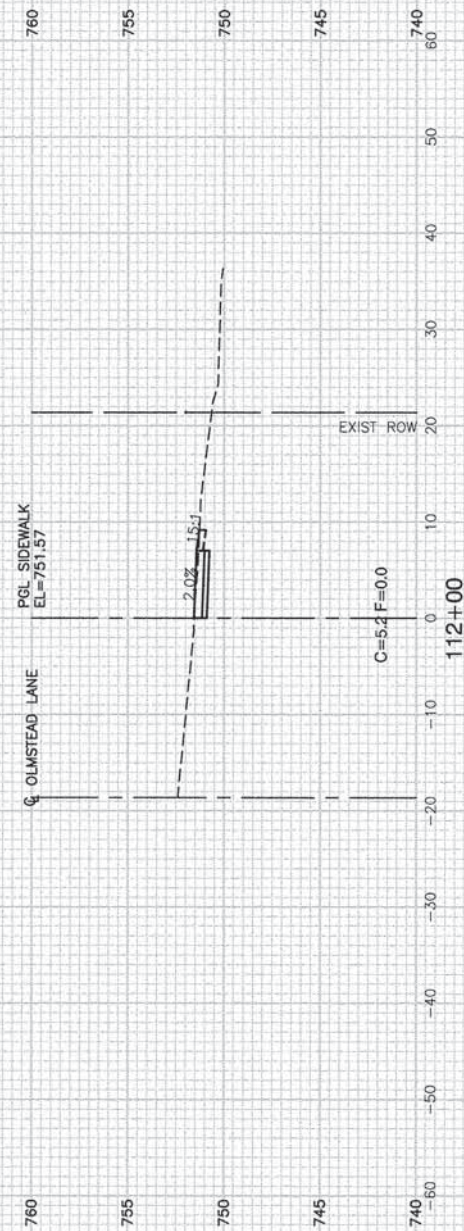

FILE NAME = 13345-00-XSECT-01 - IDOT P01 (9)

USER NAME =
 PLOT SCALE =
 PLOT DATE = 7-11-14

DESIGNED -- ERR
 CHECKED --
 DRAWN -- ACAD
 CHECKED -- ACAD

REVISED --
 REVISED --
 REVISED --
 REVISED --

STATE OF ILLINOIS
 DEPARTMENT OF TRANSPORTATION

OLMSTEAD LANE AND BLACKHAWK DRIVE
 SAFE ROUTES TO SCHOOL
 OLMSTEAD LANE CROSS SECTIONS

F.A.U. RTE.	SECTION	COUNTY	TOTAL SHEETS	SHEET NO.
	12-00020-00-SW	COOK	25	20
CONTRACT NO. 61B29				

SCALE: SHEET NO. 20 OF 25 SHEETS STA. TO STA.

FED. ROAD DIST. NO. 1 ILLINOIS FED. AID PROJECT SRTS-4009(256)

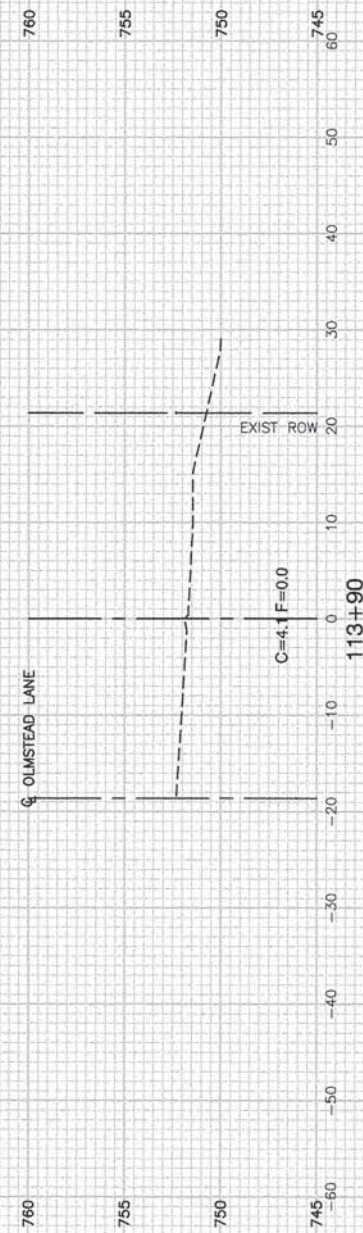
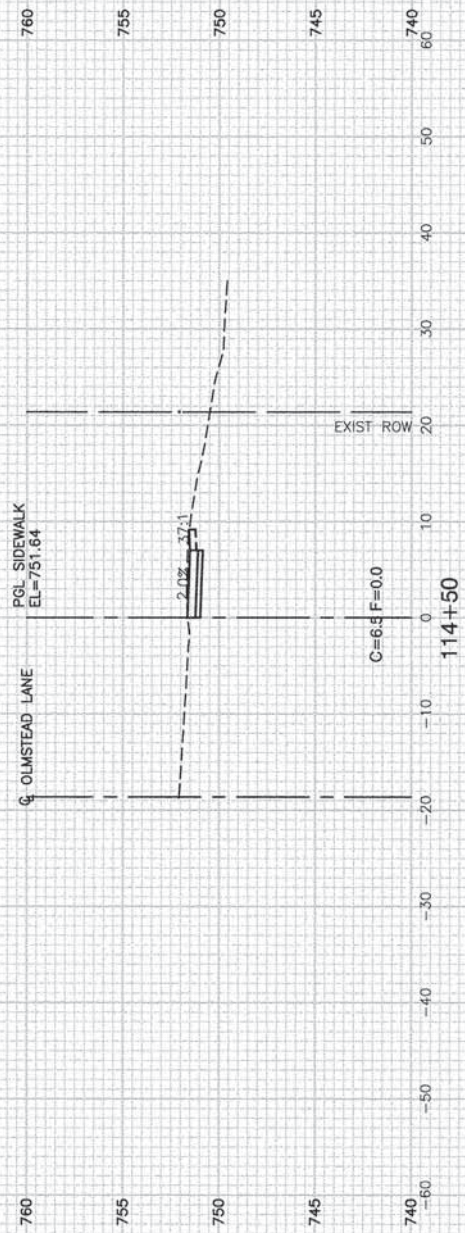
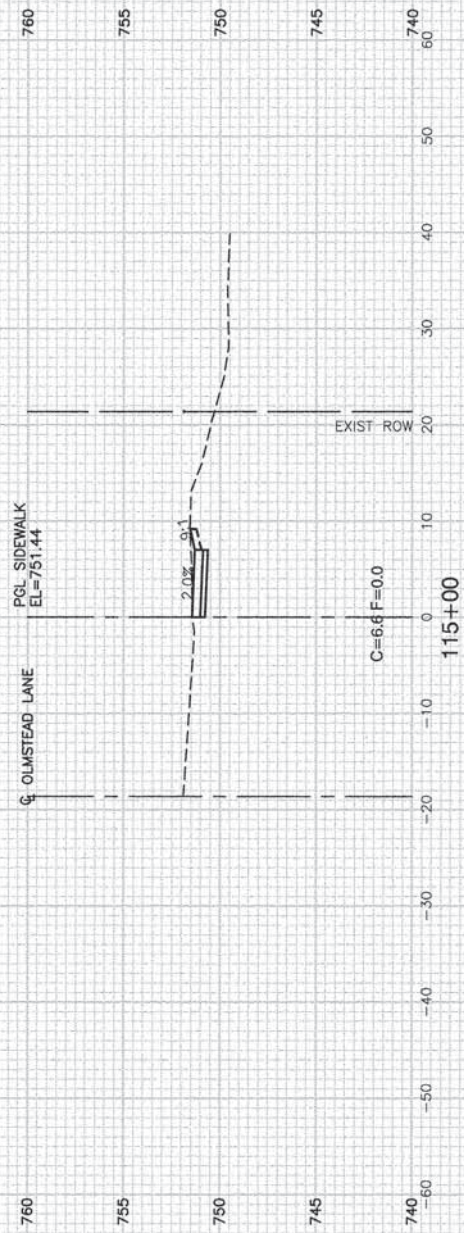

FILE NAME = 13345-02-XSECT-01 - IDOT P01 (10)

USER NAME =	DESIGNED -- ERR	REVISED --
	CHECKED --	REVISED --
PLOT SCALE =	DRAWN -- ACAD	REVISED --
PLOT DATE = 7-11-14	CHECKED -- ACAD	REVISED --

STATE OF ILLINOIS
DEPARTMENT OF TRANSPORTATION

OLMSTEAD LANE AND BLACKHAWK DRIVE SAFE ROUTES TO SCHOOL OLMSTEAD LANE CROSS SECTIONS			
SCALE:	SHEET NO. 21 OF 25 SHEETS	STA.	TO STA.

FAU RTE.	SECTION	COUNTY	TOTAL SHEETS	SHEET NO.
--	12-00020-00-SW	COOK	25	21
FED. ROAD DIST. NO. 1		ILLINOIS	CONTRACT NO. 61B29	
FED. AID PROJECT SRTS-4009(256)				

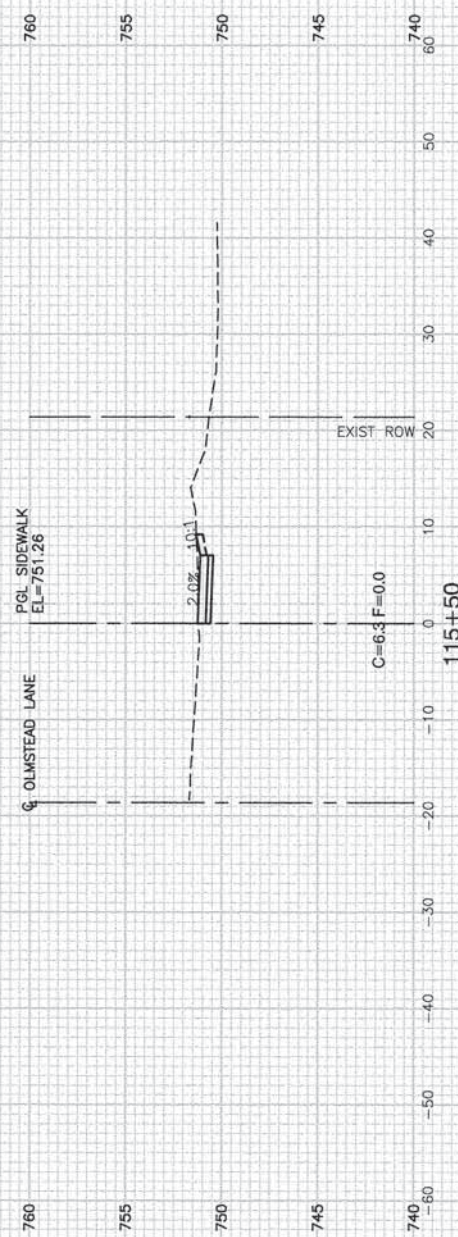
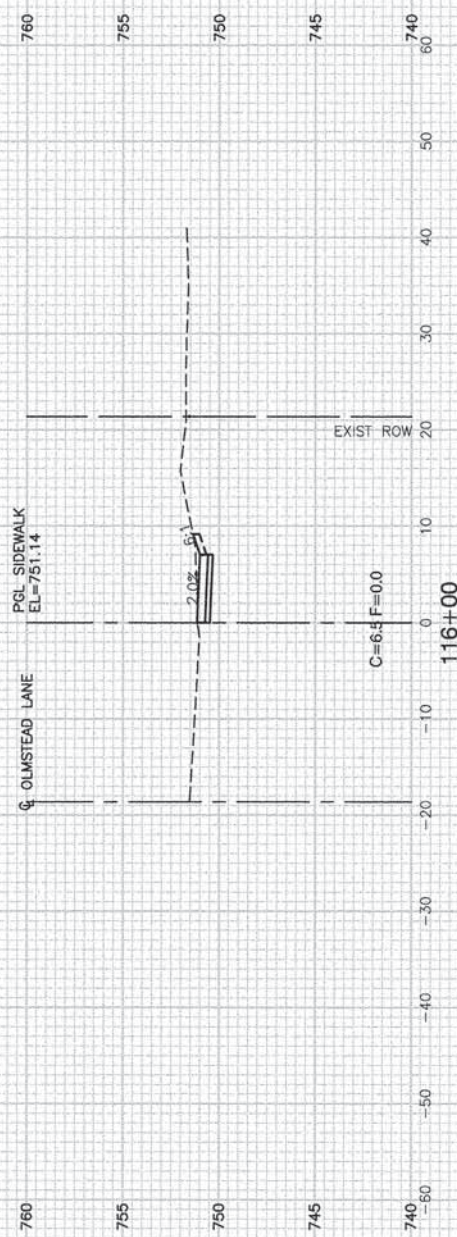
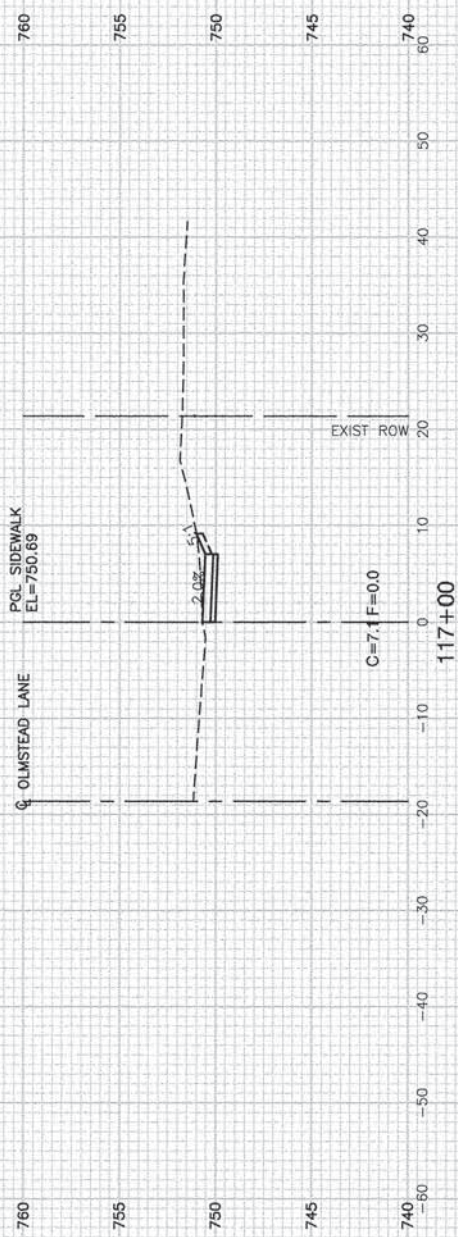

FILE NAME = 13345-02-XSECT-01 - IDOT P01 (11)

USER NAME =	DESIGNED - ERR	REVISED -
	CHECKED -	REVISED -
PLOT SCALE =	DRAWN - ACAD	REVISED -
PLOT DATE = 7-11-14	CHECKED - ACAD	REVISED -

STATE OF ILLINOIS
DEPARTMENT OF TRANSPORTATION

OLMSTEAD LANE AND BLACKHAWK DRIVE
SAFE ROUTES TO SCHOOL
OLMSTEAD LANE CROSS SECTIONS

SCALE: SHEET NO. 22 OF 25 SHEETS STA. TO STA.

F.A.U. RTE.	SECTION	COUNTY	TOTAL SHEETS	SHEET NO.
	12-00020-00-SW	COOK	25	22
CONTRACT NO. 61B29				
FED. ROAD DIST. NO. 1 ILLINOIS FED. AID PROJECT SRTS-4009(256)				

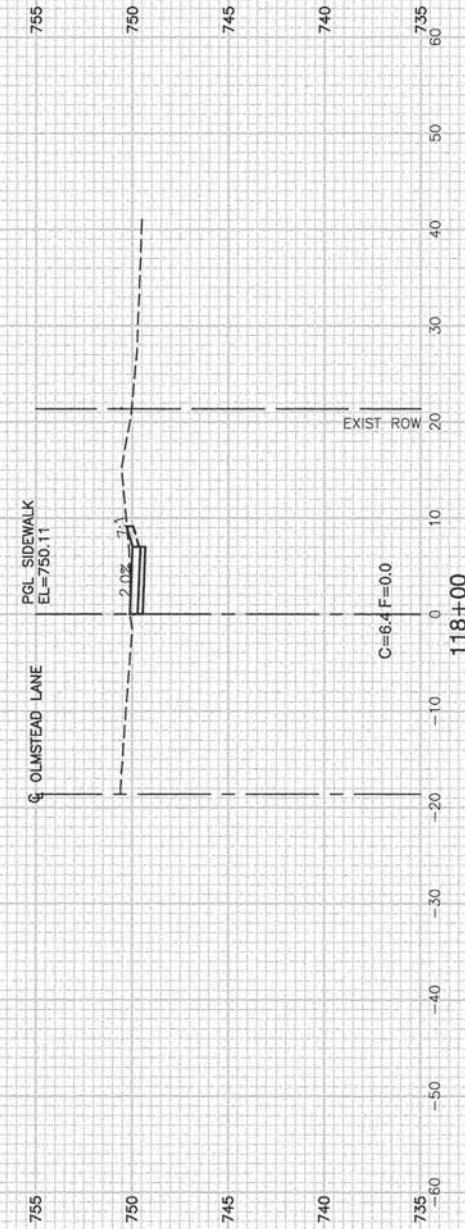
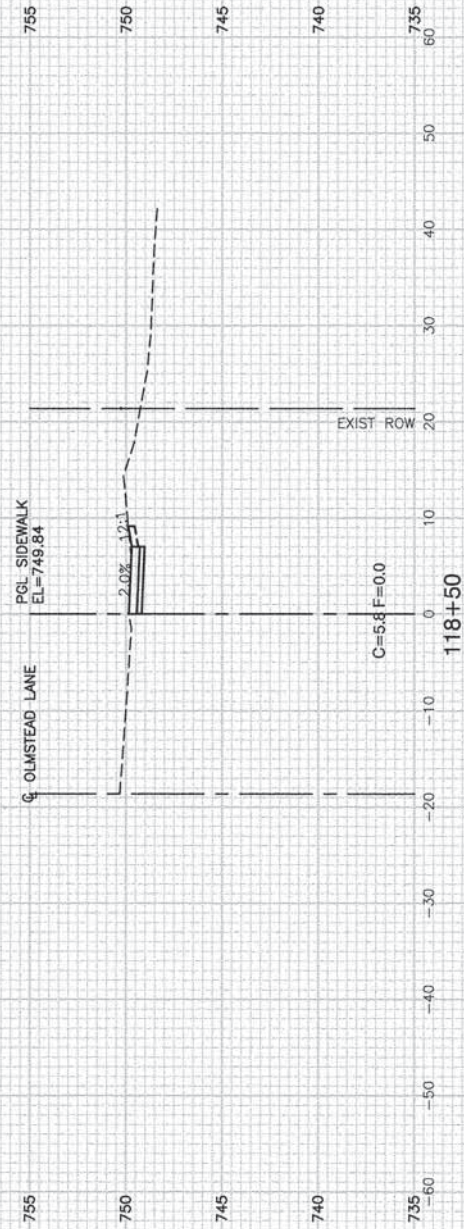
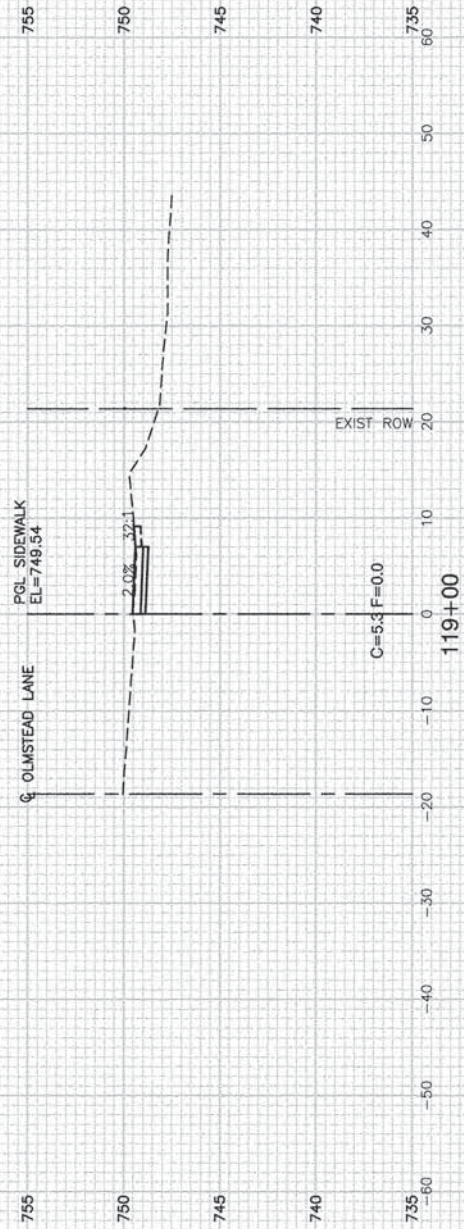

FILE NAME = 13345-02-XSECT-01 - IDOT P01 (12)

USER NAME =
 PLOT SCALE =
 PLOT DATE = 7-11-14

DESIGNED - ERR
 CHECKED -
 DRAWN - ACAD
 CHECKED - ACAD

REVISED -
 REVISED -
 REVISED -
 REVISED -

STATE OF ILLINOIS
 DEPARTMENT OF TRANSPORTATION

OLMSTEAD LANE AND BLACKHAWK DRIVE
 SAFE ROUTES TO SCHOOL
 OLMSTEAD LANE CROSS SECTIONS

SCALE: SHEET NO. 23 OF 25 SHEETS STA. TO STA.

F.A.U. RTE.	SECTION	COUNTY	TOTAL SHEETS	SHEET NO.
	12-00020-00-SW	COOK	25	23
CONTRACT NO. 61B29				
FED. ROAD DIST. NO. 1 ILLINOIS FED. AID PROJECT SRTS-4009(256)				

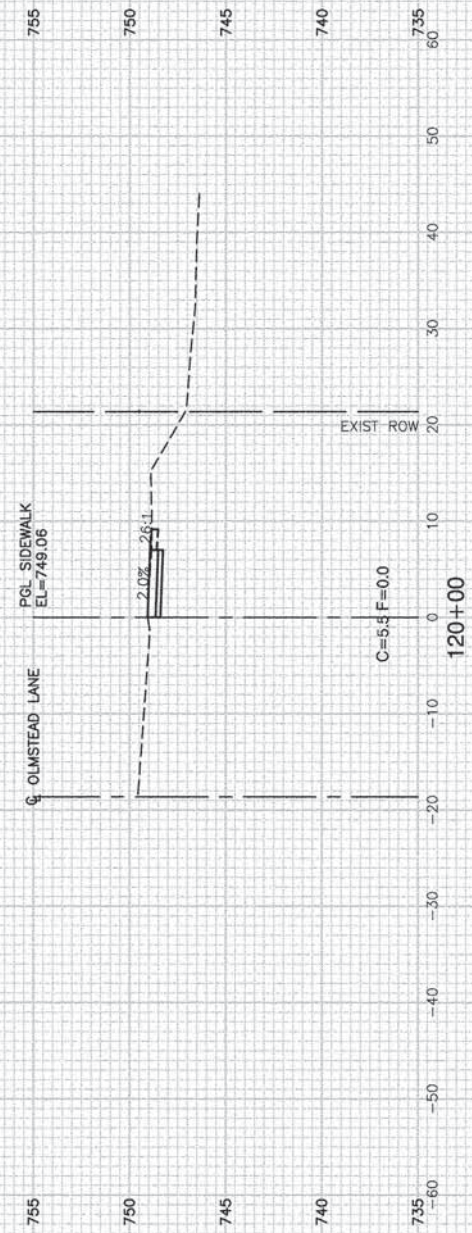
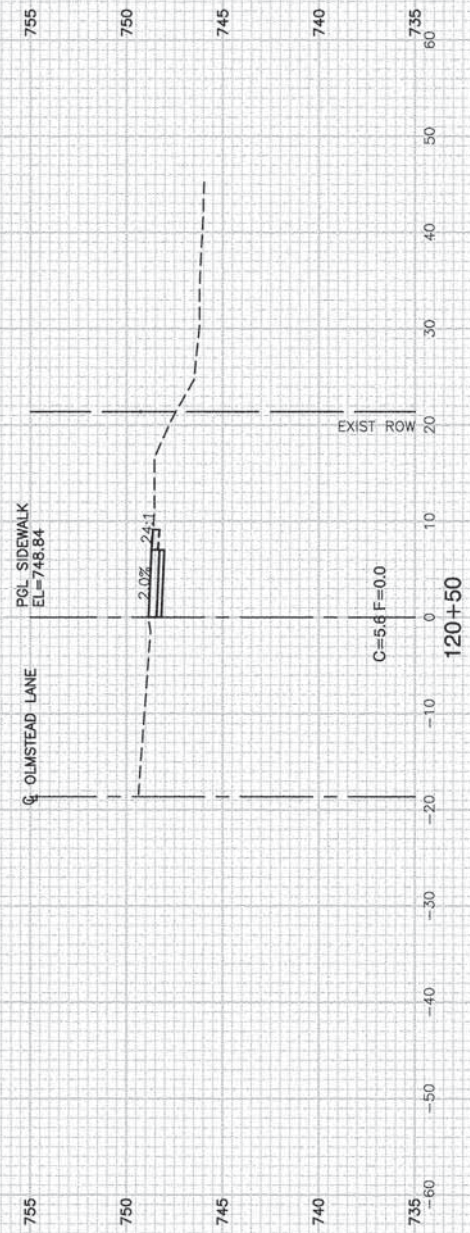

FILE NAME = 13345-02-XSECT-01 - IDOT P01 (13)

USER NAME =
 PLOT SCALE =
 PLOT DATE = 7-11-14

DESIGNED -- ERR
 CHECKED --
 DRAWN -- ACAD
 CHECKED -- ACAD

REVISED --
 REVISED --
 REVISED --
 REVISED --

STATE OF ILLINOIS
 DEPARTMENT OF TRANSPORTATION

OLMSTEAD LANE AND BLACKHAWK DRIVE
 SAFE ROUTES TO SCHOOL
 OLMSTEAD LANE CROSS SECTIONS

SCALE: SHEET NO. 24 OF 25 SHEETS STA. TO STA.

F.A.U. RTE.	SECTION	COUNTY	TOTAL SHEETS	SHEET NO.
	12-00020-00-SW	COOK	25	24
CONTRACT NO. 61B29				
FED. ROAD DIST. NO. 1 ILLINOIS FED. AID PROJECT SRTS-4009(256)				

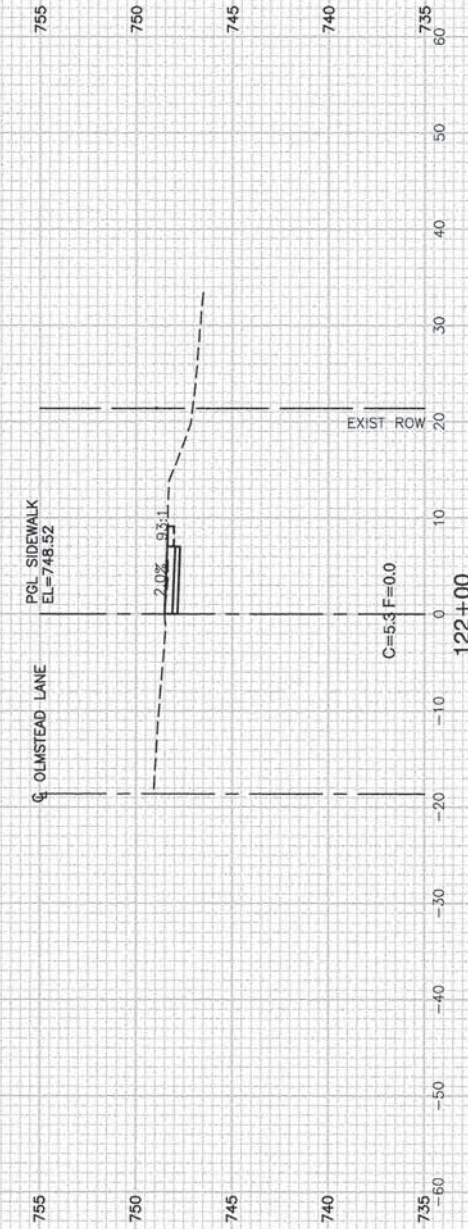
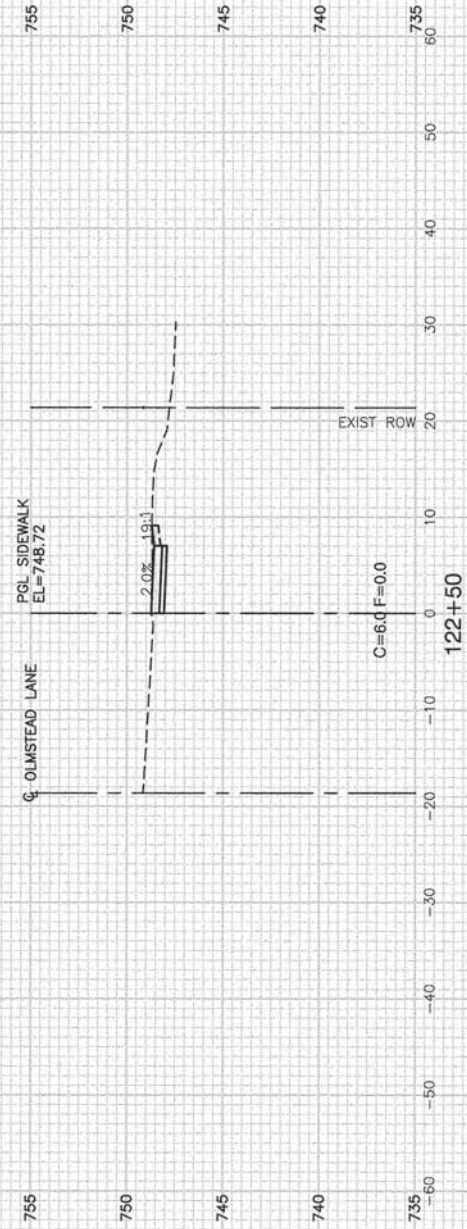
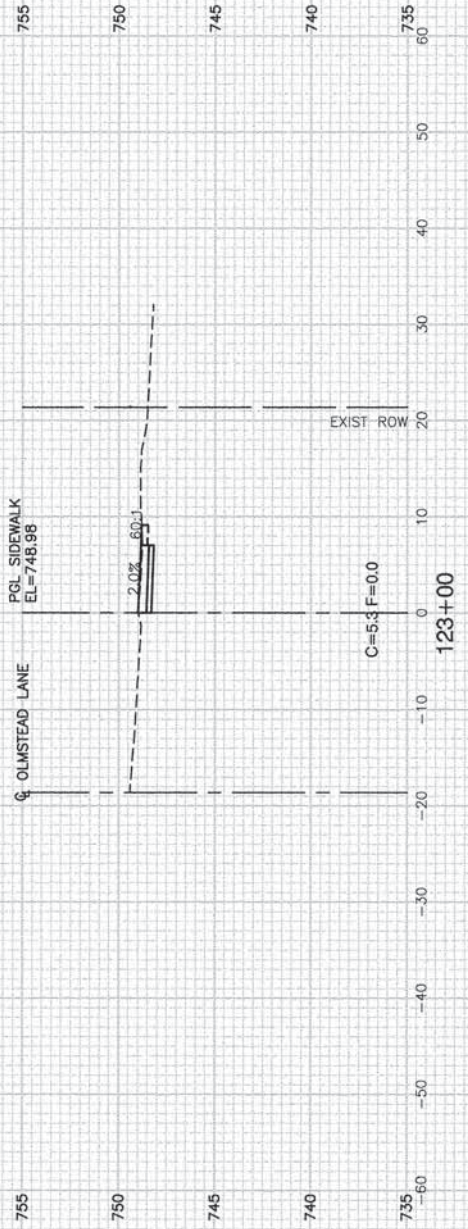

FILE NAME = 13345-02-XSECT-01 - IDOT P01 (14)

USER NAME =	DESIGNED - ERR	REVISED -
PLOT SCALE =	CHECKED -	REVISED -
PLOT DATE = 7-11-14	DRAWN - ACAD	REVISED -
	CHECKED - ACAD	REVISED -

STATE OF ILLINOIS
DEPARTMENT OF TRANSPORTATION

OLMSTEAD LANE AND BLACKHAWK DRIVE
SAFE ROUTES TO SCHOOL
OLMSTEAD LANE CROSS SECTIONS

SCALE: SHEET NO. 25 OF 25 SHEETS STA. TO STA.

F.A.U. RTE.	SECTION	COUNTY	TOTAL SHEETS	SHEET NO.
---	12-00020-00-SW	COOK	25	25
FED. ROAD DIST. NO. 1 ILLINOIS FED. AID PROJECT SRTS-4009(256)			CONTRACT NO. 61B29	