

05/14/02 PM 01:11:01 10017.GD:Sheet 1 of 2

DESIGN AND PLAN PREPARATION ENGINEER : K. ENG / M. GOMEZ (847) 705 - 4432

STATE OF ILLINOIS
DEPARTMENT OF TRANSPORTATION
DIVISION OF HIGHWAYS

PROPOSED
HIGHWAY PLANS

F.A.I. ROUTE 80 (INTERSTATE 80)
GRUNDY COUNTY LINE TO ROWELL STREET
RESURFACING (MAINT.) & BRIDGE REPAIRS
SECTION (99 [1,2,3,4] & 4-1) RS-7
C-91-507-00
WILL COUNTY

F.A.I. RTE.	SECTION	COUNTY	TOTAL SHEETS	SHEET NO.
80		WILL	82	1

99 (1,2,3,4 & 4-1) RS-7

D-91-507-00

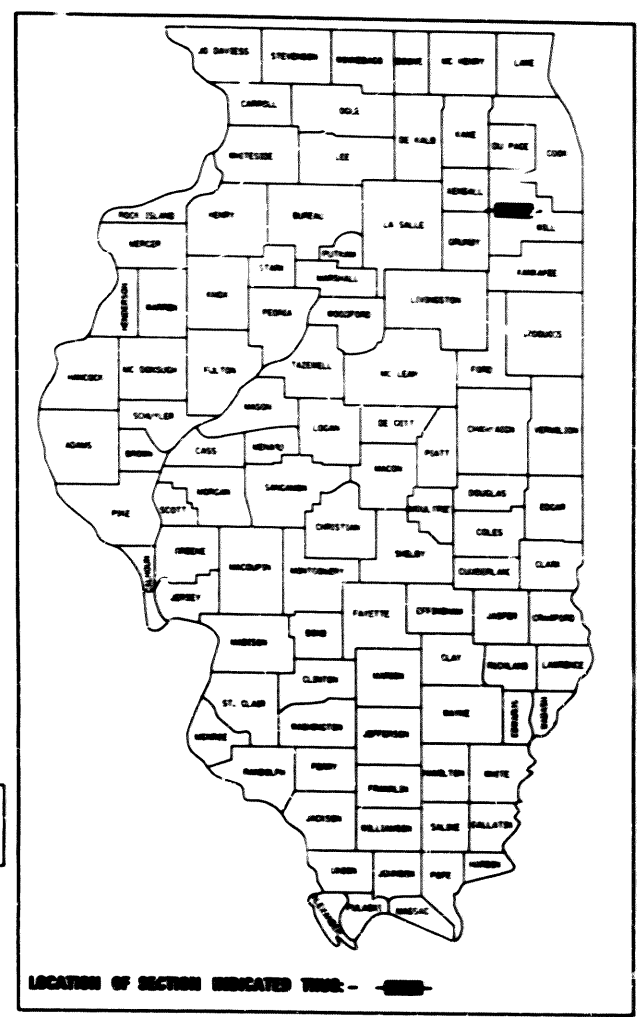

FOR INDEX OF SHEETS, SEE SHEET NO. 2

THIS IMPROVEMENT IS LOCATED WITHIN
ROCKDALE AND JOLIET

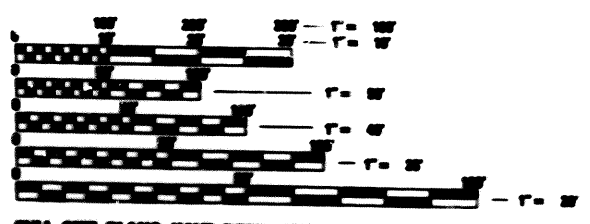
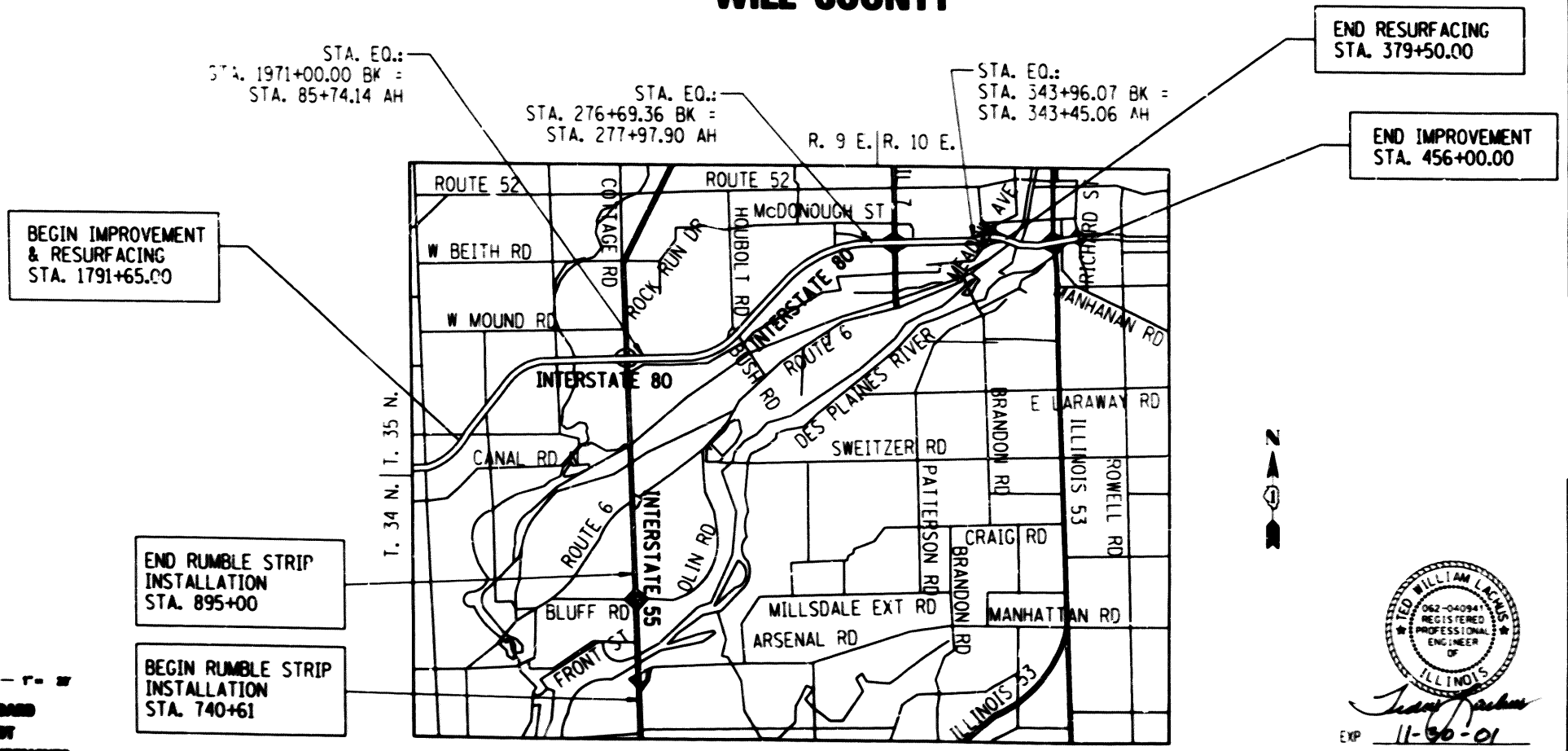

FULL SIZE PLANS HAVE BEEN PREPARED USING STANDARD
ENGINEERING SCALE. REDUCED SIZE PLANS WILL NOT
CONFORM TO STANDARD SCALE. IN MAKING MEASUREMENTS
ON REDUCED PLANS, THE ABOVE SCALES MAY BE USED.

SCALE
JOINT UTILITY LOCATION INFORMATION FOR EXCAVATION
1-800-888-0828

TRAFFIC DATA
INTERSTATE 80
WEST OF LARKIN AVE.
1999 ADT = 35,000
SPEED LIMIT: 55 MPH

TRAFFIC DATA
INTERSTATE 80
EAST OF LARKIN AVE.
1999 ADT = 74,500
SPEED LIMIT: 45-55 MPH

LOCATION MAP
GROSS LENGTH OF SECTION = 47,342.55LF = 8.966 MILES
NET LENGTH OF SECTION = 44,479 LF = 8.424 MILES
MAP SCALE
1"=6000'

STATION EQUATIONS
1971+00 BK = 85+74.14 AH
276+69.36 BK = 277+97.90 AH
342+96.07 BK = 343+45.06 AH

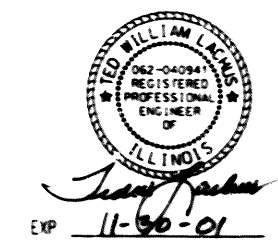

PATRICK ENGINEERING, INC.
TED R. LACHUS, P.E.
062-04094

STATE OF ILLINOIS
DEPARTMENT OF TRANSPORTATION
DIVISION OF HIGHWAYS

SUBMITTED: April 12, 2001
 District Engineer: [Signature]
 May 11, 2001
 District Engineer: [Signature]
 May 11, 2001
 District Engineer: [Signature]

PRINTED BY THE AUTHORITY
OF THE STATE OF ILLINOIS

CONTRACT NO. 62002

4-10-01
DATE:

SECTION	CHYTY	DATE	BY
80	WILL	92	68
STA.	TO STA.		

• 99 (1, 2, 3, 4 & 4-1195-7)

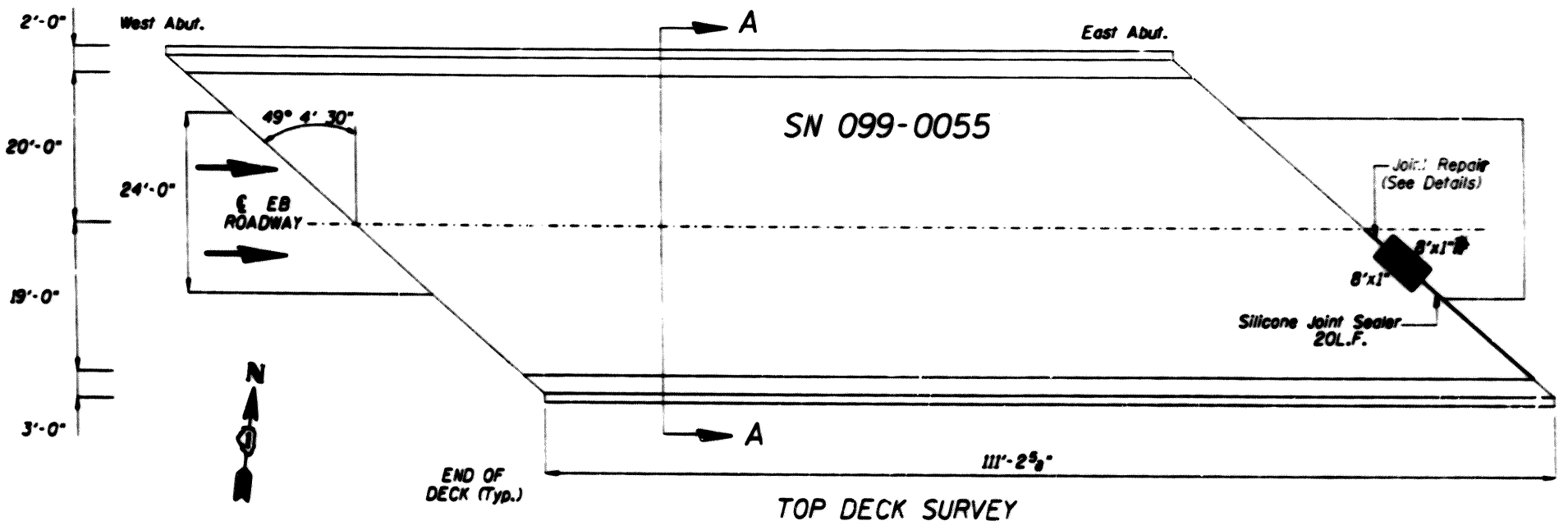
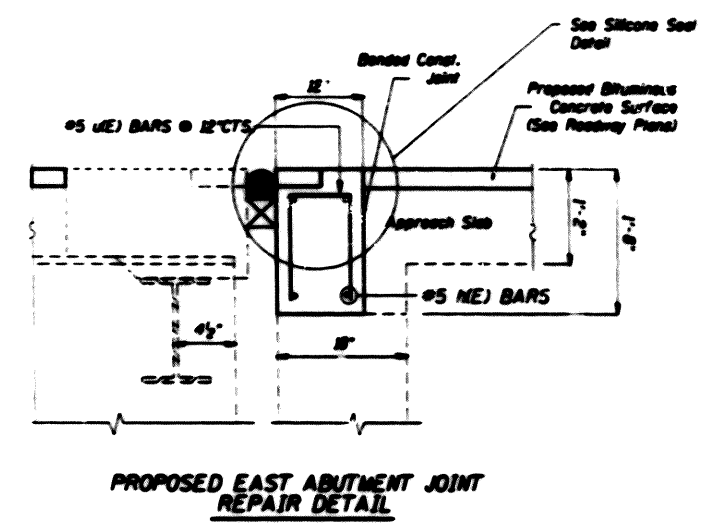
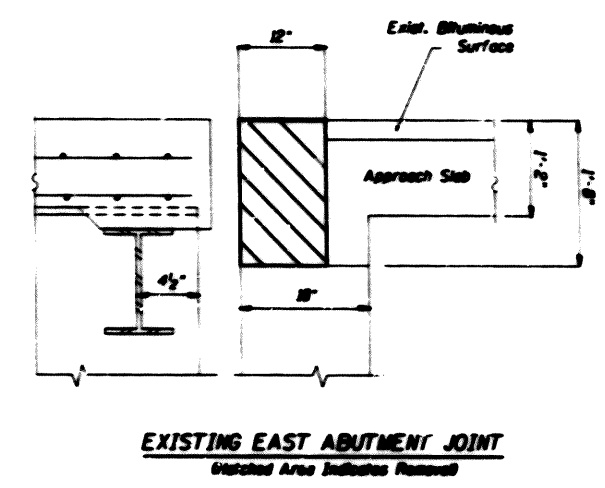
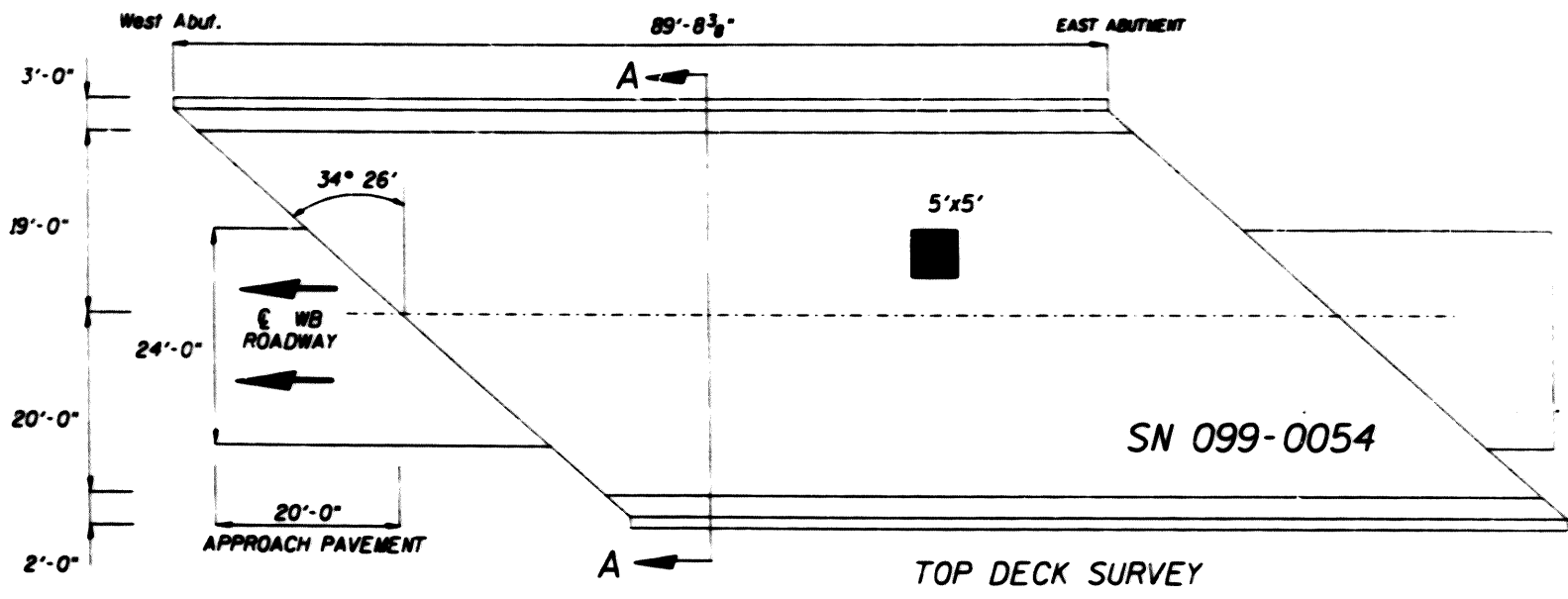

LEGEND
 DECK SLAB REPAIR PARTIAL DEPTH

GENERAL NOTES

PLAN DIMENSIONS AND DETAILS RELATIVE TO EXISTING STRUCTURES HAVE BEEN TAKEN FROM EXISTING PLANS AND ARE SUBJECT TO GENERAL CONSTRUCTION VARIATIONS. IT SHALL BE THE CONTRACTOR'S RESPONSIBILITY TO VERIFY SUCH DIMENSIONS AND DETAILS IN THE FIELD AND MAKE NECESSARY APPROVED ADJUSTMENTS PRIOR TO CONSTRUCTION OR ORDERING OF MATERIALS. SUCH VARIATIONS SHALL NOT BE CAUSE FOR ADDITIONAL COMPENSATION FOR A CHANGE IN THE SCOPE, HOWEVER, THE CONTRACTOR WILL BE PAID FOR THE QUANTITY ACTUALLY FURNISHED AT THE UNIT BID PRICE OF THE WORK.

EXISTING REINFORCEMENT BARS EXTENDING INTO THE REMOVAL AREA SHALL BE CLEANED, STRAIGHTENED AND INCORPORATED INTO THE NEW CONSTRUCTION. ANY REINFORCEMENT BARS THAT ARE DAMAGED DURING CONCRETE REMOVAL SHALL BE REPLACED WITH AN APPROVED BAR SPLICER OR ANCHORAGE SYSTEM COST INCLUDED WITH CONCRETE REMOVAL.

AREAS OF DECK REPAIRS ARE ESTIMATED. THE ACTUAL TYPE AND LOCATION OF THE DECK REPAIRS ARE TO BE DETERMINED BY THE ENGINEER DURING CONSTRUCTION.

THE ENGINEER SHALL MARK THE LOCATIONS OF THE REPAIRS ON THE AS-BUILT PLANS.

DATE OF SURVEY OCTOBER 2000.

TOTAL BILL OF MATERIALS - BRIDGE

Bar	No.	Size	Length	Shape
NEJ	4	#5	7'-9"	—
WEJ	9	#5	2'-11"	┌
ITEM		UNIT	QUANTITY	
Reinforcement Bars (Epoxy Coated)		Pound	50	
Concrete Superstructure		Cu. Yds.	0.5	
Concrete Removal		Cu. Yds.	0.5	
Deck Slab Repair (Partial)		Sq. Yd.	3.6	
Bituminous Concrete Removal (Deck)		Sq. Yd.	875	
Polymerized Bituminous Concrete Surface Course, Superpave, Mix "E", M90		Ton	98	
Waterproofing Membrane System		Sq. Yd.	875	
Polymer Concrete		Cu. Ft.	0.4	
Silicone Joint Sealer		L.F.T.	20	

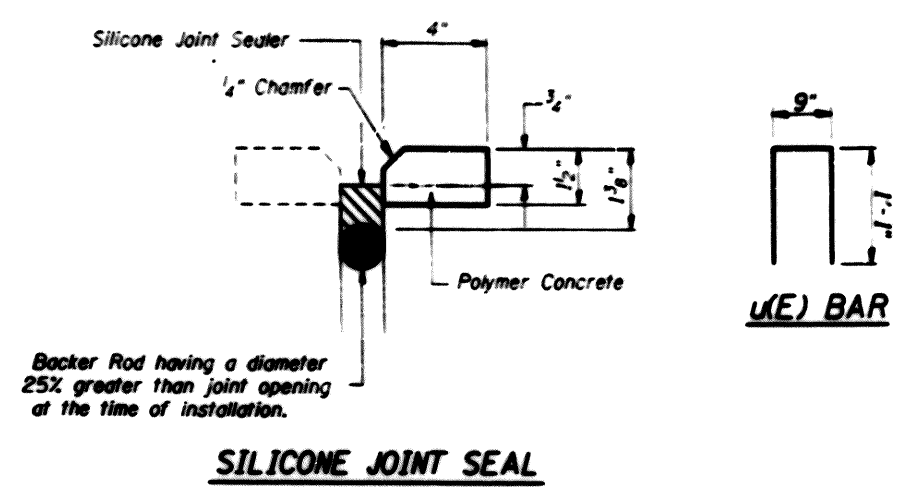
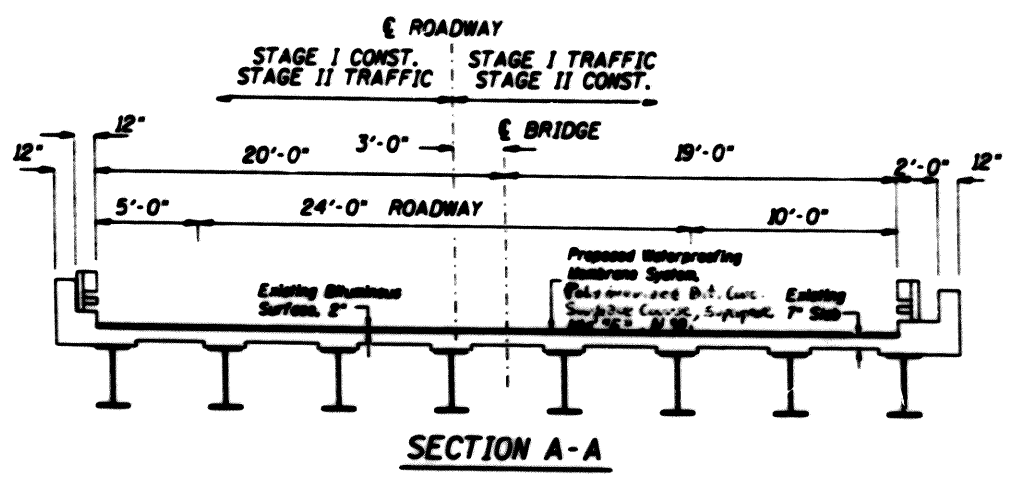

§ Polymer Concrete to be used at this location.

REVISIONS	DATE

ILLINOIS DEPARTMENT OF TRANSPORTATION
 INT. RTE. 80 OVER
 SB CENTER ST TO EB I-80
 SN 099-0054
 SN 099-0055

SCALE: NRE
 DRAWN BY: CABD