

05/14/02 PM 01:11:01 3087.GD:Sheet 1 of 2

DESIGN AND PLAN PREPARATION ENGINEER : K. ENG / M. GOMEZ (847) 705 - 4432

STATE OF ILLINOIS
DEPARTMENT OF TRANSPORTATION
DIVISION OF HIGHWAYS

PROPOSED
HIGHWAY PLANS

F.A.I. ROUTE 80 (INTERSTATE 80)
GRUNDY COUNTY LINE TO ROWELL STREET
RESURFACING (MAINT.) & BRIDGE REPAIRS
SECTION (99 [1,2,3,4] & 4-1) RS-7
C-91-507-00
WILL COUNTY

F.A.I. RTE.	SECTION	COUNTY	TOTAL SHEETS	SHEET NO.
80		WILL	82	1

99 (1,2,3,4 & 4-1) RS-7

D-91-507-00

FOR INDEX OF SHEETS, SEE SHEET NO. 2

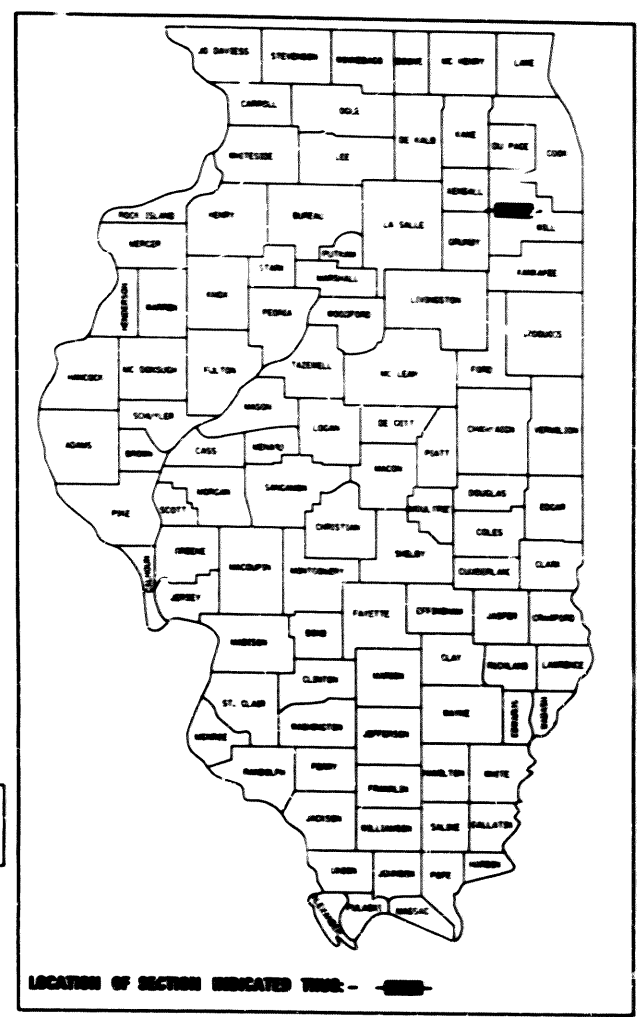

THIS IMPROVEMENT IS LOCATED WITHIN
ROCKDALE AND JOLIET

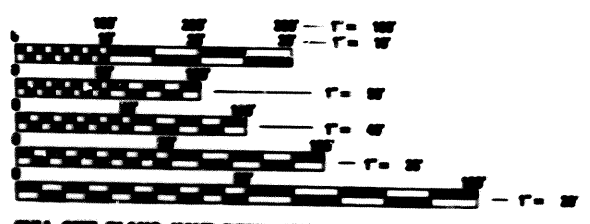
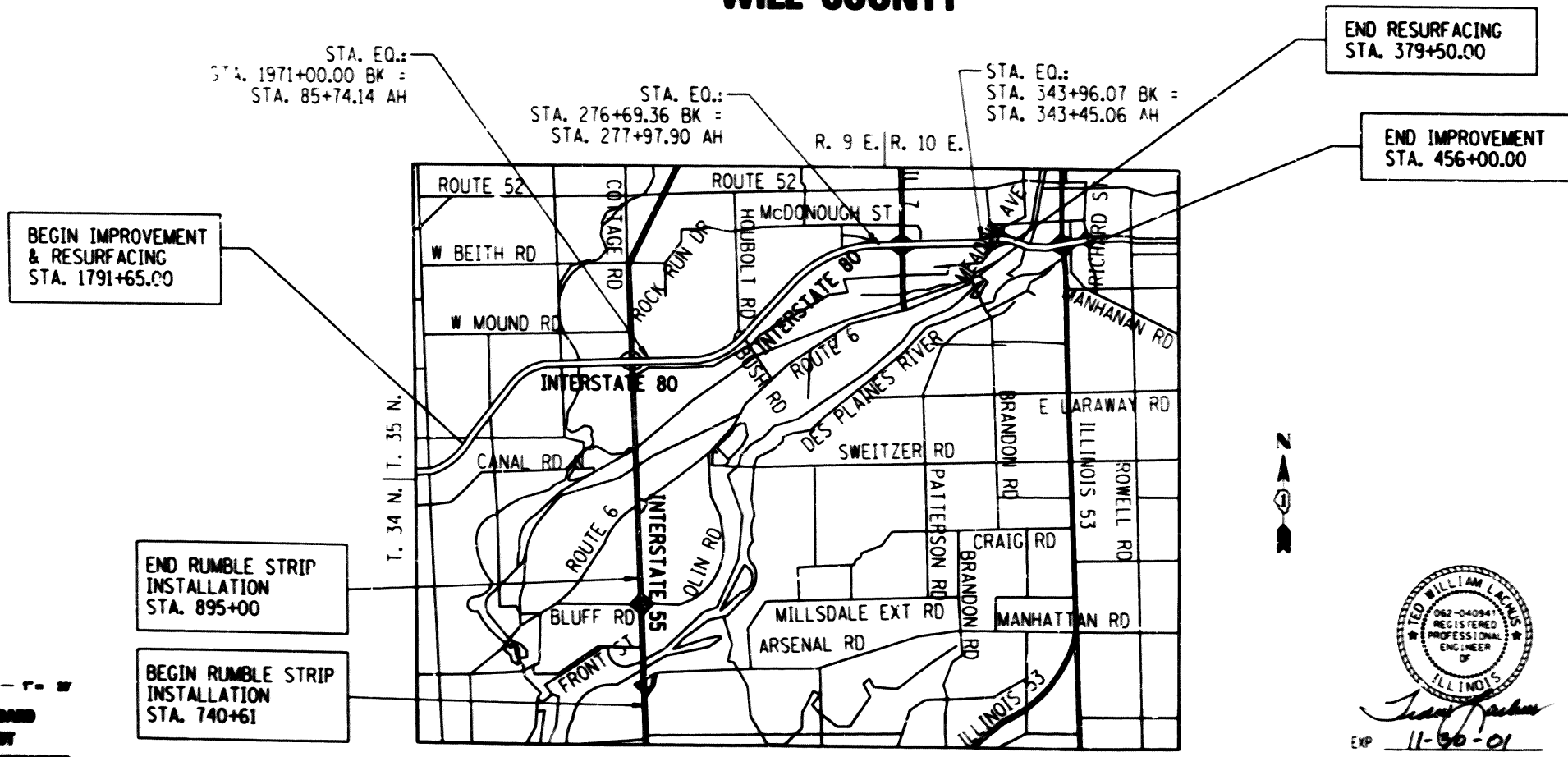

FULL SIZE PLANS HAVE BEEN PREPARED USING STANDARD ENGINEERING SCALE. REDUCED SIZE PLANS WILL NOT CONFORM TO STANDARD SCALE. IN MAKING MEASUREMENTS ON REDUCED PLANS, THE ABOVE SCALES MAY BE USED.

SCALE
JOINT UTILITY LOCATION INFORMATION FOR EXISTENCE
1-800-888-0888

CONTRACT NO. 62002

END RESURFACING
STA. 379+50.00

END IMPROVEMENT
STA. 456+00.00

REGISTERED PROFESSIONAL ENGINEER OF ILLINOIS
 WILLIAM LACUS
 062-04094
 EXP 11-30-01

STATE OF ILLINOIS
DEPARTMENT OF TRANSPORTATION
DIVISION OF HIGHWAYS

SUBMITTED April 12, 2001

James P. Kane DISTRICT ENGINEER

May 11, 2001

Michael A. Hill CHIEF OF BUREAU AND SUPERVISOR

May 11, 2001

James P. Kane DISTRICT ENGINEER

PRINTED BY THE AUTHORITY
OF THE STATE OF ILLINOIS

PATRICK ENGINEERING, INC.
TED R. LACUS, P.E.
062-040941
4-10-01
DATE:

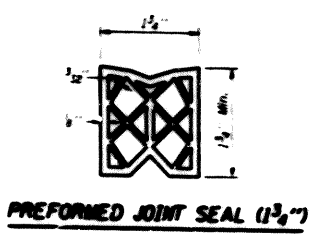
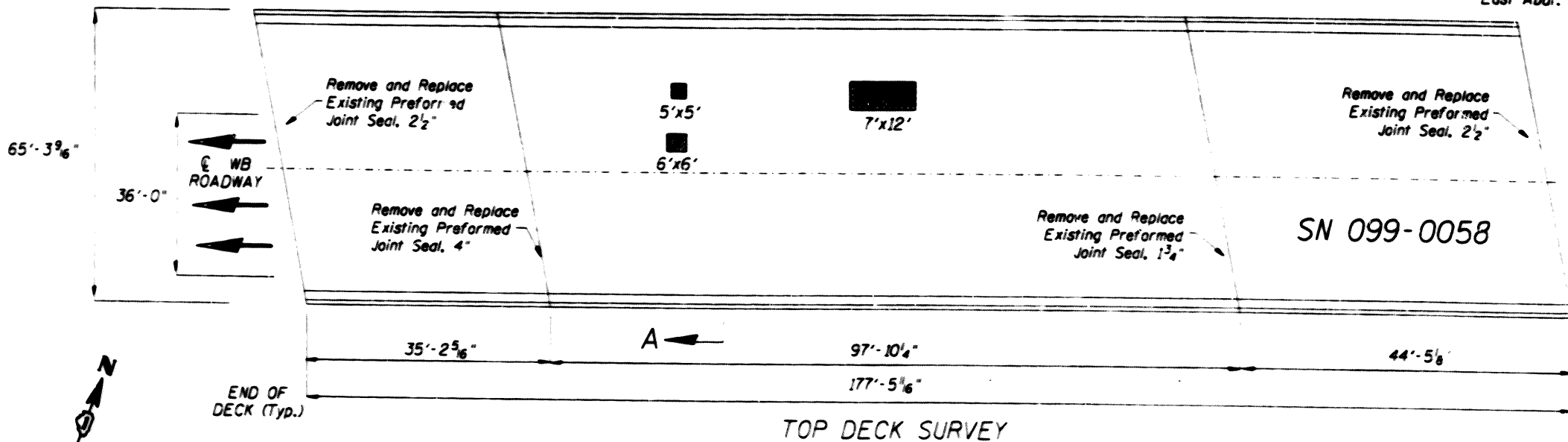

GENERAL NOTES

PLAN DIMENSIONS AND DETAILS RELATIVE TO EXISTING STRUCTURES HAVE BEEN TAKEN FROM EXISTING PLANS AND ARE SUBJECT TO NOMINAL CONSTRUCTION VARIATIONS. IT SHALL BE THE CONTRACTOR'S RESPONSIBILITY TO VERIFY SUCH DIMENSION AND DETAILS IN THE FIELD AND MAKE NECESSARY APPROVED ADJUSTMENTS PRIOR TO CONSTRUCTION OR ORDERING OF MATERIALS. SUCH VARIATION SHALL NOT BE CAUSE FOR ADDITIONAL COMPENSATION FOR A CHANGE IN THE SCOPE. HOWEVER, THE CONTRACTOR WILL BE PAID FOR THE QUANTITY ACTUALLY FURNISHED AT THE UNIT BID PRICE OR THE WORK.

AREAS OF DECK REPAIRS ARE ESTIMATED PERIOD THE ACTUAL TYPE AND LOCATION OF THE DECK REPAIRS ARE TO BE DETERMINED BY THE ENGINEER DURING CONSTRUCTION.

THE ENGINEER SHALL MARK THE LOCATIONS OF THE REPAIRS ON THE AS-BUILT PLANS.

DATE OF SURVEY OCTOBER 2000.

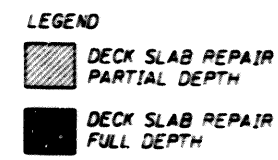

THE CONTRACTOR SHALL GRIND OFF THE EXISTING CONCRETE PATCHES. THIS IS INCLUDED IN THE COST OF 'BITUMINOUS CONCRETE REMOVAL (DECK)'.

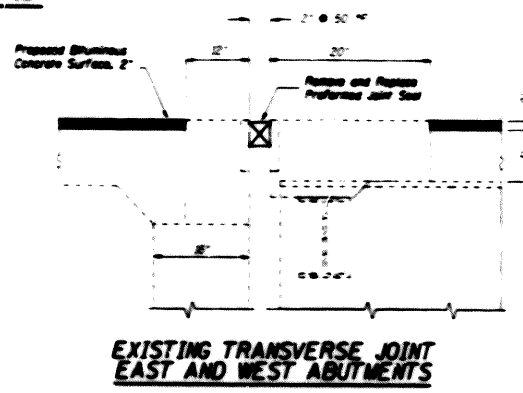
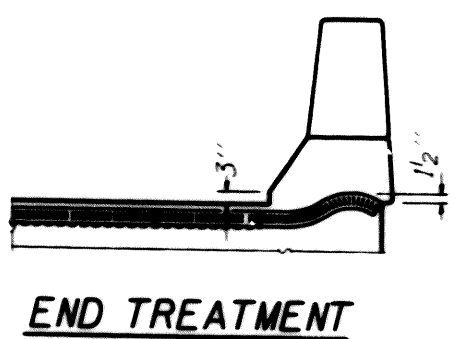
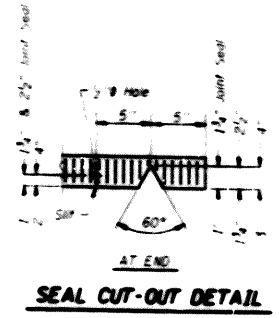
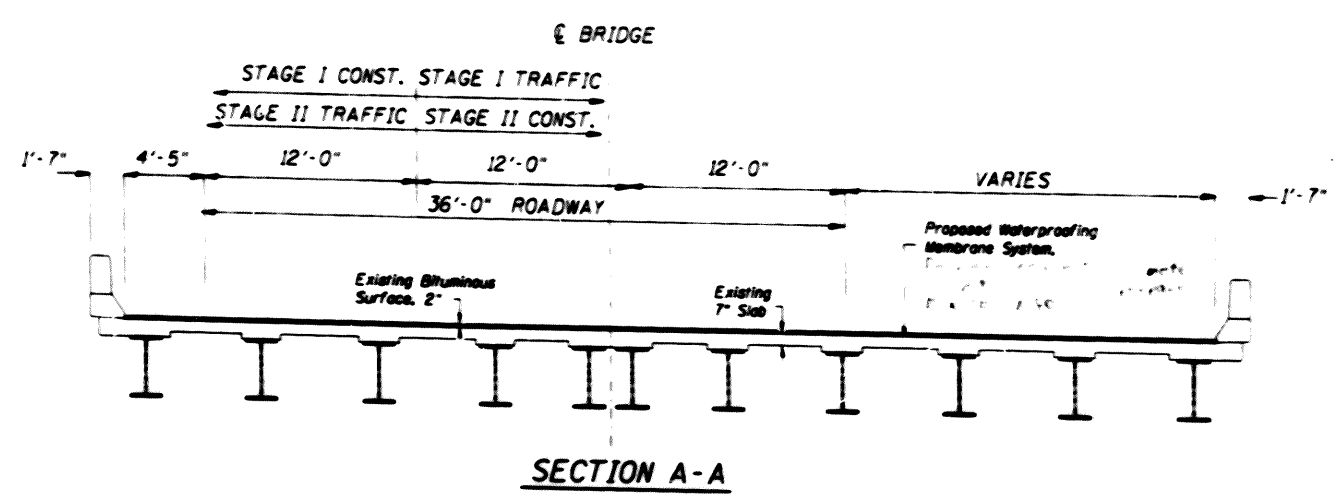
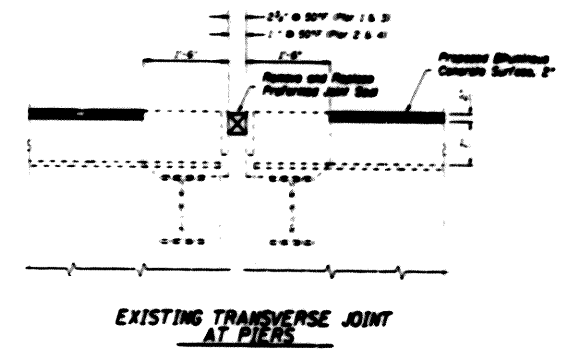
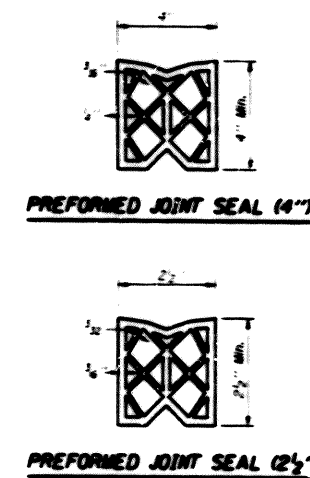
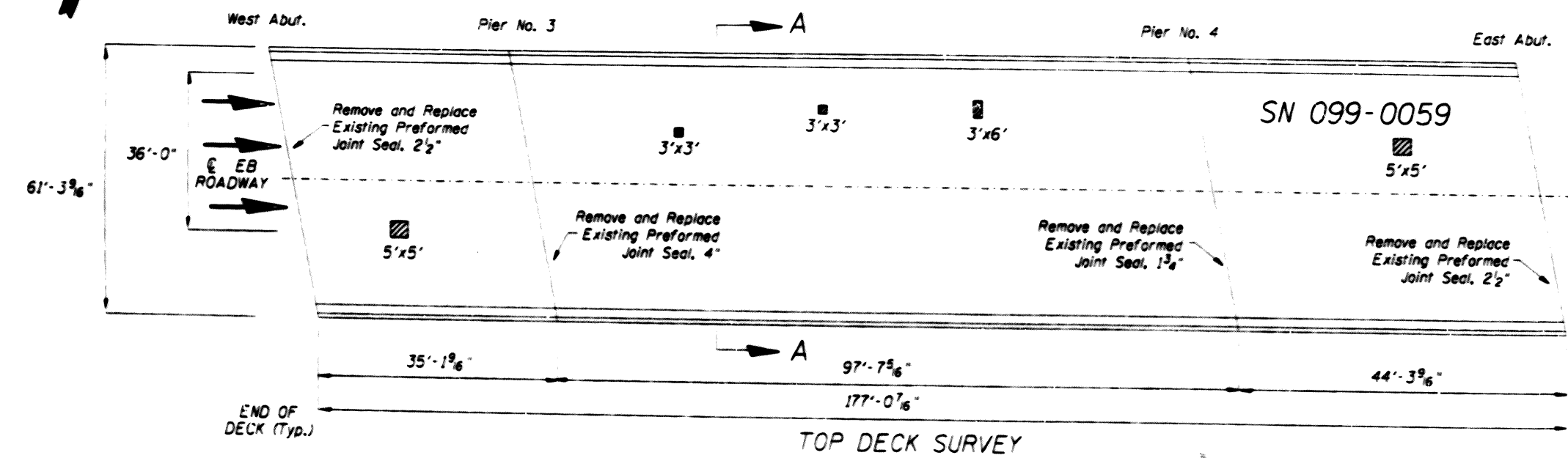

TOTAL BILL OF MATERIALS - BRIDGE

ITEM	UNIT	QUANTITY
Preformed Joint Seal, 1 3/4"	Foot	132
Preformed Joint Seal, 2 1/2"	Foot	264
Preformed Joint Seal, 4"	Foot	132
Deck Slab Repair (Partial)	Sq. Yd.	17
Deck Slab Repair (Full Depth)	Sq. Yd.	10
Polymerized Bituminous Concrete Surface Course, Superpave, Mix "E", N90	Ton.	264
Waterproofing Membrane System	Sq. Yd.	2360
Bituminous Concrete Removal (Deck)	Sq. Yd.	2360
Protective Shield	Sq. Yd.	10

ILLINOIS DEPARTMENT OF TRANSPORTATION
 INTERSTATE RTE. 80 OVER
 ILLINOIS RTE. 53
 SN 099-0058
 SN 099-0059

SCALE: NONE
 DATE: 11/11/00
 DRAWN BY: CAD
 CHECKED BY: TMS