

05/14/02 PM 01:11:01 0017.GD:Sheet 1 of 2

CONTRACT 1 - DESIGN AND PLAN PREPARATION ENGINEER : K. ENG / M. GOMEZ (847) 705 - 4432

STATE OF ILLINOIS
DEPARTMENT OF TRANSPORTATION
DIVISION OF HIGHWAYS

PROPOSED
HIGHWAY PLANS

F.A.I. ROUTE 80 (INTERSTATE 80)
GRUNDY COUNTY LINE TO ROWELL STREET
RESURFACING (MAINT.) & BRIDGE REPAIRS
SECTION (99 [1,2,3,4] & 4-1) RS-7
C-91-507-00
WILL COUNTY

F.A.I. RTE.	SECTION	COUNTY	TOTAL SHEETS	SHEET NO.
80		WILL	82	1

99 (1,2,3,4 & 4-1) RS-7

D-91-507-00

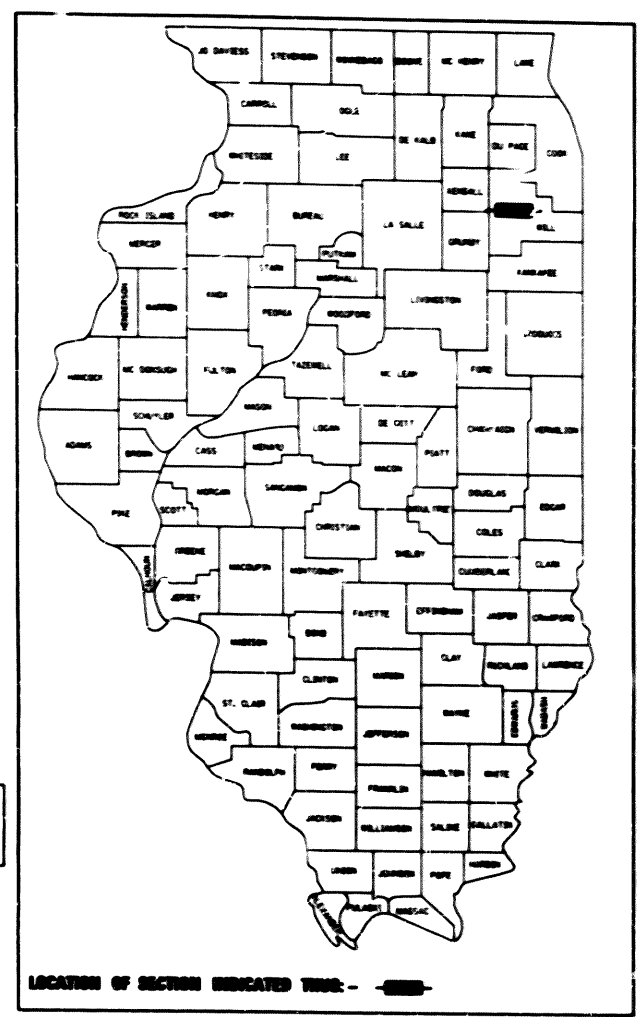

FOR INDEX OF SHEETS, SEE SHEET NO. 2

THIS IMPROVEMENT IS LOCATED WITHIN ROCKDALE AND JOLIET

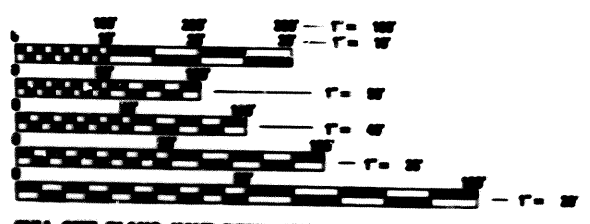
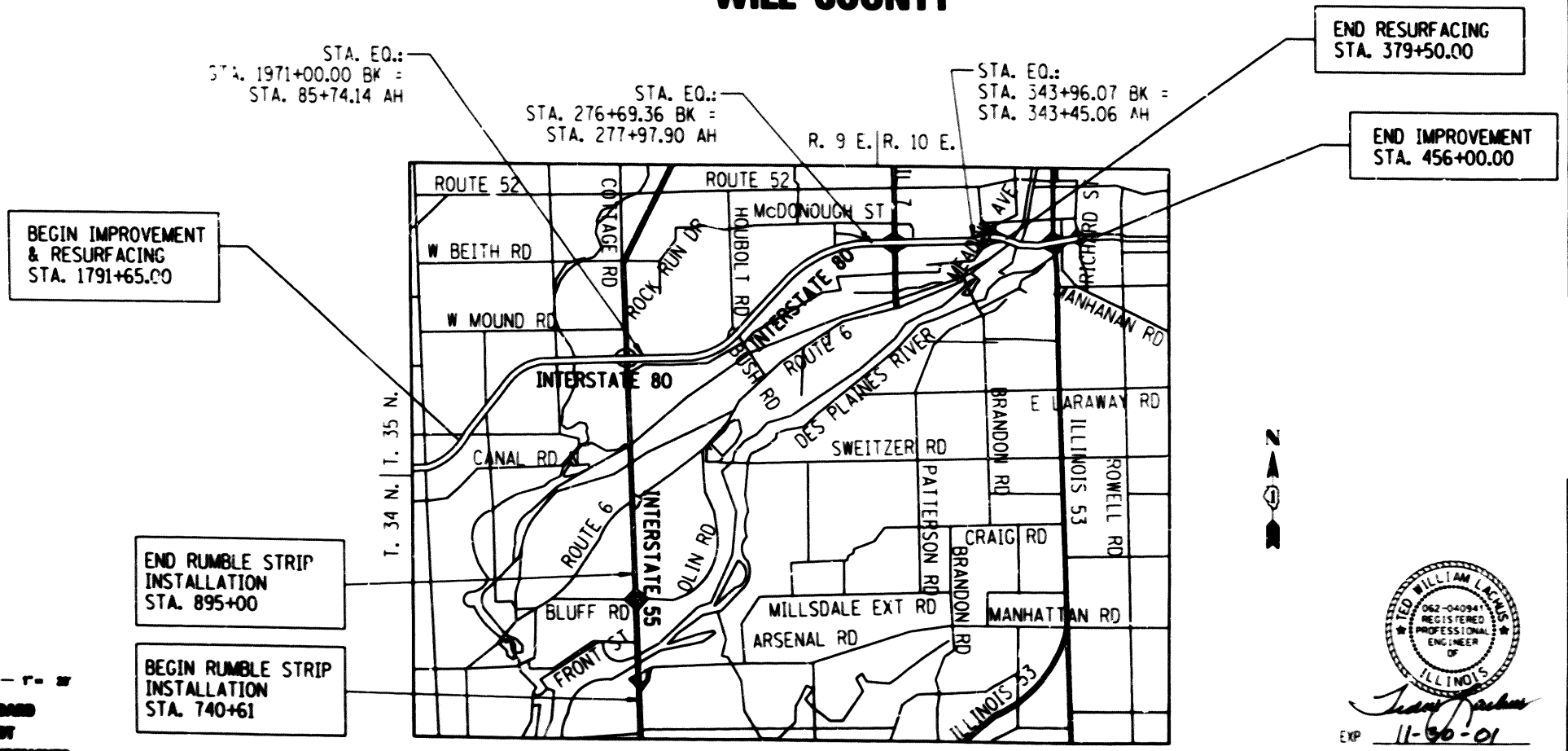

FULL SIZE PLANS HAVE BEEN PREPARED USING STANDARD ENGINEERING SCALE. REDUCED SIZE PLANS WILL NOT CONFORM TO STANDARD SCALE. IN MAKING MEASUREMENTS ON REDUCED PLANS, THE ABOVE SCALES MAY BE USED.

JALAE
 JOHN SMITH LOCATION INFORMATION FOR ELEVATION
 1-800-888-0828

TRAFFIC DATA
 INTERSTATE 80
 WEST OF LARKIN AVE.
 1999 ADT = 35,000
 SPEED LIMIT: 55 MPH

TRAFFIC DATA
 INTERSTATE 80
 EAST OF LARKIN AVE.
 1999 ADT = 74,500
 SPEED LIMIT: 45-55 MPH

LOCATION MAP
 GROSS LENGTH OF SECTION = 47,342.55LF = 8.966 MILES
 NET LENGTH OF SECTION = 44,479 LF = 8.424 MILES
 MAP SCALE
 1"=6000'

STATION EQUATIONS
 1971+00 BK = 85+74.14 AH
 276+69.36 BK = 277+97.90 AH
 342+96.07 BK = 343+45.06 AH

PATRICK ENGINEERING, INC.
 TED R. LACUS, P.E.
 # 062-040941

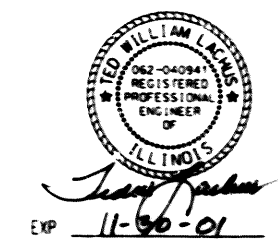

STATE OF ILLINOIS
 DEPARTMENT OF TRANSPORTATION
 DIVISION OF HIGHWAYS

SUBMITTED April 12, 2001
John P. Kane DISTRICT ENGINEER
May 11, 2001
Michael A. Hill CHIEF OF BUREAU AND SUPERVISOR
May 11, 2001
James P. Stiles DISTRICT CHIEF OF HIGHWAYS

PRINTED BY THE AUTHORITY
OF THE STATE OF ILLINOIS

CONTRACT NO. 62002

4-10-01
 DATE:

SECTION	COUNTY	TOWNSHIP	RANGE
80	WILL	8A	7E
STA.	10 STA.		
FILE NO.	DATE	FILE NO.	

• 99 (1, 2, 3, 4 & 4-1175-7

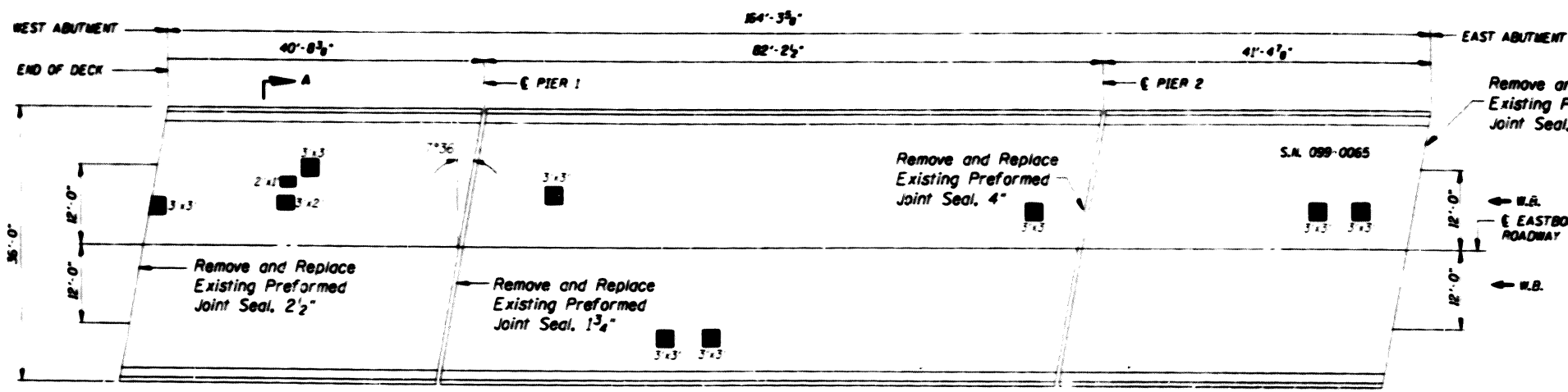

LEGEND
 DECK SLAB REPAIR PARTIAL DEPTH
 DECK SLAB REPAIR FULL DEPTH

GENERAL NOTES

PLAN DIMENSIONS AND DETAILS RELATIVE TO EXISTING STRUCTURES HAVE BEEN TAKEN FROM EXISTING PLANS AND ARE SUBJECT TO NOMINAL CONSTRUCTION VARIATIONS. IT SHALL BE THE CONTRACTOR'S RESPONSIBILITY TO VERIFY SUCH DIMENSION AND DETAILS IN THE FIELD AND MAKE NECESSARY APPROVED ADJUSTMENTS PRIOR TO CONSTRUCTION OR ORDERING OF MATERIALS. SUCH VARIATION SHALL NOT BE CAUSE FOR ADDITIONAL COMPENSATION FOR A CHANGE IN THE SCOPE. HOWEVER, THE CONTRACTOR WILL BE PAID FOR THE QUANTITY ACTUALLY FURNISHED AT THE UNIT BID PRICE OF THE WORK.

AREAS OF DECK REPAIRS ARE ESTIMATED THE ACTUAL TYPE AND LOCATION OF THE DECK REPAIRS ARE TO BE DETERMINED BY THE ENGINEER DURING CONSTRUCTION.

THE ENGINEER SHALL MARK THE LOCATIONS OF THE REPAIRS ON THE AS-BUILT PLANS.

DATE OF SURVEY OCTOBER 2000.

THE CONTRACTOR SHALL GRIND OFF THE EXISTING CONCRETE PATCHES. THIS IS INCLUDED IN THE COST OF BITUMINOUS CONCRETE REMOVAL (DECK).

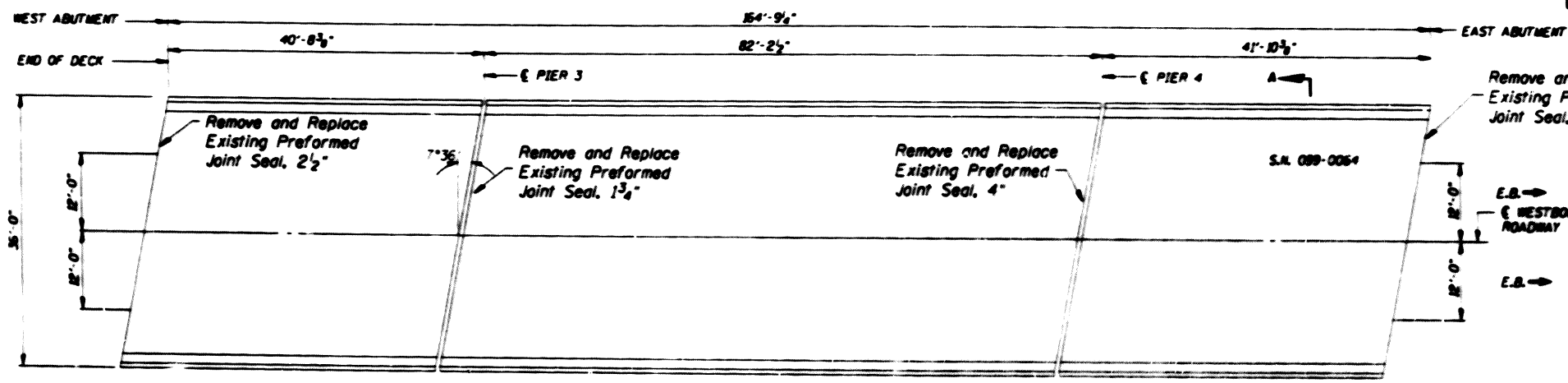

TOTAL BILL OF MATERIALS - BRIDGE

ITEM	UNIT	QUANTITY
Preformed Joint Seal, 1 3/4"	Foot	148
Preformed Joint Seal, 2 1/2"	Foot	74
Preformed Joint Seal, 4"	Foot	74
Deck Slab Repair (Partial)	Sq. Yd.	8
Deck Slab Repair (Full Depth, Type I)	Sq. Yd.	1
Bituminous Concrete Removal (Deck)	Sq. Yd.	1066
Polymerized Bituminous Concrete Surface Course, Superpave, Mix "E", N90	Ton.	120
Waterproofing Membrane System	Sq. Yd.	1066

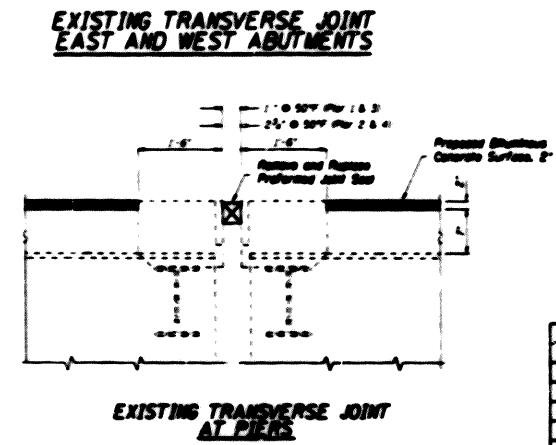
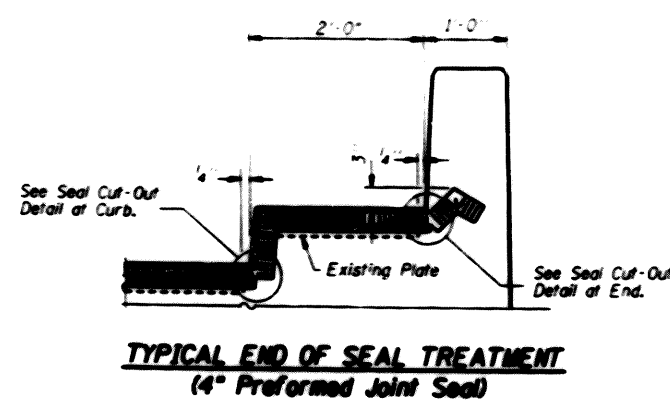
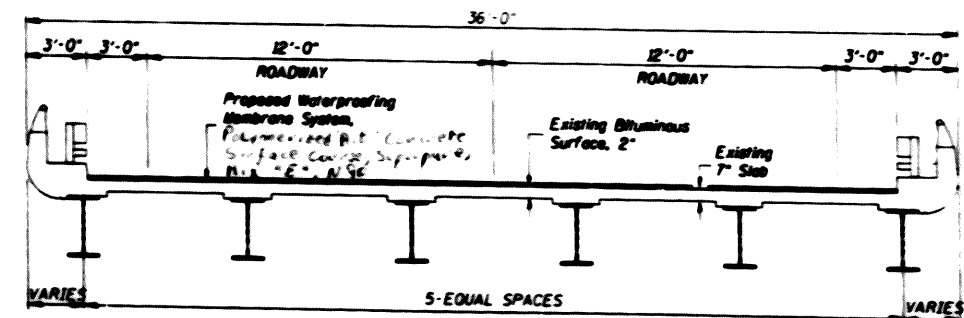
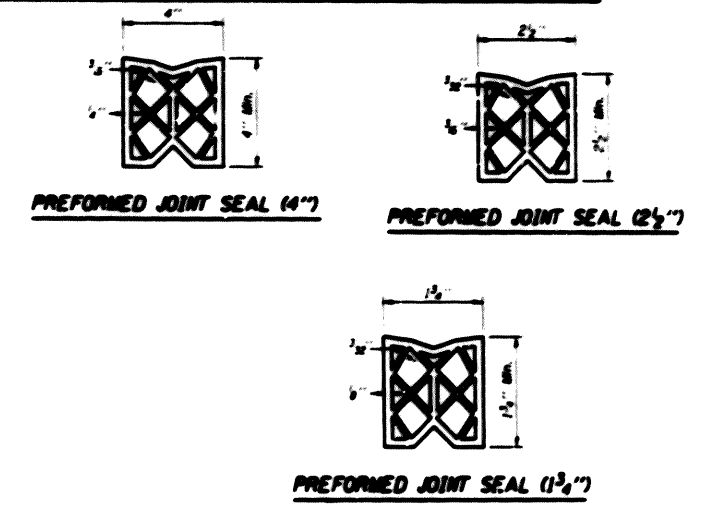
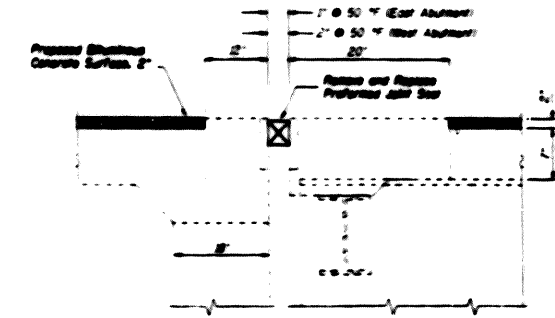
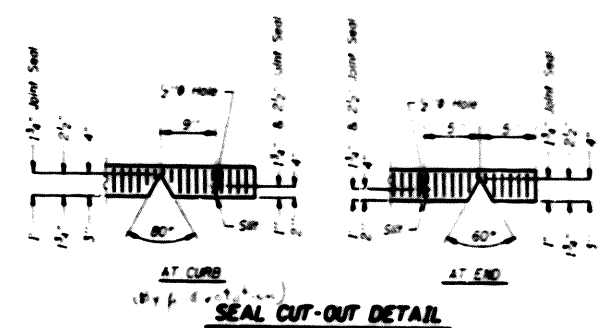
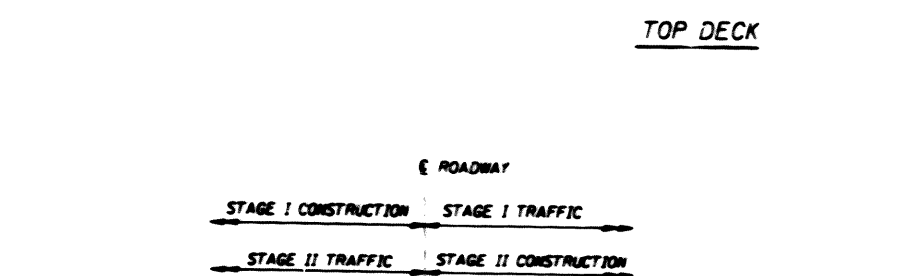

REVISIONS	
NO.	DATE

ILLINOIS DEPARTMENT OF TRANSPORTATION
 INTERSTATE RTE. 80 OVER
 RICHARDS STREET
 SN 099-0064 (EASTBOUND)
 SN 099-0065 (WESTBOUND)

SCALE: NONE
 DRAWN BY CAD
 CHECKED BY JTB