

033

STATE OF ILLINOIS
DEPARTMENT OF TRANSPORTATION

F.A.P. RTE	SECTION	COUNTY	TOTAL SHEETS	SHEET NO
71	(113, 112)RS-3	ILLINOIS	13	1

CONTRACT NO. 66E15
FORD & IROQUOIS

INDEX OF SHEETS

1	COVER SHEET
2	GENERAL NOTES
3-5	SUMMARY OF QUANTITIES
6-8	SCHEDULES
9-11	TYPICAL SECTIONS
12-13	DETAILS

LIST OF ILLINOIS DOT HIGHWAY STANDARDS

000001-07	STANDARD SYMBOLS, ABBREVIATIONS AND PATTERNS
001006	DECIMAL OF AN INCH AND OF A FOOT
482011-03	HMA SHOULDER STRIPS/SHOULDERS WITH RS OR WIDENING & RS PROJECTS
630001-12	STEEL PLATE BEAM GUARDRAIL
630201-07	PCC/HMA STABILIZATION AT STEEL PLATE BEAM GUARDRAIL
630301-09	SHOULDER WIDENING FOR TYPE 1 (SPECIAL) GUARDRAIL TERMINALS
631025-06	TRAFFIC BARRIER TERMINAL TYPE 5
701001-02	OFF-ROAD OPERATIONS 2L, 2W, MORE THAN 15' (4.5 m) AWAY
701006-05	OFF-ROAD OPERATIONS 2L, 2W, 15' (4.5 m) TO 24' (600 mm) FROM PAVEMENT EDGE
701301-04	LANE CLOSURE, 2L, 2W, SHORT TIME OPERATIONS
701306-04	LANE CLDSURE, 2L, 2W, SLOW MOVING OPERATIONS DAY ONLY, FOR SPEEDS ≥ 45 MPH
701311-03	LANE CLOSURE, 2L, 2W, MOVING OPERATIONS - DAY ONLY
701901-08	TRAFFIC CONTROL DEVICES
780001-05	TYPICAL PAVEMENT MARKINGS
781001-04	TYPICAL APPLICATIONS RAISED REFLECTIVE PAVEMENT MARKERS
782006-01	GUARDRAIL AND BARRIER WALL REFLECTOR MOUNTING DETAILS

PROPOSED HIGHWAY PLANS

FAP ROUTE 71 (IL 54)
SECTION (113, 112)RS-3
PROJECT STP-W3T3(507)
3P MILLING & RESURFACING
FORD & IROQUOIS COUNTIES

C-93-151-14



COUNTY LINE
STA. 270 + 05

BEGINNING OF PROJECT
STA. 30 + 32
PAVEMENT JOINT EAST
OF IL 115

END OF PROJECT
STA. 222 + 42 (SN 038-0213)
WEST APPROACH PAVEMENT OF
SN 038-0213 OVER SPRING CREEK

MINOR ARTERIAL
ADT (2017) = 1000
P.V. = 78.0%
S.U. = 6.0%
M.U. = 16.0%

STATION EQUATION
363 + 26(BK) = 266 + 80 (AH)



FULL SIZE PLANS HAVE BEEN PREPARED USING STANDARD ENGINEERING SCALES. REDUCED SIZED PLANS WILL NOT CONFORM TO STANDARD SCALES. IN MAKING MEASUREMENTS ON REDUCED PLANS, THE ABOVE SCALES MAY BE USED.

J.U.L.I.E.
JOINT UTILITY LOCATION INFORMATION FOR EXCAVATION
1-800-892-0123
OR 811

PROJECT ENGINEER: BRAD DUNCAN, P.E.
UNIT CHIEF: ALEX NUGENT
DISTRICT 3 NO. (815) 434-6131
CONTRACT NO. 66E15

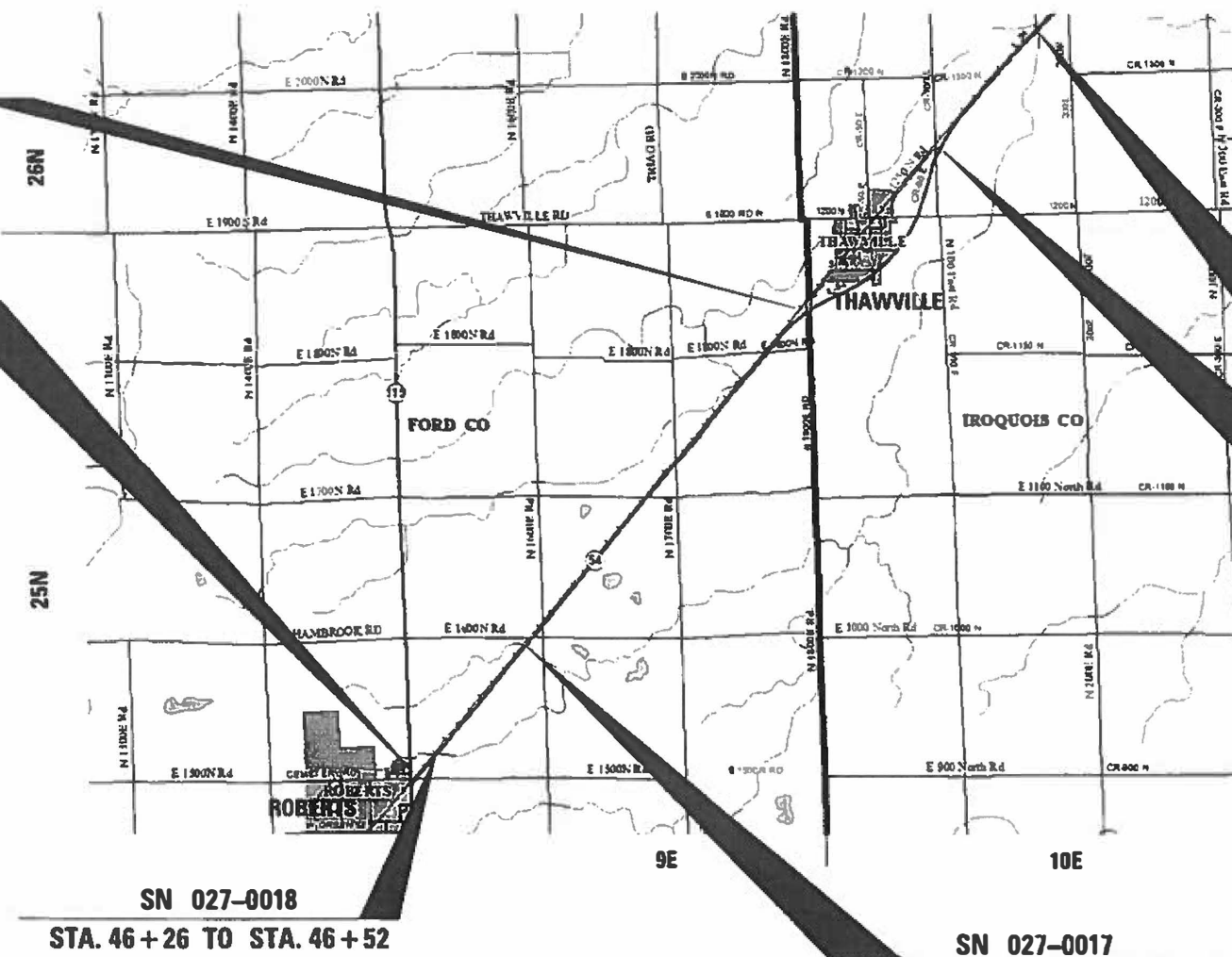

GROSS LENGTH = 37,893 FT. = 7.18 MILE
NET LENGTH = 37,893 FT. = 7.18 MILE

STATE OF ILLINOIS
DEPARTMENT OF TRANSPORTATION

SUBMITTED Jan 30, 2020

REGIONAL ENGINEER
March 20, 2020

ENGINEER OF DESIGN AND ENVIRONMENT
March 20, 2020

DIRECTOR OF HIGHWAYS PROJECT IMPLEMENTATION

PRINTED BY THE AUTHORITY
OF THE STATE OF ILLINOIS

MODEL: Default
 FILE NAME: P:\uplanroom.dat\illinois.gov\PWIDOT\Documents\DOT_Offices\District_3\Project\0366E15\CADD\0366E15-shr-500.dgn

CODE NO.	ITEM	UNIT	TOTAL QUANTITY	CONSTRUCTION CODE	
				80% FEDERAL 20% STATE ROADWAY	80% FEDERAL 20% STATE ROADWAY
				0005 FORD	0005 IROQUOIS
20200100	EARTH EXCAVATION	CU YD	88	88	
40200800	AGGREGATE SURFACE COURSE, TYPE B	TON	108	60	48
40600290	BITUMINOUS MATERIALS (TACK COAT)	POUND	10165	6266	3899
40600400	MIXTURE FOR CRACKS, JOINTS, AND FLANGWAYS	TON	32	20	12
40600900	HOT-MIX ASPHALT BINDER COURSE (HAND METHOD), N50	TON	55	34	21
40600990	TEMPORARY RAMP	SQ YD	584	322	262
40602965	HOT-MIX ASPHALT BINDER COURSE, IL-9.5FG, N50	TON	7577	4707	2870
40604000	HOT-MIX ASPHALT SURFACE COURSE, IL-9.5FG, MIX "C", N50	TON	7630	4760	2870
40800050	INCIDENTAL HOT-MIX ASPHALT SURFACING	TON	557	327	230
44000153	HOT-MIX ASPHALT SURFACE REMOVAL, 1"	SQ YD	255	255	
44000159	HOT-MIX ASPHALT SURFACE REMOVAL, 2 1/2"	SQ YD	108824	67819	41005
48102100	AGGREGATE WEDGE SHOULDER, TYPE B	TON	2145	1336	809
* 63000001	STEEL PLATE BEAM GUARDRAIL, TYPE A, 6 FOOT POSTS	FOOT	850	850	
* 63100075	TRAFFIC BARRIER TERMINAL, TYPE 5A	EACH	8	8	

*= SPECIALTY ITEM

USER NAME = duncanbd	DESIGNED -	REVISED -	STATE OF ILLINOIS DEPARTMENT OF TRANSPORTATION	SUMMARY OF QUANTITIES			F.A.P. RTE.	SECTION	COUNTY	TOTAL SHEETS	SHEET NO.
PLOT SCALE = 100.0000' / in.	DRAWN -	REVISED -		71	(113, 112)RS-3	"	13	3			
PLOT DATE = 1/30/2020	CHECKED -	REVISED -		CONTRACT NO. 66E15							
	DATE -	REVISED -		SCALE:	SHEET 1 OF 3 SHEETS	STA.	TO STA.	ILLINOIS FED. AID PROJECT			

GUARDRAIL SCHEDULE										
STRUCTURE	QUAD	LENGTH OF NEED FOOT	SPBGR TYP A 6' POST FOOT	TRAF BAR TERM TYP 1 (SPL) TANGENT EACH	TRAF BAR TERM TYP 5A EACH	GUARDRAIL REFLECTORS TYPE A EACH	TERM MARK DA EACH	GUARDRAIL REMOVAL FOOT	EARTH EX* CU YD	HMA STAB 6" AT SPBGR SQ YD
SN 027-0018	NW	179	137.5	1	1	3	1	215	13	76
	SW	121	75	1	1	2	1	140	9	56
	NE	121	75	1	1	2	1	140	9	56
	SE	179	137.5	1	1	3	1	215	13	76
SN 027-0017	NW	179	137.5	1	1	3	1	140	13	76
	SW	121	75	1	1	2	1	215	9	56
	NE	121	75	1	1	2	1	178	9	56
	SE	179	137.5	1	1	3	1	140	13	76
PROJECT TOTAL (FORD COUNTY)			850	8	8	20	8	1383	88	528

*EARTH EX FROM GUARDRAIL SHOULDER STABILIZATION TO BE USED AS FURNISHED EX AROUND SIDEROAD RADIUS



ILL. RTE. 54		LOCATION: IL 115 IN ROBERTS TO SPRING CREEK				FORD COUNTY	
MONUMENT NUMBER	DESCRIPTION	EXISTING MONUMENT TYPE	PROPOSED MONUMENT TYPE	MONUMENT RECORD TO BE RECORDED	RESPONSIBILITY		
N/A	NO PERMANENT SURVEY MARKERS OR SECTION CORNER MARKERS TO BE SET ON THIS JOB	N/A	N/A	N/A	N/A		
<p>NO KNOWN SURVEY OR CENTERLINE CONTROL MONUMENTS ARE ON THE ROAD SURFACE THAT WILL BE DISTURBED BY THE RESURFACING. R.E. WILL DIRECT PLATS AND PLANS TO SEARCH FOR ADDITIONAL MONUMENTS IF THE JOB LIMITS ARE EXPANDED DURING CONSTRUCTION. UNKNOWN MONUMENTS MAY EXIST. IF FOUND, R.E. MUST TIE AND REQUEST PLATS AND PLANS PERSONNEL TO GPS ANY UNKNOWN MONUMENT WHICH IS SUBJECT TO DESTRUCTION BY THE RESURFACING WORK, AND INFORM THEM TO RESET THE MONUMENT UPON JOB COMPLETION. NO MONUMENT RECORDS ARE REQUIRED FOR THIS JOB.</p>							

MODEL: Default
FILE: h:\m\c\p\pub\h\m\com\data\illinois\pwr\WIDOT\Documents\DOT_Offices\Director_3\Projects\0366E15\CADD\data\0366E15-shc-schedule.dgn

Revised 4/9/2020 BDD

USER NAME = duncanbd	DESIGNED -	REVISED -	STATE OF ILLINOIS DEPARTMENT OF TRANSPORTATION	SCHEDULES			F.A.P. RTE. 71	SECTION (113, 112)RS-3	COUNTY *	TOTAL SHEETS 13	SHEET NO. 8
PLOT SCALE = 100,0000 ' / in.	CHECKED -	REVISED -		SCALE:	SHEET 3	OF 3	SHEETS	STA.	TO STA.	CONTRACT NO. 66E15	
PLOT DATE = 4/9/2020	DATE -	REVISED -		ILLINOIS FED. AID PROJECT							
*FORD & IROQUOIS											