

INDEX OF SHEETS

1 COVER SHEET
 2 INDEX OF SHEETS, STANDARDS, AND GENERAL NOTES
 3 SOIL EROSION AND SEDIMENTATION CONTROL NOTES
 4 - 13 SUMMARY OF QUANTITIES
 14 - 15 TYPICAL SECTIONS - PULASKI ROAD
 16 - 17 TYPICAL SECTIONS - FORD CITY DRIVE
 18 - 19 ALIGNMENT, TIES AND BENCHMARKS
 20 - 21 REMOVAL PLAN - PULASKI ROAD
 22 - 24 REMOVAL PLAN - FORD CITY DRIVE
 25 - 26 ROADWAY PLAN - PULASKI ROAD
 27 - 28 ROADWAY PLAN - FORD CITY DRIVE
 29 - 30 MAINTENANCE OF TRAFFIC - DETOUR PLAN
 31 MAINTENANCE OF TRAFFIC - STAGE I
 32 - 35 MAINTENANCE OF TRAFFIC - STAGE II
 36 - 39 MAINTENANCE OF TRAFFIC - STAGE III
 40 EROSION AND SEDIMENT CONTROL PLAN
 41 - 42 DRAINAGE PLAN - PULASKI ROAD
 43 - 45 DRAINAGE PLAN - FORD CITY DRIVE
 46 - 47 PAVEMENT MARKING PLANS - PULASKI ROAD
 48 - 49 PAVEMENT MARKING PLANS - FORD CITY DRIVE
 50 PROPOSED GRADING PLAN
 51 LANDSCAPE PLAN
 52 - 61 LIGHTING DETAILS
 62 - 63 TRAFFIC SIGNAL DETAILS
 64 - 65 SIDEWALK DETAILS AND ADA RAMPS
 66 - 71 EXISTING STRUCTURE PLANS
 72 BD-08 FRAMES AND LIDS ADJUSTMENT WITH MILLING
 73 BD-09 CITY OF CHICAGO DRAINAGE DETAILS
 74 BD-17 CITY OF CHICAGO PCC CONC DRIVEWAY, ALLEY RETURN AND SIDEWALK
 75 BD-24 CURB OR CURB AND GUTTER REMOVAL AND REPLACEMENT
 76 BD-32 BUTT JOINTS AND HMA TAPER
 77 BD-47 CITY OF CHICAGO CATCH BASIN, INLET AND MANHOLE DETAILS
 78 TC-10 TRAFFIC CONTROL AND PROTECTION FOR SIDE ROADS, INTERSECTIONS AND DRIVEWAYS
 79 TC-14 TRAFFIC CONTROL AND PROTECTION AT TURN BAYS (TO REMAIN OPEN TO TRAFFIC)
 80 TC-16 SHORT-TERM PAVEMENT MARKING LETTERS AND SYMBOLS
 81 TC-21 DETOUR SIGNING FOR CLOSING STATE HIGHWAYS
 82 TC-22 ARTERIAL ROAD INFORMATION SIGN
 83 - 85 TC-24 CITY OF CHICAGO TYPICAL PAVEMENT MARKING
 86 TC-26 DRIVEWAY ENTRANCE SIGNING
 87 - 98 PROPOSED CROSS SECTIONS - PULASKI ROAD
 99 - 110 PROPOSED CROSS SECTIONS - FORD CITY DRIVE

ILLINOIS DOT HIGHWAY STANDARDS

000001-07 STANDARD SYMBOLS, ABBREVIATIONS AND PATTERNS
 001006-00 DECIMAL OF AN INCH AND OF A FOOT
 280001-07 TEMPORARY EROSION CONTROL SYSTEMS
 424001-11 PERPENDICULAR CURB RAMPS FOR SIDEWALKS
 424021-05 DEPRESSED CORNER FOR SIDEWALKS
 424031-02 MEDIAN PEDESTRIAN CROSSINGS
 542501-02 INLET BOX TYPE 24 (600) A
 601001-05 PIPE UNDERDRAINS
 602011-02 CATCH BASIN, TYPE C
 602401-06 PRECAST MANHOLE, TYPE A, 4' (1.22 M) DIAMETER
 602701-02 MANHOLE STEPS
 604001-05 FRAME AND LIDS, TYPE 1
 604036-03 GRATE, TYPE 8
 604061-03 FRAME AND GRATE, TYPE 12
 606001-07 CONCRETE CURB TYPE B AND COMBINATION CONCRETE CURB AND GUTTER
 606301-04 PC CONCRETE ISLANDS AND MEDIANS
 701101-05 OFF-ROAD OPERATIONS, MULTILANE, 15' (4.5 M) TO 24" (600 MM) FROM PAVEMENT EDGE
 701106-02 OFF-ROAD OPERATIONS, MULTILANE, MORE THAN 15' (4.5 M) AWAY
 701427-05 LANE CLOSURE, MULTILANE, INTERMITTENT OR MOVING OPERATION, FOR SPEEDS = 40 MPH
 701606-10 URBAN SINGLE LANE CLOSURE, MULTILANE, 2W WITH MOUNTABLE MEDIAN
 701611-01 URBAN HALF ROAD CLOSURE, MULTILANE, 2W WITH MOUNTABLE MEDIAN
 701701-10 URBAN LANE CLOSURE, MULTILANE INTERSECTION
 701801-06 SIDEWALK, CORNER OR CROSSWALK CLOSURE
 701901-08 TRAFFIC CONTROL DEVICES
 720001-01 SIGN PANEL MOUNTING DETAILS
 720006-04 SIGN PANEL ERECTION DETAILS
 720011-01 METAL POSTS FOR SIGNS, MARKERS AND DELINEATORS
 725001-01 OBJECT AND TERMINAL MARKERS
 729001-01 APPLICATIONS OF TYPES A AND B METAL POSTS (FOR SIGNS & MARKERS)

GENERAL NOTES

- SOIL EROSION AND SEDIMENTATION CONTROL PRACTICES AND DEVICES SHALL BE IN ACCORDANCE WITH THE LATEST EDITION OF IDOT STANDARD SPECIFICATIONS AND ALL REVISIONS THERETO AND IN ACCORDANCE WITH THE DETAILS ON THE PLANS.
- THE CONTRACTOR SHALL CONTACT THE DISTRICT ONE TRAFFIC CONTROL SUPERVISOR AT KALPANA.KANNAN-HOSADURGA@ILLINOIS.GOV A MINIMUM OF 72 HOURS IN ADVANCE OF BEGINNING WORK.
- THE RESIDENT ENGINEER SHALL CONTACT THE AREA TRAFFIC FIELD ENGINEER, EMAD ALHUSSEINI, AT EMAD.ALHUSSEINI@ILLINOIS.GOV A MINIMUM OF TWO WEEKS PRIOR TO PLACING PERMANENT PAVEMENT MARKINGS.
- THE CONTRACTOR SHALL CONTACT C.U.A.N. (1-312-744-7000) 48 HOURS PRIOR TO ANY WORK IN THE RIGHT OF WAY OR EASEMENTS TO LOCATE UTILITIES, AND CONTACT THE OWNER'S REPRESENTATIVE SHOULD PUBLIC UTILITIES APPEAR TO BE IN CONFLICT WITH THE PROPOSED IMPROVEMENTS.
- IT SHALL BE THE CONTRACTOR'S RESPONSIBILITY TO VERIFY ALL DIMENSIONS AND CONDITIONS EXISTING IN THE FIELD PRIOR TO ORDERING MATERIALS AND BEGINNING CONSTRUCTION.
- THE CONTRACTOR WILL NOT BE ALLOWED TO SET UP A YARD OR FIELD OFFICE ON STATE PROPERTY WITHOUT WRITTEN PERMISSION FROM THE DEPARTMENT.
- BEFORE BEGINNING ANY WORK, THE CONTRACTOR SHALL RETAIN AND RECORD FOR FUTURE REFERENCE, ALL EXISTING PAVEMENT MARKING LINES (AND RAISED REFLECTIVE PAVEMENT MARKERS) IN ORDER THAT THESE LOCATIONS CAN BE RE-ESTABLISHED FOR STRIPING. EXACT LOCATIONS OF ALL PAVEMENT MARKINGS SHALL BE AS DIRECTED BY THE ENGINEER."
- THE CONTRACTOR SHALL TAKE CARE TO PROTECT ALL SIGNS ALONG THE ROUTE OF CONSTRUCTION. SIGNS SHALL BE REMOVED IF THEY ARE IN CONFLICT WITH PROPOSED WORK, AND APPROVED BY ENGINEER. THE CONTRACTOR SHALL NOTIFY THE ENGINEER OF ANY EXISTING DAMAGE TO A SIGN PRIOR TO REMOVAL. THE CONTRACTOR SHALL REPLACE ALL SIGNS AND POSTS DAMAGED DURING REMOVAL. THE COST OF ALL MATERIALS REQUIRED AND ALL LABOR NECESSARY TO COMPLY WITH THE RELOCATION OF SIGNS SHALL BE INCLUDED IN THE CONTRACT WITHOUT ANY EXTRA COMPENSATION ALLOWED TO THE CONTRACTOR ACCORDING TO ART. 107.25. UNLESS MARKED ON PLANS.
- THE REMOVAL OF GUARDRAIL TERMINAL SECTIONS SHALL BE INCLUDED IN THE UNIT PRICE PER FOOT FOR GUARDRAIL REMOVAL.
- ALL ELEVATIONS IN THE PLANS ARE BASED UPON THE NORTH AMERICAN VERTICAL DATUM OF 1988 (NAVD88).
- DO NOT SCALE PLANS FOR CONSTRUCTION DIMENSIONS.
- THE CONTRACTOR SHALL BE REQUIRED TO PROVIDE ACCESS TO ABUTTING PROPERTY AT ALL TIMES DURING THE CONSTRUCTION OF THE PROJECT.
- SEEDING SHALL NOT BE PERMITTED AT ANY TIME WHEN THE GROUND IS FROZEN. WET, OR IN AN UNTILLABLE CONDITION.
- THE FINISHED EARTHWORK SHALL HAVE A VEGETATION-SUSTAINING SOIL COVERING THE TOP SIX INCHES IN AREAS TO BE SEEDED OR SODDED.
- WHEN MILLED PAVEMENT IS OPEN TO TRAFFIC THE MAXIMUM GRADE DIFFERENTIAL BETWEEN PASSES OF THE MILLING MACHINE SHALL NOT EXCEED 1 1/2 INCHES WHERE THE SPEED LIMIT IS 45 MPH OR LESS. WITH WRITTEN APPROVAL FROM THE ENGINEER. A MAXIMUM GRADE DIFFERENTIAL OF 3 INCHES MAY BE ALLOWED IF THE EDGE OF THE MILLING IS SLOPED A MINIMUM 1:3 V:H.
- NITROGEN, PHOSPHORUS, AND POTASSIUM FERTILIZER NUTRIENTS SHALL BE APPLIED TO ALL PERMANENT SEEDBEDS ACCORDING TO SECTION 250.04 OF THE STANDARD SPECIFICATIONS.
- THE DEPARTMENT HAS NOT OBTAINED ANY PERMITS FOR OFFSITE BORROW, WASTE, USE (BWU) AREAS. PRIOR TO WORKING IN BWU AREAS IF THE CONTACTOR CHOOSES TO USE ACTIVITIES REQUIRING PERMITS IT IS THE CONTRACTOR'S RESPONSIBILITY TO SECURE THE PROPER PERMITS. IN ADDITION TO THE BORROW REVIEW (BOE 2289) AND USE/WASTE REVIEW (BOE 2290) SUBMITTALS, THE CONTRACTOR SHALL SUBMIT AN EROSION AND SEDIMENT CONTROL (ESC) PLAN FOR EVERY BWU SITE TO THE DEPARTMENT FOR ACCEPTANCE. GUIDELINES FOR ACCEPTABLE BWU PRACTICES CAN BE FOUND IN SECTION II.G.1 AND 2 OF THE SWPPP. THE COST OF ALL MATERIALS AND LABOR NECESSARY TO COMPLY WITH THE ABOVE PROVISIONS TO PREPARE AND IMPLEMENT ESC PLANS WILL NOT BE PAID FOR SEPARATELY, BUT SHALL BE CONSIDERED AS INCLUDED IN THE UNIT BID PRICES OF THE CONTRACT AND NO ADDITIONAL COMPENSATION WILL BE ALLOWED.

GENERAL NOTES

- BEFORE BEGINNING ANY WORK, THE CONTRACTOR SHALL RETAIN AND RECORD FOR FUTURE REFERENCE, ALL EXISTING PAVEMENT MARKING LINES (AND RAISED REFLECTIVE PAVEMENT MARKERS) IN ORDER THAT THESE LOCATIONS CAN BE RE-ESTABLISHED FOR STRIPING. EXACT LOCATIONS OF ALL PAVEMENT MARKINGS SHALL BE AS DIRECTED BY THE ENGINEER.
- CONTRACTOR SHALL CONTACT CTA, QUENTIN SHIPLEY-MELLON AT QSHIPLEY-MELLON@TRANSITCHICAGO.COM OR (312)-681-4119 MINIMUM OF TWO(2) WEEKS PRIOR TO ANY BUS SERVICE IMPACTS.
- CONTRACTOR SHALL CONTACT PACE, RICK WILLMAN AT RICHARD.WILLMAN@PACEBUS.COM OR (847)-228-3584 MINIMUM OF TWO(2) WEEKS PRIOR TO THE START OF CONSTRUCTION.

COMMITMENTS

- NO COMMITMENTS AT THIS TIME.

HOT-MIX ASPHALT MIXTURE REQUIREMENTS

MIXTURE TYPE	AIR VOIDS @ N _{tes}	QMP
PAVEMENT WIDENING		
POLYMERIZED HOT-MIX ASPHALT SURFACE COURSE, STONE MATRIX ASPHALT, 9.5, MIX "F", N80 (1.75")	3.5% @ 80 GYR.	QC/QA
POLYMERIZED HOT-MIX ASPHALT BINDER COURSE, IL-4.75, N50 (3/4")	3.5% @ 50 GYR.	QC/QA
HOT-MIX ASPHALT BASE COURSE, 7 3/4" (HMA BINDER IL-19.0)	4% @ 90 GYR.	QC/QA
HOT-MIX ASPHALT BASE COURSE WIDENING, 7 3/4" (HMA BINDER IL-19.0)	4% @ 90 GYR.	QC/QA
PAVEMENT RESURFACING		
POLYMERIZED HOT-MIX ASPHALT SURFACE COURSE, STONE MATRIX ASPHALT, 9.5, MIX "F", N80 (1.75")	3.5% @ 80 GYR.	QC/QA
POLYMERIZED HOT-MIX ASPHALT BINDER COURSE, IL-4.75, N50 (3/4")	3.5% @ 50 GYR.	QC/QA
HOT-MIX ASPHALT BASE COURSE, 7 3/4" (HMA BINDER IL-19.0)	4% @ 90 GYR.	QC/QA
HOT-MIX ASPHALT BASE COURSE WIDENING, 7 3/4" (HMA BINDER IL-19.0)	4% @ 90 GYR.	QC/QA
PAVEMENT PATCHING		
CLASS D PATCH (HMA BINDER IL-19.0) (10" / 12" / 14")	4% @ 70 GYR.	QC/QA
TEMPORARY PAVEMENT (VARIABLE DEPTH)		
HOT-MIX ASPHALT SURFACE COURSE, MIX "D", N70 (IL-9.5 VAR. DEPTH)	4% @ 70 GYR.	QC/QA
QMP DESIGNATIONS: QUALITY CONTROL/QUALITY ASSURANCE (QC/QA); QUALITY CONTROL FOR PERFORMANCE (QCP); PAY FOR PERFORMANCE (PFP)		

THE UNIT WEIGHT USED TO CALCULATE ALL HMA SURFACE MIXTURE QUANTITIES IS 112 LBS/SQ YD/IN

THE "AC TYPE" FOR POLYMERIZED HMA MIXES SHALL BE "SBS/SBR PG 76-22" AND FOR NON-POLYMERIZED HMA THE "AC TYPE" SHALL BE "PG 64-22" UNLESS MODIFIED BY DISTRICT ONE SPECIAL PROVISIONS.

QUALITY MANAGEMENT PROGRAM (QMP) IDENTIFIES THE PARTICULAR QUALITY CONTROL SPECIFICATION THAT APPLIES TO THE HMA MIXTURE.

FOR USE OF RECYCLED MATERIALS SEE SPECIAL PROVISIONS.

LOCATION	FOR INFORMATION ONLY			
	20200100	FOR INFORMATION ONLY		
	EARTH EXCAVATION	EXCAVATION TO BE USED IN EMBANKMENT (ADJUSTED FOR SHRINKAGE) (EXC. x 0.85)	EMBANKMENT (FILL)	EARTHWORK BALANCE WASTE(+) AND SHORTAGE (-)
	CU. YD.	CU. YD.	CU. YD.	CU. YD.
FORD CITY DRIVE				
STA. 407+09.44 TO STA. 414+50.00	1511	1284	29	+1255
STA. 414+50.00 TO STA. 416+50.00				
STA. 416+50.00 TO STA. 421+50.00	1949	1657	4337	-2680
PULASKI ROAD				
STA. 210+95.07 TO STA. 219+63.09	4159	3535	206	+3329
TOTAL	7619	6476	4572	+1904

EARTH EXCAVATION SHRINKAGE FACTOR = 15%

STATE OF ILLINOIS
DEPARTMENT OF TRANSPORTATION

INDEX OF SHEETS, STANDARDS AND GENERAL NOTES
PULASKI ROAD AT FORD CITY DRIVE

SCALE: 1" = 50' SHEET 1 OF 1 SHEETS STA. TO STA.

REVISED 4/13/2020 SEP







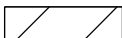

USER NAME = gjameson	DESIGNED - RKA	REVISED 04-09-2020 RKA
CHECKED - CWC	REVISOR	
PLOT SCALE = 100.0.0000 'in / in.	DRAWN - GSI	REVISED
PLOT DATE = 4/10/2020	CHECKED - RKA	REVISED

F.A.P. RTE.	SECTION	COUNTY	TOTAL SHEETS	SHEET NO.
368	1919-N(16)	COOK	110	2
CONTRACT NO. 62D42				
ILLINOIS FED. AID PROJECT				

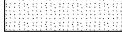
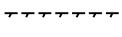
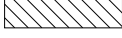
MODEL: Defult
FILE NAME: I:\projects\DOT_0-18793_PTB_189-010_V08793_02_Pulaski_Road\CADD\CAD_Sheets\18793_PTB_189-010_V08793_02_sht-genetes0.dgn

design firm
no. 184001036
whks
engineers + planners + land surveyors

REMOVAL LEGEND

- X TREE REMOVAL
-  TREE REMOVAL, ACRES (SPECIAL) (X2010350)
-  PAVEMENT REMOVAL (44000100)
-  HOT-MIX ASPHALT SURFACE REMOVAL, 2 1/2" (44000159)
-  DRIVEWAY PAVEMENT REMOVAL (44000200)
-  COMBINATION CURB AND GUTTER REMOVAL (44000500)
-  SIDEWALK REMOVAL (44000600)
-  MEDIAN REMOVAL (44003100)
-  REMOVAL OF EXISTING STRUCTURES (50100100)
- XXXXXXXXXXXXX GUARDRAIL REMOVAL (63200310)
-  ADJUST
-  REMOVAL
-  RELOCATE

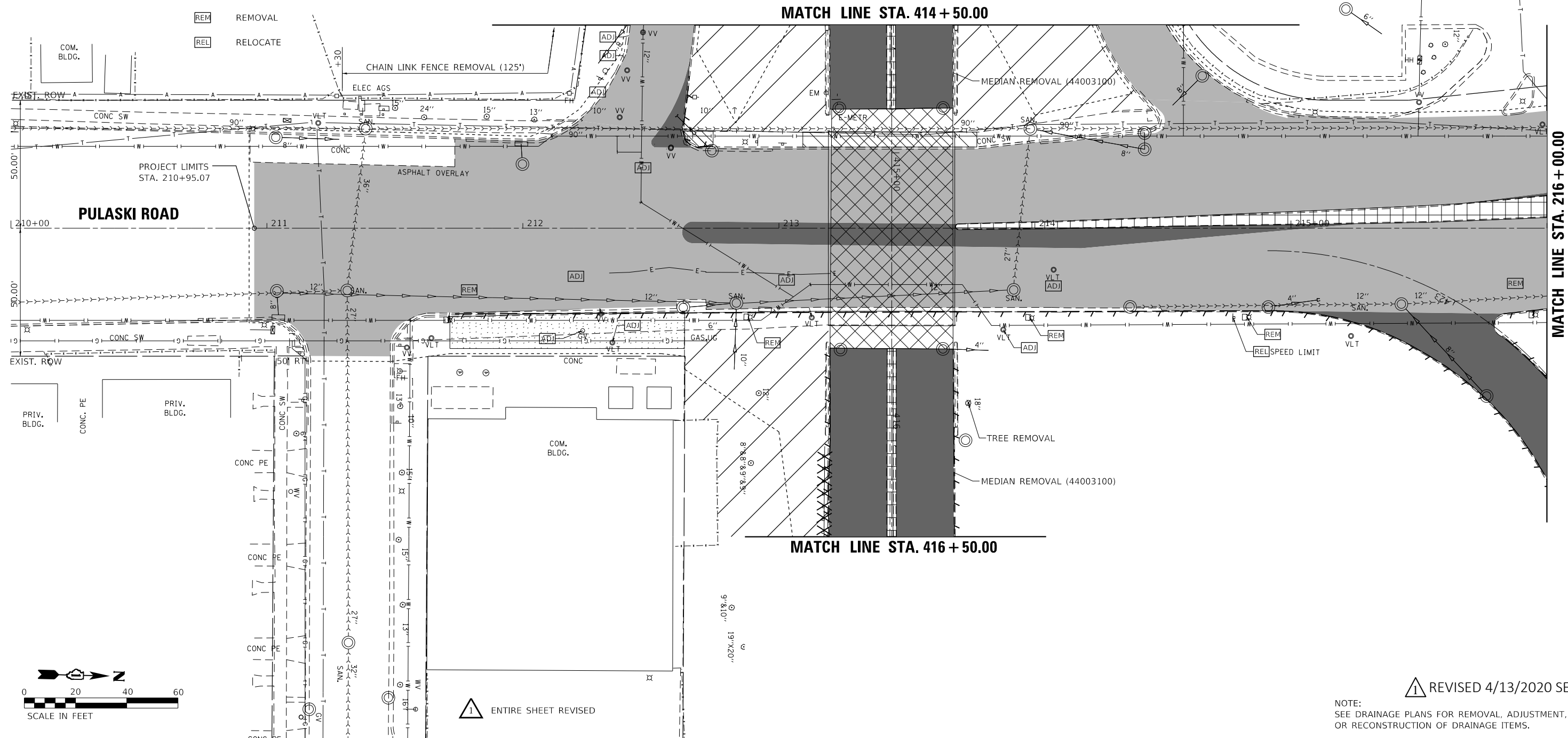

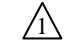
 REVISED 4/13/2020 SEP

NOTE:
SEE DRAINAGE PLANS FOR REMOVAL, ADJUSTMENT,
OR RECONSTRUCTION OF DRAINAGE ITEMS.

 ENTIRE SHEET REVISED

MODEL: Default
FILE NAME: C:\projects\DOT_D-18793_PTB_1894010_VV07293.02_Pulaski_Road\CADD\CAD_Sheets\184001036-structure\pulsaski184001036.dgn

design firm
no. 184001036



engineers + planners + land surveyors





USER NAME = SOPERATORS	DESIGNED - RKA	REVISED 04-09-2020 RKA
	CHECKED - SDS	REVISED
PLOT SCALE = 40,0000' / in.	DRAWN - GSJ	REVISED
PLOT DATE = 4/9/2020	CHECKED - RKA	REVISED

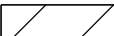
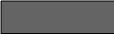

**STATE OF ILLINOIS
DEPARTMENT OF TRANSPORTATION**

REMOVAL PLAN - PULASKI ROAD		F.A.P. RTE.	SECTION	COUNTY	TOTAL SHEETS	SHEET NO.
PULASKI ROAD AT FORD CITY DRIVE		368	1919-N(16)	COOK	110	20
SCALE: 1" = 20'		SHEET 1 OF 2 SHEETS		STA. 210+95.07 TO STA. 216+00.00		CONTRACT NO. 62D42

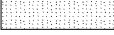
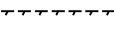
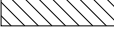
ILLINOIS		FED. AID PROJECT	
----------	--	------------------	--

REMOVAL LEGEND

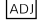
- X TREE REMOVAL
-  TREE REMOVAL, ACRES (SPECIAL) (X2010350)
-  PAVEMENT REMOVAL (44000100)
-  HOT-MIX ASPHALT SURFACE REMOVAL, 2 1/2" (44000159)
-  DRIVEWAY PAVEMENT REMOVAL (44000200)
-  COMBINATION CURB AND GUTTER REMOVAL (44000500)
-  SIDEWALK REMOVAL (44000600)
-  MEDIAN REMOVAL (44003100)
-  REMOVAL OF EXISTING STRUCTURES (50100100)
- XXXXXXXXXXXXX GUARDRAIL REMOVAL (63200310)

-  ADJUST
-  REMOVAL
-  RELOCATE

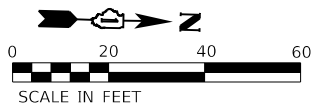
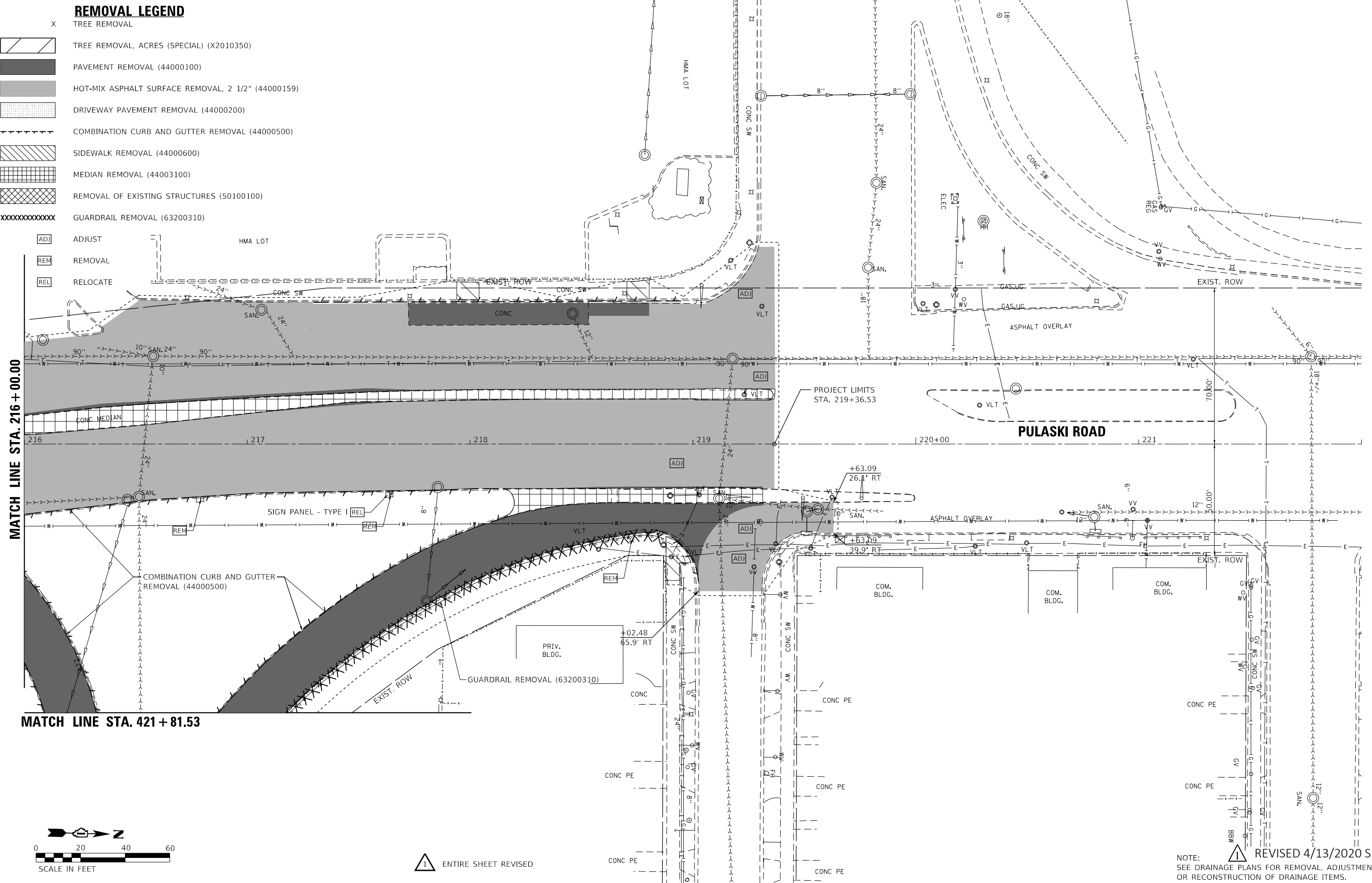

 ENTIRE SHEET REVISED

NOTE:  REVISED 4/13/2020 SEP
SEE DRAINAGE PLANS FOR REMOVAL, ADJUSTMENT, OR RECONSTRUCTION OF DRAINAGE ITEMS.

MODEL: Default FILE NAME: C:\projects\DOT_D-18793_PTB_189410_VV07293.02_Pulaski_Road\CADD\CAD_Sheets\162D12-structure\pulsaski170.dgn

design firm
no. 184001036



engineers + planners + land surveyors

USER NAME = \$OPERATORS	DESIGNED - RKA	REVISED 04-09-2020 RKA
PLOT SCALE = 40,0000' / in.	CHECKED - SDS	REVISED
PLOT DATE = 4/9/2020	DRAWN - GSI	REVISED
	CHECKED - RKA	REVISED

**STATE OF ILLINOIS
DEPARTMENT OF TRANSPORTATION**

**REMOVAL PLAN - PULASKI ROAD
PULASKI ROAD AT FORD CITY DRIVE**

SCALE: 1" = 20' SHEET 2 OF 2 SHEETS STA. 216+00.00 TO STA. 219+36.53

F.A.P. RTE.	SECTION	COUNTY	TOTAL SHEETS	SHEET NO.
368	1919-N(16)	COOK	110	21
CONTRACT NO. 62D42				
ILLINOIS FED. AID PROJECT				

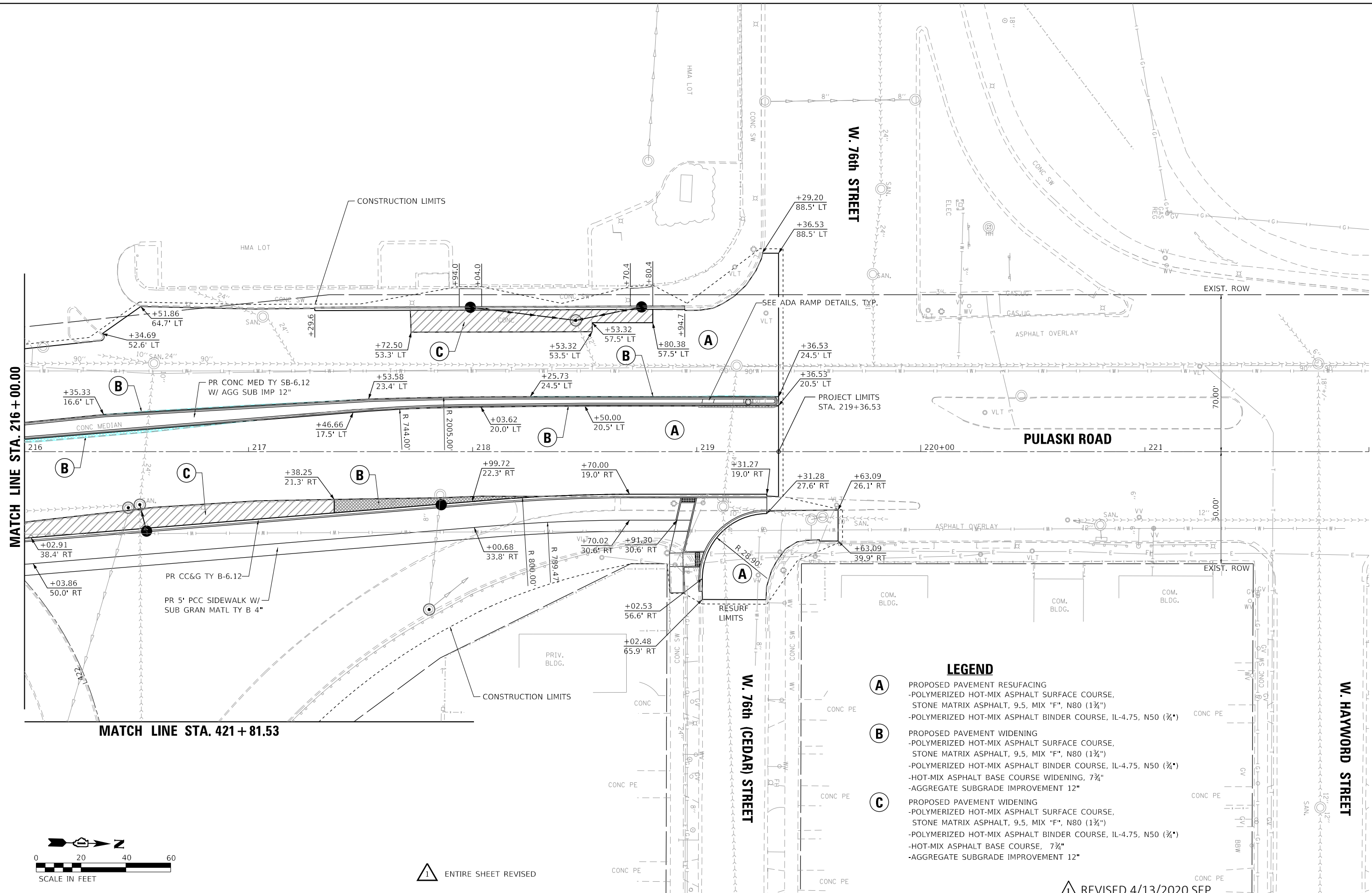

MATCH LINE STA. 216 + 00.00

MATCH LINE STA. 421 + 81.53

LEGEND

- (A)** PROPOSED PAVEMENT RESURFACING
 - POLYMERIZED HOT-MIX ASPHALT SURFACE COURSE, STONE MATRIX ASPHALT, 9.5, MIX "F", N80 (1 3/4")
 - POLYMERIZED HOT-MIX ASPHALT BINDER COURSE, IL-4.75, N50 (3/4")
- (B)** PROPOSED PAVEMENT WIDENING
 - POLYMERIZED HOT-MIX ASPHALT SURFACE COURSE, STONE MATRIX ASPHALT, 9.5, MIX "F", N80 (1 3/4")
 - POLYMERIZED HOT-MIX ASPHALT BINDER COURSE, IL-4.75, N50 (3/4")
 - HOT-MIX ASPHALT BASE COURSE WIDENING, 7 3/4"
 - AGGREGATE SUBGRADE IMPROVEMENT 12"
- (C)** PROPOSED PAVEMENT WIDENING
 - POLYMERIZED HOT-MIX ASPHALT SURFACE COURSE, STONE MATRIX ASPHALT, 9.5, MIX "F", N80 (1 3/4")
 - POLYMERIZED HOT-MIX ASPHALT BINDER COURSE, IL-4.75, N50 (3/4")
 - HOT-MIX ASPHALT BASE COURSE, 7 3/4"
 - AGGREGATE SUBGRADE IMPROVEMENT 12"

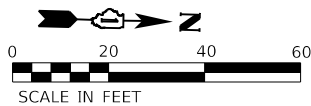

ENTIRE SHEET REVISED

REVISED 4/13/2020 SEP

MODEL: D:\p1\184001036\184001036.dwg FILE NAME: 184001036.dwg PLOT DATE: 4/9/2020

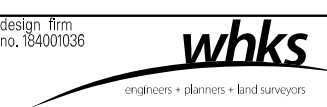

USER NAME = SOPERATORS	DESIGNED - RKA	REVISED 04-09-2020 RKA
PLOT SCALE = 40,0000 ' / in.	CHECKED - SDS	REVISED
PLOT DATE = 4/9/2020	DRAWN - GSI	REVISED
	CHECKED - RKA	REVISED

**STATE OF ILLINOIS
DEPARTMENT OF TRANSPORTATION**

**ROADWAY PLAN - PULASKI ROAD
PULASKI ROAD AT FORD CITY DRIVE**

SCALE: 1" = 20' SHEET 2 OF 2 SHEETS STA. TO STA.

F.A.P. RTE.	SECTION	COUNTY	TOTAL SHEETS	SHEET NO.
368	1919-N(16)	COOK	110	26
CONTRACT NO. 62D42				
ILLINOIS FED. AID PROJECT				

TRAFFIC CONTROL GENERAL NOTES

1. THE CONTRACTOR SHALL NOT MOUNT SIGNS ON EXISTING SIGNS.
2. CONTRACTOR SHALL MAINTAIN SATISFACTORY INGRESS AND EGRESS TO ADJACENT PROPERTIES THROUGHOUT THE CONSTRUCTION.
3. ALL TEMPORARY PAVEMENT MARKINGS SHALL BE TEMPORARY PAVEMENT MARKING TAPE, TYPE IV.
4. REMOVAL OF TEMPORARY PAVEMENT MARKINGS SHALL BE PAID FOR AS SHORT TERM PAVEMENT MARKING REMOVAL.
5. EXISTING, CONFLICTING PAVEMENT MARKINGS SHALL BE REMOVED. THIS WORK SHALL BE PAID FOR AS PAVEMENT MARKING REMOVAL - WATER BLASTING.
6. THE EXISTING PAVEMENT MARKINGS THAT HAVE BEEN REMOVED SHALL BE REPLACED IN-KIND USING THERMOPLASTIC PAVEMENT MARKING.
7. USE SUGGESTED TRAFFIC CONTROL AND PROTECTION PLAN IN CONJUNCTION WITH STANDARDS 701601, 701606 AND APPLICABLE PORTIONS OF DISTRICT ONE STANDARD TRAFFIC CONTROL STANDARDS TC-10, TC-14, TC-16, TC-21 AND TC-22. ADDITIONAL SIGNAGE MAY BE REQUIRED BY THE RESIDENT ENGINEER. ALL WORK AND SIGNAGE IN THE PLANS SHALL BE INCLUDED IN THE PAY ITEM FOR TRAFFIC CONTROL AND PROTECTION (SPECIAL) UNLESS OTHERWISE PROVIDED IN THE PLANS.

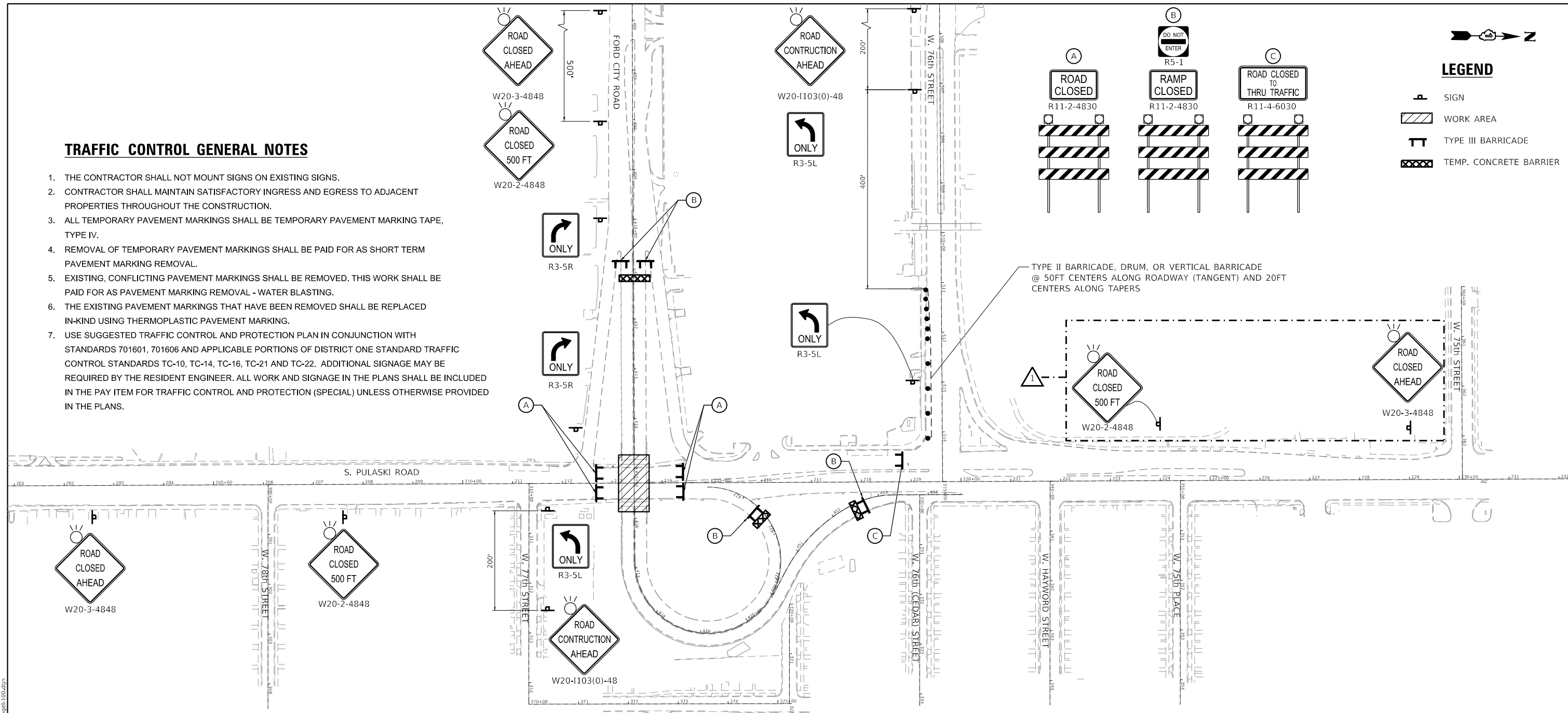

LEGEND

- SIGN
- WORK AREA
- TYPE III BARRICADE
- TEMP. CONCRETE BARRIER

TYPE II BARRICADE, DRUM, OR VERTICAL BARRICADE @ 50FT CENTERS ALONG ROADWAY (TANGENT) AND 20FT CENTERS ALONG TAPERS

INSET A (STAGE I)

CONSTRUCTION STAGING

STAGE I
REMOVE BRIDGE SUPERSTRUCTURE, APPURTENANCES, ATTACHED UTILITIES, AND ABUTMENTS.

MAINTENANCE OF TRAFFIC

STAGE I
ERECT DETOUR SIGNING AS SHOWN ON DETOUR PLAN. CLOSE PULASKI ROAD AND FORD CITY DRIVE AS SHOWN ON THE MAINTENANCE OF TRAFFIC - STAGE I PLAN.

ROAD CLOSURE SHALL TAKE PLACE OVER ONE WEEKEND BETWEEN THE TIMES OF 10:00 P.M. FRIDAY AND 5:00 A.M. MONDAY. SEE SPECIAL PROVISIONS.

REVISED 4/13/2020 SEP

MODEL: D:\default\design firm no. 184001036 FILE NAME: C:\projects\DOT_D-118793_PTB_189-010_VV18793_02_Pulaski_Road\CADD\CAD_Sheets\162-D12-shtA01F-stage1-100.dgn

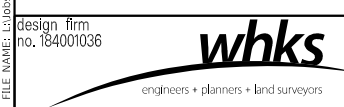

USER NAME = \$OPERATORS	DESIGNED - RKA	REVISED 04-09-2020 RKA
	CHECKED - SDS	REVISED
PLOT SCALE = 200,0000' / in.	DRAWN - GSI	REVISED
PLOT DATE = 4/9/2020	CHECKED - RKA	REVISED

STATE OF ILLINOIS
DEPARTMENT OF TRANSPORTATION

MAINTENANCE OF TRAFFIC - STAGE I PULASKI ROAD AT FORD CITY DRIVE			
SCALE: NTS	SHEET 1 OF 1 SHEETS	STA. TO STA.	

F.A.P. RTE.	SECTION	COUNTY	TOTAL SHEETS	SHEET NO.
368	1919-N(16)	COOK	110	31
CONTRACT NO. 62D42				
ILLINOIS FED. AID PROJECT				

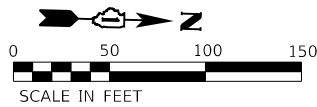

MATCH LINE STA. 208 + 00.00

MATCH LINE STA. 223 + 00.00

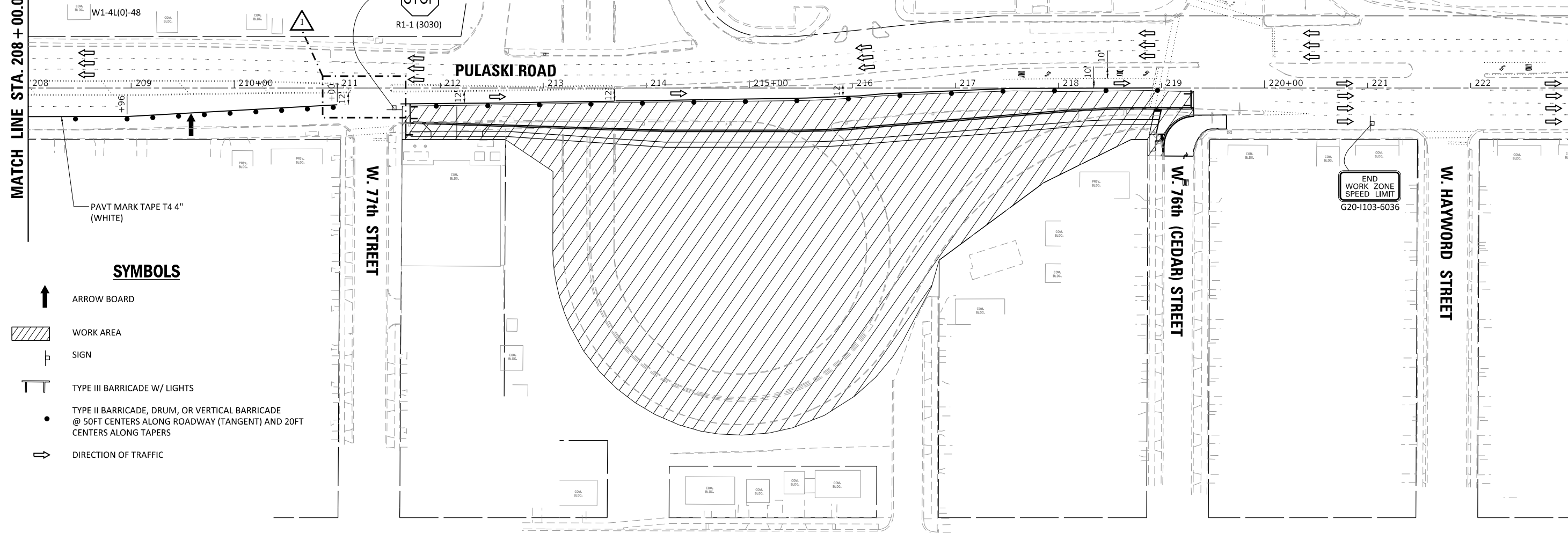

PAVT MARK TAPE T4 4" (WHITE)

SYMBOLS

- ARROW BOARD
- WORK AREA
- SIGN
- TYPE III BARRICADE W/ LIGHTS
- TYPE II BARRICADE, DRUM, OR VERTICAL BARRICADE @ 50FT CENTERS ALONG ROADWAY (TANGENT) AND 20FT CENTERS ALONG TAPERS
- DIRECTION OF TRAFFIC

REVIS 4/13/2020 SEP

MODEL: Default FILE NAME: C:\Users\jdoyle\OneDrive\Documents\620-1103-6036\620-1103-6036.dwg

design firm
no. 184001036

engineers • planners • land surveyors

USER NAME = rallender	DESIGNED - RKA	REVISED 04-09-2020 RKA
	CHECKED - SDS	REVISED
PLOT SCALE = 100,0000' / in.	DRAWN - GSJ	REVISED
PLOT DATE = 4/9/2020	CHECKED - RKA	REVISED

**STATE OF ILLINOIS
DEPARTMENT OF TRANSPORTATION**

**MAINTENANCE OF TRAFFIC - STAGE II
PULASKI ROAD AT FORD CITY DRIVE**

SCALE: 1" = 50' SHEET 3 OF 4 SHEETS STA. TO STA.

F.A.P. RTE. 368	SECTION 1919-N(16)	COUNTY COOK	TOTAL SHEETS 110	SHEET NO. 34
CONTRACT NO. 62D42				
ILLINOIS FED. AID PROJECT				

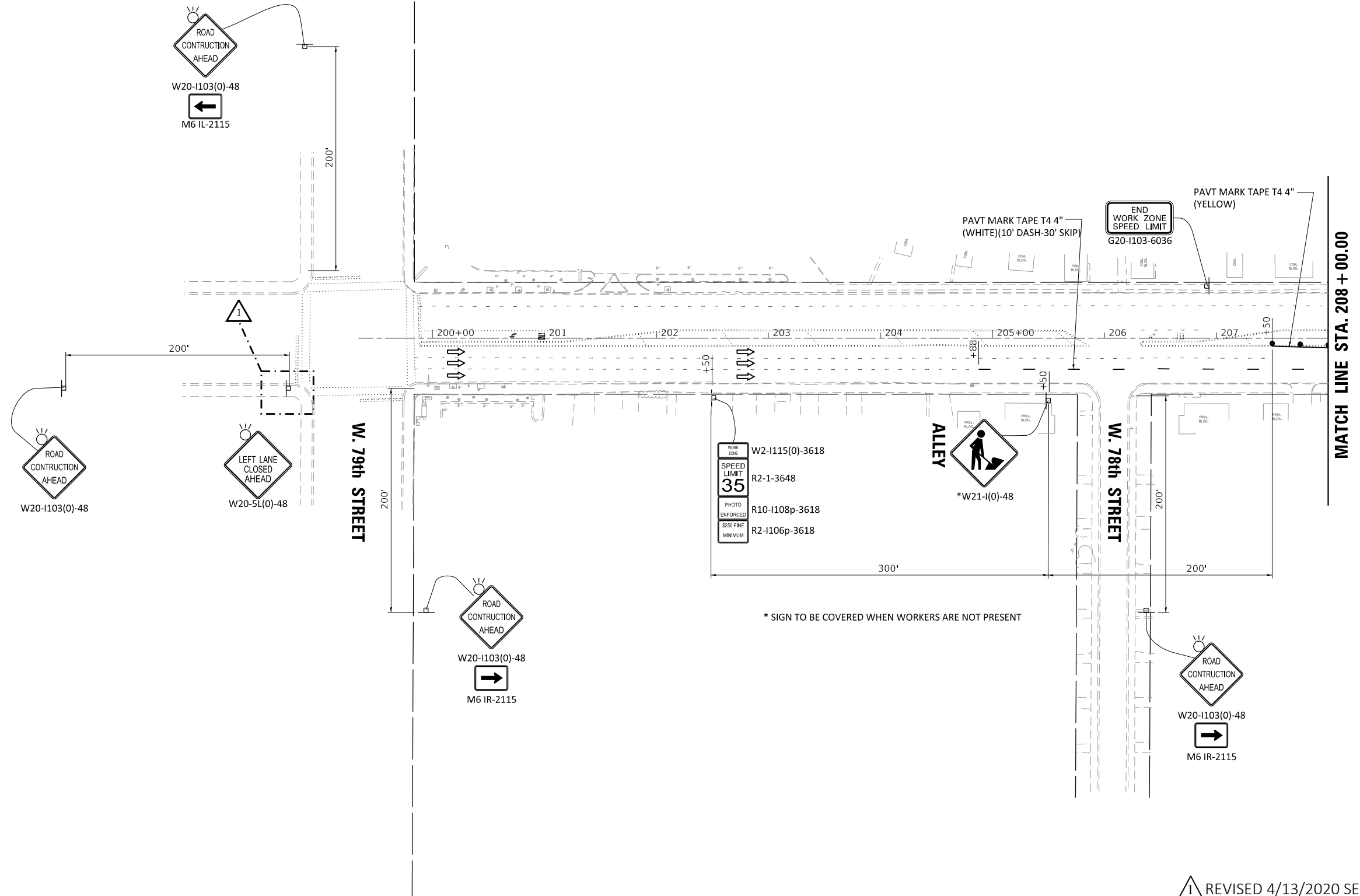
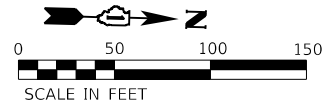

SYMBOLS

- ARROW BOARD
- WORK AREA
- SIGN
- TYPE III BARRICADE W/ LIGHTS
- TYPE II BARRICADE, DRUM, OR VERTICAL BARRICADE @ 50FT CENTERS ALONG ROADWAY (TANGENT) AND 20FT CENTERS ALONG TAPERS
- DIRECTION OF TRAFFIC

MODEL: Default
 FILE NAME: \\sps\dot\DOT_D-118793_PTB_189-010_VV07293.02_Pulaski_Road\CADD\CAD_Sheets\162\162-DTP-162-MOT-2019\162.dgn
 design firm no. 184001036
 engineers + planners + land surveyors

USER NAME = rallender	DESIGNED - RKA	REVISED 04-09-2020 RKA
	CHECKED - SDS	REVISED
PLOT SCALE = 100,0000' / in.	DRAWN - GSJ	REVISED
PLOT DATE = 4/9/2020	CHECKED - RKA	REVISED

**STATE OF ILLINOIS
DEPARTMENT OF TRANSPORTATION**

MAINTENANCE OF TRAFFIC – STAGE III PULASKI ROAD AT FORD CITY DRIVE			
SCALE: 1" = 50'	SHEET 2	OF 4 SHEETS	STA. TO STA.

F.A.P. RTE. 368	SECTION 1919-N(16)	COUNTY COOK	TOTAL SHEETS 110	SHEET NO. 37
CONTRACT NO. 62D42				
ILLINOIS FED. AID PROJECT				

1 REVISED 4/13/2020 SEP

STRUCTURE NO.	STA.	OFFSET FT.	STRUCTURE TYPE	RIM/EOP	INVERTS			
S-1	212+61.6	35.7' RT	CATCH BASINS, TYPE C, TYPE 12 FRAME AND GRATE	617.80	614.57 12" N	614.47 12" S		
S-2	212+75.0	36.2' RT	INLETS, TYPE A, TYPE 12 FRAME AND GRATE	617.68	614.70 12" S			
S-3	214+36.2	40.9' RT	CATCH BASINS, TYPE C, TYPE 12 FRAME AND GRATE	617.77	614.19 12" N	614.09 12" W		
S-4	214+91.2	40.8' RT	INLETS, TYPE A, TYPE 12 FRAME AND GRATE	617.74	614.74 12" S			
S-5	215+55.2	85.0' RT	CATCH BASINS, TYPE C, TYPE 8 GRATE	617.00	613.71 12" NW			
351	211+31.4	24.3' RT	EXISTING MANHOLE	618.71	603.01 EX 10" S	602.31 EX 32" E	602.31 EX 32" W	613.17 12" N
362	212+62.6	31.0' RT	MANHOLES TO BE ADJUSTED WITH NEW TYPE 1 FRAME, CLOSED LID (CITY OF CHICAGO)	617.84				
370	212+83.4	29.2' RT	MANHOLES TO BE ADJUSTED WITH NEW TYPE 1 FRAME, CLOSED LID (CITY OF CHICAGO)	617.65	607.45 EX 8" S	607.45 12" N	614.47 12" E	
371	212+94.6	31.7' RT	MANHOLES TO BE ADJUSTED WITH NEW TYPE 1 FRAME, CLOSED LID (CITY OF CHICAGO)	617.77				
425	215+43.15	29.66' RT	MANHOLES TO BE ADJUSTED WITH NEW TYPE 1 FRAME, CLOSED LID (CITY OF CHICAGO)	618.51	607.61 EX 12" N	607.61 EX 12" S	612.36 EX 8" NE (TBR)	613.44 12" E
427	214+91.2	30.8' RT	MANHOLES TO BE ADJUSTED WITH NEW TYPE 1 FRAME, CLOSED LID (CITY OF CHICAGO)	617.97				
428	214+37.16	30.74' RT	CATCH BASINS TO BE ADJUSTED / FRAMES AND LIDS, CLOSED LID (CITY OF CHICAGO)	617.89	608.59 EX	613.99 12" E		

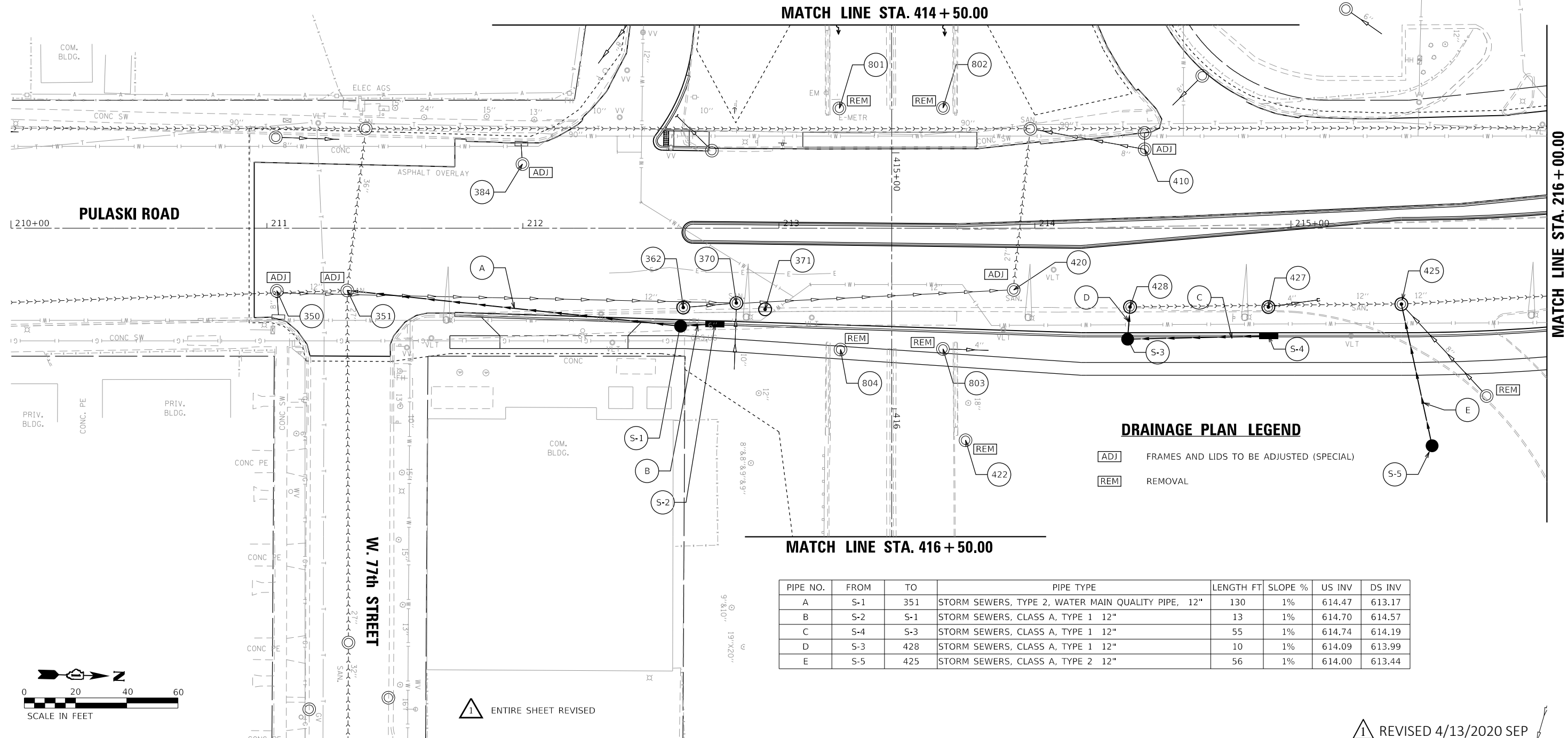

DRAINAGE PLAN LEGEND

- ADJ FRAMES AND LIDS TO BE ADJUSTED (SPECIAL)
- REM REMOVAL

PIPE NO.	FROM	TO	PIPE TYPE	LENGTH FT	SLOPE %	US INV	DS INV
A	S-1	351	STORM SEWERS, TYPE 2, WATER MAIN QUALITY PIPE, 12"	130	1%	614.47	613.17
B	S-2	S-1	STORM SEWERS, CLASS A, TYPE 1 12"	13	1%	614.70	614.57
C	S-4	S-3	STORM SEWERS, CLASS A, TYPE 1 12"	55	1%	614.74	614.19
D	S-3	428	STORM SEWERS, CLASS A, TYPE 1 12"	10	1%	614.09	613.99
E	S-5	425	STORM SEWERS, CLASS A, TYPE 2 12"	56	1%	614.00	613.44

ENTIRE SHEET REVISED

REVISED 4/13/2020 SEP

MODEL: Default; FILE NAME: C:\Users\jdo\OneDrive\Documents\2020\1919-N(16)\1919-N(16)_184001036.dwg; PLOT DATE: 4/9/2020



USER NAME = SOPERATORS	DESIGNED = RKA	REVISED = 04-09-2020 RKA
PLOT SCALE = 40,0000' / in.	CHECKED = SDS	REVISED
PLOT DATE = 4/9/2020	DRAWN = GSJ	REVISED
	CHECKED = RKA	REVISED

**STATE OF ILLINOIS
DEPARTMENT OF TRANSPORTATION**

**DRAINAGE PLAN - PULASKI ROAD
PULASKI ROAD AT FORD CITY DRIVE**

SCALE: 1" = 20' SHEET 1 OF 2 SHEETS STA. TO STA.

F.A.P. RTE.	SECTION	COUNTY	TOTAL SHEETS	SHEET NO.
368	1919-N(16)	COOK	110	41

CONTRACT NO. 62D42

ILLINOIS FED. AID PROJECT

STRUCTURE NO.	STA.	OFFSET FT.	STRUCTURE TYPE	RIM/EOP	INVERTS		
S-6	216+54.37	34.2' RT	CATCH BASINS, TYPE C, TYPE 12 FRAME AND GRATE	618.8	615.80	12" W	
S-7	217+85.4	23.4' RT	CATCH BASINS, TYPE C, TYPE 12 FRAME AND GRATE	618.73	616.30	8" EX E	
S-8	217+99.0	63.2' LT	CATCH BASINS, TYPE C, TYPE 12 FRAME AND GRATE	618.39	615.39	12" N	
S-9	218+75.38	63.5' LT	CATCH BASINS, TYPE C, TYPE 12 FRAME AND GRATE	618.39	615.39	12" S	
430	216+51.5	23.7' RT	MANHOLES TO BE ADJUSTED WITH NEW TYPE 1 FRAME, CLOSED LID (CITY OF CHICAGO)	619.02	615.7	12" E	603.12 24" EX E 602.77 24" EX W 603.72 10" EX S
431	217+80.6	70.4' RT	MANHOLES TO BE ADJUSTED WITH NEW TYPE 8 GRATE	617.00			
432	217+85.5	19.3' RT	EXISTING MANHOLE TO BE REMOVED	618.73	616.33	8" EX E	
449	218+46.0	58.6' LT	MANHOLES TO BE ADJUSTED WITH NEW TYPE 1 FRAME, CLOSED LID (CITY OF CHICAGO)	618.36	613.16	EX	614.92 12" S 615.09 12" N

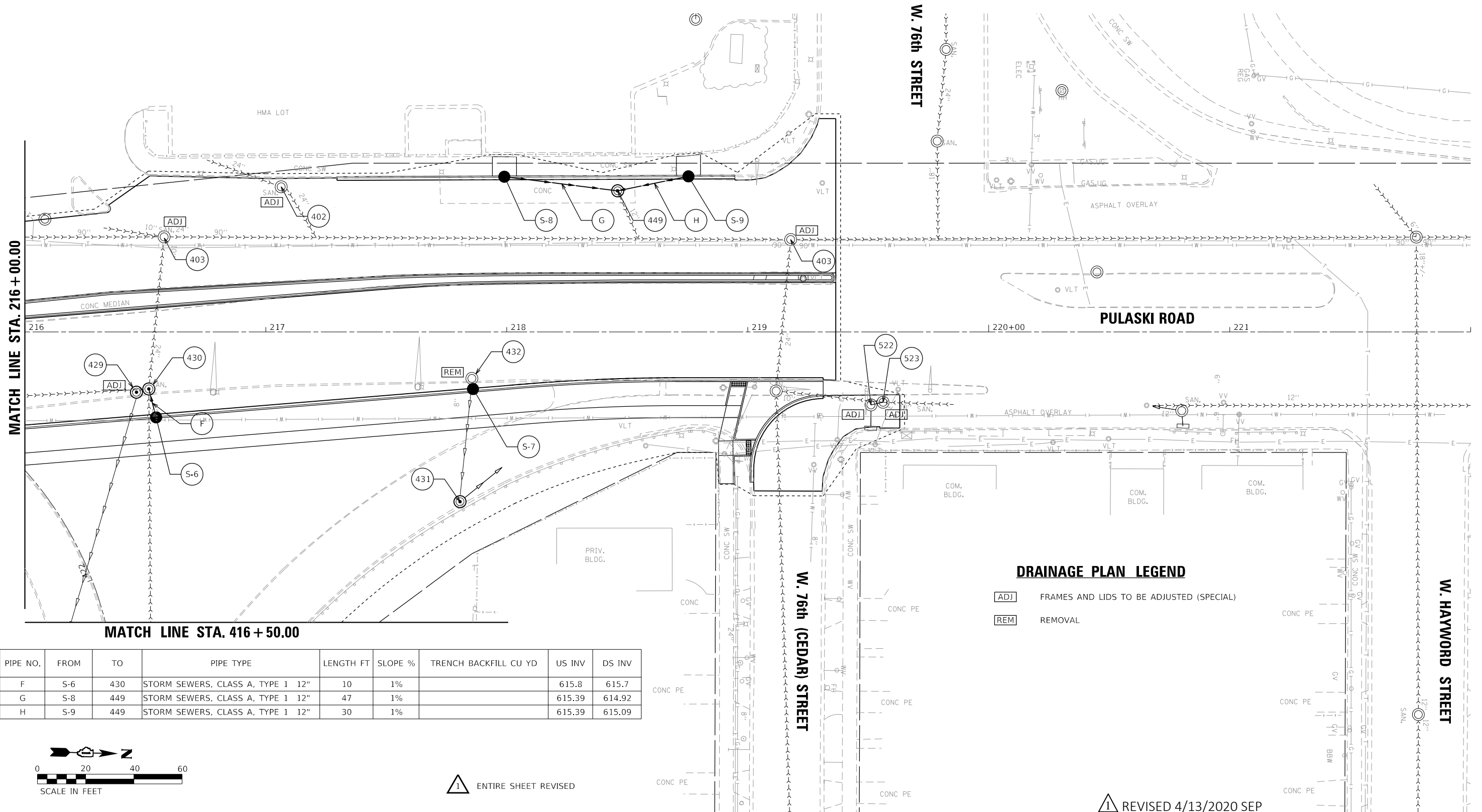

PIPE NO.	FROM	TO	PIPE TYPE	LENGTH FT	SLOPE %	TRENCH BACKFILL CU YD	US INV	DS INV
F	S-6	430	STORM SEWERS, CLASS A, TYPE 1 12"	10	1%		615.8	615.7
G	S-8	449	STORM SEWERS, CLASS A, TYPE 1 12"	47	1%		615.39	614.92
H	S-9	449	STORM SEWERS, CLASS A, TYPE 1 12"	30	1%		615.39	615.09

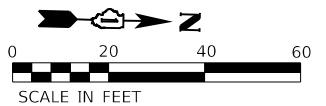

ENTIRE SHEET REVISED

REVISED 4/13/2020 SEP

MODEL: D:\p1\184001036\184001036.dwg
 FILE NAME: 184001036.dwg
 PLOT DATE: 4/9/2020
 PLOT SCALE: 1" = 20'
 PLOT SIZE: 11.00 x 17.00
 PLOT AREA: 187.00 sq ft
 PLOT PERIMETER: 54.00 ft
 PLOT CENTER: 11.00, 17.00
 PLOT ORIGIN: 0.00, 0.00
 PLOT SCALE: 1" = 20'
 PLOT SIZE: 11.00 x 17.00
 PLOT AREA: 187.00 sq ft
 PLOT PERIMETER: 54.00 ft
 PLOT CENTER: 11.00, 17.00
 PLOT ORIGIN: 0.00, 0.00

design firm
 no. 184001036

 engineers + planners + land surveyors

USER NAME = SOPERATORS	DESIGNED - RKA	REVISED 04-09-2020 RKA
PLOT SCALE = 40,0000' / in.	CHECKED - SDS	REVISED
PLOT DATE = 4/9/2020	DRAWN - GSI	REVISED
	CHECKED - RKA	REVISED

STATE OF ILLINOIS
DEPARTMENT OF TRANSPORTATION

DRAINAGE PLAN - PULASKI ROAD
PULASKI ROAD AT FORD CITY DRIVE

SCALE: 1" = 20' SHEET 2 OF 2 SHEETS STA. TO STA.

F.A.P. RTE.	SECTION	COUNTY	TOTAL SHEETS	SHEET NO.
368	1919-N(16)	COOK	110	42
CONTRACT NO. 62D42				

ILLINOIS FED. AID PROJECT

MATCH LINE STA. 416 + 50.00

STRUCTURE NO.	STA.	OFFSET FT.	STRUCTURE TYPE	RIM/EOP	INVERTS
4643	419+98.8	3.8' RT	CATCH BASINS TO BE ADJUSTED / FRAMES AND LIDS, CLOSED LID (CITY OF CHICAGO)	624.8	UNKNOWN

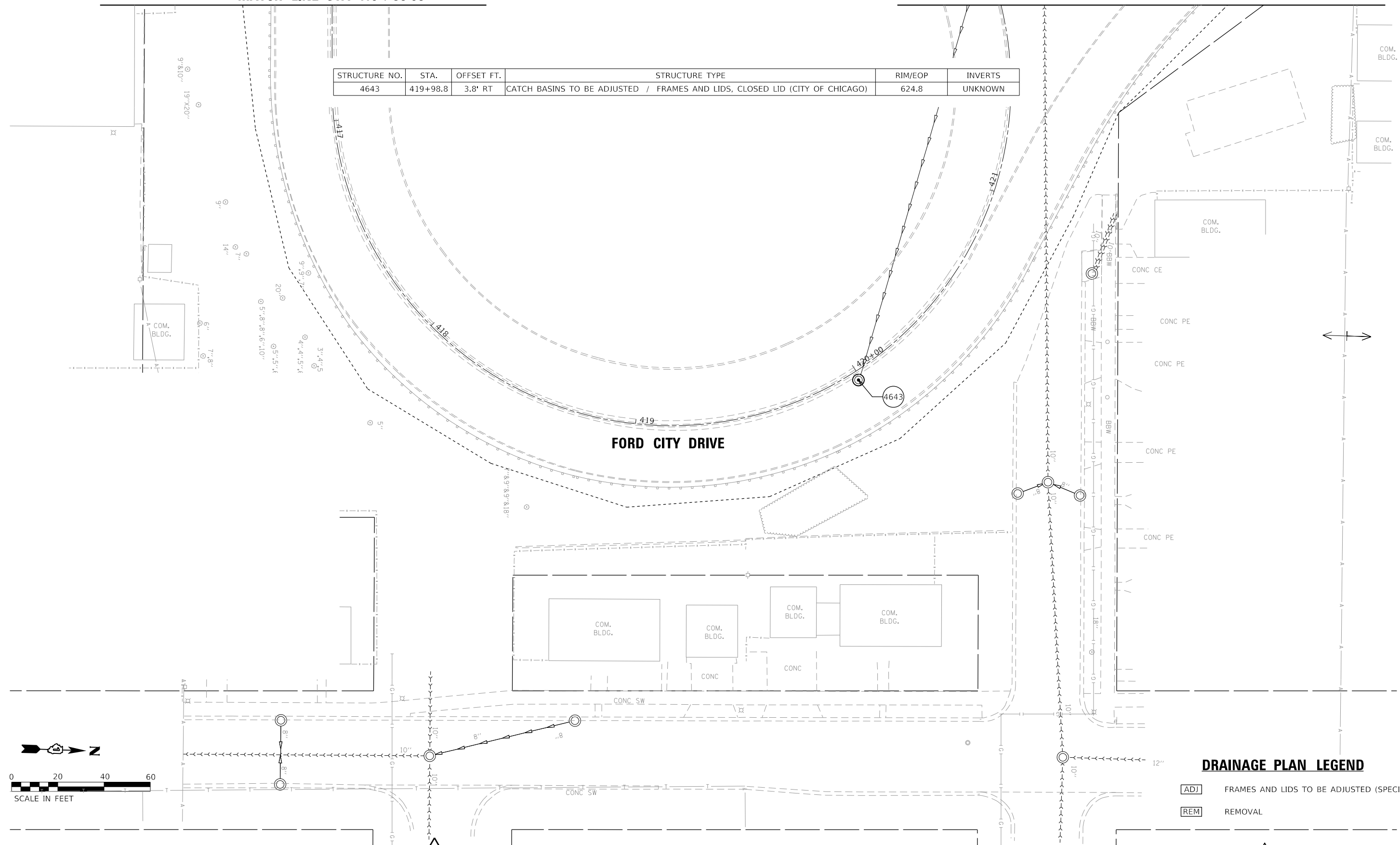

DRAINAGE PLAN LEGEND

- ADJ FRAMES AND LIDS TO BE ADJUSTED (SPECIAL)
- REM REMOVAL

1 ENTIRE SHEET REVISED

1 REVISED 4/13 2020 SEP

MODEL: D:\default\design firm\184001036\184001036.dwg
 FILE NAME: 184001036.dwg
 PLOT DATE: 4/9/2020
 PLOT SCALE: 40.0000' / in.
 USER NAME: SOPERATORS
 DESIGNED: RKA
 CHECKED: SDS
 DRAWN: GSI
 CHECKED: RKA
 REVISED: 04-09-2020 RKA
 REVISED
 REVISED
 REVISED

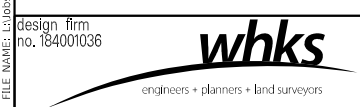

USER NAME = SOPERATORS	DESIGNED - RKA	REVISED 04-09-2020 RKA
PLOT SCALE = 40.0000' / in.	CHECKED - SDS	REVISED
PLOT DATE = 4/9/2020	DRAWN - GSI	REVISED
	CHECKED - RKA	REVISED

**STATE OF ILLINOIS
DEPARTMENT OF TRANSPORTATION**

**DRAINAGE PLAN - FORD CITY DRIVE
PULASKI ROAD AT FORD CITY DRIVE**

SCALE: 1" = 20' SHEET 3 OF 3 SHEETS STA. TO STA.

F.A.P. RTE.	SECTION	COUNTY	TOTAL SHEETS	SHEET NO.
368	1919-N(16)	COOK	110	45
CONTRACT NO. 62D42				

ILLINOIS FED. AID PROJECT

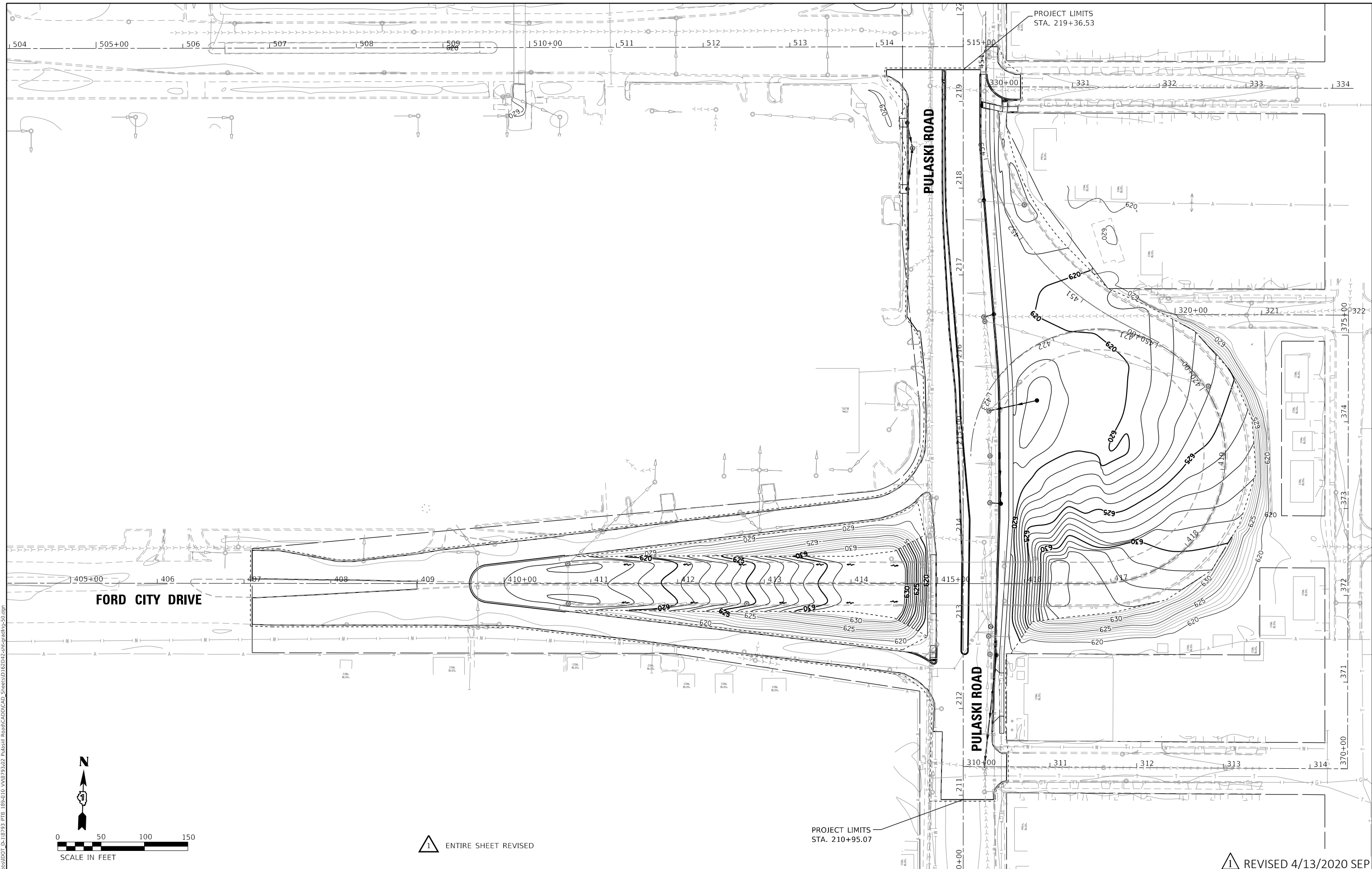

MODEL: D:\m\h\l\184001036\184001036.dwg
 FILE NAME: 184001036\184001036.dwg
 MODEL: D:\m\h\l\184001036\184001036.dwg
 FILE NAME: 184001036\184001036.dwg

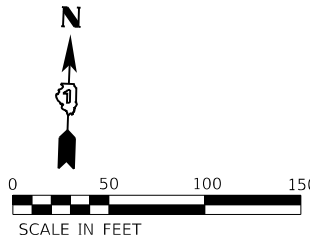

1 ENTIRE SHEET REVISED

PROJECT LIMITS
STA. 210+95.07

PROJECT LIMITS
STA. 219+36.53

design firm
 no. 184001036

 engineers + planners + land surveyors

USER NAME = rallender	DESIGNED - RKA	REVISED 04-09-2020 RKA
	CHECKED - SDS	REVISED
PLOT SCALE = 100,0000' / in.	DRAWN - GSJ	REVISED
PLOT DATE = 4/9/2020	CHECKED - RKA	REVISED

**STATE OF ILLINOIS
DEPARTMENT OF TRANSPORTATION**

GRADING PLAN
PULASKI ROAD AT FORD CITY DRIVE
 SCALE: 1" = 50' SHEET 1 OF 1 SHEETS STA. TO STA.

1 REVISED 4/13/2020 SEP

F.A.P. RTE.	SECTION	COUNTY	TOTAL SHEETS	SHEET NO.
368	1919-N(16)	COOK	110	50
CONTRACT NO. 62D42				
ILLINOIS FED. AID PROJECT				

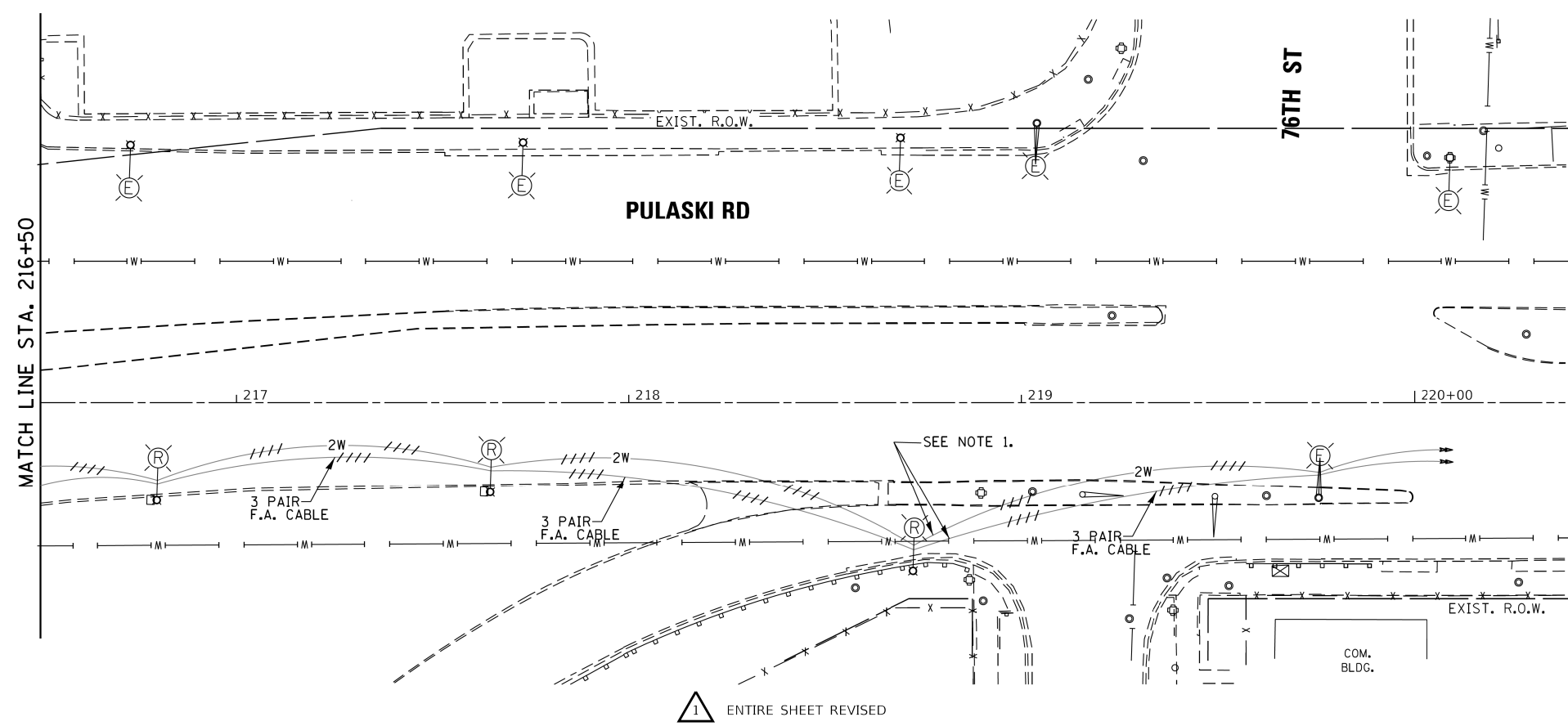
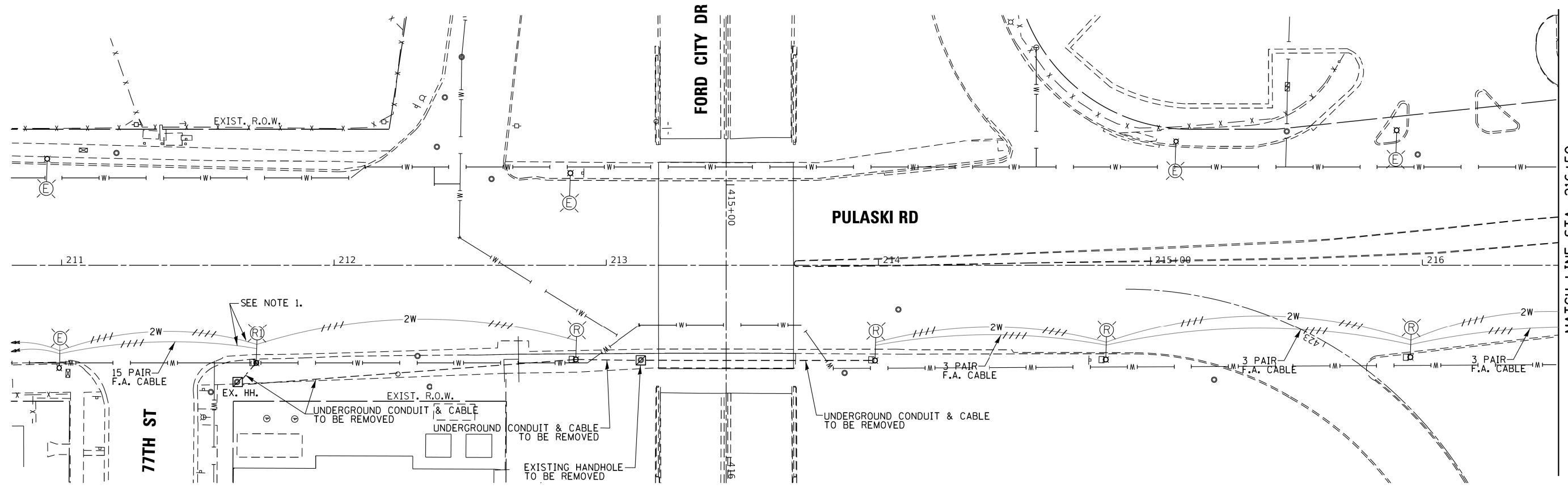

LEGEND:

- REMOVE 4x9x35' EMBEDDED POLE, MAST ARM, AND LUMINAIRE
- REMOVE 29'-6" POLE, BALLAST HOUSING, MAST ARM, AND LUMINAIRE
- OVERHEAD WIRE TO BE REMOVED

NOTES:

1. DISCONNECT 2 AERIAL WIRE (STREET LIGHT) AND FIRE ALARM CABLE FROM EXISTING POLE & RECONNECT TO NEW LIGHT POLE, AFTER PROPOSED LIGHTING IS INSTALLED.
2. EXISTING LIGHT POLES TO REMAIN IN PLACE AND OPERATIONAL UNTIL PROPOSED LIGHTING IS INSTALLED.

1 REVISED 4/13/2020 SEP

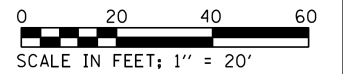

FILE NAME =
#FILEL#

GA GANDHI AND ASSOCIATES, INC.
ENGINEERS AND PLANNERS
5015 N. NORTHWEST HIGHWAY
SUITE 300
CHICAGO, ILLINOIS 60630 TEL: (773) 774-5590

USER NAME = #USER#	DESIGNED - SM	REVISED - 04-09-2020 RKA
PLOT SCALE = #SCALE#	DRAWN - AV, EA	REVISED -
PLOT DATE = #DATE#	CHECKED - SM	REVISED -
	DATE - 11/22/2019	REVISED -

**STATE OF ILLINOIS
DEPARTMENT OF TRANSPORTATION**

**PULASKI RD AT 76TH ST
REMOVAL LIGHTING PLAN**

SCALE: 1"=20'	SHEET NO.	OF	SHEETS	STA.	TO	STA.
---------------	-----------	----	--------	------	----	------

F.A.P. RTE.	SECTION	COUNTY	TOTAL SHEETS	SHEET NO.
368	1919-N(16)	COOK	110	53
CONTRACT NO. 62D42				
FED. ROAD DIST. NO. 1 ILLINOIS FED. AID PROJECT				

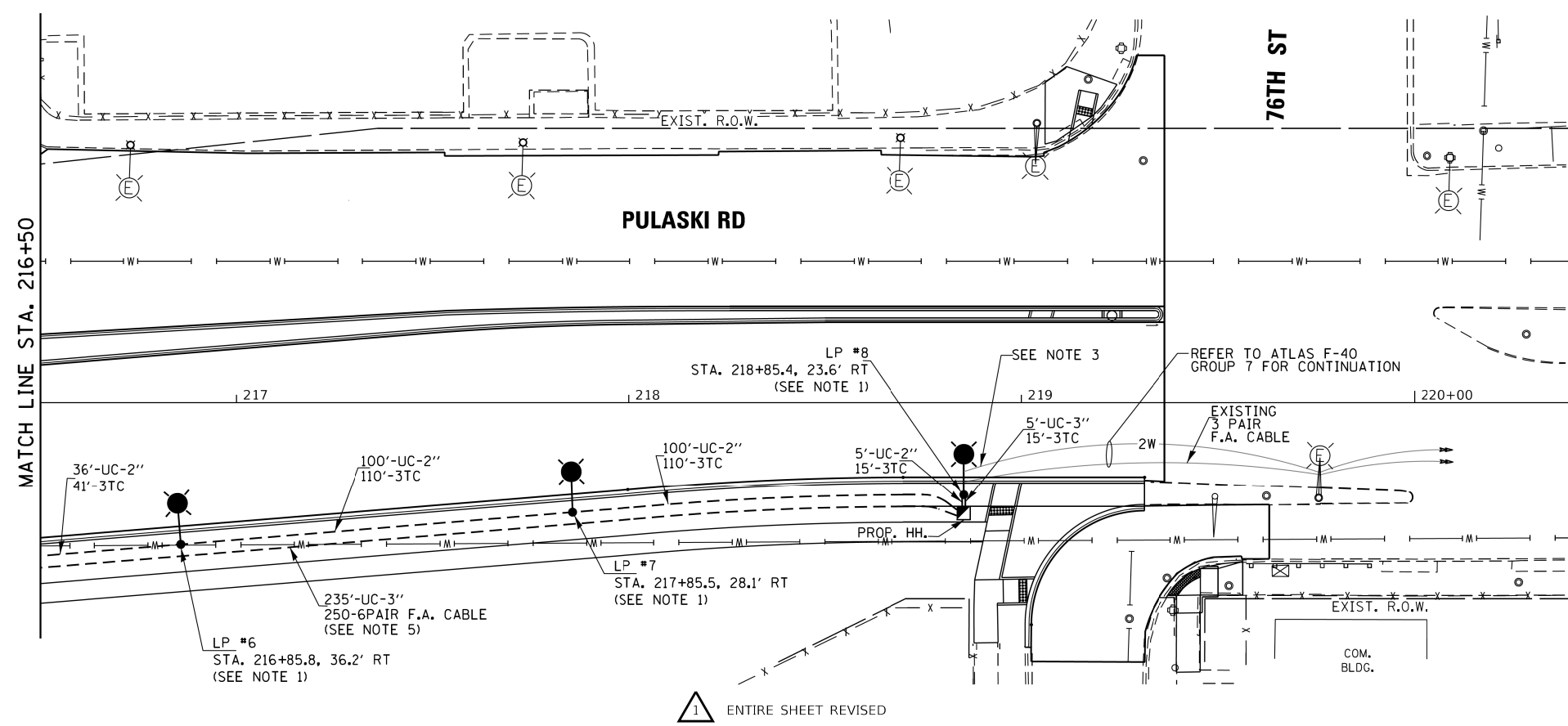
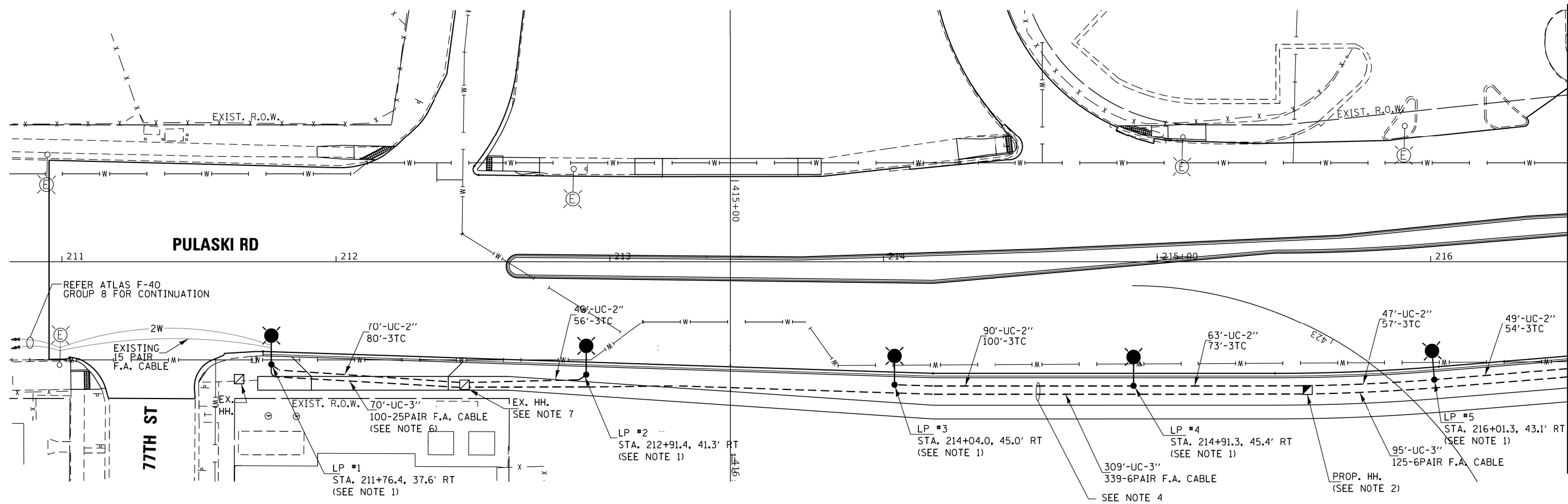
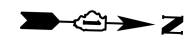

LEGEND:

- EXISTING LIGHT POLE
- PROPOSED LIGHT POLE
- PROPOSED UNDERGROUND CONDUIT
- PROPOSED HANDHOLE
- EXISTING HANDHOLE

NOTES:

1. INSTALL LIGHT POLE FOUNDATION (SPECIAL), 35' DAVID POLE, BRUSHED ALUMINUM 12' MAST ARM AND GE ERLH 014 B3 3000K COBRA HEAD LUMINAIRE 3' BEHIND THE FACE OF CURB
2. INSTALL HANDHOLE PER DRAWING #11447.A
3. INSTALL TSS-18 JUNCTION BOX FOR 6 PAIR F.A. CABLE
4. INSTALL 2" CONDUIT FOR STREET LIGHT & 3" CONDUIT FOR F.A. CABLE AS SHOWN
5. INSTALL 6 PAIR F.A. CABLE AS INDICATED
6. INSTALL 25 PAIR F.A. CABLE AS SHOWN
7. HANDHOLE TO BE ADJUSTED WITH NEW FRAME AND COVER

REVISED 4/13/2020 SEP



ENTIRE SHEET REVISED

FILE NAME =
#FILEL#



USER NAME = #USER#	DESIGNED - SM	REVISED - 04-09-2020 RKA
DRAWN - AV, EA	REVISED -	
PLOT SCALE = #SCALE#	CHECKED - SM	REVISED -
PLOT DATE = #DATE#	DATE - 11/22/2019	REVISED -

**STATE OF ILLINOIS
DEPARTMENT OF TRANSPORTATION**

**PULASKI RD AT 76TH ST
PROPOSED LIGHTING PLAN**

SCALE: 1"=20'	SHEET NO.	OF	SHEETS	STA.	TO	STA.
---------------	-----------	----	--------	------	----	------

F.A.P. RTE.	SECTION	COUNTY	TOTAL SHEETS	SHEET NO.
368	1919-N(16)	COOK	110	54
CONTRACT NO. 62D42				
FED. ROAD DIST. NO. 1 ILLINOIS FED. AID PROJECT				