

Benchmark: TBM #1, Top of NE bolt in light pole at Sta. 1699+89, 35' Rf. - Elev. 101.45  
 Existing Structure: No. 022-0040. Two span, 99'-2" Bk-Bk Abuts. 58'-0" face to face curb, 5'-0" sidewalks and 1'-0" parapets each side; 70'-0" out to out. PPC Dk. Bms placed on older substructure in 1986. Concrete parapet with aluminum handrail on top.

Salvage: Remove, store and re-erect aluminum rail. Remove, clean and reinstall existing name plate.

STATE OF ILLINOIS  
 DEPARTMENT OF TRANSPORTATION

ROUTE NO.	SECTION	COUNTY	TOTAL SHEETS	SHEET NO.	SHEET NO. 1
FAP 311	625X-B-R-1	DuPage	29	9	16 SHEETS
FED. ROAD DIST. NO. 7	ILLINOIS	FED. AID PROJECT			

Contract #60C53

**INDEX OF SHEETS**

1. General Plan & Elevation
2. General Notes and Total Bill of Material
3. Stage Construction
4. Temporary Concrete Barrier
5. Deck Cross Section
6. 21" x 36" PPC Dk. Bms.
7. 21" x 48" PPC Dk. Bms.
8. Precast Approach Beams
9. Concrete Wearing Surface
10. Sidewalks
11. Parapets
12. Railing
13. Expansion Joint Details
14. Abutments and Pier Details
15. Substructure Repairs
16. Bar Splicer Details

**LOADING HS20-44**

No Allowance for future wearing surface

**DESIGN SPECIFICATIONS**

2002 AASHTO Standard Specifications

**DESIGN STRESSES**

**FIELD UNITS**

$f'_c = 3,500$  psi  
 $f_y = 60,000$  psi (reinforcement)

**PRECAST PRESTRESSED UNITS**

$f'_c = 5,000$  psi  
 $f'_{ci} = 4,000$  psi  
 $f'_s = 270,000$  psi (1/2"  $\phi$  low lax strands)  
 $f'_{si} = 201,960$  psi (1/2"  $\phi$  low lax strands)

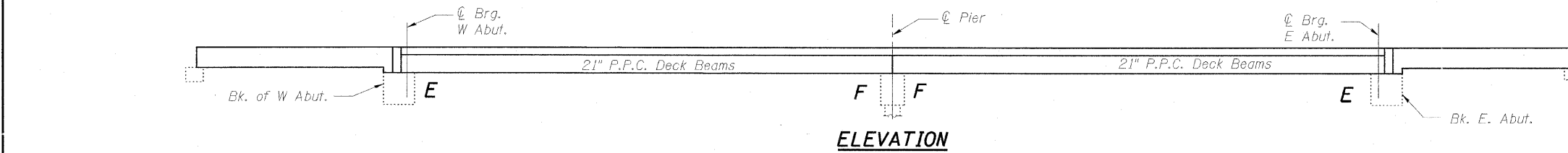

Remove and Replace Existing Precast Approach Beam, Typ. 4 corners

Combination Concrete Curb and Gutter, Type B-9.18 (Modified) Typ. 4 corners

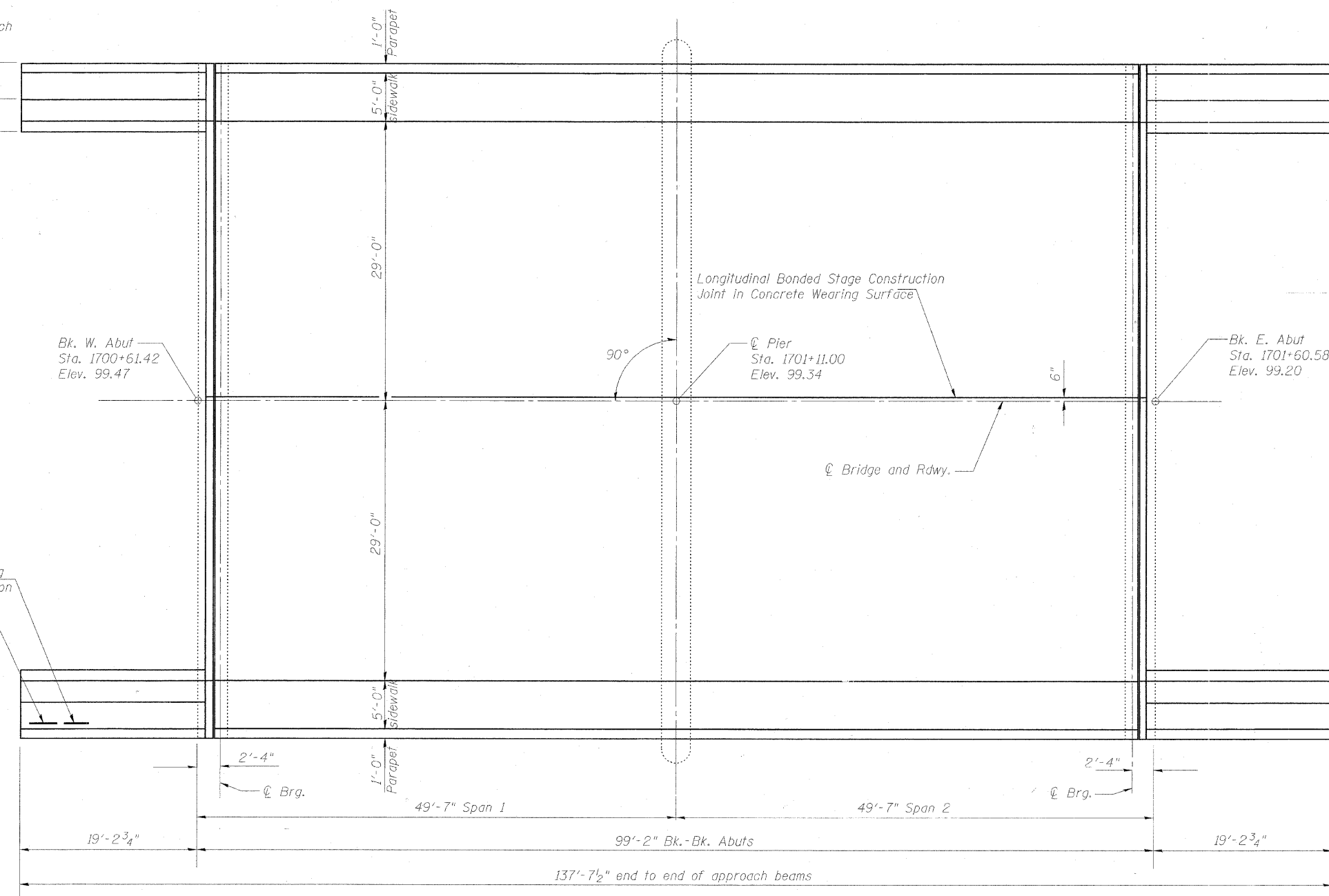

Relocated existing Name Plate location  
 Name Plate location

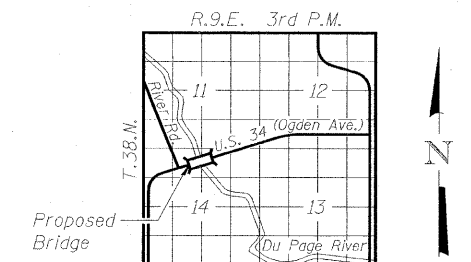

**LOCATION SKETCH**

**GENERAL PLAN & ELEVATION**  
**F.A.P. 311 (US RTE. 34)**  
**OVER W BRANCH OF DU PAGE RIVER**  
**SECTION 652X-B-R-1,**  
**DU PAGE COUNTY, STA. 1701+11**  
**STRUCTURE NO. 022-0040**

DESIGNED	DDB
CHECKED	LLV
DRAWN	MGM
CHECKED	DDB

**PLAN**

**APPROVED**  
 FOR STRUCTURAL ADEQUACY ONLY

*Ralph E. Anderson*  
 ENGINEER OF BRIDGES AND STRUCTURES

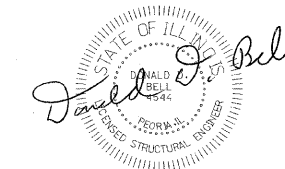

License Expires: 11/30/08  
 Date Signed: 11-8-07

