

PLAN	REVIEWED	DATE
	PLOTTED	
	CHECKED	
	ALIGNED	
	CADD FILE NAME	
	NO.	

PROFILE	REVIEWED	DATE
	PLOTTED	
	CHECKED	
	GRADED	
	STRUCTURE	
	NOTATION	
	CHKD	
	NO.	

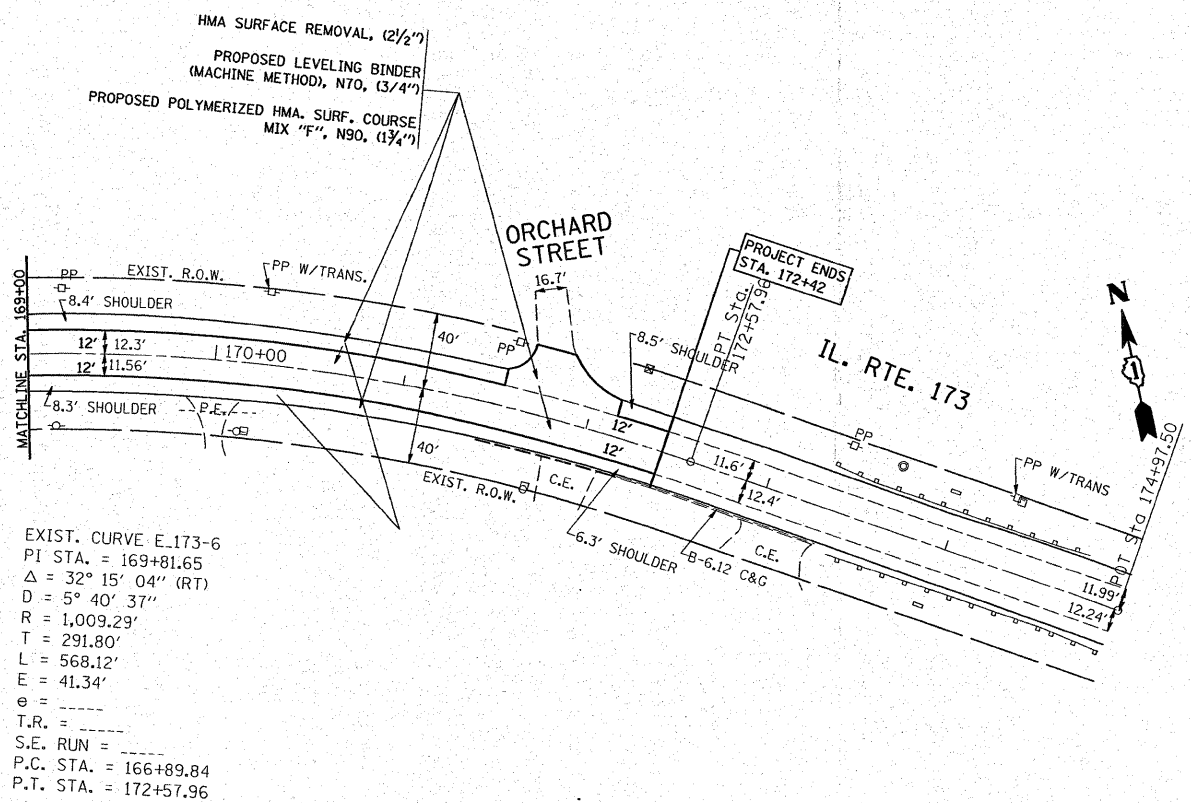

NOTE: LIMIT OF RESURFACING ON SIDE-STREETS THROUGH OUT THE IMPROVEMENT SHALL BE TO THE RADIUS OF RETURN OR AS DIRECTED BY THE ENGINEER.
 FOR SUPERELEVATION CORRECTION USE LEVELING BINDER

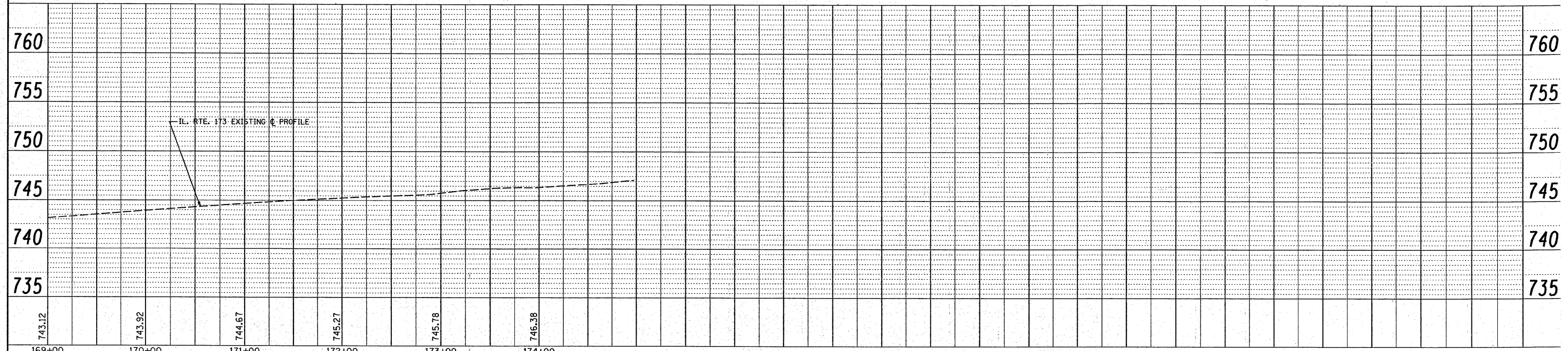

FILE NAME = c:\projects\101108\sh_rday.dgn	USER NAME = drivakasn	DESIGNED -	REVISED -	STATE OF ILLINOIS DEPARTMENT OF TRANSPORTATION	IL. RTE. 173 (FAP 303) (LAKE AVENUE TO ORCHARD STREET) PLAN AND PROFILE	F.A.P. RTE. 303	SECTION 049-1	COUNTY LAKE	TOTAL SHEETS 49	SHEET NO. 14	
PLOT SCALE = 50.0000' / IN.	CHECKED -	REVISED -	SCALE: 50H/5V=1"			SHEET NO. OF SHEETS	STA. 169+00 TO STA. 181+82.69	FED. ROAD DIST. NO. 1	ILLINOIS FED. AID PROJECT	CONTRACT NO. 60D39	
PLOT DATE = 1/31/2008	DATE -	REVISED -									