

BY	DATE
FINAL SURVEY	SURVEYED
NOTE BOOK	PLOTTED
NO.	TEMPLATE
	AREAS CHECKED
	AREAS CHECKED

BY	DATE
ORIGINAL SURVEY	SURVEYED
NOTE BOOK	PLOTTED
NO.	TEMPLATE
	AREAS CHECKED
	AREAS CHECKED

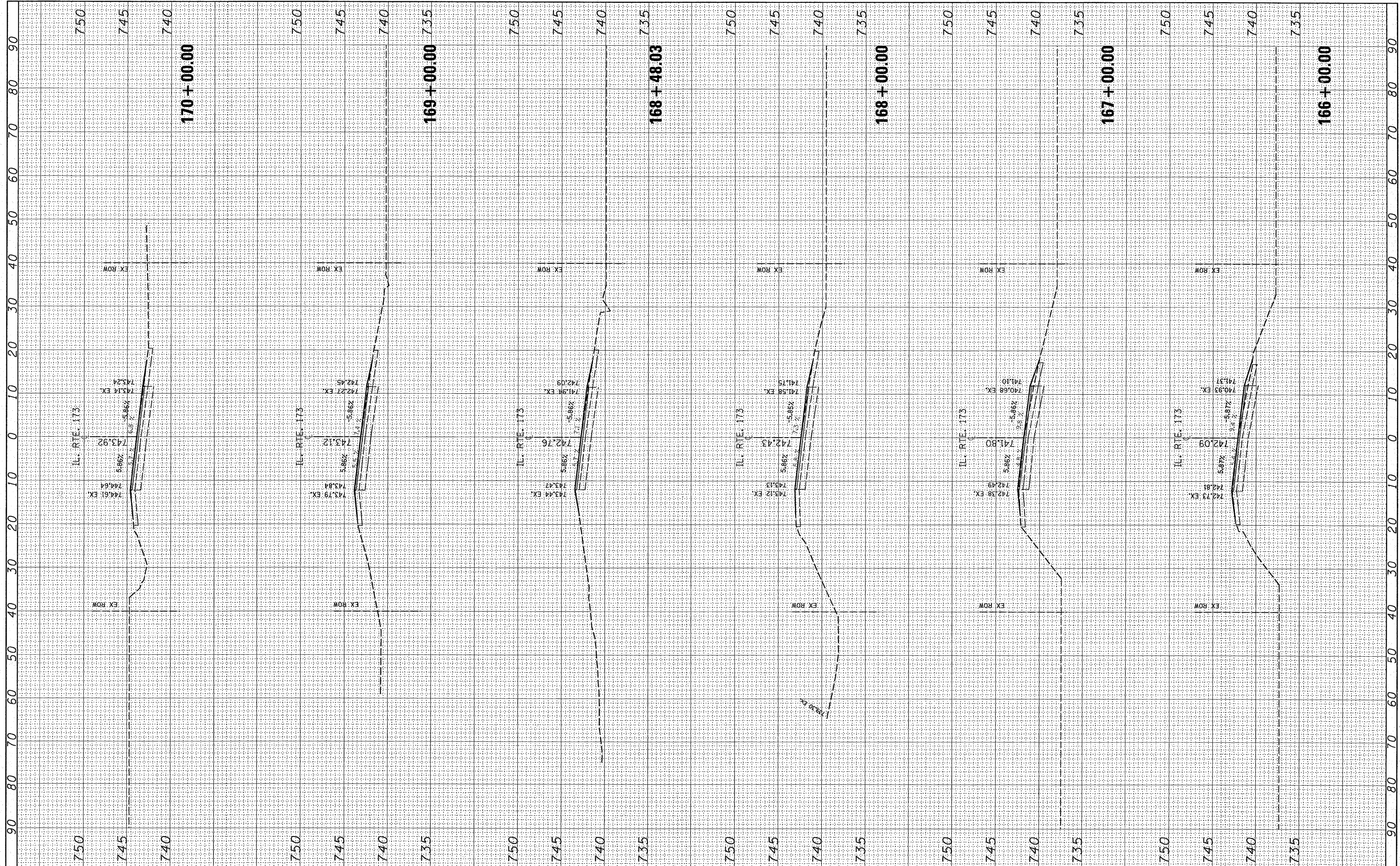

FILE NAME = c:\projects\dl01108\ss.173.shdgn

USER NAME = galbannb

DESIGNED -
DRAWN -
CHECKED -
DATE -

REVISED -
REVISED -
REVISED -
REVISED -

STATE OF ILLINOIS
DEPARTMENT OF TRANSPORTATION

IL 173 (LAKE AVENUE TO ORCHARD STREET)
CROSS SECTION

SCALE: SHEET NO. OF SHEETS STA. 166+00.00 TO STA. 170+00.00

F.A.P. RTE. 303	SECTION 2007-049 I	COUNTY LAKE	TOTAL SHEETS 48	SHEET NO. 48
CONTRACT NO. 60D39				
FED. ROAD DIST. NO. 1 ILLINOIS FED. AID PROJECT				