

F. A. S. ETC.	SECTION	COUNTY	TOTAL SHEETS	SHEET NO
	05-00113-00-PK	COOK	012	005
STA. 3+54		TO STA. 7+89		
FED. ROAD DIST. NO.	ALIAS	FED. AID PROJECT		

CONTRACT NO. 63006

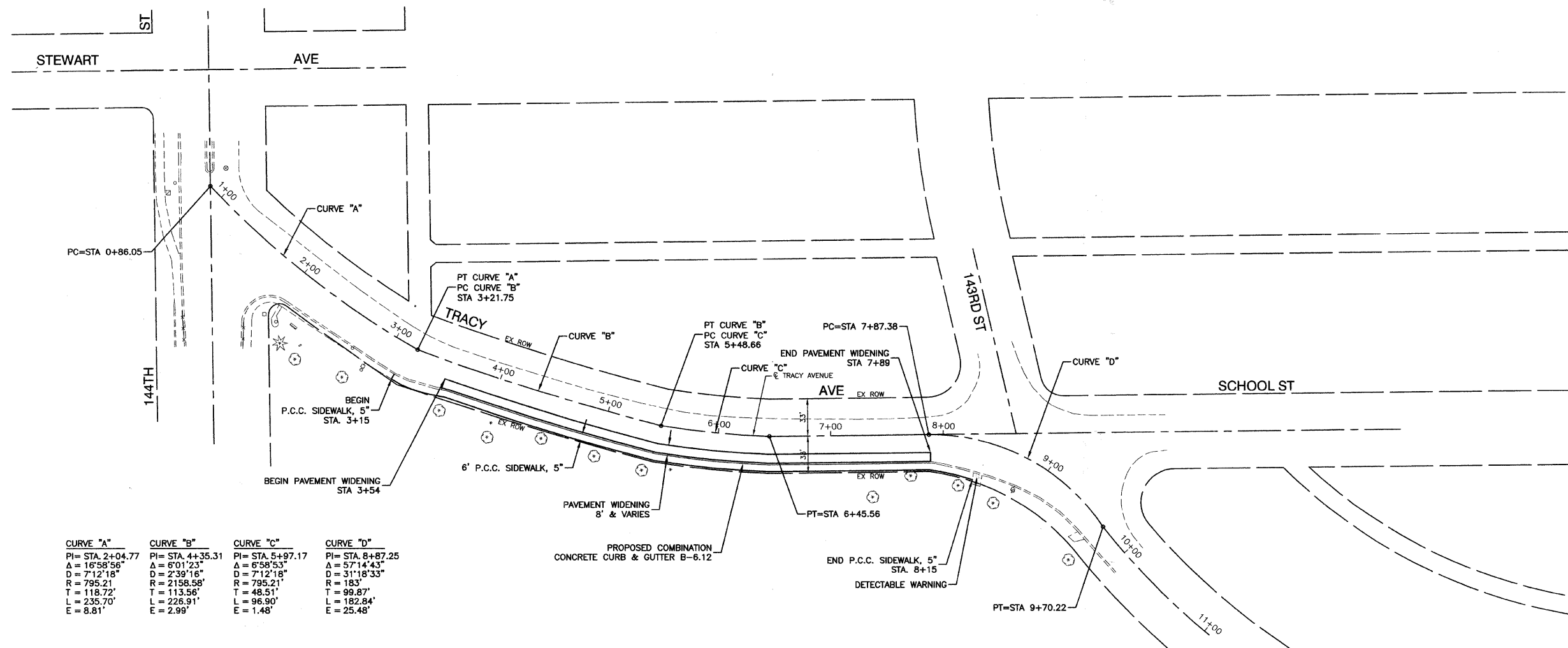

CURVE "A"	CURVE "B"	CURVE "C"	CURVE "D"
PI= STA. 2+04.77	PI= STA. 4+35.31	PI= STA. 5+97.17	PI= STA. 8+87.25
Δ = 16°58'56"	Δ = 6°01'23"	Δ = 6°58'53"	Δ = 57°14'43"
D = 7'12"18"	D = 2'39"16"	D = 7'12"18"	D = 31'18"33"
R = 795.21	R = 2158.58	R = 795.21	R = 183'
T = 118.72'	T = 113.56'	T = 48.51'	T = 99.87'
L = 235.70'	L = 226.91'	L = 96.90'	L = 182.84'
E = 8.81'	E = 2.99'	E = 1.48'	E = 25.48'

BENCH MARK:
RR SPIKE SET IN WEST FACE OF WOOD LIGHT POLE AT NORTH WEST CORNER OF 143RD STREET AND TRACY AVENUE. ELEVATION=600.984

ILLINOIS DEPARTMENT OF TRANSPORTATION
**IVANHOE METRA COMMUTER KISS 'N RIDE
PROPOSED PLAN**

REVISIONS	
NAME	DATE

SCALE: VERT. 1"=50'
HORIZ. 1"=50'
DATE 11-1-07
DRAWN BY AG/EDG
CHECKED BY PKB