

F. A. L. A. SECTION	COUNTY	TOTAL SHEETS	SHEET NO.
05-00113-00-PK	COOK	012	001
STA.	TO STA.	12+1 = 13	
FED. ROAD DIST. NO.	ILLINOIS	FED. AID PROJECT	

CONTRACT NO. 63006

INDEX OF SHEETS

1. TITLE SHEET
2. SUMMARY OF QUANTITIES & GENERAL NOTES
3. TYPICAL CROSS SECTIONS
4. REMOVAL PLAN
5. PROPOSED PLAN
6. PAVEMENT MARKING AND SIGNAGE PLAN
7. LIGHTING PLAN
8. LIGHTING DETAILS
- 9.-10. CROSS SECTIONS
- 11.-12. DISTRICT STANDARDS

STATE STANDARDS

- | | |
|-----------|--|
| 000001-05 | STANDARD SYMBOLS, ABBREVIATIONS AND PATTERNS |
| 280001-04 | TEMPORARY EROSION CONTROL SYSTEMS |
| 424001-05 | CURB RAMPS FOR SIDEWALKS |
| 606001-03 | CONCRETE CURB TYPE B & COMBINATION CONCRETE CURB & GUTTER |
| 701006-02 | OFF-ROAD OPERATIONS, 2L, 2W |
| 701301-02 | LANE CLOSURE, 2L, 2W, SHORT TIME OPERATIONS |
| 701311-02 | LANE CLOSURE, 2L, 2W, MOVING OPERATIONS-DAY ONLY |
| 701501-04 | URBAN LANE CLOSURE, 2L, 2W, UNDIVIDED |
| 701801-03 | URBAN LANE CLOSURE, ML, 2W, CROSSWALK AND SIDEWALK CLOSURE |
| 701901 | TRAFFIC CONTROL DEVICES |
| 720001 | SIGN PANEL MOUNTING DETAILS |
| 720006-01 | SIGN PANEL ERECTION DETAILS |
| 720011 | METAL POSTS FOR SIGNS, MARKERS, AND DELINEATORS |
| 729001 | APPLICATIONS OF TYPE A AND B METAL POSTS (FOR SIGNS & MARKERS) |
| 780001-01 | TYPICAL PAVEMENT MARKINGS |
| 805001 | ELECTRIC SERVICE INSTALLATION DETAILS |

STATE OF ILLINOIS
DEPARTMENT OF TRANSPORTATION
DIVISION OF HIGHWAYS

PLANS FOR PROPOSED FEDERAL AID HIGHWAY

**IVANHOE METRA COMMUTER KISS 'N RIDE
TRACY AVENUE BETWEEN 143RD ST. AND 144TH ST.
CMAQ PROJECT NO.: CMM-8003(584)
L.A. SECTION NO:05-00113-00-PK
VILLAGE of RIVERDALE
COOK COUNTY
C-91-133-06**

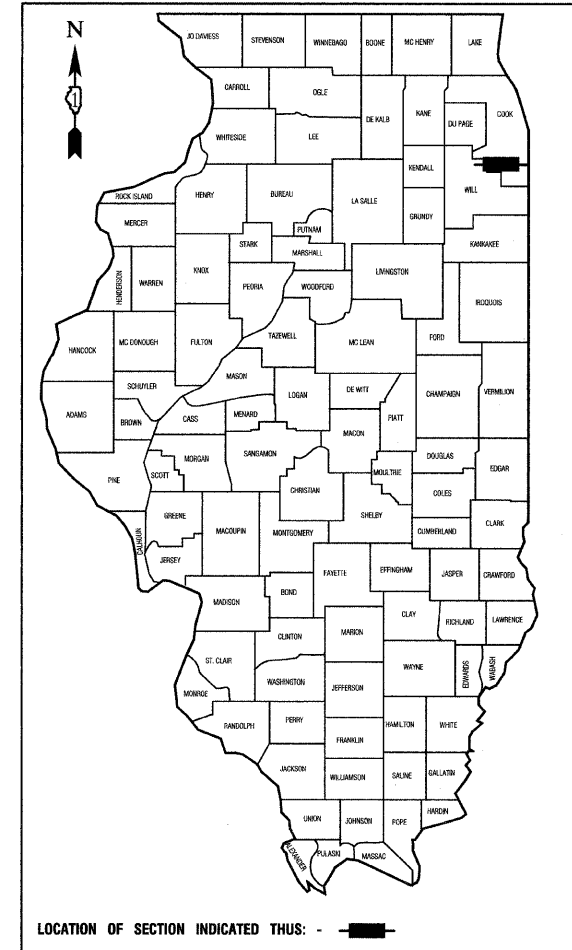

DESIGN DESIGNATION - TRACY AVENUE ADT 5,600 (2030) - LOCAL ROAD
PV=4,928 SU=392 MU=280

TRACY AVENUE

2006 ADT - 5,500
2030 ADT - 5,600

POSTED SPEED LIMIT - 25 MPH

DESIGN PERIOD - 20 YEARS
DESIGN SPEED LIMIT - 30 MPH
STREET CLASSIFICATION - CLASS III

END OF IMPROVEMENTS
TRACY AVE. STA. 8+15

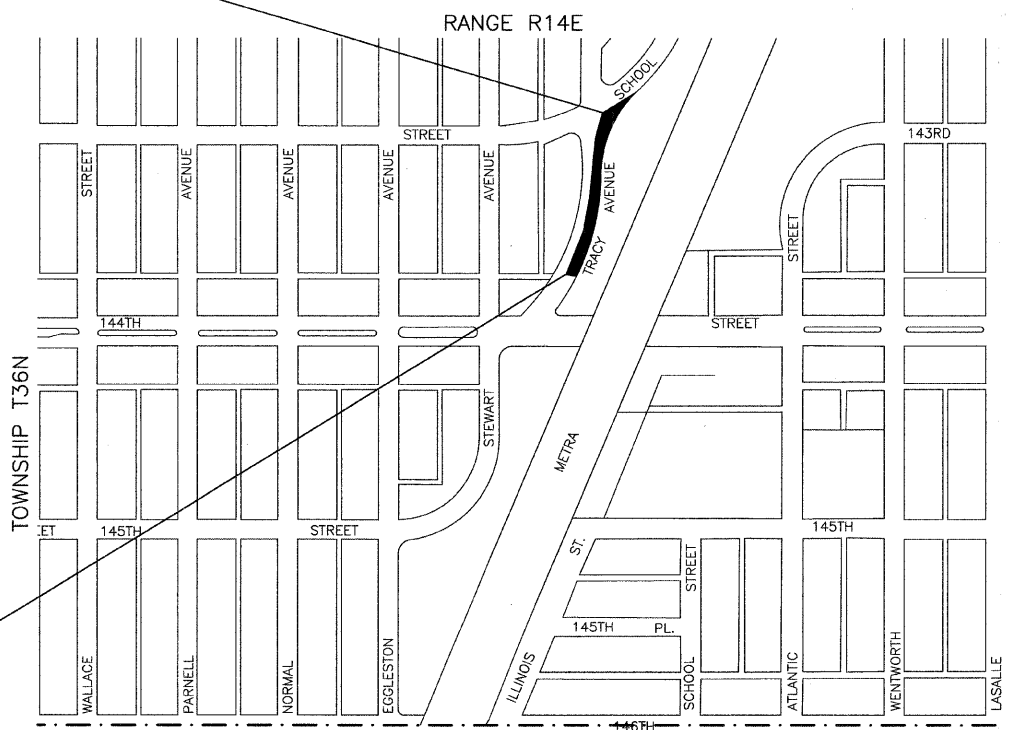

BEGINNING OF IMPROVEMENTS
TRACY AVE. STA 3+15

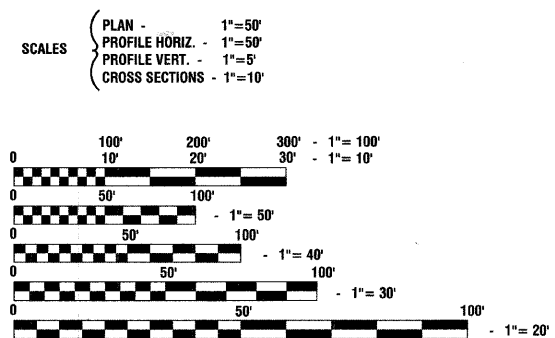

FULL SIZE PLANS HAVE BEEN PREPARED USING STANDARD ENGINEERING SCALES, REDUCED SIZED PLANS WILL NOT CONFORM TO STANDARD SCALES, IN MAKING MEASUREMENTS ON REDUCED PLANS, THE ABOVE SCALES MAY BE USED.

J. U. L. I. E.
JOINT UTILITY LOCATION INFORMATION FOR EXCAVATION
1 - 800 - 892 - 0123

LOCATION MAP

GROSS LENGTH=528 FEET=0.10 MILES
NET LENGTH=528 FEET=0.10 MILES

STATE OF ILLINOIS
DEPARTMENT OF TRANSPORTATION
DIVISION OF HIGHWAYS

APPROVED: December 21, 2007
Benjamin B. Evans
PRESIDENT, VILLAGE OF RIVERDALE

PASSED: FEBRUARY 19, 2008
Christopher Holt
DISTRICT ENGINEER OF LOCAL ROADS & STREETS

RELEASED FOR BID BASED ON LIMITED REVIEW: FEBRUARY 14, 2008
Dan M. O'Keefe
DEPUTY DIRECTOR OF HIGHWAYS, REGION ONE ENGINEER

**PRINTED BY THE AUTHORITY OF
THE STATE OF ILLINOIS**

PREPARED BY OR UNDER THE
DIRECT SUPERVISION OF:
Shrik Bah
12/21/07

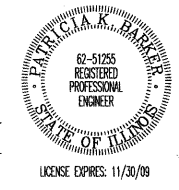

FIELD ENGINEER: MELCHOR MANGOBA 847-705-4408
CONSULTANTS: ROBINSON ENGINEERING, LTD. 708-331-6700

CONTRACT NO. 63006

F.A.S. ETC.	SECTION	COUNTY	TOTAL SHEETS	SHEET NO.
	05-00113-00-PK	COOK	012	002
STA.		TO STA.		
FED. ROAD DIST. NO.	BLKNO.	FED. AID PROJECT		

CONTRACT NO. 63006

SUMMARY OF QUANTITIES					PAVEMENT	MARKINGS	SIGNS	LANDSCAPE	LIGHTING				
S.P.	S.I.	CODE NO.	PAY ITEM	UNIT	QUAN	CONSTRUCTION TYPE CODE							
						I000	SFTY-1D	Y002-1C	Y003	Y030-1E			
		20100110	TREE REMOVAL (6 TO 15 UNITS DIAMETER)	UNIT	14				14				
		20100210	TREE REMOVAL (OVER 15 UNITS DIAMETER)	UNIT	21				21				
		20101000	TEMPORARY FENCE	FOOT	50				50				
		20101200	TREE ROOT PRUNING	EACH	7				7				
		20200500	EARTH EXCAVATION (WIDENING)	CU YD	205	205							
		20201200	REMOVAL AND DISPOSAL OF UNSUITABLE MATERIAL	CU YD	23.5	23.5							
Δ		20700420	POROUS GRANULAR EMBANKMENT, SUBGRADE	CU YD	23.5	23.5							
		21001000	GEOTECHNICAL FABRIC FOR GROUND STABILIZATION	SQ YD	71	71							
		21101615	TOPSOIL FURNISH AND PLACE, 4"	SQ YD	167				167				
		25000400	NITROGEN FERTILIZER NUTRIENT	POUND	3				3				
		25000500	PHOSPHORUS FERTILIZER NUTRIENT	POUND	3				3				
		25000600	POTASSIUM FERTILIZER NUTRIENT	POUND	3				3				
		25200100	SODDING	SQ YD	167				167				
		25200200	SUPPLEMENTAL WATERING	UNIT	5				5				
		28000400	PERIMETER EROSION BARRIER	FOOT	500				500				
		28000510	INLET FILTERS	EACH	3				3				
		35101600	AGGREGATE BASE COURSE, TYPE B 4"	SQ YD	415	415							
		40600100	BITUMINOUS MATERIAL (PRIME COAT)	GAL	118	118							
		40600300	AGGREGATE (PRIME COAT)	TON	2	2							
		40701801	HOT-MIX ASPHALT PAVEMENT (FULL-DEPTH), 6"	SQ YD	394	394							
		42001300	PROTECTIVE COAT	SQ YD	452	452							
		42400200	PORTLAND CEMENT CONCRETE SIDEWALK 5 INCH	SQ FT	3170								
		42400800	DETECTABLE WARNINGS	SQ FT	12	12							
		44000100	PAVEMENT REMOVAL	SQ YD	96	96							
		44000500	COMBINATION CURB AND GUTTER REMOVAL	FOOT	445	445							
		44000600	SIDEWALK REMOVAL	SQ FT	50	50							
		60603800	COMBINATION CONCRETE CURB AND GUTTER, TYPE B-6.12	FOOT	445	445							
		67100100	MOBILIZATION	L SUM	1	1							
		70102620	TRAFFIC CONTROL AND PROTECTION, STANDARD 701501	L SUM	1	1							
		70102640	TRAFFIC CONTROL AND PROTECTION, STANDARD 701801	L SUM	1	1							
		72000100	SIGN PANEL - TYPE 1	SQ FT	4.88			4.88					
		72900200	METAL POST - TYPE B	FOOT	14			14					
*		78000200	THERMOPLASTIC PAVEMENT MARKING - LINE 4"	FOOT	1013		1013						
*		78000650	THERMOPLASTIC PAVEMENT MARKING - LINE 24"	FOOT	35		35						
*		81603040	UNIT DUCT, 600V, 2-1C NO.6, 1/C NO.8 GROUND, (XLP-TYPE USE), 1" DIA. POLYETHYLENE	FOOT	500				500				
*		83600200	LIGHT POLE FOUNDATION, 24" DIAMETER	FOOT	14				14				
Δ	*	XX001399	UNIT DUCT, BORED AND PULLED	FOOT	460				460				
Δ	*	XX005669	RELOCATE EXISTING LIGHTING UNIT	EACH	2				2				
Δ	*	XX006937	GROUND ROD, 5/8" DIA. X 10 FT.	EACH	2				2				
Δ	*	X0321478	MAINTENANCE OF EXISTING LIGHTING SYSTEM COMPLETE	L SUM	1				1				
Δ	*	X0322178	REMOVE EXISTING LIGHT POLE FOUNDATION	EACH	2				2				

* - INDICATES SPECIALTY ITEMS Δ - INDICATES SPECIAL PROVISION

REVISIONS	
NAME	DATE

ILLINOIS DEPARTMENT OF TRANSPORTATION

IVANHOE METRA COMMUTER KISS 'N RIDE

SUMMARY OF QUANTITIES & GENERAL NOTES

SCALE: VERT. NONE DRAWN BY PS/EDG

HORIZ. NONE CHECKED BY PKB

DATE 11-1-07

ROBINSON ENGINEERING, LTD.
 1700 SOUTH PARK AVENUE SOUTH HOLLAND, ILLINOIS 60473
 (708) 321-8100 FAX (708) 321-3800
 ILLINOIS DESIGN FIRM REGISTRATION NO. 184001128 04824-QUAN-01 - P01

F. A. S. NO.	SECTION	COUNTY	TOTAL SHEETS	SHEET NO.
	05-00113-00-PK	COOK	012	002A
STA.		TO STA.		
FED. ROAD DIST. NO.	ILLINOIS	FED. AID PROJECT		

CONTRACT NO. 63006

GENERAL NOTES

- ANY REFERENCE TO STANDARDS THROUGHOUT THE PLANS OR SPECIAL PROVISIONS SHALL BE INTERPRETED TO BE THE LATEST STANDARDS OF THE ILLINOIS DEPARTMENT OF TRANSPORTATION.
- ITEMS OF WORK LISTED IN THE SUMMARY OF QUANTITIES WHICH ARE NOT SPECIFICALLY INDICATED IN THE PLANS SHALL BE PERFORMED AT LOCATIONS AS DIRECTED BY THE ENGINEER.
- WHEN, IN THE CONSTRUCTION OPERATION, ANY LOOSE MATERIAL IS DEPOSITED IN THE FLOW LINE OF DITCHES, GUTTERS OR OTHER DRAINAGE STRUCTURES SO THAT THE NATURAL FLOW OF WATER IS OBSTRUCTED, IT SHALL BE REMOVED AT THE CLOSE OF EACH DAY BY THE CONTRACTOR AT HIS EXPENSE. AT THE CONCLUSION OF THE CONSTRUCTION OPERATIONS, ALL DRAINAGE STRUCTURES SHALL BE FREE FROM ALL DIRT AND DEBRIS. THIS WORK SHALL NOT BE PAID FOR SEPARATELY BUT SHALL BE CONSIDERED INCIDENTAL TO THE CONTRACT.
- WHEN EXISTING DRAINAGE FACILITIES ARE DISTURBED, THE CONTRACTOR SHALL PROVIDE AND MAINTAIN TEMPORARY OUTLETS AND CONNECTIONS FOR ALL PRIVATE OR PUBLIC DRAINS, SEWERS OR CATCH BASINS. HE SHALL PROVIDE FACILITIES TO TAKE IN ALL STORM WATER WHICH WILL BE RECEIVED BY THESE DRAINS & SEWERS AND DISCHARGE SAME. HE SHALL PROVIDE AND MAINTAIN AN EFFICIENT PUMPING PLANT, IF NECESSARY, AND A TEMPORARY OUTLET, AND BE PREPARED AT ALL TIMES TO DISPOSE OF THE WATER RECEIVED FROM THESE TEMPORARY SEWER CONNECTIONS UNTIL SUCH TIME AS THE PERMANENT CONNECTIONS WITH SEWERS ARE BUILT AND IN SERVICE. THIS WORK SHALL NOT BE PAID FOR DIRECTLY, BUT WILL BE CONSIDERED INCIDENTAL TO THE CONTRACT.
- THE APPROXIMATE LOCATION OF KNOWN PUBLIC UTILITIES ARE SHOWN ON THE PLANS. HOWEVER, THE DEPARTMENT DOES NOT GUARANTEE ITS ACCURACY. PRIOR TO COMMENCING OPERATIONS ON THE PROJECT WHICH MAY IN ANY WAY CREATE THE POSSIBILITY OF INVOLVEMENT WITH EXISTING UTILITIES, THE CONTRACTOR SHALL CONTACT THE FIRM (OR COMMUNITY) INVOLVED. ADJUSTMENT OF ALL PUBLIC UTILITIES WITHIN THE LIMITS OF THIS IMPROVEMENT WILL BE DONE BY THE RESPECTIVE OWNERS. NO ADDITIONAL COMPENSATION WILL BE ALLOWED DUE TO DELAYS OR INCONVENIENCE CAUSED BY THESE ADJUSTMENTS. IT SHALL BE THE CONTRACTOR'S RESPONSIBILITY TO VERIFY LOCATIONS OF UNDERGROUND INSTALLATION BEFORE STARTING CONSTRUCTION OPERATIONS.
- ALL TRENCHES WITHIN 2 FEET OF PROPOSED PAVEMENT, DRIVEWAYS, AND SIDEWALKS SHALL BE BACKFILLED WITH TRENCH BACKFILL ONLY.
- THE CONTRACTOR SHALL PROTECT ALL TREES WITHIN AND ADJACENT TO THE CONSTRUCTION SITE DURING THE CLEARING AND SUBSEQUENT CONSTRUCTION OPERATIONS IN ACCORDANCE WITH SECTION 201 OF THE STANDARD SPECIFICATIONS. THOSE TREES TO BE REMOVED AS SHOWN IN THE PLANS SHALL BE DONE IN ACCORDANCE WITH SECTION 201 AND 202 OF THE STANDARD SPECIFICATIONS.
- BEFORE STARTING ANY EXCAVATION, THE CONTRACTOR SHALL CALL "JULIE" AT 800-892-0123 FOR FIELD LOCATIONS OF BURIED ELECTRIC, TELEPHONE AND GAS FACILITIES. (48 HOURS NOTIFICATION IS REQUIRED).
- THE CONTRACTOR SHALL COORDINATE CONSTRUCTION ACTIVITIES WITH UTILITY COMPANIES.
- THE CONTRACTOR WILL NOT BE ALLOWED TO SET UP A YARD OR FIELD OFFICE ON VILLAGE PROPERTY WITHOUT WRITTEN PERMISSION FROM THE VILLAGE.
- BARRICADES: THE CONTRACTOR SHALL PROVIDE AND INSTALL TWO (2) WEIGHTED SAND BAGS ON EACH TYPE I OR TYPE II BARRICADE USED. (ONE (1) WEIGHTED SAND BAG ACROSS EACH BOTTOM RAIL).
- THE CONTRACTOR SHALL CONTACT THE DISTRICT ONE TRAFFIC CONTROL SUPERVISOR AT (847) 705-4150 A MINIMUM OF 72 HOURS IN ADVANCE OF BEGINNING WORK. THE CONTRACTOR SHALL ALSO CONTACT ROBINSON ENGINEERING (708) 331-6700 AND THE VILLAGE OF RIVERDALE (708) 841-2200, A MINIMUM OF 72 HOURS IN ADVANCE OF BEGINNING WORK.
- ALL HMA PAVING SHALL FOLLOW DESIGNATED DRIVING LANES AS SHOWN IN STRIPING DETAILS. NO LONGITUDINAL PAVING JOINT OR SEAMS ARE ALLOWED WITHIN THE DRIVING LANES. ALL LONGITUDINAL PAVING JOINTS OR SEAMS WILL BE BETWEEN THE DRIVING LANES.
- POROUS GRANULAR EMBANKMENT (PGE) SUBGRADE HAS BEEN PROVIDED FOR LOCATIONS WHERE SOILS TEND TO BE UNSTABLE WHEN WET. THE ACTUAL NEED FOR REMOVAL AND REPLACEMENT WITH PGE WILL BE DETERMINED IN THE FIELD AT THE TIME OF CONSTRUCTION BY THE ENGINEER (BY USE OF A CONE PENETROMETER IN CONJUNCTION WITH THE IDOT SUBGRADE STABILITY MANUAL). IF UNSTABLE AND/OR UNSUITABLE MATERIALS ARE NOT ENCOUNTERED, THEN THE QUANTITY SHALL BE DEDUCTED AND NO ADDITIONAL COMPENSATION WILL BE DUE TO THE CONTRACTOR.
- ALL PAVEMENT, CURB AND SIDEWALK REMOVALS SHALL BE MADE BY MEANS OF STRAIGHT SAW CUT JOINT. THE COST FOR SAW CUTTING SHALL BE INCIDENTAL TO THE CONTRACT.
- CONTRACTOR SHALL BE RESPONSIBLE AT ALL TIMES FOR TRAFFIC CONTROL AND PROTECTION IN ACCORDANCE WITH THE IDOT STANDARD SPECIFICATIONS ADOPTED JANUARY 1, 2007, THE LATEST EDITION OF THE ILLINOIS MANUAL ON UNIFORM TRAFFIC AND CONTROL DEVICES FOR STREETS AND HIGHWAYS.
- THE CONTRACTOR SHALL MAKE EVERY ATTEMPT NOT TO DAMAGE EXISTING TREES.
- 10' TRANSITIONS SHALL BE USED TO MATCH PROPOSED CURB AND GUTTER TO EXISTING CURB AND GUTTER OR TO TAPER FROM 6" TO 0", UNLESS OTHERWISE SHOWN. THE TRANSITIONS SHALL BE PAID FOR AT THE CONTRACT UNIT PRICE FOR THE PROPOSED ITEM OF WORK SPECIFIED.
- TEMPORARY FENCE SHOULD BE ERECTED ALONG THE DRIPLINE OF EXISTING TREES TO REMAIN WITHIN THE LIMITS OF CONSTRUCTION. AFTER TREES ARE SAFELY FENCED NOTHING IS TO BE STORED, DRIVEN, OR DISTURBED INSIDE THE FENCE. REMOVE PROTECTIVE TEMPORARY FENCE ONLY AFTER ALL CONSTRUCTION WORK HAS BEEN COMPLETED.
- THE CONTRACTOR SHALL TAKE ALL NECESSARY PRECAUTIONS FOR THE PROTECTION OF EXISTING PLANT MATERIAL FOR WHICH THE CONTRACT DOES NOT PROVIDE REMOVAL. THE PROTECTION OF EXISTING PLANT MATERIAL AND THE REPAIR OR REPLACEMENT OF EXISTING PLANT MATERIAL DAMAGED BY THE CONTRACTOR SHALL BE DONE IN ACCORDANCE WITH THE REQUIREMENTS OF SECTION 201 OF THE STANDARD SPECIFICATIONS.
- TREE ROOT PRUNING IS TO BE USED ON EXISTING TREES TO PREVENT THE RIPPING UP OF ROOTS WHEN TRENCHING OR EXCAVATION IS WITHIN THE ROOT ZONE OF ADJACENT TREES TO REMAIN. SUPPLEMENTAL WATERING OF TREES SHOULD BEGIN IMMEDIATELY AFTER ROOT PRUNING OF THE TREES HAS OCCURRED.
- EROSION CONTROL WORK ITEMS ARE CONSIDERED TO BE HIGH PRIORITY ITEMS ON THIS CONTRACT. THE ENGINEER WILL IMPLEMENT ALL PROVISIONS OF THE SPECIFICATION NECESSARY TO ASSURE THAT EROSION CONTROL ITEMS ARE CONSTRUCTED AND MAINTAINED IN A TIMELY WAY. ALL EROSION CONTROL MEASURES SHALL BE INSTALLED PRIOR TO BEGINNING ANY CONSTRUCTION ACTIVITIES WHICH WILL POTENTIALLY CREATE ERODABLE CONDITIONS.
- PAYMENT FOR CONNECTION TO EXISTING STREET LIGHT SYSTEM SHALL BE CONSIDERED INCIDENTAL TO THE UNIT PRICE FOR UNIT DUCT.
- PAY LIMIT FOR AGGREGATE BASE COURSE, TYPE B, 4" SHALL BE 1 FT OFFSET FROM BACK OF CURB.

REVISIONS	
NAME	DATE

ILLINOIS DEPARTMENT OF TRANSPORTATION
IVANHOE METRA COMMUTER KISS 'N RIDE
SUMMARY OF QUANTITIES & GENERAL NOTES

SCALE: VERT. NONE
HORIZ. NONE
DATE 11-1-07

DRAWN BY PS/EDG
CHECKED BY PKB

F. A. N. P.E.	SECTION	COUNTY	TOTAL SHEETS	SHEET NO.
	05-00113-00-PK	COOK	012	003
STA.		TO STA.		
FED. ROAD DIST. NO.	ILLINOIS	FED. AID PROJECT		

CONTRACT NO. 63006

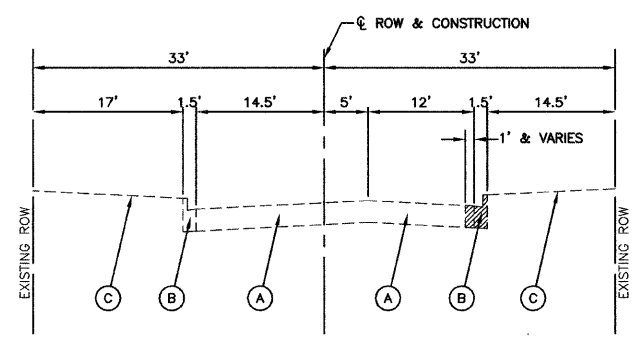

EXISTING TYPICAL CROSS SECTION
TRACY AVENUE
FROM STA. 3+54 TO STA. 7+89

- EXISTING LEGEND**
- (A) HMA PAVEMENT
 - (B) TYPE B-6.12 CURB
 - (C) GRASS PARKWAY
 - ▨ ITEM TO BE REMOVED

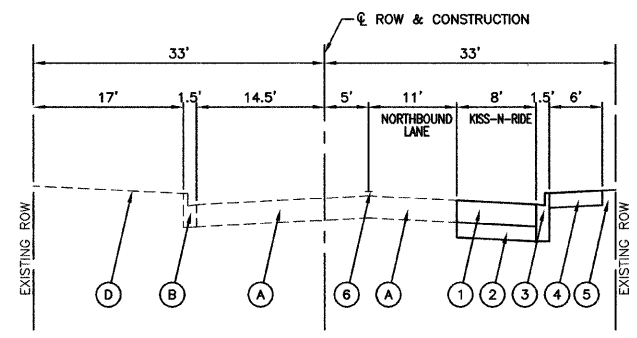

PROPOSED TYPICAL CROSS SECTION
TRACY AVENUE
FROM STA. 3+54 TO STA. 7+89

- PROPOSED LEGEND**
- (1) HOT-MIX ASPHALT PAVEMENT (FULL DEPTH) 6"
 - (2) AGGREGATE BASE COURSE, TYPE B, 4"
 - (3) COMBINATION CONCRETE CURB & GUTTER TYPE B-6.12
 - (4) P.C.C. SIDEWALK, 5"
 - (5) SODDING
 - (6) PAVEMENT MARKING

HOT-MIX ASPHALT MIXTURE REQUIREMENTS

MIXTURE TYPE	AC TYPE	AIR VOIDS
FULL DEPTH PAVEMENT		
HOT-MIX ASPHALT SURFACE COURSE, MIX "C", N50 (IL 9.5mm); 2"	PG 64-22	4% @ 50 Gyr.
HOT-MIX ASPHALT BINDER COURSE, IL-19.0, N50; 4"	PG 64-22/58-22 *	4% @ 50 Gyr.

THE UNIT WEIGHT USED TO CALCULATE ALL HOT-MIX ASPHALT SURFACE MIXTURE QUANTITIES IS 112 lbs/sq yd/in.
* WHEN RAP EXCEEDS 20%, THE NEW ASPHALT BINDER IN THE MIX SHALL BE PG 58-22

REVISIONS	
NAME	DATE

ILLINOIS DEPARTMENT OF TRANSPORTATION
**IVANHOE METRA COMMUTER KISS 'N RIDE
TYPICAL CROSS SECTIONS**

SCALE: VERT. NONE
HORIZ. NONE
DATE 11-1-07

DRAWN BY AG/EDG
CHECKED BY PKB

F. A. S. ETC.	SECTION	COUNTY	TOTAL SHEETS	SHEET NO.
	05-00113-00-PK	COOK	012	004
STA. 3+54		TO STA. 7+89		
FED. ROAD DIST. NO.	ALMORE	FED. AID PROJECT		

CONTRACT NO. 63006

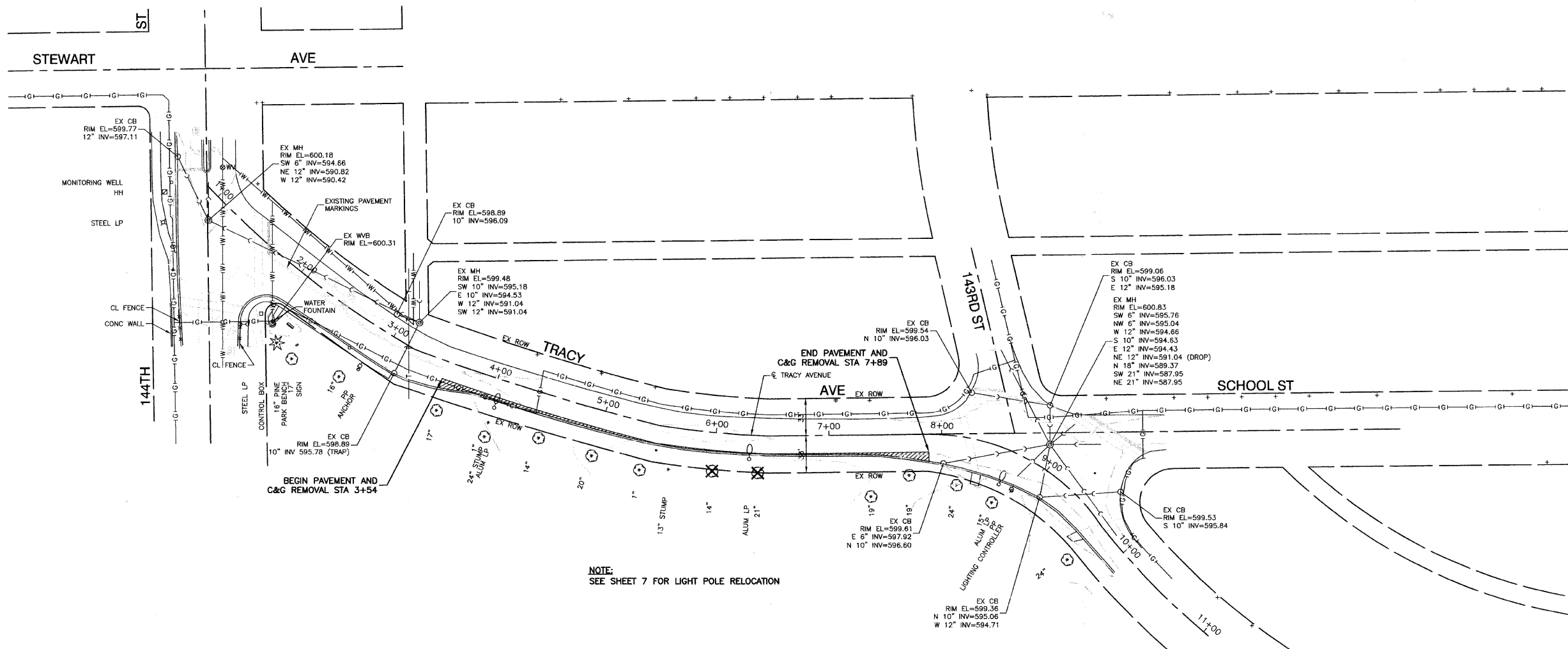

NOTE:
SEE SHEET 7 FOR LIGHT POLE RELOCATION

LEGEND

- TREE REMOVAL
- CURB & GUTTER REMOVAL
- PAVEMENT REMOVAL

REVISIONS	
NAME	DATE

BENCH MARK:
RR SPIKE SET IN WEST FACE OF WOOD LIGHT POLE AT NORTH WEST CORNER OF 143RD STREET AND TRACY AVENUE. ELEVATION=600.984

ILLINOIS DEPARTMENT OF TRANSPORTATION
IVANHOE METRA COMMUTER KISS 'N RIDE
REMOVAL PLAN

SCALE: VERT. 1"=50'
HORIZ. 1"=50'

DATE: 11-1-07

DRAWN BY: AG/EDG
CHECKED BY: PKB

F. A. S. ETC.	SECTION	COUNTY	TOTAL SHEETS	SHEET NO
	05-00113-00-PK	COOK	012	005
STA. 3+54		TO STA. 7+89		
FED. ROAD DIST. NO.	ALIAS	FED. AID PROJECT		

CONTRACT NO. 63006

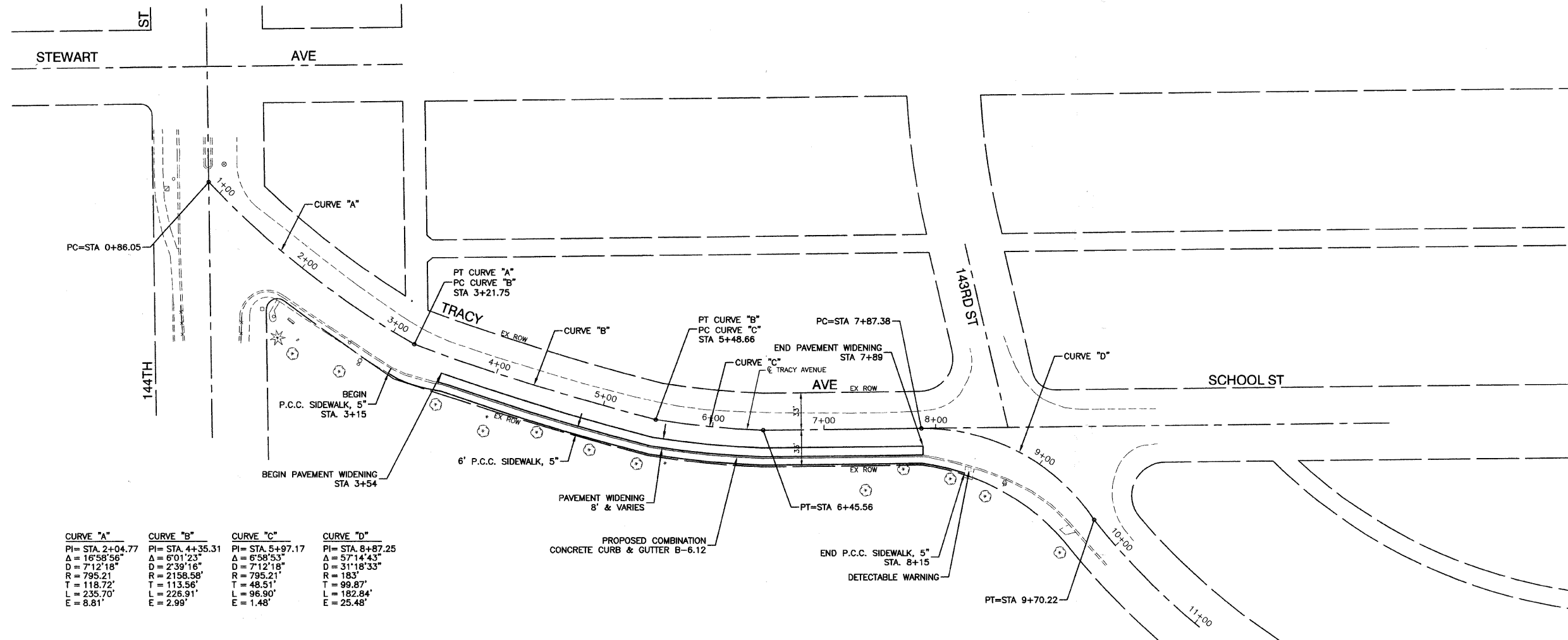

CURVE "A"	CURVE "B"	CURVE "C"	CURVE "D"
PI= STA. 2+04.77	PI= STA. 4+35.31	PI= STA. 5+97.17	PI= STA. 8+87.25
Δ = 16°58'56"	Δ = 6°01'23"	Δ = 6°58'53"	Δ = 57°14'43"
D = 7'12"18"	D = 2'39"16"	D = 7'12"18"	D = 31'18"33"
R = 795.21	R = 2158.58	R = 795.21	R = 183'
T = 118.72'	T = 113.56'	T = 48.51'	T = 99.87'
L = 235.70'	L = 226.91'	L = 96.90'	L = 182.84'
E = 8.81'	E = 2.99'	E = 1.48'	E = 25.48'

BENCH MARK:

RR SPIKE SET IN WEST FACE OF WOOD LIGHT POLE AT NORTH WEST CORNER OF 143RD STREET AND TRACY AVENUE. ELEVATION=600.984

ILLINOIS DEPARTMENT OF TRANSPORTATION
**IVANHOE METRA COMMUTER KISS 'N RIDE
 PROPOSED PLAN**

REVISIONS	
NAME	DATE

SCALE: VERT. 1"=50'
 HORIZ. 1"=50'
 DATE 11-1-07

DRAWN BY AG/EDG
 CHECKED BY PKB

F. A. S. RTE.	SECTION	COUNTY	TOTAL SHEETS	SHEET NO.
	05-00113-00-PK	COOK	012	006
STA. 3+54		TO STA. 7+89		
FED. ROAD DIST. NO.	ALMOST	FED. AID PROJECT		

CONTRACT NO. 63006

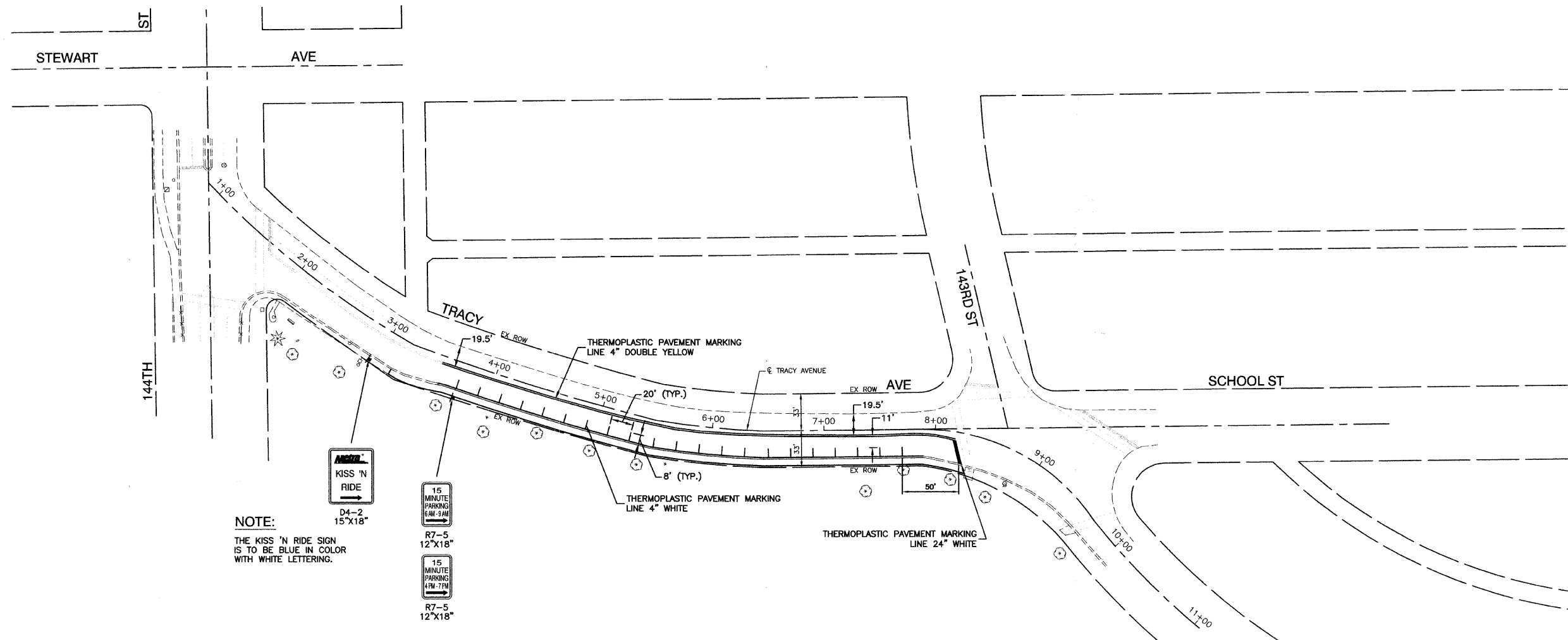
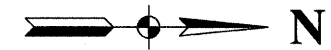

NOTE:

THE KISS 'N RIDE SIGN IS TO BE BLUE IN COLOR WITH WHITE LETTERING.



D4-2
15'x18"



R7-5
12'x18"



R7-5
12'x18"

BENCH MARK:

RR SPIKE SET IN WEST FACE OF WOOD LIGHT POLE AT NORTH WEST CORNER OF 143RD STREET AND TRACY AVENUE. ELEVATION=600.984

ILLINOIS DEPARTMENT OF TRANSPORTATION
IVANHOE METRA COMMUTER KISS 'N RIDE
PAVEMENT MARKING & SIGNAGE PLAN

REVISIONS	
NAME	DATE

SCALE: VERT. 1"=50'
HORIZ. 1"=50'
DATE 11-1-07

DRAWN BY AG/EDG
CHECKED BY PKB

F. A. S. NO.	SECTION	COUNTY	TOTAL SHEETS	SHEET NO.
	05-00113-00-PK	COOK	012	007
STA. 3+54		TO STA. 7+89		
FED. ROAD DIST. NO.	ILLINOIS	FED. AID PROJECT		

CONTRACT NO. 63006

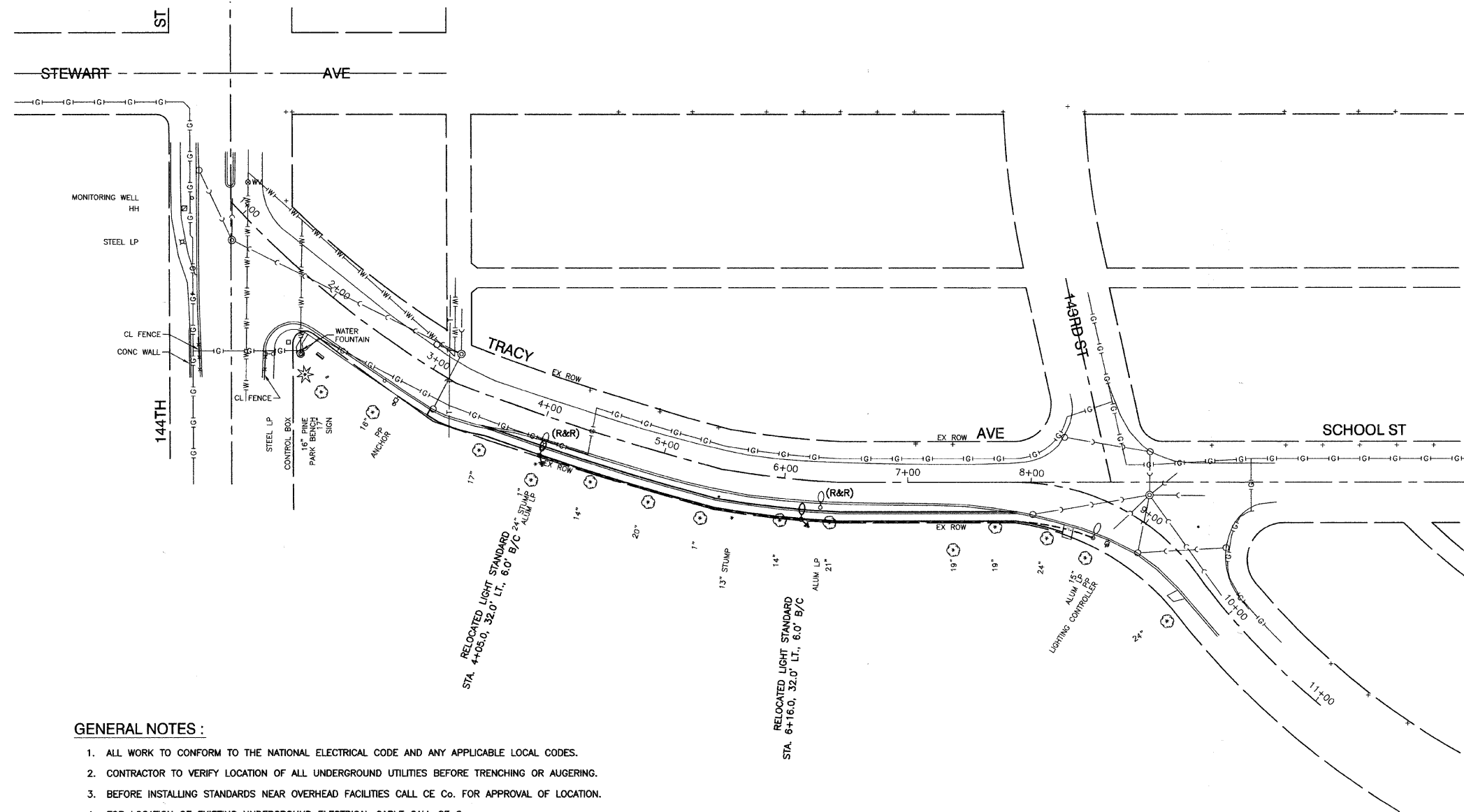

GENERAL NOTES :

1. ALL WORK TO CONFORM TO THE NATIONAL ELECTRICAL CODE AND ANY APPLICABLE LOCAL CODES.
2. CONTRACTOR TO VERIFY LOCATION OF ALL UNDERGROUND UTILITIES BEFORE TRENCHING OR AUGERING.
3. BEFORE INSTALLING STANDARDS NEAR OVERHEAD FACILITIES CALL CE Co. FOR APPROVAL OF LOCATION.
4. FOR LOCATION OF EXISTING UNDERGROUND ELECTRICAL CABLE CALL CE Co.
5. ALL PUSHED CONDUIT TO BE 2" DIAMETER UNLESS OTHERWISE SPECIFIED.
6. ANY TREE TRIMMING REQUIRED AS DIRECTED BY THE ENGINEER SHALL BE PERFORMED BY THE CONTRACTOR, AND THE COST OF THIS WORK SHALL BE CONSIDERED INCIDENTAL TO THE CONTRACT.
7. CONTRACTOR SHALL TAKE ALL NECESSARY MEASURES TO RESTORE ANY SPECIALIZED LANDSCAPING, (i.e. DECORATIVE ROCKS, SHRUBS, PLANTS, ECT.) OR SHALL REPLACE IT, THE COST OF WHICH SHALL BE CONSIDERED INCIDENTAL TO THE CONTRACT.
8. CONNECTION TO EXISTING STREET LIGHT SYSTEM SHALL BE CONSIDERED INCIDENTAL TO THE UNIT PRICE FOR UNIT DUCT.
9. STATION AND OFFSET CALLOUTS FOR PROPOSED FOUNDATIONS ARE TO THE CENTER OF FOUNDATION.

LEGEND:

- EXISTING STREET LIGHT
- EXISTING STREET LIGHT
- EXISTING CONTROLLER
- P CONDUIT, PUSHED, GALVANIZED STEEL
- T CONDUIT, TRENCHED, GALVANIZED STEEL
- UNIT DUCT, 2-1/2", NO.6 AWG AND NO.8 GROUND, 600V IN 1" DUCT
- SERVICE WIRE, 3-1/2", NO. 1/0 AWG. (SEE LIGHTING CONTROLLER PLAN)
- GR GROUND ROD, 5/8" DIA. x 10'
- (R&R) RELOCATE EXISTING STREET LIGHT
- LT LEFT
- RT RIGHT
- MH MOUNTING HEIGHT
- MA MAST ARM
- B/C BACK OF CURB
- BDTB BREAKAWAY DEVICE, TRANSFORMER BASE, 15" BOLT CIRCLE
- R&R REMOVE AND REPLACE EXISTING STREET LIGHT

REVISIONS	
NAME	DATE

ILLINOIS DEPARTMENT OF TRANSPORTATION
IVANHOE METRA COMMUTER KISS 'N RIDE
STREET LIGHTING

SCALE: VERT. 1"=50'
 DATE 11-1-07

DRAWN BY PS/EDG
 CHECKED BY PKB

F.A.S. R/E.	SECTION	COUNTY	TOTAL SHEETS	SHEET NO.
	05-00113-00-PK	COOK	012	008
STA.	TO STA.			
FED. ROAD DIST. NO.	ALINKS	FED. AID PROJECT		

CONTRACT NO. 63006

NOMINAL WATTAGE
250

FUSE SIZE
3.5 AMP

LUMINAIRE FUSE SIZE TABLE

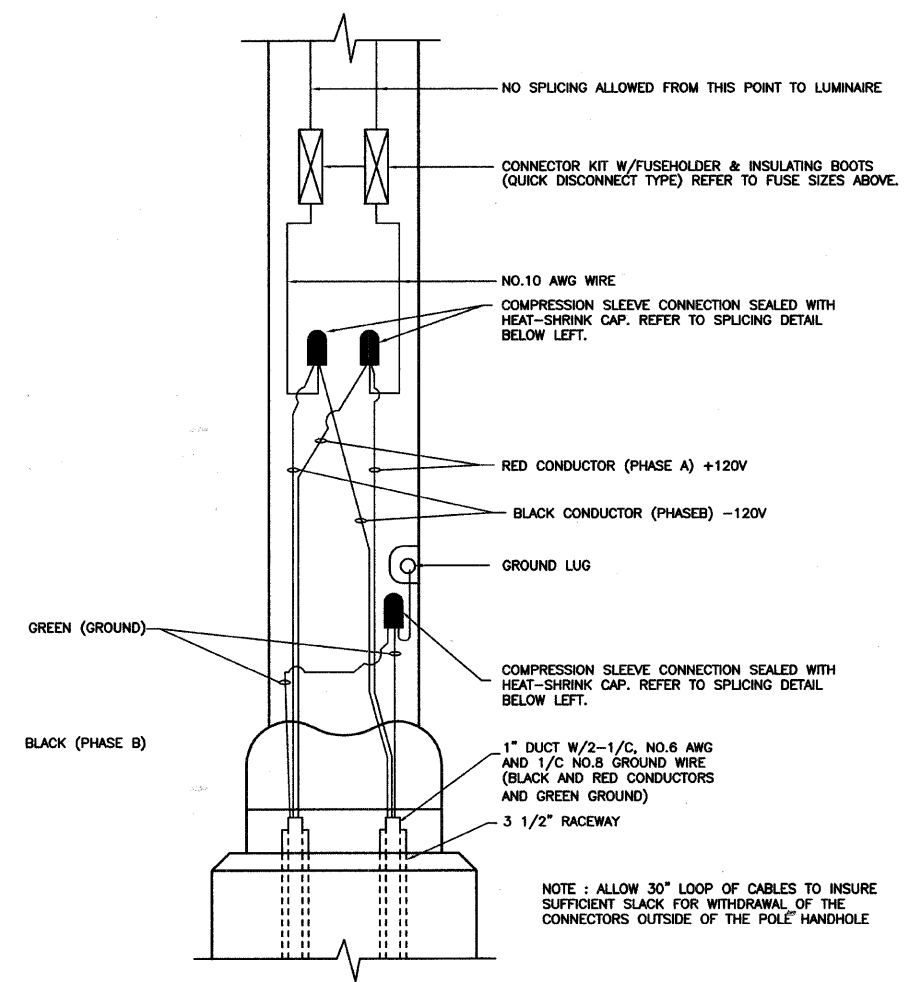

POLE HANDHOLE WIRING DIAGRAM
(TYPICAL FOR SINGLE LUMINAIRE INSTALLATION)

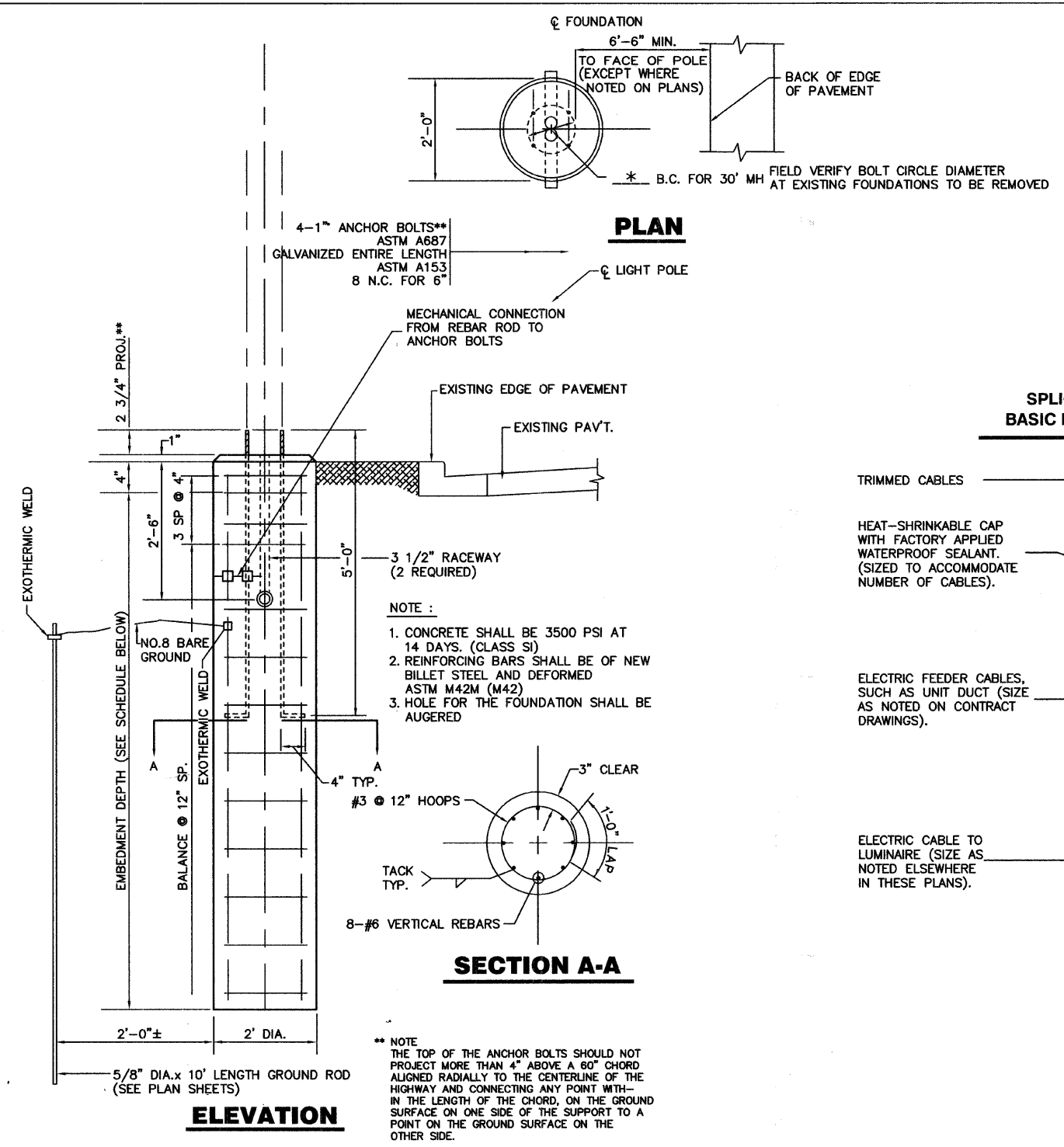

LIGHT POLE FOUNDATION (TYPICAL)

FOUNDATION SCHEDULE *

TYPE OF SOILS		EMBEDMENT			
DESCRIPTION	STANDARDS	MOUNTING HEIGHT			
		30 FT.	35 FT.	40 FT.	50 FT.
SOFT CLAY	Qu = .25-.50 T/FT. ²	9'-0"	9'-8"	10'-6"	14'-0"
MEDIUM CLAY	Qu = .50-1.0 T/FT. ²	6'-6"	7'-0"	7'-6" *	10'-0"
DENSE CLAY	Qu = 1.0-2.0 T/FT. ²	5'-6"	6'-0"	6'-6"	8'-6"
LOOSE SAND	N = 4-10	7'-0"	7'-8"	8'-4"	11'-0"
MEDIUM SAND	N = 10-30	6'-0"	6'-6"	7'-3"	9'-6"
DENSE SAND	N = 30-50	5'-6"	6'-0"	6'-6"	8'-6"

* NOTE:
ACTUAL FOUNDATION DEPTH IS 8'-8" EMBEDMENT DEPTH (FROM SCHEDULE) PLUS 6" EQUALS TOTAL DEPTH OF 7'-0" FOR 35' MOUNTING HEIGHT POLES

**SPLICING ELECTRIC CABLES
BASIC MATERIALS AND METHODS**

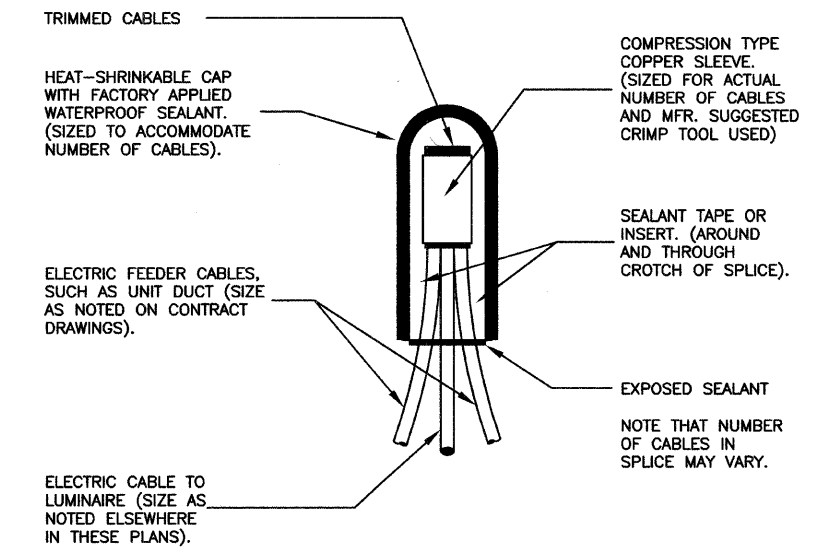

ILLINOIS DEPARTMENT OF TRANSPORTATION
IVANHOE METRA COMMUTER KISS 'N RIDE
LIGHTING DETAILS

REVISIONS	
NAME	DATE

SCALE: VERT. NONE
HORIZ. NONE
DATE: 11-1-07

DRAWN BY: PS
CHECKED BY: PAP

F. A. 11 REV.	SECTION	COUNTY	TOTAL SHEETS	SHEET NO.
	05-00113-00-PK	COOK	012	008
STA. 3+53.3		TO STA. 5+50		
FED. ROAD DIST. NO.	ILLINOIS	FED. AID PROJECT		

CONTRACT NO. 63006

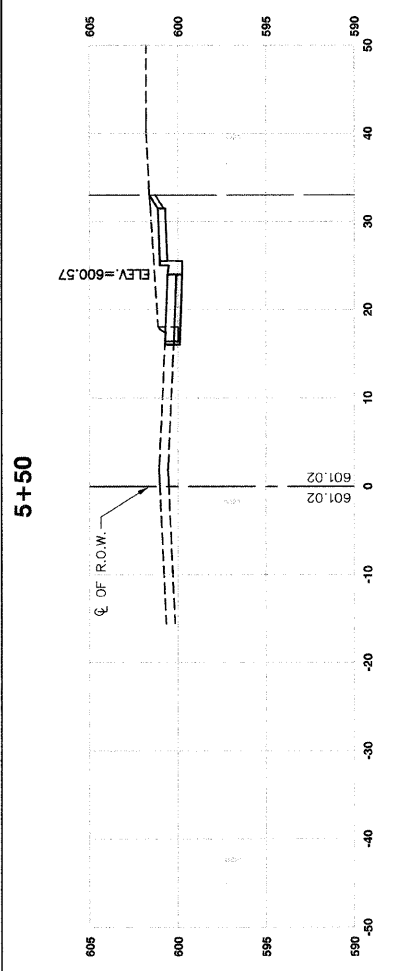

C=17 SF F=0 SF

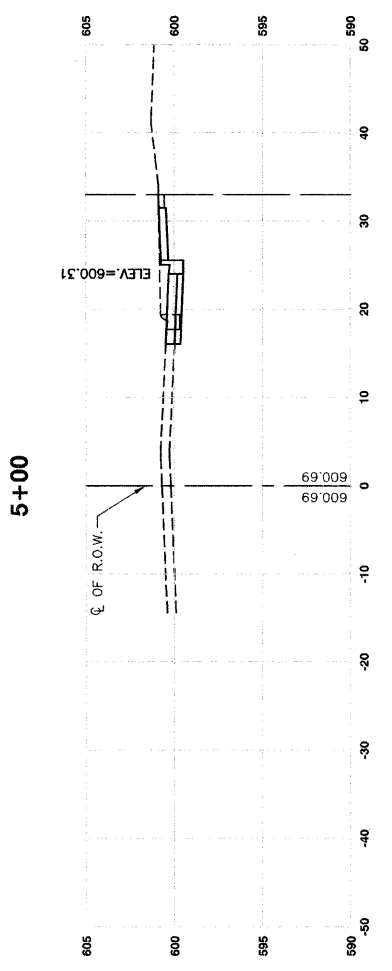

C=11 SF F=0 SF

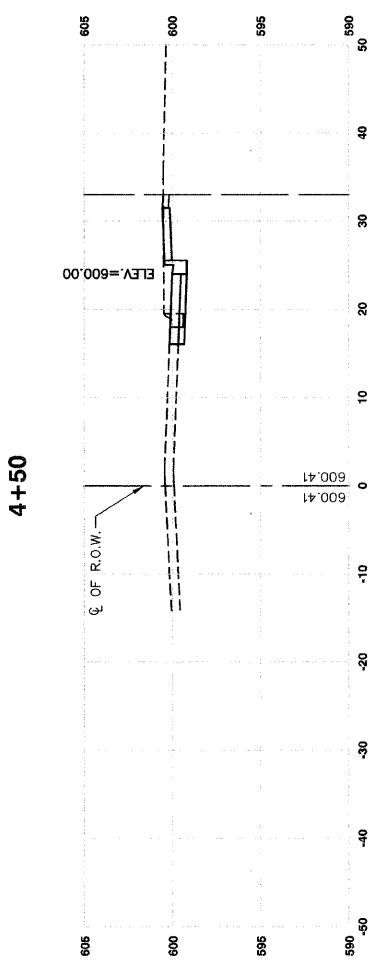

C=11 SF F=0 SF

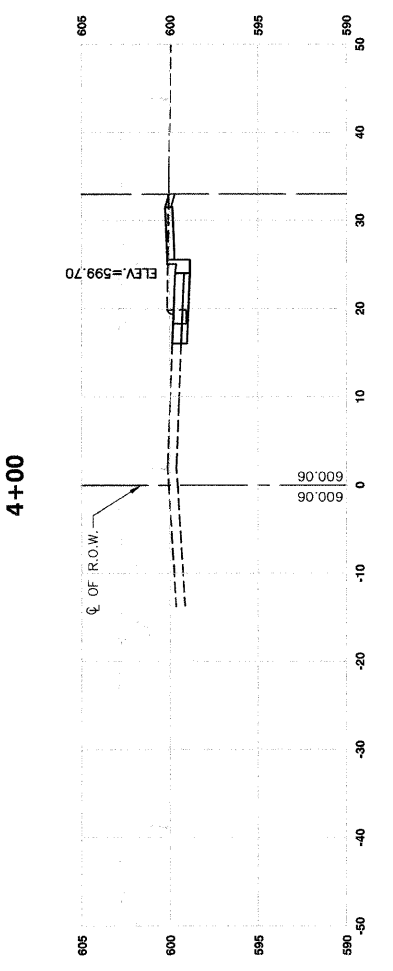

C=9 SF F=0 SF

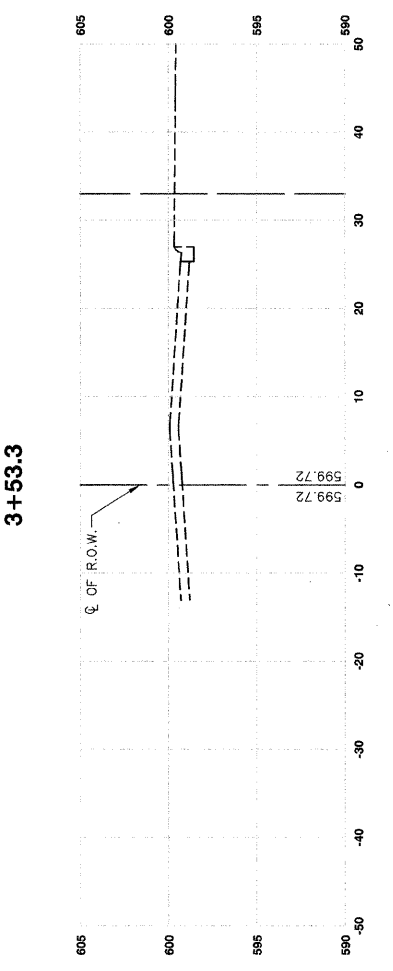

C=0 SF F=0 SF

REVISIONS	
NAME	DATE

ILLINOIS DEPARTMENT OF TRANSPORTATION
**IVANHOE METRA COMMUTER KISS 'N RIDE
 CROSS SECTIONS
 STA. 3+53.3 TO STA. 5+50**

SCALE: VERT. 1"=5'
 HORIZ. 1"=10'

DATE 11-1-07

DRAWN BY PS/EDG
 CHECKED BY PKB

ROBINSON ENGINEERING, LTD.
 1720 SOUTH PARK AVENUE SOUTH HOLLAND, ILLINOIS 60473
 (708) 231-8700 FAX (708) 231-3800
 ILLINOIS DESIGN FIRM REGISTRATION NO. 184001128

04624-XSEC-01 - X02

F. A. 91 SHEET	SECTION 05-00113-00-PK	COUNTY COOK	TOTAL SHEETS 012	SHEET NO. 010
STA. 6+00		TO STA. 8+00		
FED. ROAD DIST. NO.	ILLINOIS	FED. AID PROJECT		

CONTRACT NO. 63006

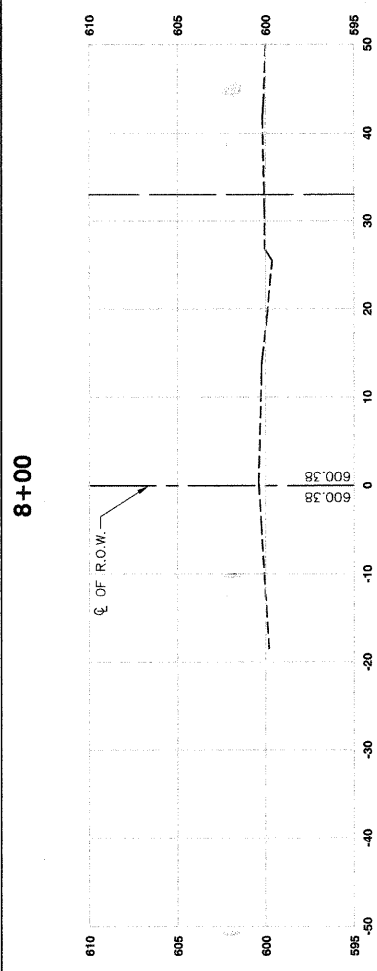

C=0 SF F=0 SF

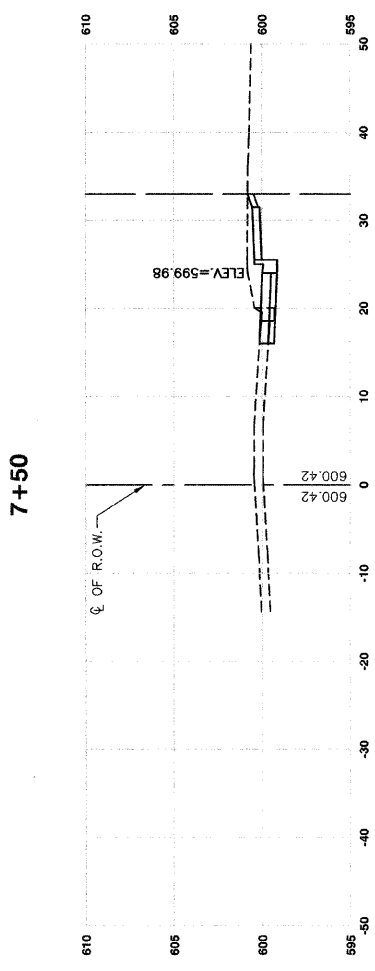

C=14 SF F=0 SF

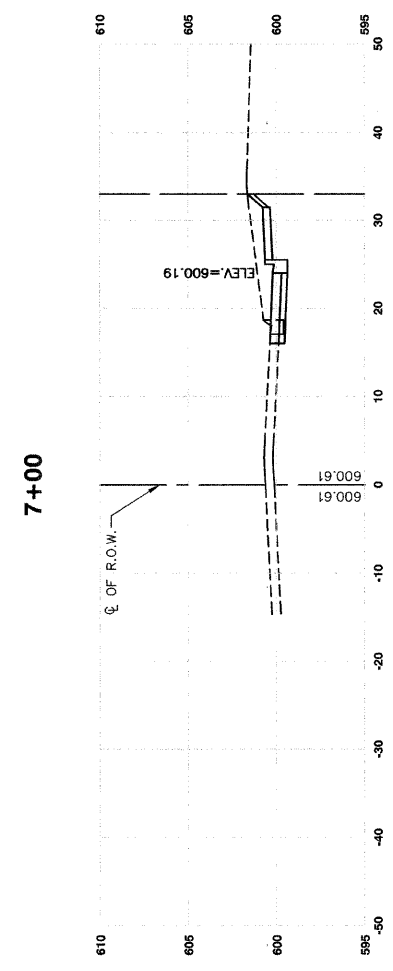

C=18 SF F=0 SF

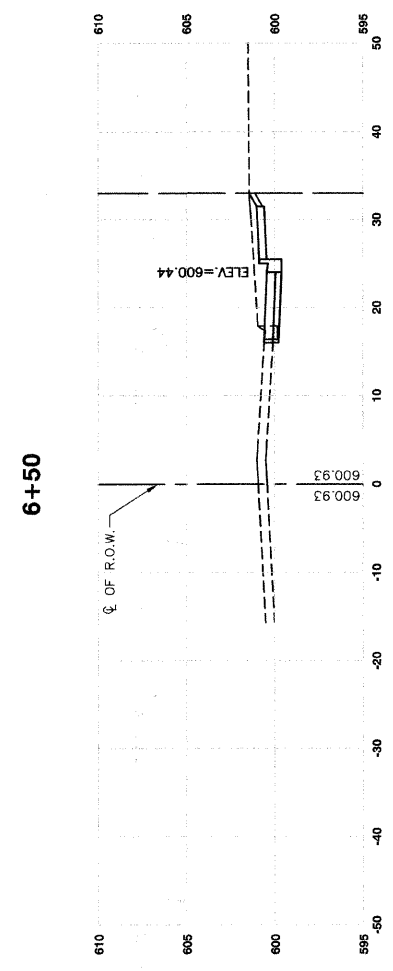

C=16 SF F=0 SF

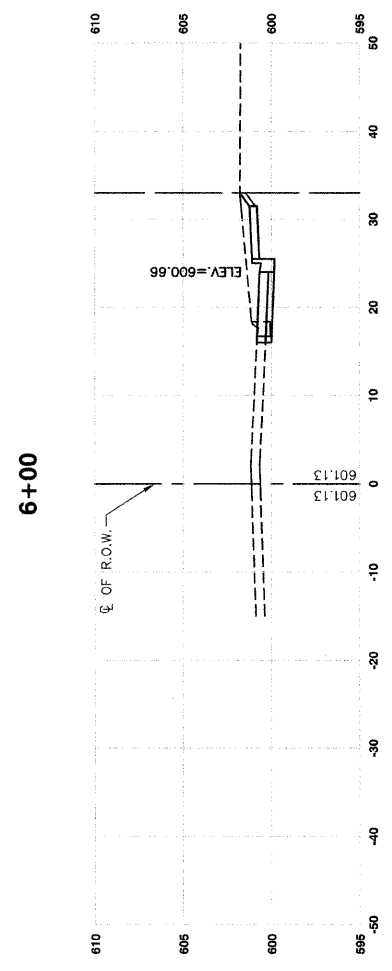

C=16 SF F=0 SF

REVISIONS	
NAME	DATE

ILLINOIS DEPARTMENT OF TRANSPORTATION
**IVANHOE METRA COMMUTER KISS 'N RIDE
 CROSS SECTIONS
 STA. 6+00 TO STA. 8+00**

SCALE: VERT. 1"=5'
 HORIZ. 1"=10'

DATE 11-1-07

DRAWN BY PS/EDG
 CHECKED BY PKB

ROBINSON ENGINEERING, LTD.
 1700 SOUTH PARK AVENUE SOUTH HOLLAND, ILLINOIS 60471
 (708) 331-6700 FAX (708) 331-3608
 ILLINOIS DESIGN FIRM REGISTRATION NO. 184001128

04624-XSEC-01 - X03

F. A. U. MILE	SECTION	COUNTY	TOTAL SHEETS	SHEET NO.
	05-00113-00-PK	COOK	012	011
STA.		TO STA.		
FED. ROAD DIST. NO.	ELIMOS	FED. AID PROJECT		

CONTRACT NO. 63006

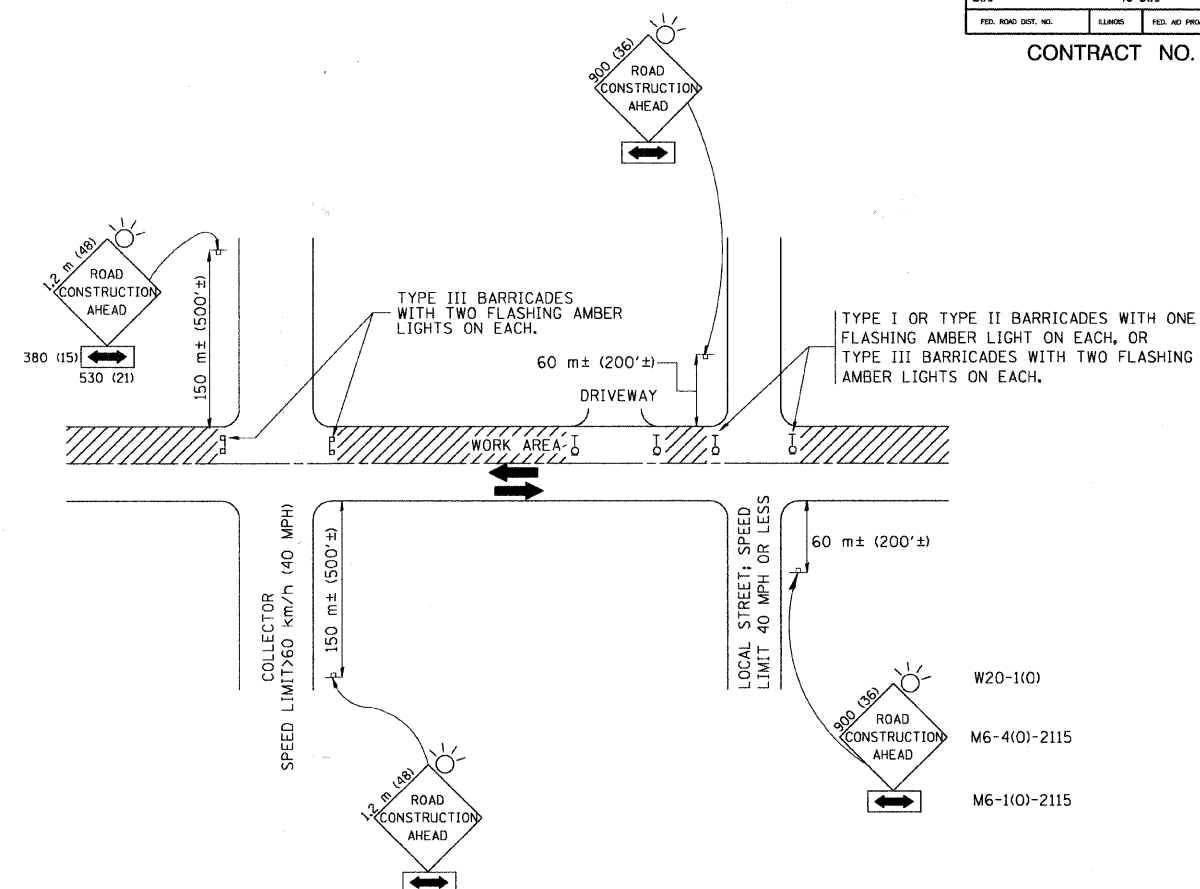

TRAFFIC CONTROL AND PROTECTION FOR SIDE ROADS, INTERSECTIONS, AND DRIVEWAYS

NOTES:

- A. FOR NO LANE RESTRICTION ON THE SIDE ROAD OR DRIVEWAYS
- SIDE ROAD WITH A SPEED LIMIT OF 60 km/h (40 MPH) OR LESS AS SHOWN ON THE DRAWING AND AS DIRECTED BY THE ENGINEER:
 - ONE **ROAD CONSTRUCTION AHEAD** SIGN 900x900 (36x36) WITH A FLASHER AND FLAG MOUNTED ON IT APPROXIMATELY 60 m (200') IN ADVANCE OF THE MAIN ROUTE.
 - THE CLOSED PORTION OF THE MAIN ROUTE SHALL BE PROTECTED BY BLOCKING WITH TYPE I, TYPE II OR TYPE III BARRICADES, 1/3 OF THE CROSS SECTION OF THE CLOSED PORTION.
 - SIDE ROAD WITH A SPEED LIMIT GREATER THAN 60 km/h (40 MPH) AS SHOWN ON THE DRAWING AND AS DIRECTED BY THE ENGINEER:
 - ONE **ROAD CONSTRUCTION AHEAD** SIGN 1.2 m x 1.2 m (48x48) WITH A FLASHER MOUNTED ON IT APPROXIMATELY 150 m (500') IN ADVANCE OF THE MAIN ROUTE.
 - THE CLOSED PORTION OF THE MAIN ROUTE SHALL BE PROTECTED BY BLOCKING WITH TYPE III BARRICADES, 1/2 OF THE CROSS SECTION OF THE CLOSED PORTION.
 - WHEN THE SIDE ROAD LIES BETWEEN THE BEGINNING OF THE MAINLINE SIGNING AND THE WORK ZONE, A SINGLE HEADED ARROW (M6-1) SHALL BE USED IN LIEU OF THE DOUBLE HEADED ARROW (M6-4).
- B. FOR A LANE CLOSURE ON A SIDE ROAD OR DRIVEWAY:
- USE APPLICABLE PORTIONS OF THE TYPICAL APPLICATION OF TRAFFIC CONTROL DEVICES (STD. 701501, STD. 701606 OR THE APPROPRIATE STANDARD). THE SPACING OF SIGNS AND BARRICADES SHALL BE ADJUSTED FOR FIELD CONDITIONS AS DIRECTED BY THE ENGINEER. THE DIRECTIONAL ARROW SHALL BE COVERED OR REMOVED WHEN NO LONGER CONSISTENT WITH THE SIDE ROAD LANE CLOSURE.
- C. ADVANCE WARNING SIGNS ARE TO BE OMITTED ON DRIVEWAY UNLESS OTHERWISE NOTED.
- D. THE TRAFFIC CONTROL AND PROTECTION FOR SIDE ROADS, INTERSECTIONS, AND DRIVEWAYS SHALL BE INCIDENTAL TO THE COST OF SPECIFIED TRAFFIC CONTROL STANDARDS OR ITEMS.

REVISIONS		ILLINOIS DEPARTMENT OF TRANSPORTATION TRAFFIC CONTROL AND PROTECTION FOR SIDE ROADS, INTERSECTIONS, AND DRIVEWAYS
NAME	DATE	
LHA	6/89	SCALE: VERT. HORIZ. DATE 10/18/2002
T. RAMMACHER	09/08/94	
J. OBERLE	10/18/95	
A. HOUSEH	03/06/96	
A. HOUSEH	10/15/96	
T. RAMMACHER	01/06/00	DRAWN BY CHECKED BY
		TC-10

CONTRACT NO. 63006

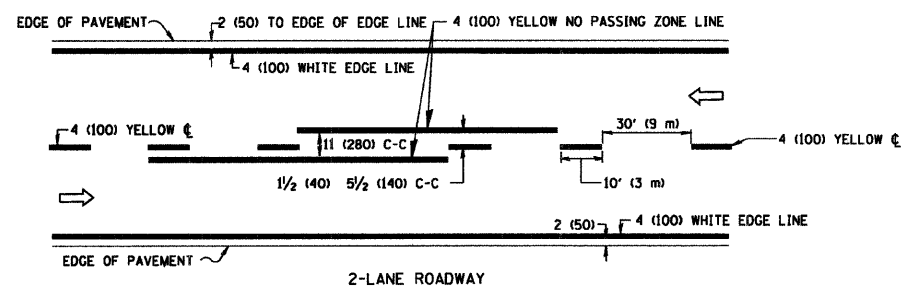

2-LANE ROADWAY

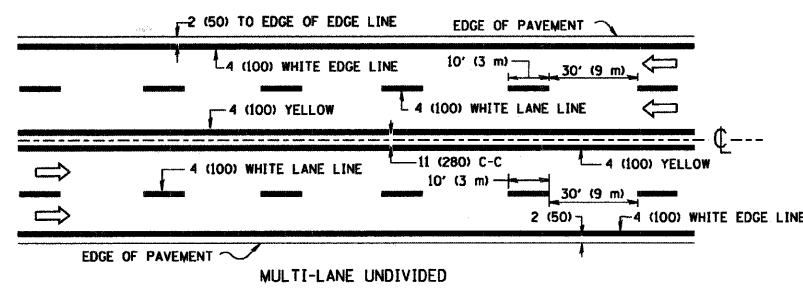

MULTI-LANE UNDIVIDED

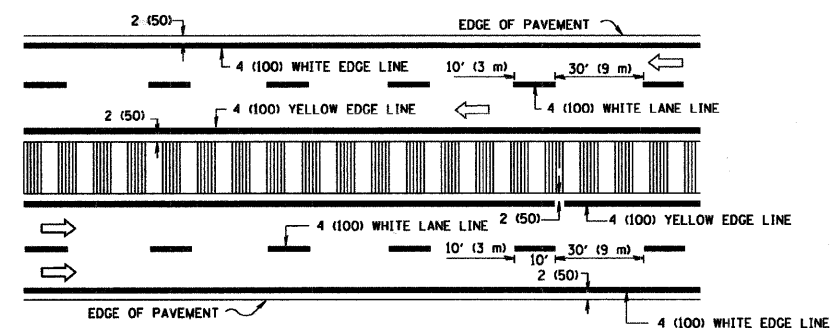

MULTI-LANE DIVIDED WITH MOUNTABLE MEDIAN

NOTE: MEDIANS WITH BARRIER CURB DO NOT REQUIRE AN EDGE LINE

TYPICAL LANE AND EDGE LINE MARKING

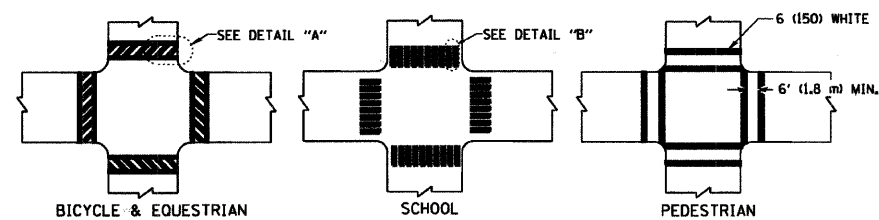

TYPICAL CROSSWALK MARKING

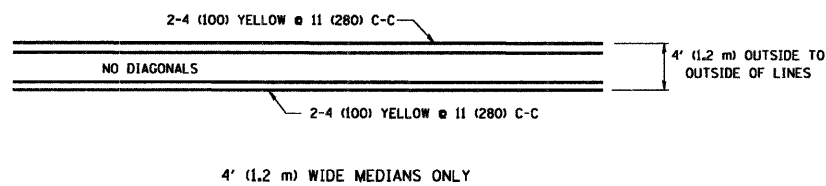

4' (1.2 m) WIDE MEDIANS ONLY

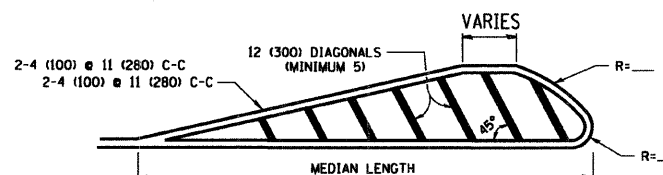

FOR MEDIAN LENGTHS WHERE DIAGONAL SPACING CANNOT BE ATTAINED, USE 5 (FIVE) EQUALLY SPACED DIAGONAL LINES.
 DIAGONAL LINE SPACING: 50' (15 m) C-C (LESS THAN 30MPH (50 km/h))
 75' (25 m) C-C 30MPH (50 km/h) TO 45MPH (70 km/h)
 150' (45 m) C-C (MORE THAN 45MPH (70 km/h))

MEDIANS OVER 4' (1.2 m) WIDE

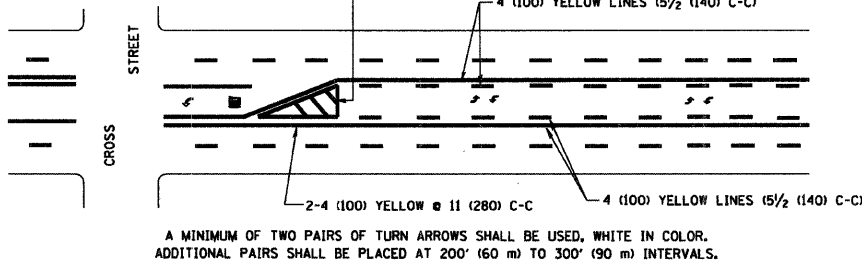

A MINIMUM OF TWO PAIRS OF TURN ARROWS SHALL BE USED, WHITE IN COLOR. ADDITIONAL PAIRS SHALL BE PLACED AT 200' (60 m) TO 300' (90 m) INTERVALS.

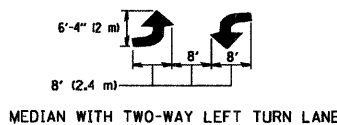

MEDIAN WITH TWO-WAY LEFT TURN LANE

TYPICAL PAINTED MEDIAN MARKING

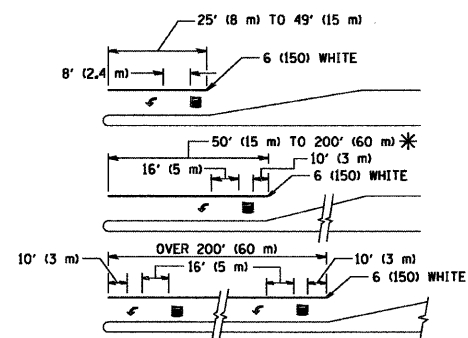

FULL SIZE LETTERS 8' (2.4 m) AND ARROWS SHALL BE USED.
 * TURN LANES IN EXCESS OF 400' (120 m) IN LENGTH MAY HAVE AN ADDITIONAL SET OF ARROW - "ONLY" INSTALLED MIDWAY BETWEEN THE OTHER TWO SETS OF ARROW - "ONLY".

TYPICAL LEFT (OR RIGHT) TURN LANE

TYPICAL TURN LANE MARKING

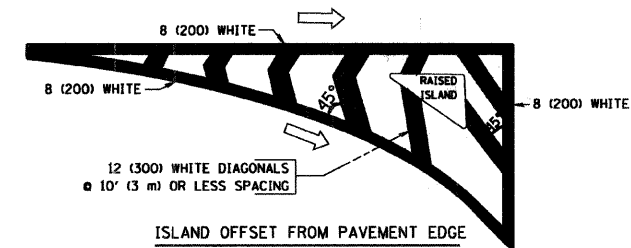

ISLAND OFFSET FROM PAVEMENT EDGE

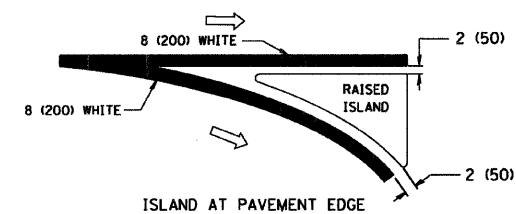

ISLAND AT PAVEMENT EDGE

TYPICAL ISLAND MARKING

TYPE OF MARKING	WIDTH OF LINE	PATTERN	COLOR	SPACING / REMARKS
CENTERLINE ON 2 LANE PAVEMENT	4 (100)	SKIP-DASH	YELLOW	10' (3 m) LINE WITH 30' (9 m) SPACE
CENTERLINE ON MULTI-LANE UNDIVIDED PAVEMENT	2 @ 4 (100)	SOLID	YELLOW	11 (280) C-C
NO PASSING ZONE LINES FOR ONE DIRECTION FOR BOTH DIRECTIONS	4 (100) 2 @ 4 (100)	SOLID SOLID	YELLOW YELLOW	5 1/2 (140) C-C FROM SKIP-DASH CENTERLINE 11 (280) C-C OMIT SKIP-DASH CENTERLINE BETWEEN
LANE LINES	4 (100) 5 (125) ON FREEWAYS	SKIP-DASH SKIP-DASH	WHITE WHITE	10' (3 m) LINE WITH 30' (9 m) SPACE
DOTTED LINES (EXTENSIONS OF CENTER, LANE OR TURN LANE MARKINGS)	SAME AS LINE BEING EXTENDED	SKIP-DASH	SAME AS LINE BEING EXTENDED	2' (600) LINE WITH 6' (1.8 m) SPACE
EDGE LINES	4 (100)	SOLID	YELLOW-LEFT WHITE-RIGHT	OUTLINE MOUNTABLE MEDIANS IN YELLOW; EDGE LINES ARE NOT USED NEXT TO BARRIER CURB
TURN LANE MARKINGS	6 (150) LINE; FULL SIZE LETTERS & SYMBOLS (8' (2.4m))	SOLID	WHITE	SEE TYPICAL TURN LANE MARKING DETAIL
TWO WAY LEFT TURN MARKING	2 @ 4 (100) EACH DIRECTION 8' (2.4m) LEFT ARROW	SKIP-DASH AND SOLID IN PAIRS	YELLOW WHITE	10' (3 m) LINE WITH 30' (9 m) SPACE FOR SKIP-DASH; 5 1/2 (140) C-C BETWEEN SOLID LINE AND SKIP-DASH LINE SEE TYPICAL TWO-WAY LEFT TURN MARKING DETAIL
CROSSWALK LINES (PEDESTRIAN) A. DIAGONALS (BIKE & EQUESTRIAN) B. LONGITUDINAL BARS (SCHOOL)	2 @ 6 (150) 12 (300) @ 45° 12 (300) @ 90°	SOLID SOLID SOLID	WHITE WHITE WHITE	NOT LESS THAN 6' (1.8 m) APART 2' (600) APART 2' (600) APART SEE TYPICAL CROSSWALK MARKING DETAILS.
STOP LINES	24 (600)	SOLID	WHITE	PLACE 4' (1.2 m) IN ADVANCE OF AND PARALLEL TO CROSSWALK, IF PRESENT. OTHERWISE, PLACE AT DESIRED STOPPING POINT, PARALLEL TO CROSSROAD CENTERLINE, WHERE POSSIBLE
PAINTED MEDIANS	2 @ 4 (100) WITH 12 (300) DIAGONALS @ 45° NO DIAGONALS USED FOR 4' (1.2 m) WIDE MEDIANS	SOLID	YELLOW; TWO WAY TRAFFIC WHITE; ONE WAY TRAFFIC	11 (280) C-C FOR THE DOUBLE LINE SEE TYPICAL PAINTED MEDIAN MARKING.
GORE MARKING AND CHANNELIZING LINES	8 (200) WITH 12 (300) DIAGONALS @ 45°	SOLID	WHITE	DIAGONALS: 15' (4.5 m) C-C (LESS THAN 30MPH (50 km/h)) 20' (6 m) C-C 30MPH (50 km/h) TO 45MPH (70 km/h) 30' (9 m) C-C (OVER 45MPH (70 km/h))
RAILROAD CROSSING	24 (600) TRANSVERSE LINES; "RR" IS 6' (1.8 m) LETTERS; 16 (400) LINE FOR "X"	SOLID	WHITE	SEE STATE STANDARD 780001 AREA OF: "R"=3.6 SQ. FT. (0.33 m²) EACH "X"=54.0 SQ. FT. (5.0 m²)
SHOULDER DIAGONALS	12 (300) @ 45°	SOLID	WHITE - RIGHT YELLOW - LEFT	50' (15 m) C-C (LESS THAN 30MPH (50 km/h)) 75' (25 m) C-C (30 MPH (50 km/h) TO 45MPH (70 km/h)) 150' (45 m) C-C (OVER 45MPH (70 km/h))

FOR FURTHER DETAILS ON PAVEMENT MARKING REFER TO STANDARD SPECIFICATIONS FOR ROAD AND BRIDGE CONSTRUCTION AND STATE STANDARD 780001.

All dimensions are in inches (millimeters) unless otherwise shown.

REVISIONS	
NAME	DATE
EVERS	03-19-90
T. RAMMACHER	10-27-94
ALEX HOUSEH	10-09-96
ALEX HOUSEH	10-17-96
T. RAMMACHER	01-06-00

ILLINOIS DEPARTMENT OF TRANSPORTATION
 DISTRICT ONE
 TYPICAL PAVEMENT MARKINGS

SCALE: NONE

DRAWN BY CADD

CHECKED BY

TC-13