

FAU RTE	SECTION	COUNTY	TOTAL SHEETS	SHEET NO.
2803	07-00202-00-RS	COOK	12	5
F. HW. A. REG.	ILLINOIS	PROJECT	M-8003(915)	

CONTRACT NO. 63014

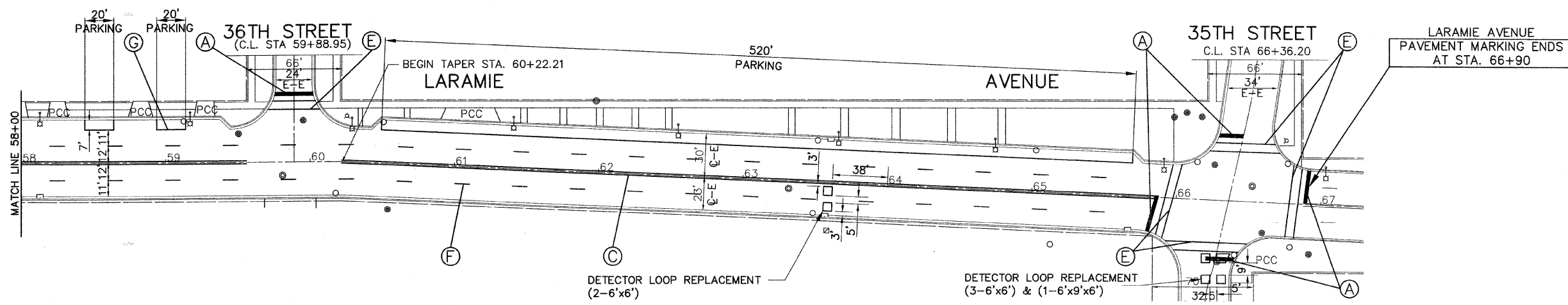
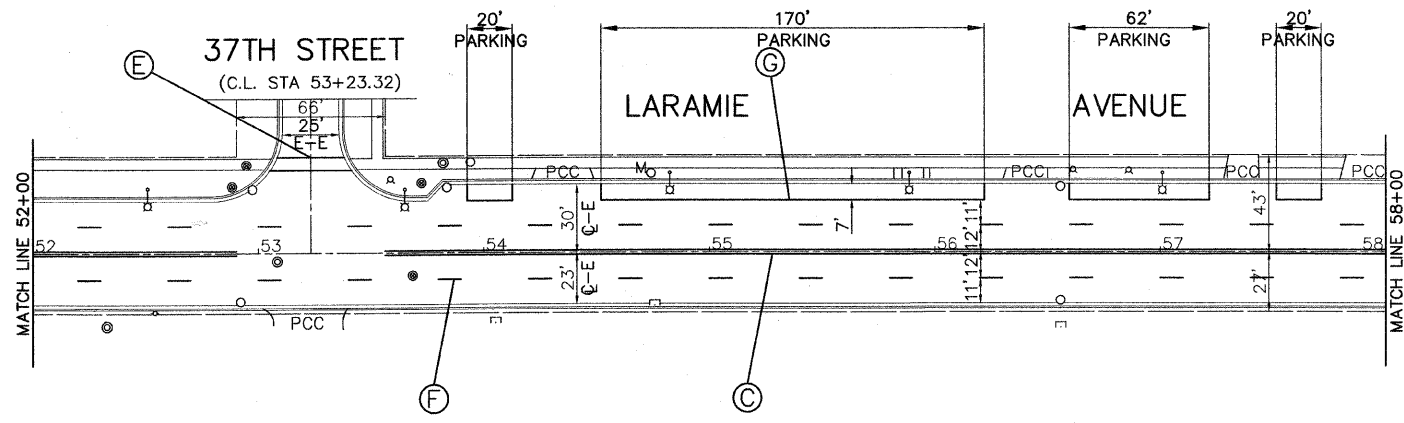
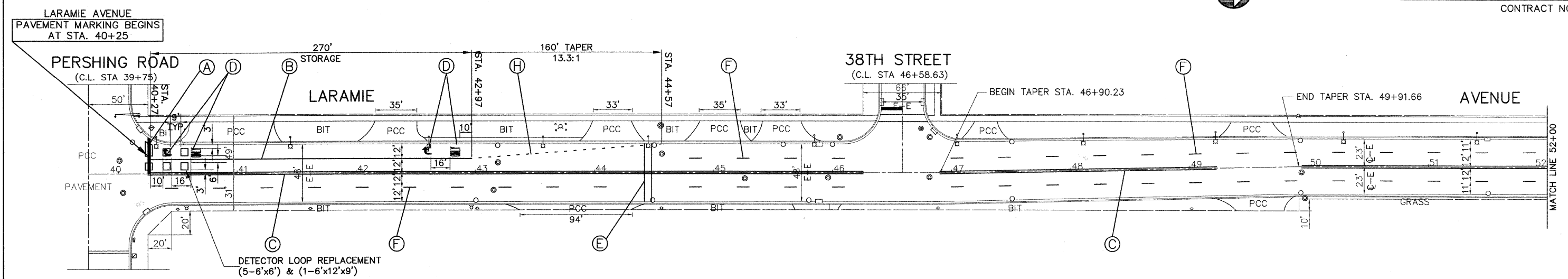

THERMOPLASTIC STRIPING CODE

- (A) SOLID WHITE THERMOPLASTIC PAVEMENT MARKING - LINE 24" (STOP BAR)
- (B) SOLID WHITE THERMOPLASTIC PAVEMENT MARKING - LINE 6" (LANE LINE)
- (C) DOUBLE SOLID YELLOW THERMOPLASTIC PAVEMENT MARKING - CENTERLINE 4" , 11" O/C (CENTERLINE)
- (D) SOLID WHITE THERMOPLASTIC PAVEMENT MARKING - LETTERS & SYMBOLS
- (E) SOLID WHITE THERMOPLASTIC PAVEMENT MARKING - LINE 6" (CROSSWALK MARKING-6' SPACING)
- (F) SOLID YELLOW THERMOPLASTIC PAVEMENT MARKING - LINE 4", 10' DASH, 30' SKIP (LANE LINE)
- (G) SOLID WHITE THERMOPLASTIC PAVEMENT MARKING - LINE 4" (PARKING LINE)
- (H) SOLID WHITE THERMOPLASTIC PAVEMENT MARKING - LINE 6", 2' DASH 6' SKIP

IMPORTANT!
 FULL SIZE PLANS HAVE BEEN PREPARED USING STANDARD ENGINEERING SCALES. REDUCED SIZED PLANS WILL NOT CONFORM TO STANDARD SCALES INDICATED IN TITLE BLOCK.

REVISIONS			
NO.	BY	DATE	DESCRIPTION
1	AMS	1/10/08	DETECTOR LOOP NOTATION ADDED