

Existing structure to be re-moved by contractor - 60' wooden span.

STATE OF ILLINOIS
DEPARTMENT OF PUBLIC WORKS & BUILDINGS
DIVISION OF HIGHWAYS

99-00080-05-BR
Contract 63020
Sheet 48

SHEET NO. 2
2 SHEETS

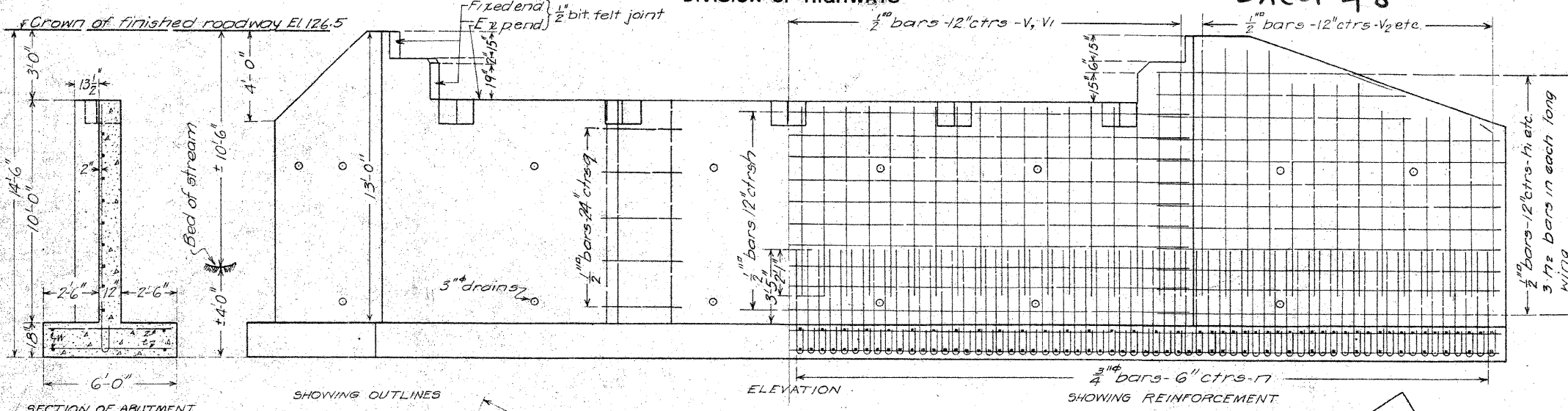

SECTION OF ABUTMENT

SHOWING OUTLINES

ELEVATION

SHOWING REINFORCEMENT

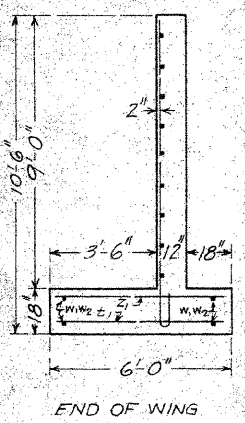

END OF WING

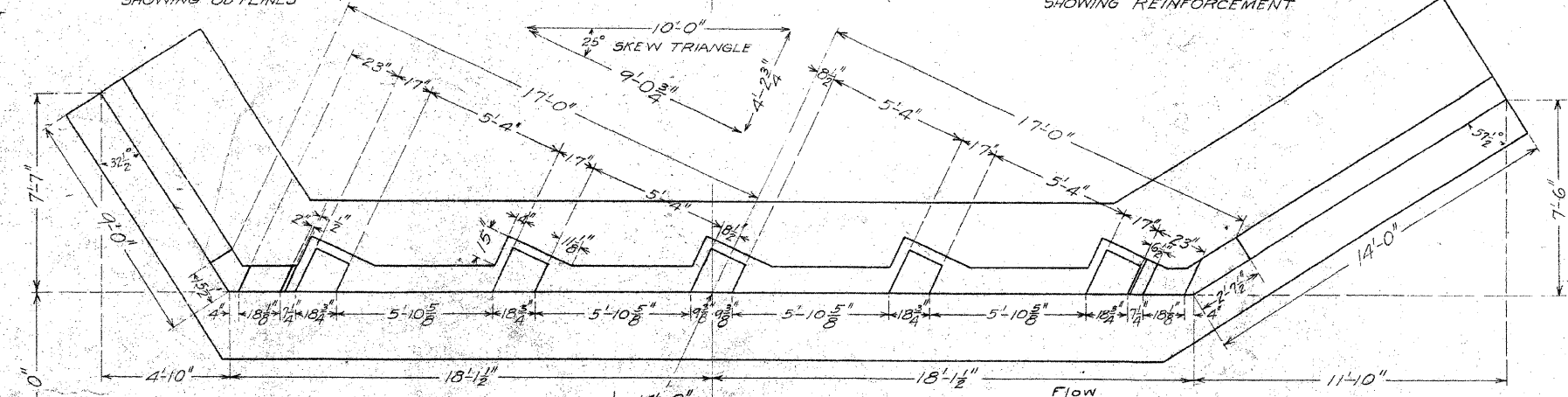

PLAN

BILL OF MATERIAL

Bar	No.	Size	Length
V	64	1/2"	8'-6"
V ₁	6	1/2"	9'-6"
V ₂	14	1/2"	11'-0"
V ₃	12	1/2"	9'-6"
V ₄	20	1/2"	8'-0"
H	232	3/4"	6'-6"
H ₁	40	1/2"	18'-6"
H ₂	18	1/2"	15'-6"
H ₃	24	1/2"	11'-0"
H ₄	6	1/2"	7'-6"
Q	50	1/2"	4'-0"
t	132	1/2"	5'-9"
Z	66	1/2"	5'-9"
t ₁	54	1/2"	5'-9"
Z ₁	96	1/2"	5'-9"
W	16	1/2"	18'-0"
W ₁	8	1/2"	15'-0"
W ₂	8	1/2"	10'-0"

Reinforcing steel Lbs 6590
Concrete cu yds. 91.4

STANDARD	COMPUTED	EXAMINED
	CHECKED	DRAWN
	CHECKED	ASSEMBLED
SPECIAL	CHECKED	

APR 20 1925
BRIDGE ENGINEER
ENGINEER OF DESIGN
CHIEF HIGHWAY ENGINEER

Class A concrete shall be used throughout. Proportions 1:2 1/2:4. All reinforcing steel shall be wired securely in place before concrete is poured.

PLAN NO. 49.16.9-1
APR 16 1925