

F.A.U. RTE.	SECTION	COUNTY	TOTAL SHEETS	SHEET NO.
124B	99-00080-00-BR	LAKE	46	2
STA. 185+96		TO STA. 189+70		
FED. ROAD DIST. NO.	ILLINOIS	FED. AID PROJECT		

63020

INDEX OF SHEETS
NUMBER DESCRIPTION

- 1 TITLE SHEET
- 2 INDEX OF SHEETS
- 3 GENERAL NOTES
- 4 SUMMARY OF QUANTITIES
- 5 TEMPORARY STREAM DIVERSION PLAN AND ELEVATION
- 6 DETOUR PLAN AND SIGNAGE
- 7 BENCH MARK AND ALIGNMENT TIES
- 8 PROPOSED PLAN & PROFILE STA. 185+96 TO STA. 189+70
- 9 EXISTING AND PROPOSED TYPICAL SECTIONS
- 10 EXISTING AND PROPOSED DRAINAGE AND UTILITY PLAN
- 11 SIDEWALK PLAN
- 12 SIDEWALK AND PRIVATE ENTRANCE DETAILS
- 13 GENERAL PLAN & ELEVATION
- 14 GENERAL NOTES & TOTAL BILL OF MATERIAL
- 15 TYPICAL CROSS SECTION
- 16 DRILLED SHAFT CAP LAYOUT
- 17 TOP OF SLAB ELEVATION LOCATIONS
- 18 TOP OF SLAB ELEVATION
- 19 DECK SLAB DETAILS
- 20 TYPICAL CROSS SECTION
- 21 PARAPET PLAN & ELEVATION
- 22 PARAPET PRECAST CONCRETE CAP PLAN & ELEVATION
- 23 ABUTMENT DIAPHRAGM DETAILS
- 24 SUPERSTRUCTURE DETAILS AND BILL OF MATERIAL
- 25 FRAMING PLAN
- 26 BEAM ELEVATION
- 27 BEARING DETAILS
- 28 ANCHOR BOLT DETAILS FOR BEARINGS
- 29 EAST ABUTMENT DRILLED SHAFT CAP PLAN
- 30 EAST ABUTMENT STEM WALL PLAN
- 31 EAST ABUTMENT ELEVATION
- 32 EAST ABUTMENT & WINGWALL DETAILS
- 33 WEST ABUTMENT DRILLED SHAFT CAP PLAN
- 34 WEST ABUTMENT STEM WALL PLAN
- 35 WEST ABUTMENT STEM WALL ELEVATION
- 36 WEST ABUTMENT & WINGWALL DETAILS
- 37 ABUTMENTS & WINGWALLS DRILLED SHAFT DETAILS
- 38 SUBSTRUCTURE BILL OF MATERIAL & DETAILS
- 39 CANTILEVER FORMING BRACKETS
- 40 SOIL BORING LOGS-I
- 41 SOIL BORING LOGS-II
- 42 PLAN BRIDGE APPROACH PAVEMENT (SPECIAL)
- 43 BRIDGE APPROACH PAVEMENT (SPECIAL) SECTIONS & DETAILS
- 44 BRIDGE APPROACH PAVEMENT JOINT SYSTEM-EXPANSION
- 45 EXISTING & PROPOSED CROSS SECTION STA. 185+00 TO STA. 188+50.00
- 46 EXISTING & PROPOSED CROSS SECTION STA. 189+00.00 TO STA. 190+00.00
- * 47 EXISTING BRIDGE PLAN
- * 48 EXISTING BRIDGE PLAN

* REVISED 4-11-08

DATE: 9/2/2008
FILENAME: P:\2006\2301-2400\2006.2324-NAnderson-Old Elm Design\MICROSTATION-FINAL\C-02.dgn

WJE
Wiss, Janney, Elstner Associates, Inc.
Engineers, Architects, Material Scientists
330 Pfingsten Road, Northbrook, IL 60062
(847) 272-7400 Fax: (847) 291-4813
WJE No. 2008.2324

 **THE CITY OF LAKE FOREST**
CHARTERED 1861

ILLINOIS DEPARTMENT OF TRANSPORTATION
BUREAU OF LOCAL ROADS AND STREETS

PROJECT:
OLD ELM ROAD OVER EAST SKOKIE DITCH

TITLE:
INDEX OF SHEETS

SCALE: N.T.S. DRAWN BY: IMG
DATE: JANUARY 2008 CHECKED BY: NSA

△				
△				
△				
△				
△				
△				
REV. NO.	DATE	REVISION RECORD	MADE BY	CHECKED BY

Contract 63020
Sheet 47
99-00080-00-BR

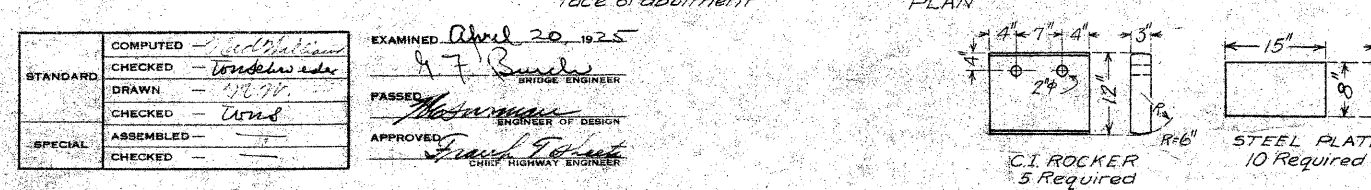
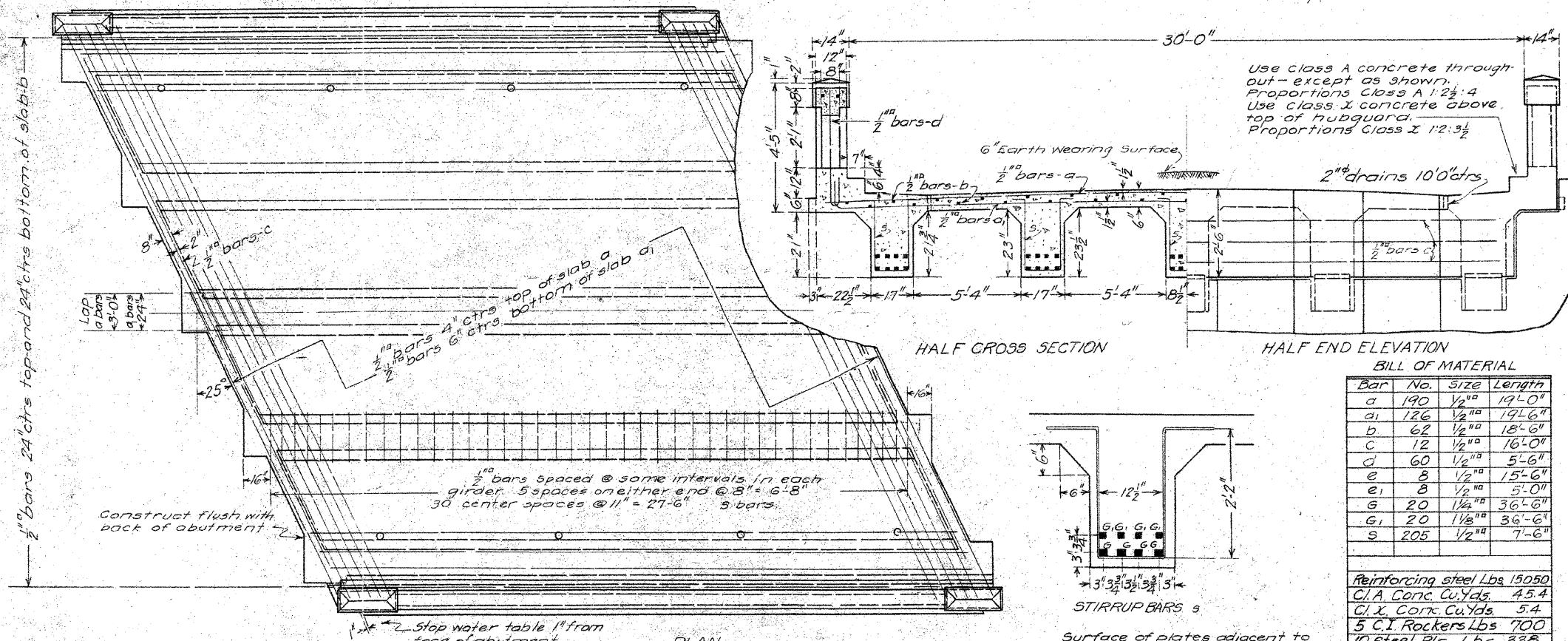
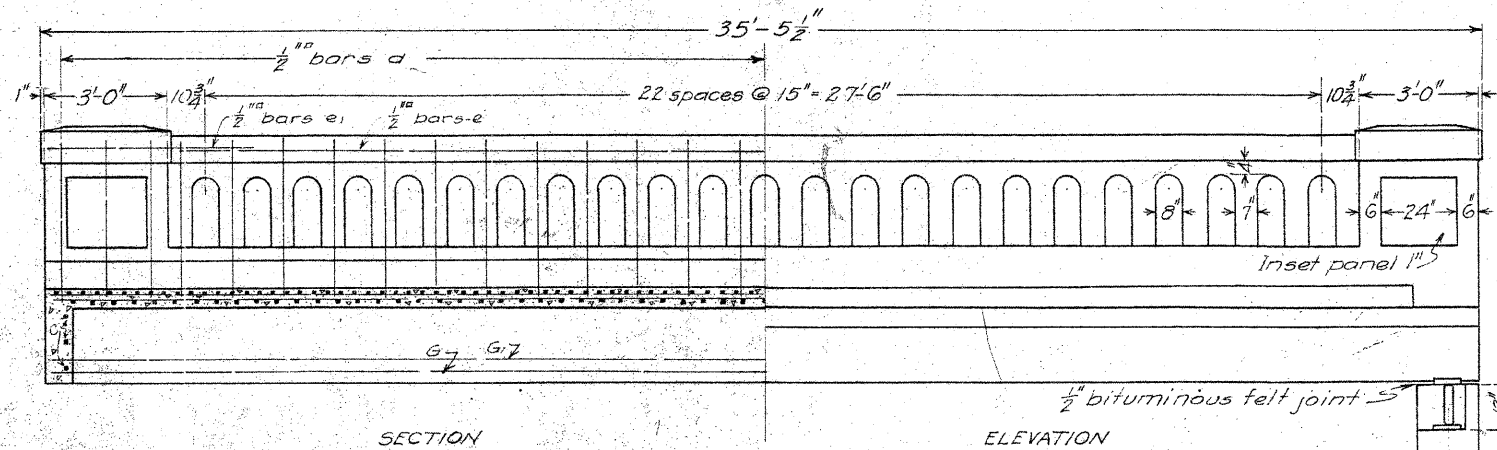

BILL OF MATERIAL

Bar No.	Size	Length
a	1/2"	19'-0"
a1	1/2"	19'-6"
b	1/2"	18'-6"
c	1/2"	16'-0"
d	1/2"	5'-6"
e	1/2"	15'-6"
e1	1/2"	5'-0"
g	1/2"	36'-6"
g1	1 1/8"	36'-6"
s	1/2"	7'-6"

Reinforcing steel Lbs 15050
C.I. Conc. Cu.Yds 45.4
C.I. Conc. Cu.Yds 5.4
5 C.I. Rockers Lbs 700
10 Steel Pls. Lbs 338
Name Plate 1

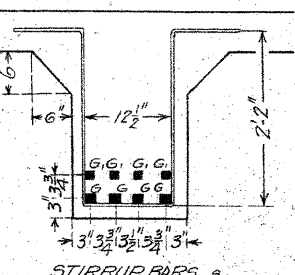

Surface of plates adjacent to rockers to be planed. Rockers and plates shall be painted two coats of sublimed blue lead paint.

PLANS FOR
OLD ELM BRIDGE
WEST DEERFIELD TWP LAKE CO
ILLINOIS

PLAN NO.
49169-1
APR 16
1925

COMPUTED	—	EXAMINED	April 20, 1925
CHECKED	—	97	BRIDGE ENGINEER
DRAWN	—		
CHECKED	—		
SPECIAL	—		
ASSEMBLED	—		
CHECKED	—		

APPROVED: *Frank G. Robert*
CHIEF HIGHWAY ENGINEER

Existing structure to be re-
moved by contractor - 60' wooden span.

STATE OF ILLINOIS
DEPARTMENT OF PUBLIC WORKS & BUILDINGS
DIVISION OF HIGHWAYS

99-00080-05-BR
Contract 63020
Sheet 48

SHEET NO. 2
2 SHEETS

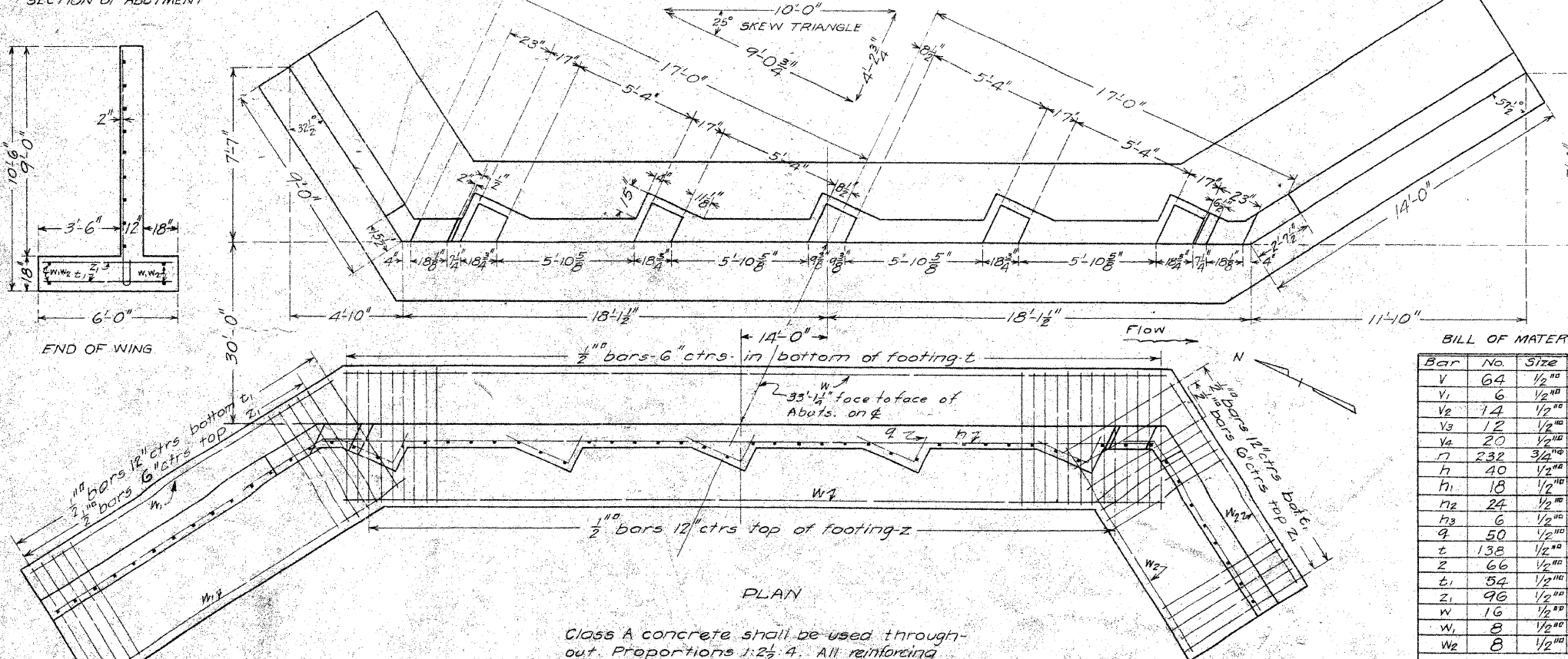
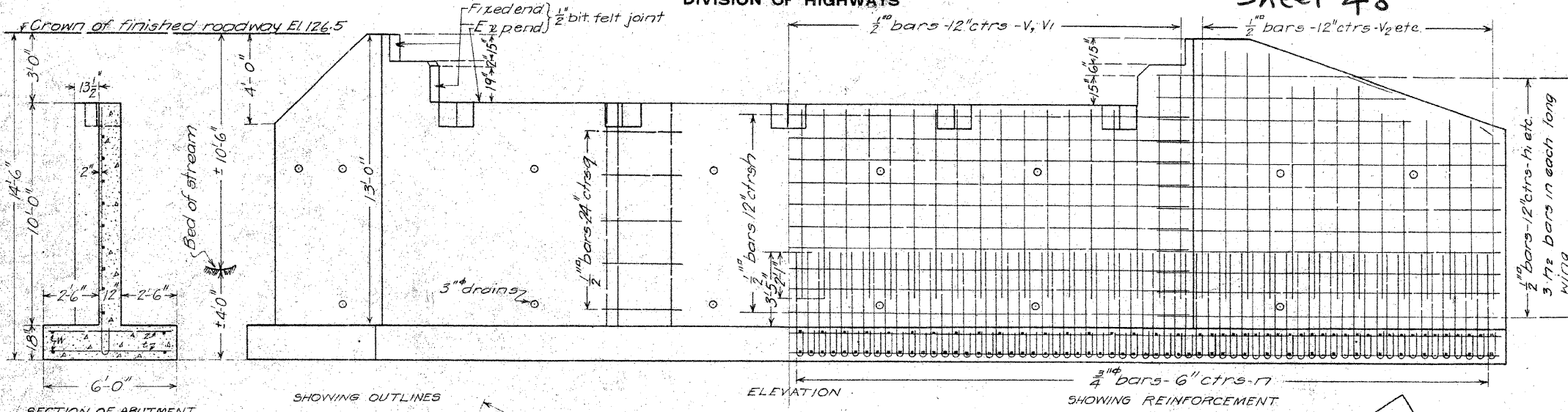

BILL OF MATERIAL

Bar	No.	Size	Length
V	64	1/2"	8'-6"
V1	6	1/2"	9'-6"
V2	14	1/2"	11'-0"
V3	12	1/2"	9'-6"
V4	20	1/2"	8'-0"
t	232	3/4"	6'-6"
H	40	1/2"	18'-6"
H1	18	1/2"	15'-6"
H2	24	1/2"	11'-0"
H3	6	1/2"	7'-6"
q	50	1/2"	4'-0"
t	132	1/2"	5'-9"
z	66	1/2"	5'-9"
t1	54	1/2"	5'-9"
z1	96	1/2"	5'-9"
w	16	1/2"	18'-0"
w1	8	1/2"	15'-0"
w2	8	1/2"	10'-0"

Reinforcing steel Lbs 6590
Concrete cu yds. 91.4

COMPUTED - [Signature]
CHECKED - [Signature]
DRAWN - [Signature]
CHECKED - [Signature]
ASSEMBLED - [Signature]
CHECKED - [Signature]

EXAMINED - April 20 1925
[Signature] BRIDGE ENGINEER

PASSED - [Signature] ENGINEER OF DESIGN

APPROVED - [Signature] CHIEF HIGHWAY ENGINEER

Class A concrete shall be used throughout. Proportions 1:2 1/2:4. All reinforcing steel shall be wired securely in place before concrete is poured.

PLAN NO. 49.16.9-1
APR 16 1925