

F.A.U. RE. 1248	SECTION 99-00080-00-BR	COUNTY LAKE	TOTAL SHEETS 46	SHEET NO. 22
STA.	TO STA.		FED. ROAD DIST. NO. ILLINOIS	
FED. AID PROJECT			63020	
Sheet S-10 of S-29				

Measured along Inside Face of Parapet

Note: All edges shall have 3/4" Chamfer

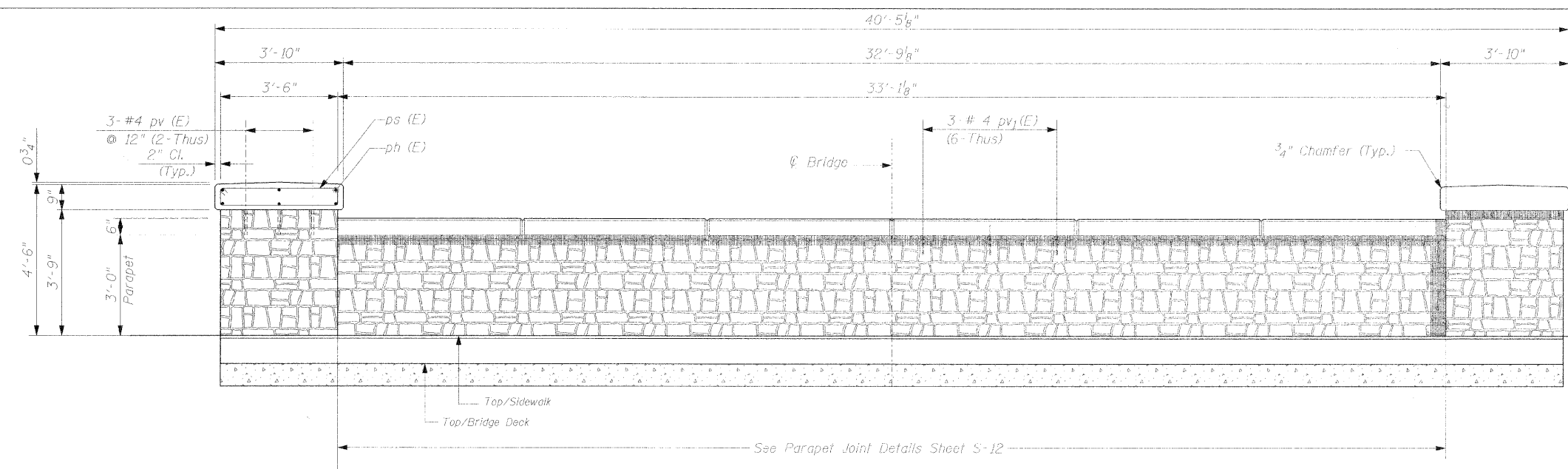

INSIDE FACE OF PARAPET ELEVATION  
(North Parapet Shown South Parapet Similar)

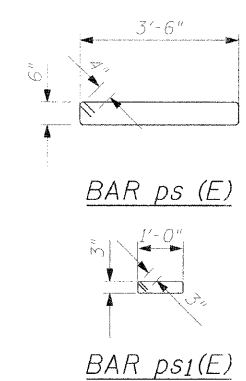

**\*\*PRECAST CONCRETE CAP BILL OF MATERIAL**

Bar	No.	Size	Length	Shape
ps(E)	12	#4	8'-8"	
ps1(E)	36	#4	3'-0"	
ph(E)	12	#5	1'-4"	
ph1(E)	36	#5	5'-2"	
pv(E)	12	#4	1'-3"	
pv1(E)	36	#4	1'-0"	
Precast Concrete Caps Foot				82

Reinforcement bars designated (E) shall be epoxy coated.

\*\* Precast Concrete Cap Reinforcement bars Included in the Cost of Precast Concrete Caps (Per Foot).

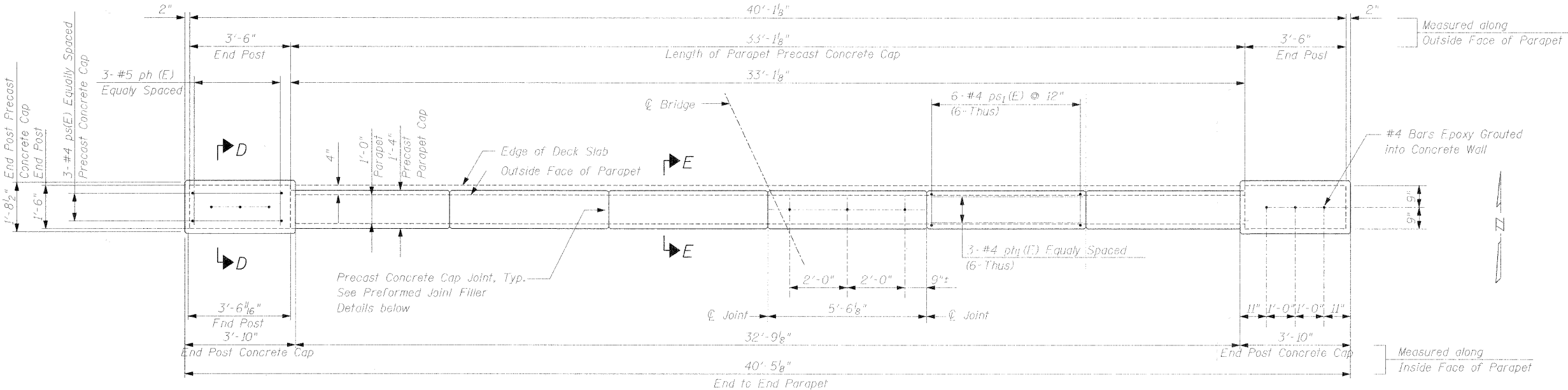

TOP PARAPET PRECAST CONCRETE CAP VIEW  
(Showing Stone Cap Reinforcement)

Notes: Thoroughly clean concrete holes of dust prior to epoxy grouting.

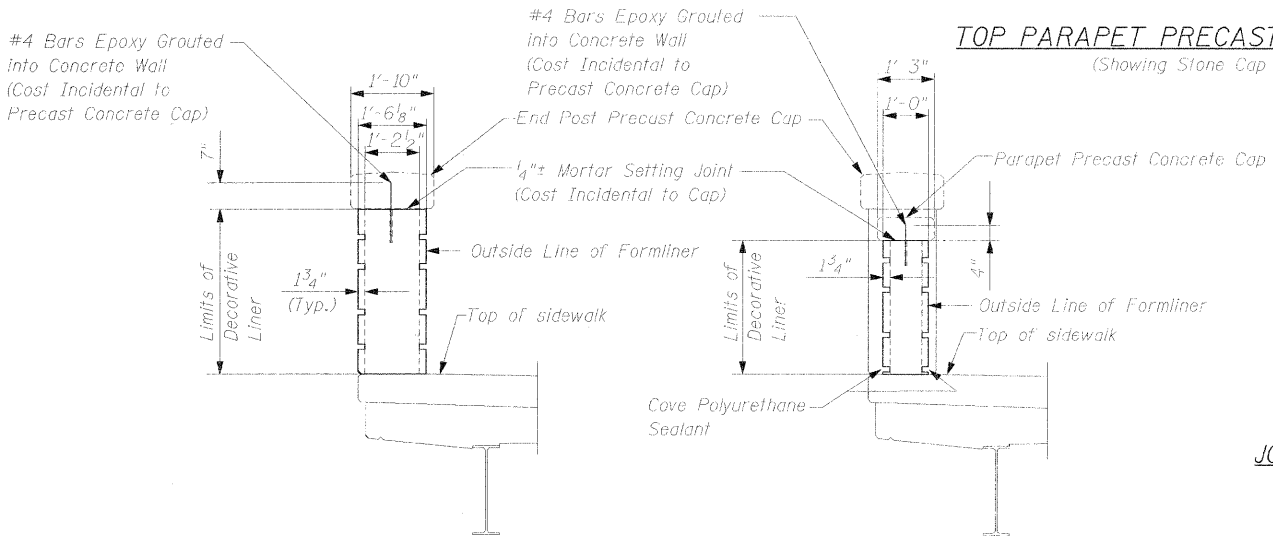

SECTION D-D

SECTION E-E

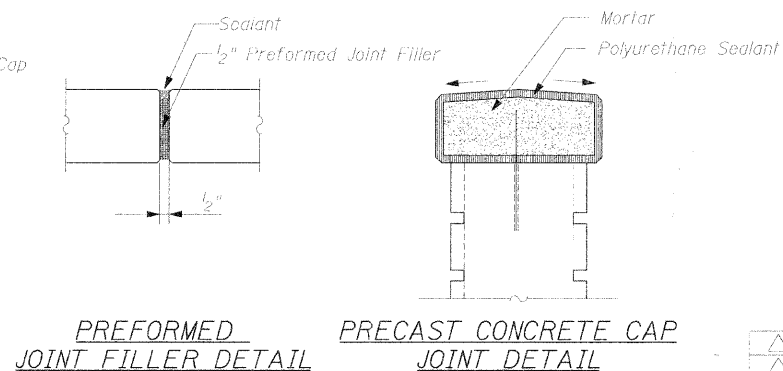

PREFORMED JOINT FILLER DETAIL

PRECAST CONCRETE CAP JOINT DETAIL

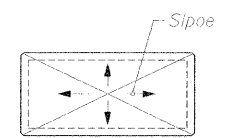

TOP END POST PLAN

REV. NO.	DATE	REVISION RECORD	MADE BY	CHECKED BY

**WJE** Wiss, Janney, Elstner Associates, Inc.  
Engineers, Architects, Material Scientists  
330 Pingsten Road, Northbrook, IL 60062  
(847) 272-7400, Fax: (847) 291-4813  
WJE No. 2006.2324

**THE CITY OF LAKE FOREST**  
CHARTERED 1861

ILLINOIS DEPARTMENT OF TRANSPORTATION  
BUREAU OF LOCAL ROADS AND STREETS

PROJECT: OLD ELM ROAD OVER EAST SKOKIE DITCH  
STA. 187+46 LAKE COUNTY  
STRUCTURE NO. 049-6870

TITLE: PARAPET PRECAST CONCRETE CAP PLAN & ELEVATION

SCALE: N.T.S. DRAWN BY: IMG  
DATE: JANUARY 2008 CHECKED BY: NSA

DATE: 2/22/08  
FILENAME: p:\2006\2301-2400\2006.2324-nanderson-old elm design\microstation-final\9-10.dgn