

F.A.P. RTE.	SECTION	COUNTY	TOTAL SHEETS	SHEET NO.
17	15T-2	CARROLL	71	21
STA.		TO STA.		
FED. ROAD DIST. NO.		ILLINOIS FED. AID PROJECT		

JAMES & LINDA LUDWIG

STA. 1359 + 16.80 6' DIA. CONCRETE PIPE

PLAN	DATE
BY	
CHECKED	
NO. OF WAY CHECKED	
CADD FILE NAME	

PROFILE	DATE
BY	
CHECKED	
NO. OF WAY CHECKED	
STRUCTURE NOTATION CHRD	

PLOT DATE = Mon Jan 28 08:37:12 2008
 FILE NAME = C:\p\proj\sta\2077885\4877885.plt.dgn
 PLOT SCALE = 20.0000 / IN.
 USER NAME = hennicke

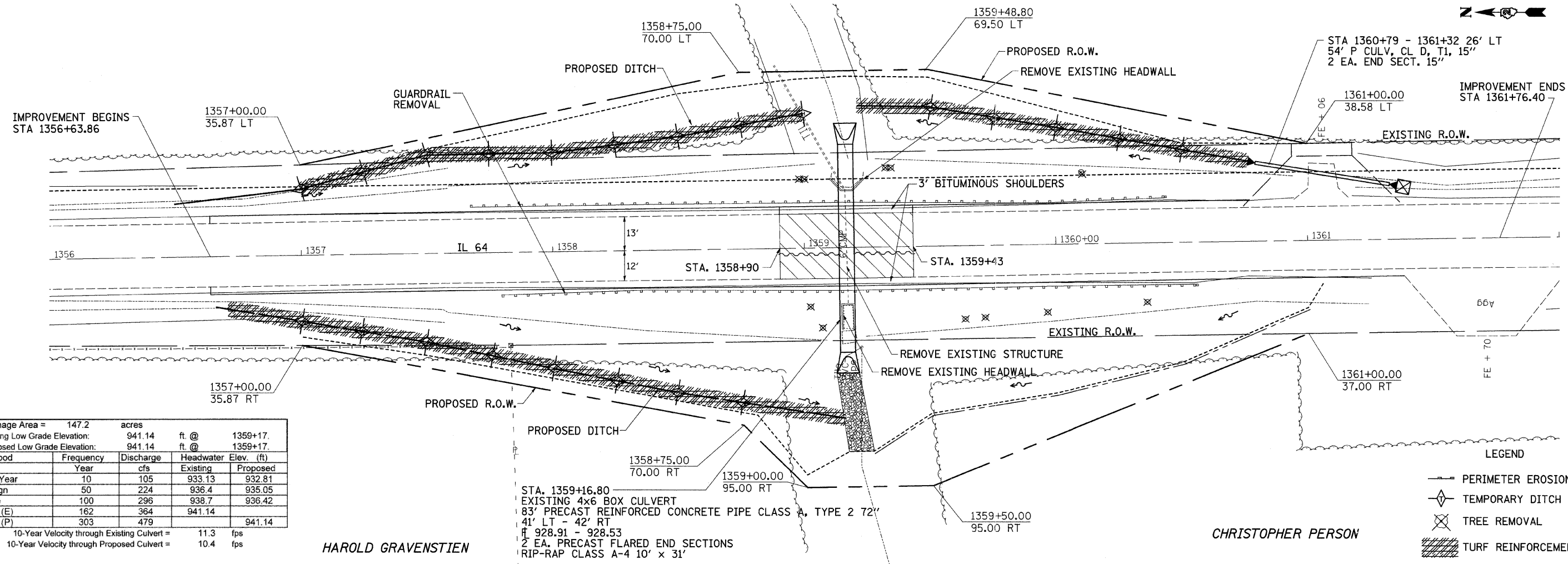

Drainage Area = 147.2 acres				
Existing Low Grade Elevation:		941.14	ft. @	1359+17.
Proposed Low Grade Elevation:		941.14	ft. @	1359+17.
Flood Year	Frequency	Discharge cfs	Headwater Elev. (ft)	
Ten-Year	10	105	933.13	932.81
Design	50	224	936.4	935.05
Base	100	296	938.7	936.42
OVT (E)	162	364	941.14	
OVT (P)	303	479		941.14
10-Year Velocity through Existing Culvert =			11.3	fps
10-Year Velocity through Proposed Culvert =			10.4	fps

STA. 1359+16.80
 EXISTING 4x6 BOX CULVERT
 83' PRECAST REINFORCED CONCRETE PIPE CLASS A, TYPE 2 72"
 41' LT - 42' RT
 ± 928.91 - 928.53
 2 EA. PRECAST FLARED END SECTIONS
 RIP-RAP CLASS A-4 10' x 31'

HAROLD GRAVENSTIEN

CHRISTOPHER PERSON

- LEGEND
- PERIMETER EROSION BARRIER
 - ◇ TEMPORARY DITCH CHECK
 - ⊗ TREE REMOVAL
 - ▨ TURF REINFORCEMENT MAT

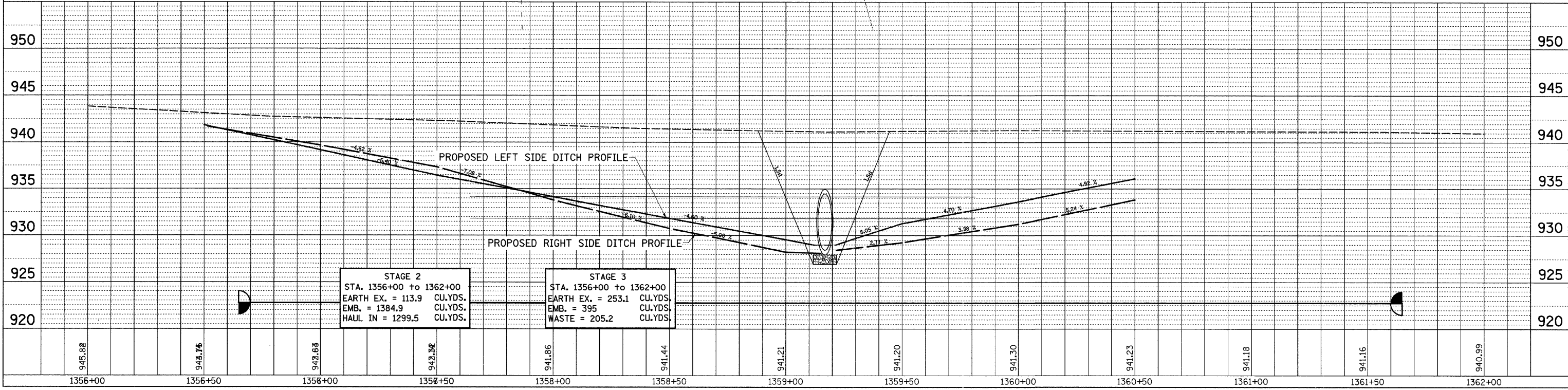

STAGE 2
 STA. 1356+00 to 1362+00
 EARTH EX. = 113.9 CU.YDS.
 EMB. = 1384.9 CU.YDS.
 HAUL IN = 1299.5 CU.YDS.

STAGE 3
 STA. 1356+00 to 1362+00
 EARTH EX. = 253.1 CU.YDS.
 EMB. = 395 CU.YDS.
 WASTE = 205.2 CU.YDS.