

F.A.P. RTE.	SECTION	COUNTY	TOTAL SHEETS	SHEET NO.
17	15T-2	CARROLL	71	27
STA. 1242+50.00		TO STA. 1242+50.00		
FED. ROAD DIST. NO.		ILLINOIS FED. AID PROJECT		

STAGE 2 STA. 1240 + 74

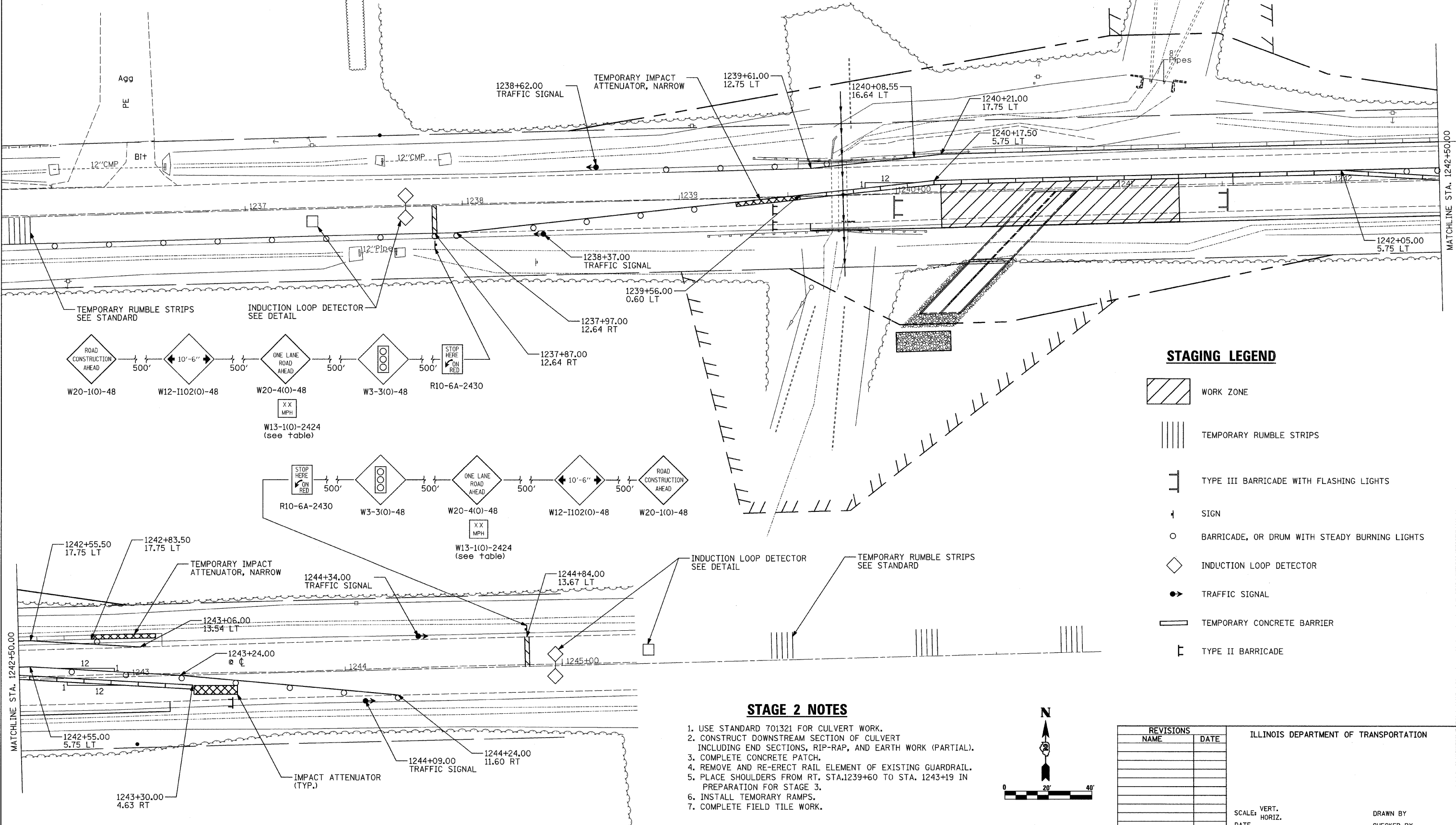

STAGING LEGEND

- WORK ZONE
- TEMPORARY RUMBLE STRIPS
- TYPE III BARRICADE WITH FLASHING LIGHTS
- SIGN
- BARRICADE, OR DRUM WITH STEADY BURNING LIGHTS
- INDUCTION LOOP DETECTOR
- TRAFFIC SIGNAL
- TEMPORARY CONCRETE BARRIER
- TYPE II BARRICADE

STAGE 2 NOTES

1. USE STANDARD 701321 FOR CULVERT WORK.
2. CONSTRUCT DOWNSTREAM SECTION OF CULVERT INCLUDING END SECTIONS, RIP-RAP, AND EARTH WORK (PARTIAL).
3. COMPLETE CONCRETE PATCH.
4. REMOVE AND RE-ERECT RAIL ELEMENT OF EXISTING GUARDRAIL.
5. PLACE SHOULDERS FROM RT. STA. 1239+60 TO STA. 1243+19 IN PREPARATION FOR STAGE 3.
6. INSTALL TEMPORARY RAMPS.
7. COMPLETE FIELD TILE WORK.

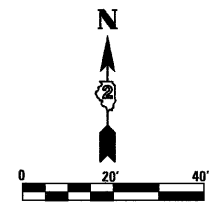

REVISIONS	
NAME	DATE

ILLINOIS DEPARTMENT OF TRANSPORTATION

SCALE: VERT. _____ HORIZ. _____

DATE _____

DRAWN BY _____ CHECKED BY _____

PLOT DATE = Mon, Jan 28, 09:06:18, 2008
 FILE NAME = K:\Projects\Carroll\64C35\11.64\11.73\to_Digital\coline\hansen\proj\set_files\maurer\stutz\final_plans\revised\207886511.dwg
 PLOT SCALE = 20.0000 / IN.
 USER NAME = hansenke