

F.A.P. RTE.	SECTION	COUNTY	TOTAL SHEETS	SHEET NO.
17	15T-2	CARROLL	71	28
STA.		TO STA.		
FED. ROAD DIST. NO.		ILLINOIS FED. AID PROJECT		

# STAGE 3 STA. 1240+74

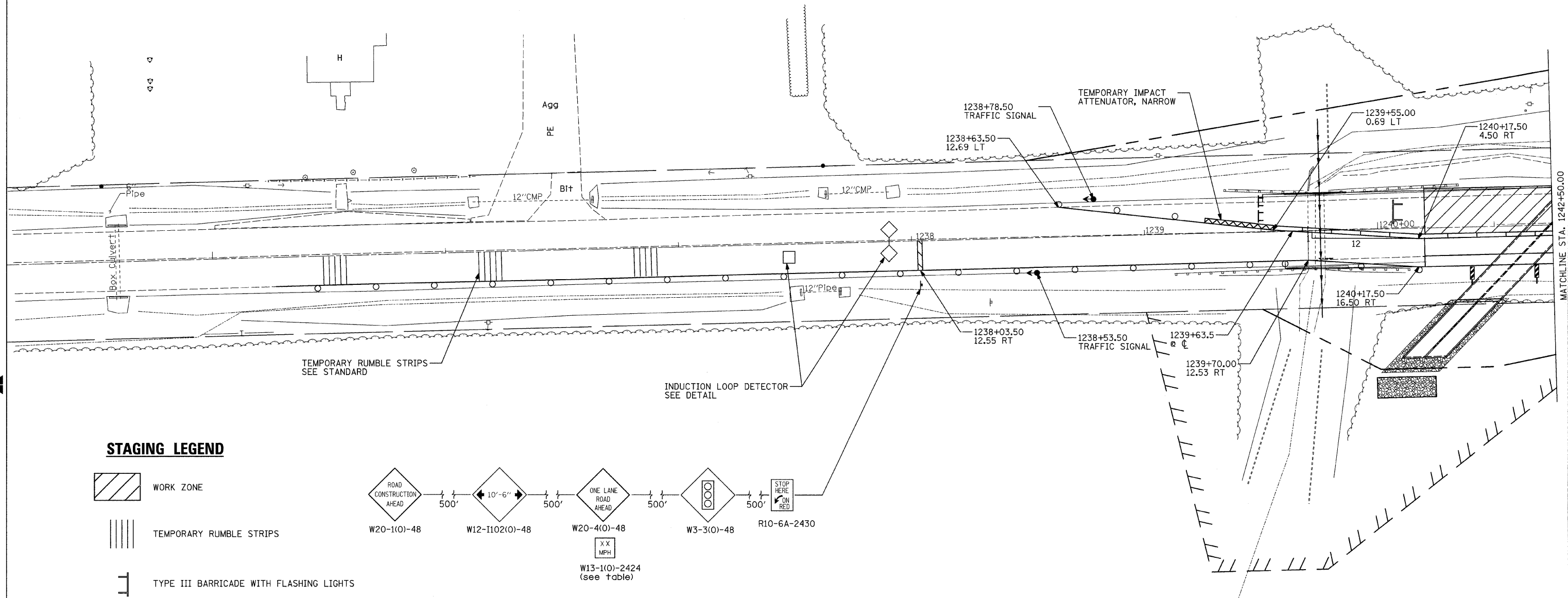

### STAGING LEGEND

- WORK ZONE
- TEMPORARY RUMBLE STRIPS
- TYPE III BARRICADE WITH FLASHING LIGHTS
- SIGN
- BARRICADE, OR DRUM WITH STEADY BURNING LIGHTS
- INDUCTION LOOP DETECTOR
- TRAFFIC SIGNAL
- TEMPORARY CONCRETE BARRIER
- DOUBLE VERTICAL PANELS
- TYPE II BARRICADE

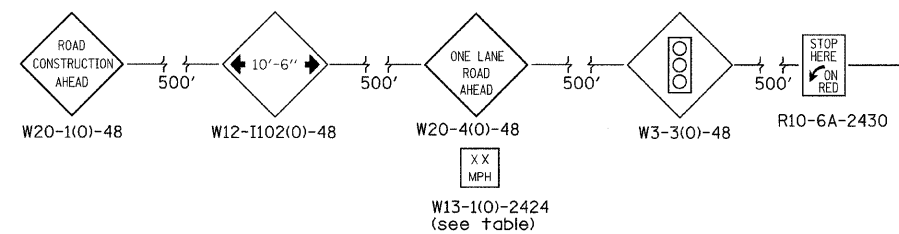

### STAGE 3 NOTES

1. USE STANDARD 701321 FOR CULVERT WORK.
2. CONSTRUCT UPSTREAM SECTIONS OF CULVERT INCLUDING END SECTIONS, RIP RAP, AND EARTH WORK (PARTIAL).
3. COMPLETE CONCRETE PATCH.
4. PLACE HOT-MIX ASPHALT SHOULDER LT STA. 1239+51 TO 1243+16
5. INSTALL TEMPORARY RAMPS.

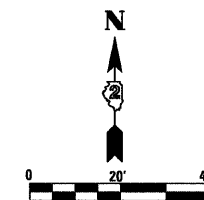

REVISIONS	
NAME	DATE

ILLINOIS DEPARTMENT OF TRANSPORTATION

SCALE: VERT. HORIZ. DATE

DRAWN BY CHECKED BY

PLOT DATE = Mon Jan 28 09:56:11 2008  
 FILE NAME = K:\Projects\64C35\17\15T-2\1715T-2\1715T-2.dwg  
 PLOT SCALE = 28.0000 / IN.  
 USER NAME = hansonke