

STAGE II

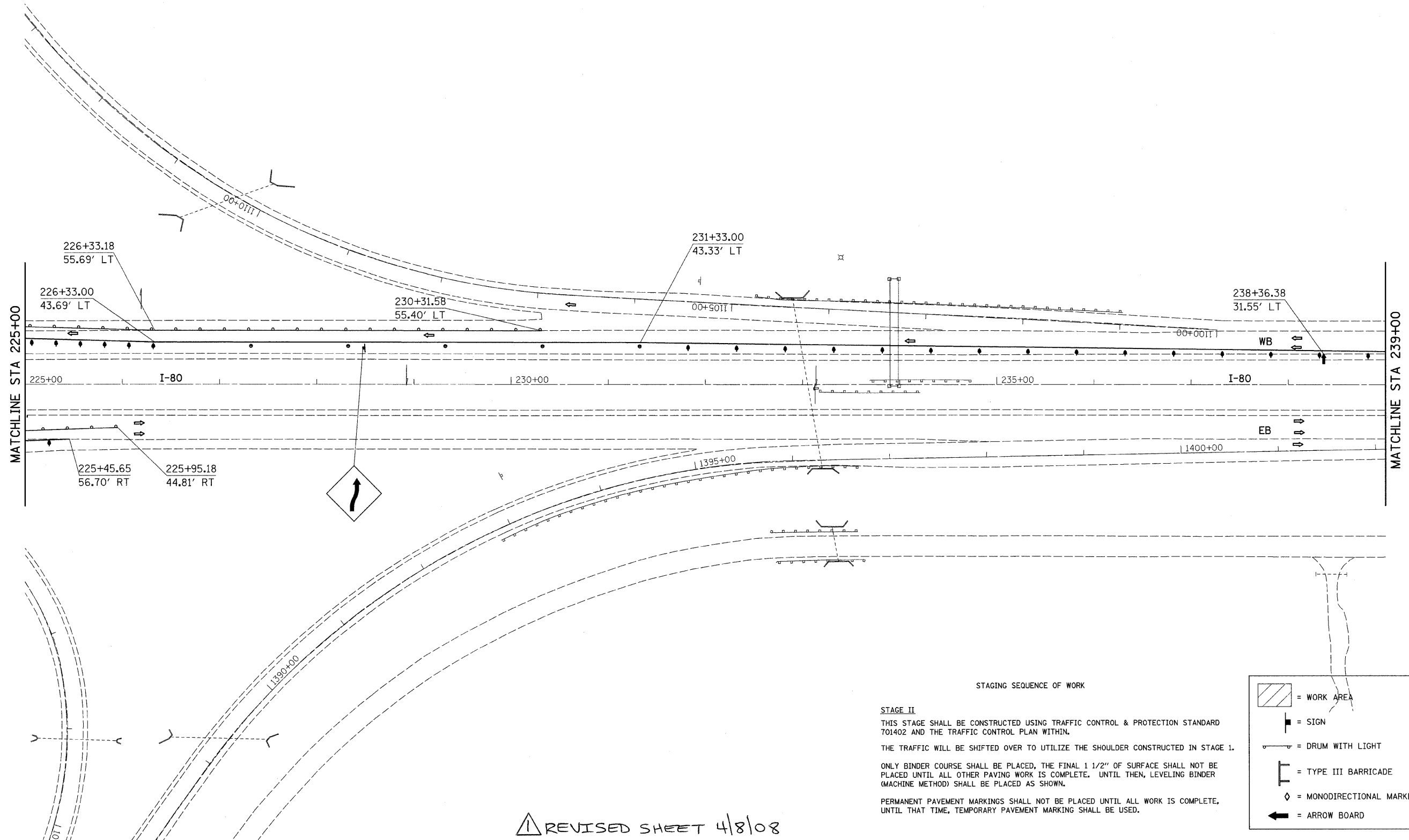
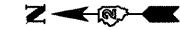

STAGING SEQUENCE OF WORK

STAGE II
 THIS STAGE SHALL BE CONSTRUCTED USING TRAFFIC CONTROL & PROTECTION STANDARD 701402 AND THE TRAFFIC CONTROL PLAN WITHIN.
 THE TRAFFIC WILL BE SHIFTED OVER TO UTILIZE THE SHOULDER CONSTRUCTED IN STAGE 1.
 ONLY BINDER COURSE SHALL BE PLACED, THE FINAL 1 1/2" OF SURFACE SHALL NOT BE PLACED UNTIL ALL OTHER PAVING WORK IS COMPLETE. UNTIL THEN, LEVELING BINDER (MACHINE METHOD) SHALL BE PLACED AS SHOWN.
 PERMANENT PAVEMENT MARKINGS SHALL NOT BE PLACED UNTIL ALL WORK IS COMPLETE, UNTIL THAT TIME, TEMPORARY PAVEMENT MARKING SHALL BE USED.

	= WORK AREA
	= SIGN
	= DRUM WITH LIGHT
	= TYPE III BARRICADE
	= MONODIRECTIONAL MARKER
	= ARROW BOARD

⚠ REVISIED SHEET 4/8/08

FILE NAME = C:\Projects\p200487\vd88487.stg.dgn	USER NAME = Jordanhd	DESIGNED -	REVISIED -	STATE OF ILLINOIS DEPARTMENT OF TRANSPORTATION	I-80 STAGE II			F.A.I. RTE. 80	SECTION 81-IHBY-D	COUNTY ROCK ISLAND	TOTAL SHEETS 120	SHEET NO. 63
	PLOT SCALE = 50.0000' / IN.	DRAWN -	REVISIED -		SCALE:	SHEET NO.	OF SHEETS	STA.	TO STA.	CONTRACT NO. 64C74		
	PLOT DATE = Tue Apr 01 13:46:57 2008	CHECKED -	REVISIED -									
		DATE -	REVISIED -									