

# STAGE III

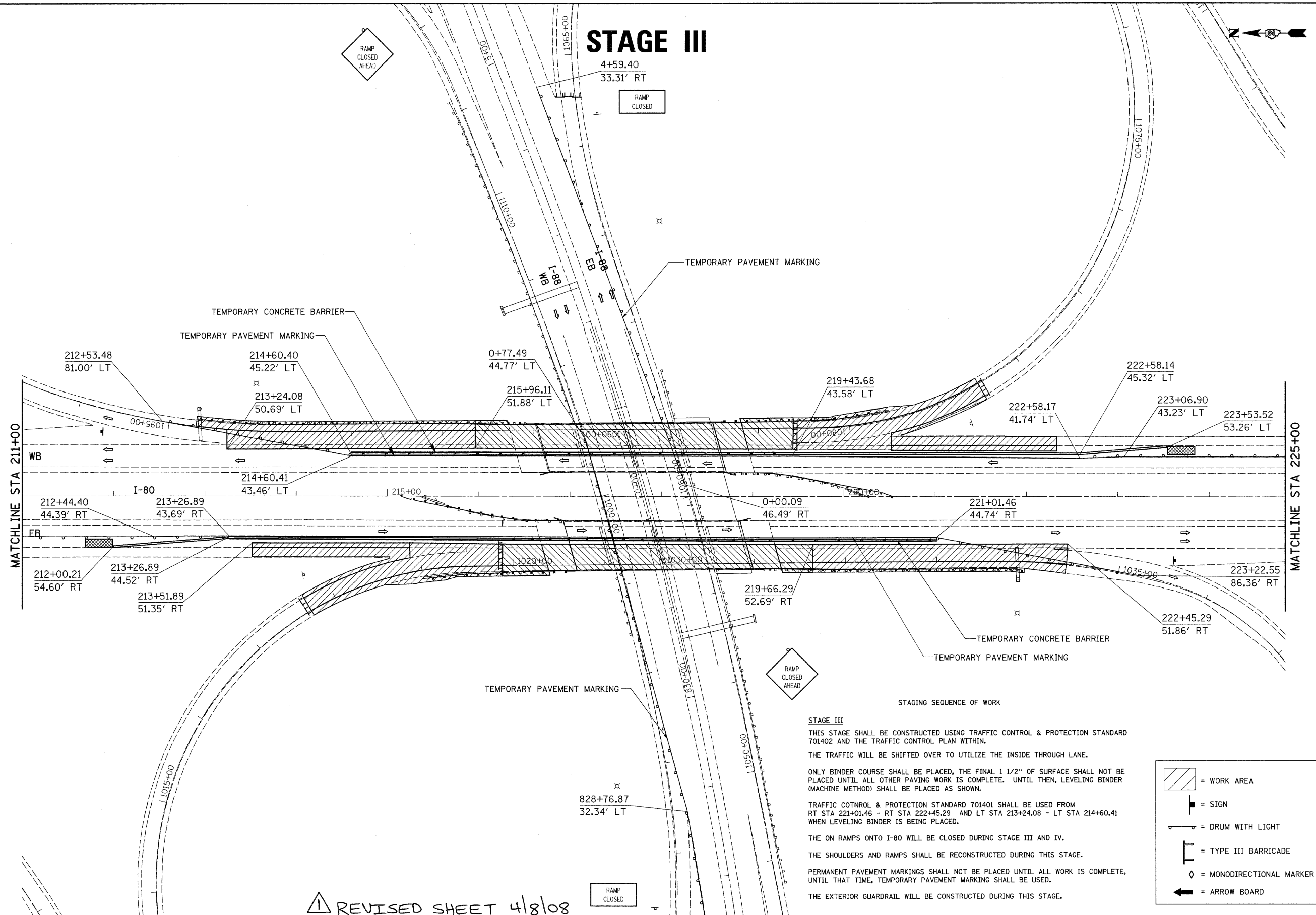

**STAGING SEQUENCE OF WORK**

**STAGE III**  
 THIS STAGE SHALL BE CONSTRUCTED USING TRAFFIC CONTROL & PROTECTION STANDARD 701402 AND THE TRAFFIC CONTROL PLAN WITHIN.  
 THE TRAFFIC WILL BE SHIFTED OVER TO UTILIZE THE INSIDE THROUGH LANE.  
 ONLY BINDER COURSE SHALL BE PLACED, THE FINAL 1 1/2" OF SURFACE SHALL NOT BE PLACED UNTIL ALL OTHER PAVING WORK IS COMPLETE. UNTIL THEN, LEVELING BINDER (MACHINE METHOD) SHALL BE PLACED AS SHOWN.  
 TRAFFIC CONTROL & PROTECTION STANDARD 701401 SHALL BE USED FROM RT STA 221+01.46 - RT STA 222+45.29 AND LT STA 213+24.08 - LT STA 214+60.41 WHEN LEVELING BINDER IS BEING PLACED.  
 THE ON RAMP ONTO I-80 WILL BE CLOSED DURING STAGE III AND IV.  
 THE SHOULDERS AND RAMP SHALL BE RECONSTRUCTED DURING THIS STAGE.  
 PERMANENT PAVEMENT MARKINGS SHALL NOT BE PLACED UNTIL ALL WORK IS COMPLETE, UNTIL THAT TIME, TEMPORARY PAVEMENT MARKING SHALL BE USED.  
 THE EXTERIOR GUARDRAIL WILL BE CONSTRUCTED DURING THIS STAGE.

- = WORK AREA
- = SIGN
- = DRUM WITH LIGHT
- = TYPE III BARRICADE
- = MONODIRECTIONAL MARKER
- = ARROW BOARD

⚠️ REVISED SHEET 4/8/08

FILE NAME = C:\Projects\p200407\d00407stg.dgn	USER NAME = jordanhd	DESIGNED -	REVISED -	<b>STATE OF ILLINOIS DEPARTMENT OF TRANSPORTATION</b>	<b>I-80 STAGE III</b>			F.A.I. RTE. 80	SECTION 81-IHBY-D	COUNTY ROCK ISLAND	TOTAL SHEETS 120	SHEET NO. 66
	PLOT SCALE = 50.0000' / IN.	DRAWN -	REVISED -		SCALE:	SHEET NO.	OF	SHEETS	STA.	TO STA.	FED. ROAD DIST. NO.	ILLINOIS FED. AID PROJECT
	PLOT DATE = Tue Apr 01 13:46:57 2008	CHECKED -	REVISED -									CONTRACT NO. 64C74
		DATE -	REVISED -									