

STATE OF ILLINOIS
DEPARTMENT OF TRANSPORTATION

Sheet S13 of S25

F.A.I. RTE.	SECTION	COUNTY	TOTAL SHEETS	SHEET NO.
80	81-IHBY-D	ROCK ISLAND	120	42
FED. ROAD DIST. NO. 2 ILLINOIS			FED. AID PROJECT	

Contract # 64C74

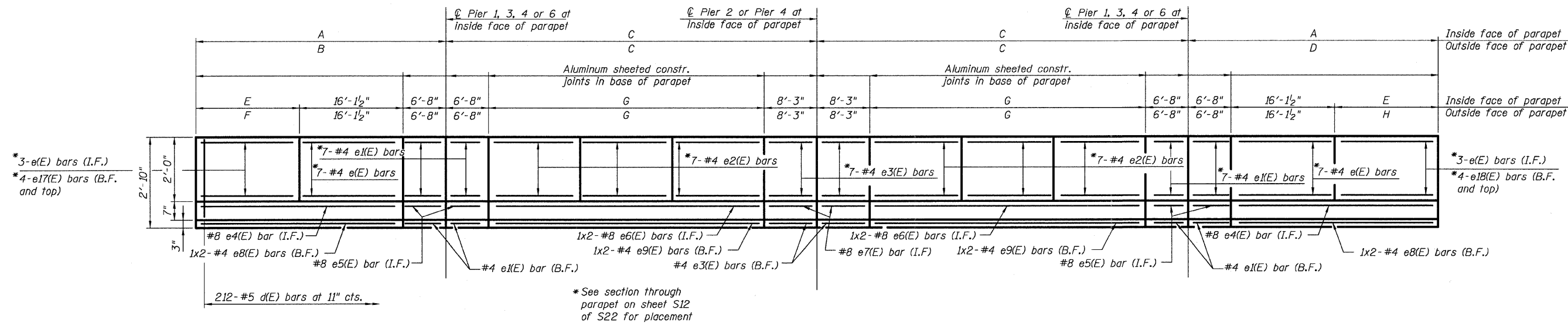

PARAPET ELEVATION

(Looking at inside face. I.F. = inside face. B.F. = back face)

MINIMUM BAR LAP

(Parapet)
#4 bar = 1'-4"
#8 bar = 3'-5"

TABLE OF PARAPET DIMENSIONS

Parapet	A	B	C	D	E	F	G	H
Westbound, East Side	38'-10 ¹ / ₄ "	39'-3 ³ / ₈ "	57'-10"	38'-5 ⁵ / ₈ "	16'-0 ³ / ₄ "	16'-5 ¹ / ₈ "	3 spaces @ 14'-3 ⁵ / ₈ " = 42" - 11"	15'-7 ⁵ / ₈ "
Westbound, West Side	38'-11 ⁵ / ₈ "	39'-5"	58'-0"	38'-6 ¹ / ₄ "	16'-2 ¹ / ₈ "	16'-7 ¹ / ₂ "	3 spaces @ 14'-4 ³ / ₈ " = 43" - 1"	15'-8 ³ / ₄ "
Eastbound, East Side	38'-11 ⁵ / ₈ "	39'-5"	58'-0"	38'-6 ¹ / ₄ "	16'-2 ¹ / ₈ "	16'-7 ¹ / ₂ "	3 spaces @ 14'-4 ³ / ₈ " = 43" - 1"	15'-8 ³ / ₄ "
Eastbound, West Side	38'-10 ¹ / ₄ "	39'-3 ³ / ₈ "	57'-10"	38'-5 ⁵ / ₈ "	16'-0 ³ / ₄ "	16'-5 ¹ / ₈ "	3 spaces @ 14'-3 ⁵ / ₈ " = 42" - 11"	15'-7 ⁵ / ₈ "

PLACES
NOTES
\$FILES
\$TIMES

PATRICK
ENGINEERING INC.
LISLE, ILLINOIS

ILLINOIS DEPARTMENT OF TRANSPORTATION
SUPERSTRUCTURE DETAILS II
PARAPET ELEVATION
INTERSTATE 80 OVER INTERSTATE 88
F.A.I. ROUTE 80 - SECTION 81-IHBY-D
ROCK ISLAND COUNTY
STATION 217+81.50
EB S.N. 081-0012 & WB 081-0013
DRAWN BY: A. Durbak
CHECKED BY: R. Koye
DATE: FEBRUARY 27, 2008