

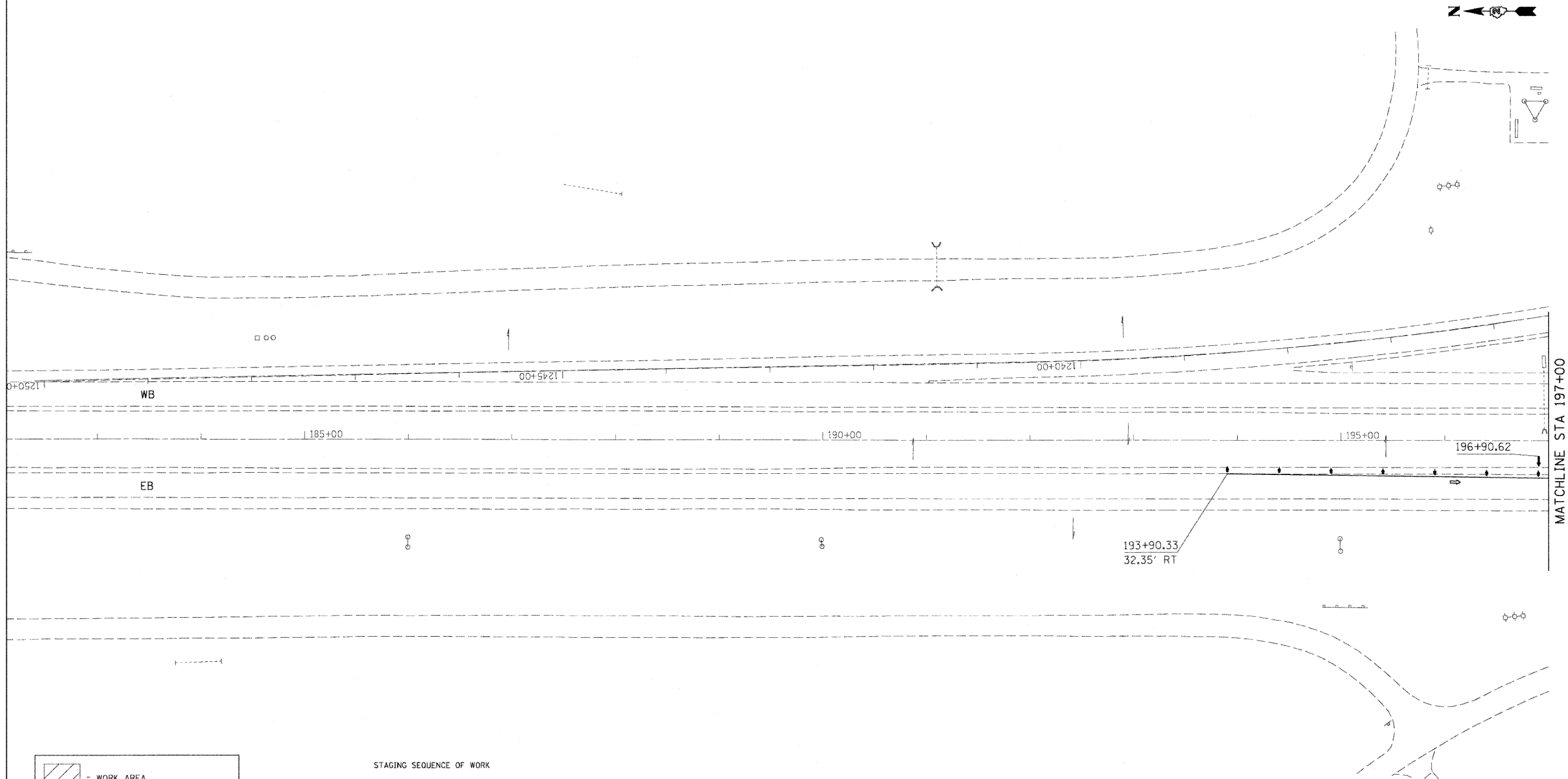





# STAGE II



-  = WORK AREA
-  = SIGN
-  = DRUM WITH LIGHT
-  = TYPE III BARRICADE
-  = MONODIRECTIONAL MARKER
-  = ARROW BOARD

### STAGING SEQUENCE OF WORK

#### STAGE II

THIS STAGE SHALL BE CONSTRUCTED USING TRAFFIC CONTROL & PROTECTION STANDARD 701402 AND THE TRAFFIC CONTROL PLAN WITHIN.

THE TRAFFIC WILL BE SHIFTED OVER TO UTILIZE THE SHOULDER CONSTRUCTED IN STAGE I.

ONLY BINDER COURSE SHALL BE PLACED, THE FINAL 1 1/2" OF SURFACE SHALL NOT BE PLACED UNTIL ALL OTHER PAVING WORK IS COMPLETE. UNTIL THEN, LEVELING BINDER (MACHINE METHOD) SHALL BE PLACED AS SHOWN.

PERMANENT PAVEMENT MARKINGS SHALL NOT BE PLACED UNTIL ALL WORK IS COMPLETE. UNTIL THAT TIME, TEMPORARY PAVEMENT MARKING SHALL BE USED.

FILE NAME =  
C:\P\objects\p208407\d08407.stg.dgn

USER NAME = jordanhd  
PLOT SCALE = 50.0000' / 1" IN.  
PLOT DATE = Thu Feb 28 13:31:11 2008

DESIGNED -	---	REVISED -	---
DRAWN -	---	REVISED -	---
CHECKED -	---	REVISED -	---
DATE -	---	REVISED -	---

**STATE OF ILLINOIS  
DEPARTMENT OF TRANSPORTATION**

**I-80 STAGE II**

SCALE: \_\_\_\_\_ SHEET NO. \_\_\_\_ OF \_\_\_\_ SHEETS STA. \_\_\_\_\_ TO STA. \_\_\_\_\_

F.A.I. RTE.	SECTION	COUNTY	TOTAL SHEETS	SHEET NO.
80	81-JHBY-D	ROCK ISLAND	120	60
CONTRACT NO. 64C74			FED. ROAD DIST. NO. [ILLINOIS] FED. AID PROJECT	