

F.A.P. RTE.	SECTION	COUNTY	TOTAL SHEETS	SHEET NO.
316	102T	LEE	41	8
STA.		TO STA.		
FED. ROAD DIST. NO.		ILLINOIS	FED. AID PROJECT	

STAGING TYPICAL SECTIONS

1. EXTEND BOX CULVERT 13' TO THE LEFT WITH 2 PIPE CULVERTS, CLASS D TYPE 1 24" TEMPORARY AND 2 24" METAL END SECTIONS.
2. DO SHOULDER WORK SO TRAFFIC CAN RUN ON SHOULDER AND DIRT WORK FOR THE WATER TO DRAIN THROUGH THE TEMPORARY CULVERT EXTENSION.
3. THEN MOVE TO THE RIGHT SIDE AND GET ALL OF STAGE 1 DONE.
4. THEN MOVE TO LEFT SIDE AND DO STAGE 2.
5. CONTRACTOR WILL NOT GET PAID FOR ANY DIRT HAULED TO THE JOB.

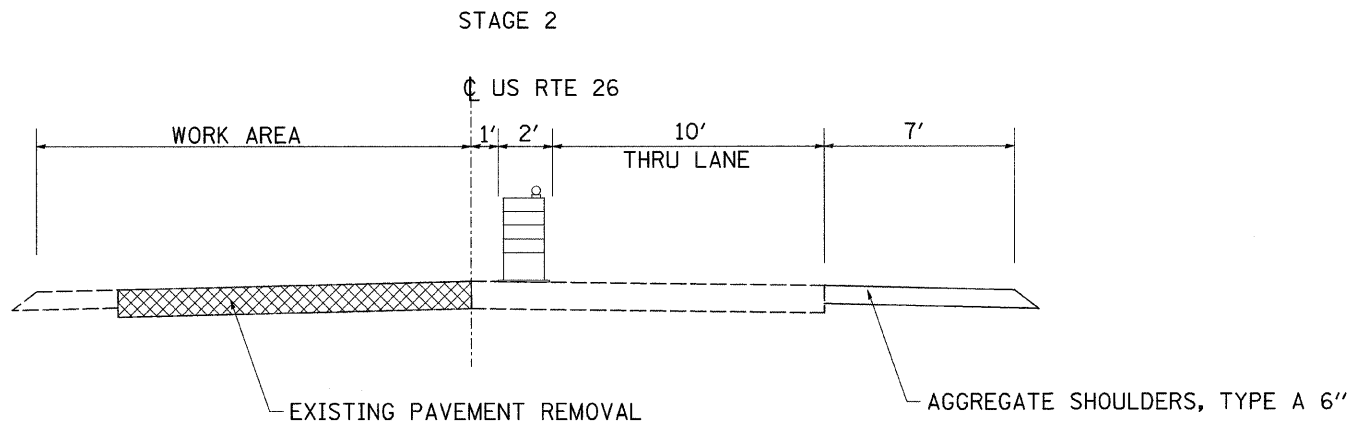
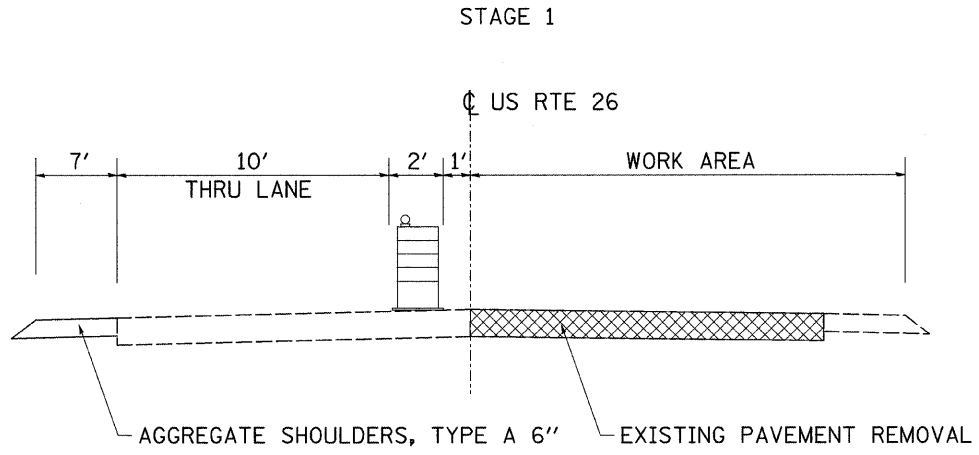

REVISIONS	
NAME	DATE

ILLINOIS DEPARTMENT OF TRANSPORTATION

SCALE: VERT. _____
 HORIZ. _____

DATE _____

DRAWN BY _____
 CHECKED BY _____

PLOT DATE = Thu, Jan 24 15:25:45 2008
 FILE NAME = C:\p\projects\6266637\6266637.dgn
 PLOT SCALE = 50.0000' / 1" = hmsnke