

STATE OF ILLINOIS
DEPARTMENT OF TRANSPORTATION

ROUTE NO.	SECTION	COUNTY	TOTAL SHEETS	SHEET NO.	SHEET NO. 6
F.A.P. 17	-	CARROLL	27	20	6 SHEETS
FED. ROAD DIST. NO. 7	ILLINOIS	FED. AID PROJECT			

PLAN BEAM 1 - SPAN 1

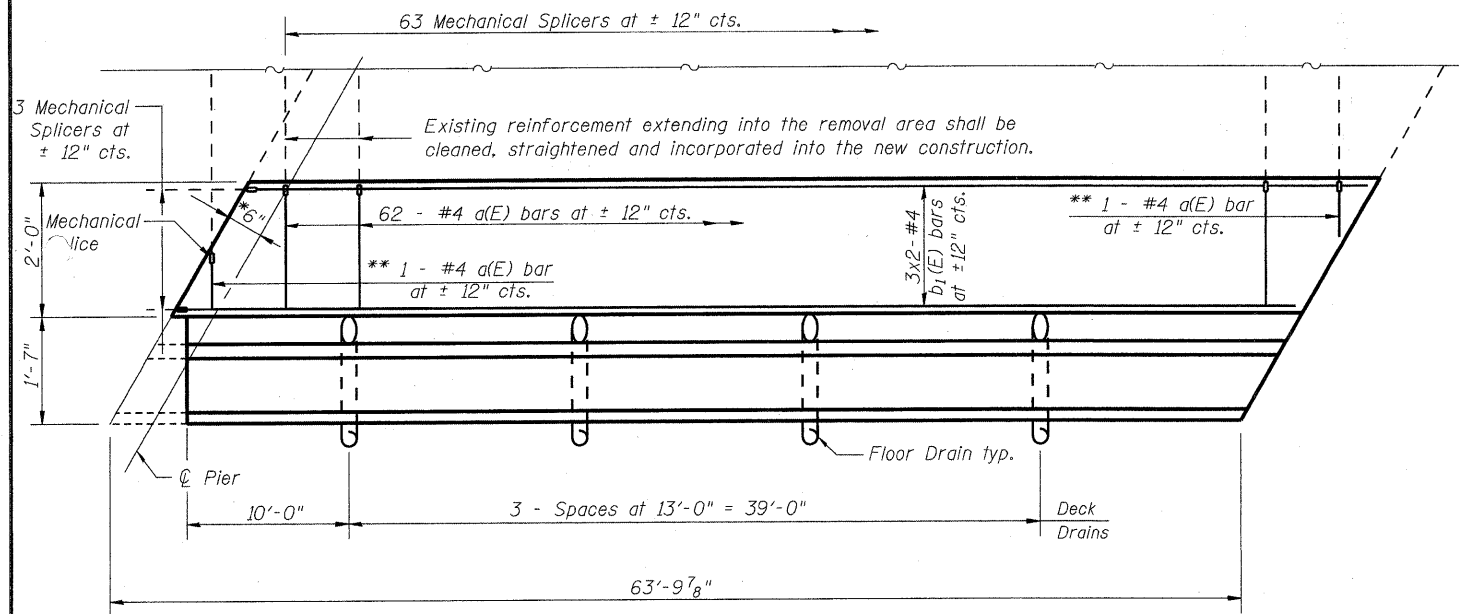

PLAN BEAM 13 - SPAN 2

(Parapet and 5" Concrete Wearing Surface)

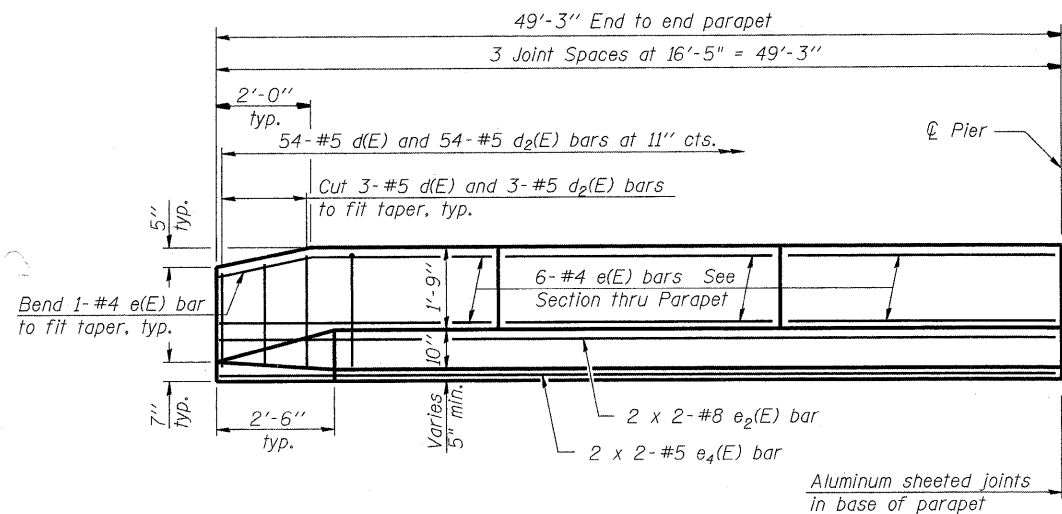

INSIDE ELEVATION OF NORTH PARAPET (SPAN 1)

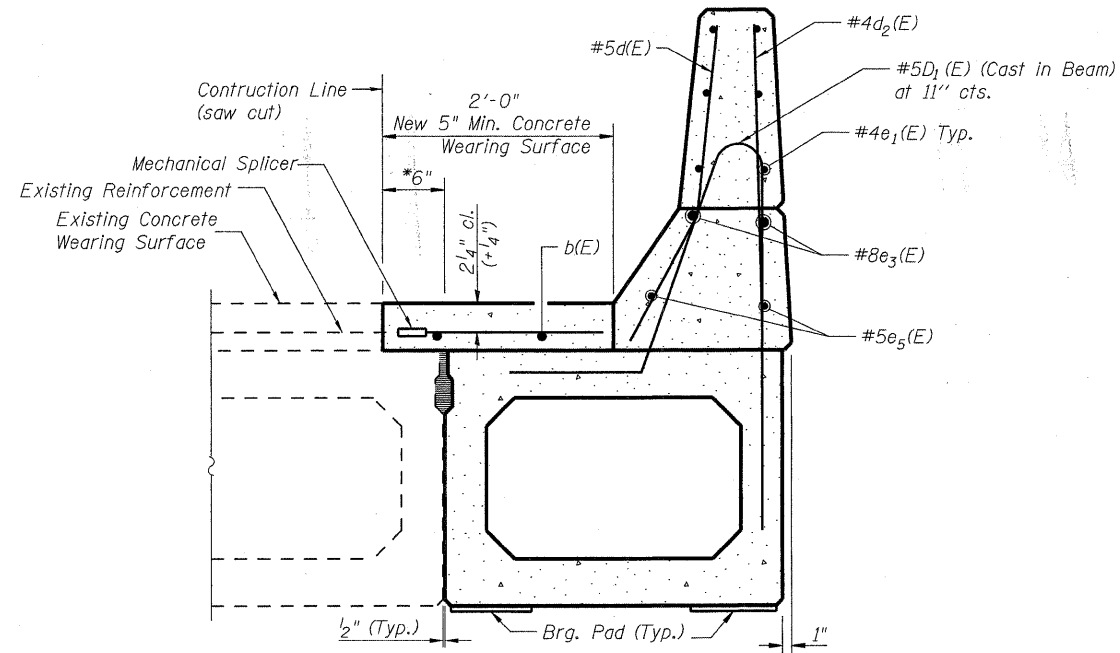

SECTION THRU BEAM 13 & SOUTH PARAPET

MIN. BAR LAP

#4 bar = 1'-4"

* Limits of 5" min. Concrete Wearing Surface Removal. Cost included with Concrete Removal.

** Order a(E) bars full length. Cut to fit skew and use remainder of bars in opposite end.

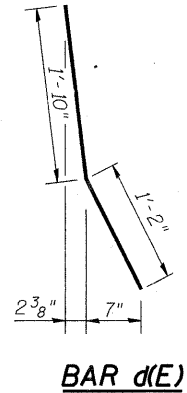

MIN. BAR LAP

#4 bar = 1'-9"
#5 bar = 2'-0"
#8 bar = 4'-0"

SUPERSTRUCTURE BILL OF MATERIAL

Bar	No.	Size	Length	Shape
d(E)	113	#4	2'-2"	—
a ₁ (E)	192	#4	3'-8"	—
a ₂ (E)	4	#4	3'-6"	—
a ₃ (E)	4	#4	1'-8"	—
b(E)	22	#4	25'-6"	—
b ₁ (E)	6	#4	32'-7"	—
d(E)	124	#5	3'-0"	—
d ₂ (E)	124	#4	2'-8"	—
e(E)	18	#4	16'-2"	—
e ₁ (E)	24	#4	15'-7"	—
e ₂ (E)	4	#8	26'-6"	—
e ₃ (E)	4	#8	33'-6"	—
e ₄ (E)	4	#5	25'-6"	—
e ₅ (E)	4	#5	32'-6"	—
Reinforcement Bars, Epoxy Coated	Pound		3,089	
Concrete Superstructure	Cu. Yds.		14.1	
Concrete Wearing Surface, 5"	Sq. Yds.		69.5	
Concrete Removal	Cu. Yds.		15.7	
Mechanical Splicers	Each		333	

Bars indicated thus 1 x 2-#5 etc. indicates 1 line of bars with 2 lengths per line.

SUPERSTRUCTURE DETAILS

Sheet 2 of 2

F.A.P. 17 (US RTE 52 & IL RTE 64)

CARROLL COUNTY

STRUCTURE NO. 008-0030

DESIGNED	- DFM
CHECKED	- RB
DRAWN	- EBS
CHECKED	- DFM