

DATE F.A.U. 2503	SECTION (35)BR-2	COUNTY KENDALL	TOTAL SHEETS 129	SHEET NO. 20
FED. ROAD DIST. NO. 5		SULLY'S FED. AID PROJECT		

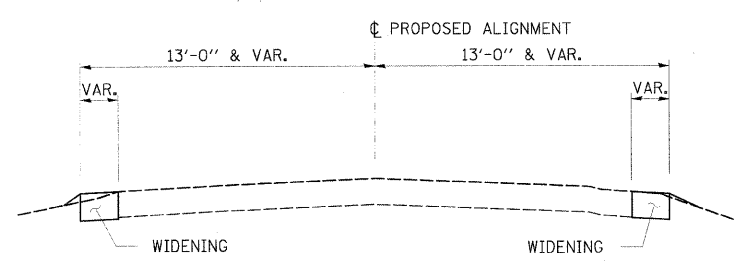
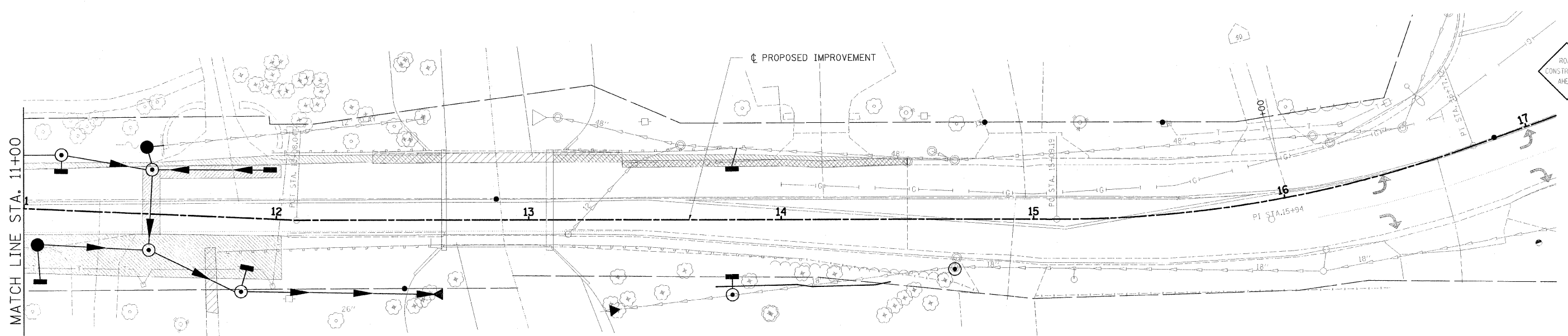
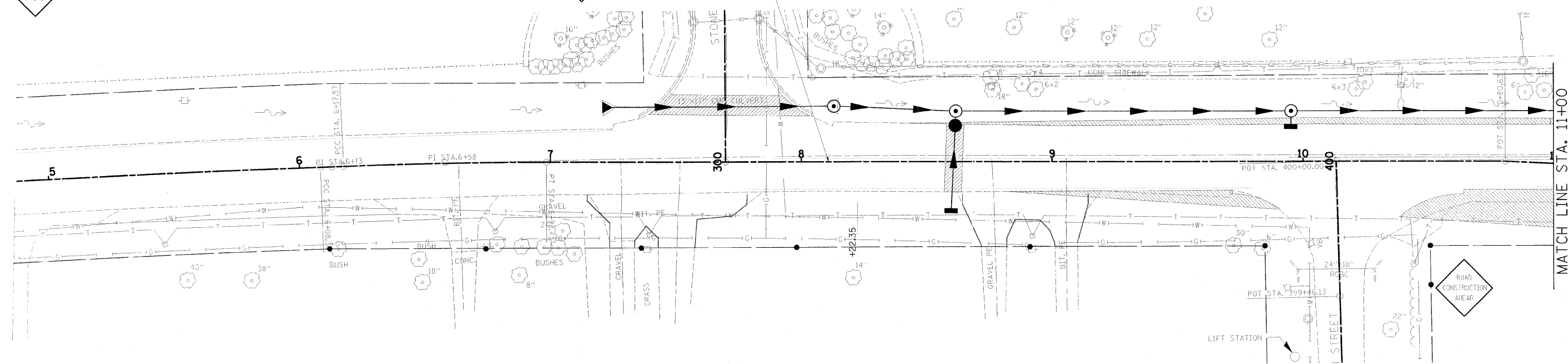
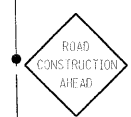

TYPICAL SECTION PRESTAGE 1
STA. 8+22.35 TO STA. 14+50.00

- LEGEND**
- CLASS D PATCH, TYPE III & IV, 12 INCH
 - WIDENING (HMA BASE COURSE, 10")
 - SIDEWALK REMOVAL
 - CONCRETE SIDEWALK REMOVAL AND WIDENING

HAMPTON, LENZINI & RENWICK, INC.
CIVIL & STRUCTURAL ENGINEERS

3085 STEVENSON DRIVE, SUITE 201
SPRINGFIELD, ILLINOIS 62703
(217) 546-3400

ELGIN • SPRINGFIELD

PROJECT NUMBER: 12-08-0029-1 DATE: 08/01/07
DESIGNED: LFS CHECKED: DRAWN: TWK

STAGING PLANS
PRE-STAGE 1
SECTION (35) BR-2
IL 25 OVER WAUBONSEE CREEK
KENDALL COUNTY

PLOT DATE: 11/31/2008; FILE NAME: F:\ALIN\2008\35cad\Phase 1\FAC\12-08-0029-1.dwg; PREPARED BY: LFS