

ROUTE NO. FAU 2503	SECTION (35)BR-2	COUNTY KENDALL	TOTAL SHEETS 129	SHEET NO. 22
FED. ROAD DIST. NO. 5	SUB. PROJ. 5	FED. AID PROJECT		

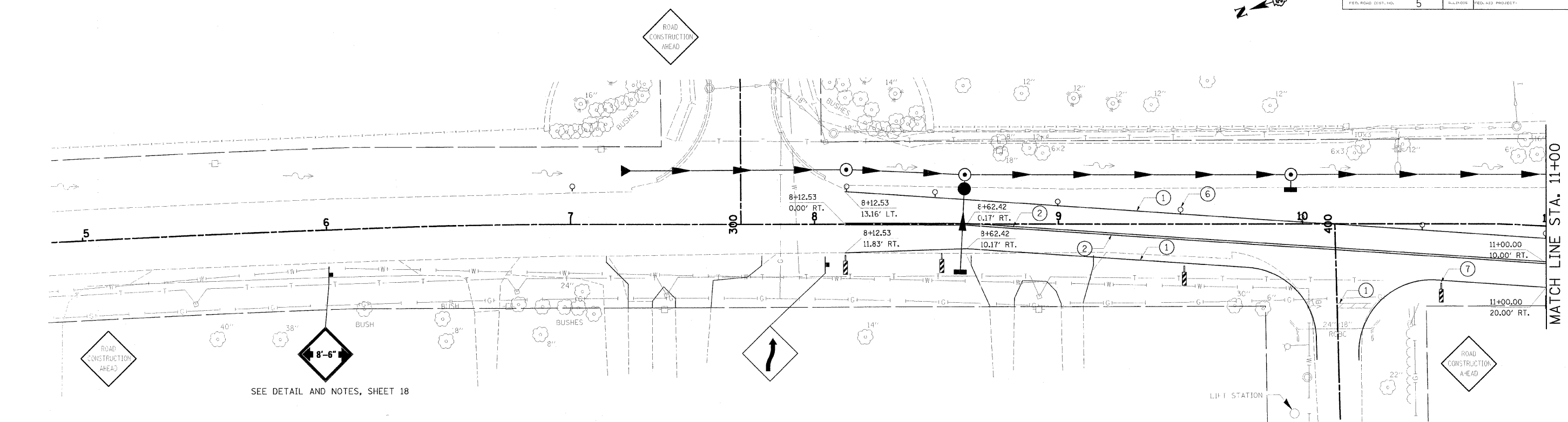

SEE DETAIL AND NOTES, SHEET 18

SEE DETAIL AND NOTES, SHEET 18

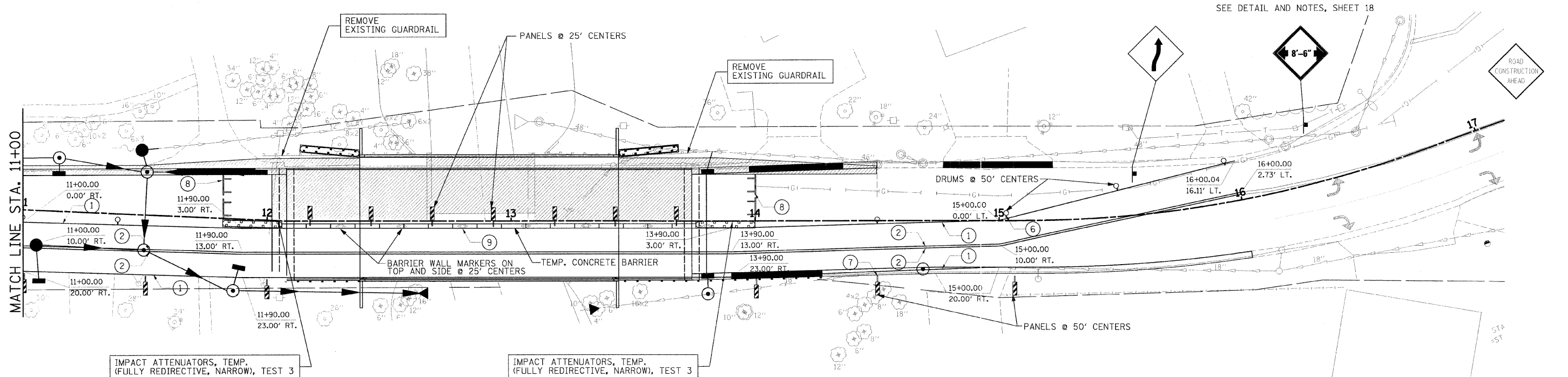

IMPACT ATTENUATORS, TEMP. (FULLY REDIRECTIVE, NARROW), TEST 3

IMPACT ATTENUATORS, TEMP. (FULLY REDIRECTIVE, NARROW), TEST 3

TEMPORARY PAVEMENT MARKING LEGEND

- 1 TEMPORARY PAINT PAVEMENT MARKING LINE 4" (WHITE)
- 2 TEMPORARY PAINT PAVEMENT MARKING LINE 4" (YELLOW)
- 3 TEMPORARY PAINT PAVEMENT MARKING LINE 12" (SOLID WHITE DIAGONAL @ 20' CENTERS)
- 4 TEMPORARY PAINT PAVEMENT MARKING LINE 12" (SOLID YELLOW DIAGONAL @ 20' CENTERS)
- 5 TEMPORARY PAINT PAVEMENT MARKING LINE 24" (WHITE)
- 6 BARRICADE OR DRUM WITH MONODIRECTIONAL STEADY BURNING LIGHT
- 7 VERTICAL PANEL WITH MONODIRECTIONAL STEADY BURNING LIGHT
- 8 TYPE III BARRICADE
- 9 BARRIER WALL MARKER, TYPE C

LEGEND

REMOVAL: BRIDGE / PAVEMENT

HAMPTON, LENZINI & RENWICK, INC.
CIVIL & STRUCTURAL ENGINEERS

3085 STEVENSON DRIVE, SUITE 201
SPRINGFIELD, ILLINOIS 62703
(217) 546-3400

ELGIN • SPRINGFIELD

PROJECT NUMBER: 12-06-0029-1 DATE: 06/01/07
DESIGNED: LFS CHECKED: DRAWN: TWK

STAGING PLANS & TRAFFIC CONTROL
STAGE 2
SECTION (35) BR-2
IL 25 OVER WAUBONSEE CREEK
KENDALL COUNTY

PLN_01 DATE: 11/23/2006 FILE NAME: P:\A\2511\4464\Asst\rd\stage2.dwg