

ROUTE NO. FAU 2503	SECTION (35)BR-2	COUNTY KENDALL	TOTAL SHEETS 129	SHEET NO. 23
FED. ROAD DIST. NO. 5	ILL. HOUS. FED. AID PROJECT			

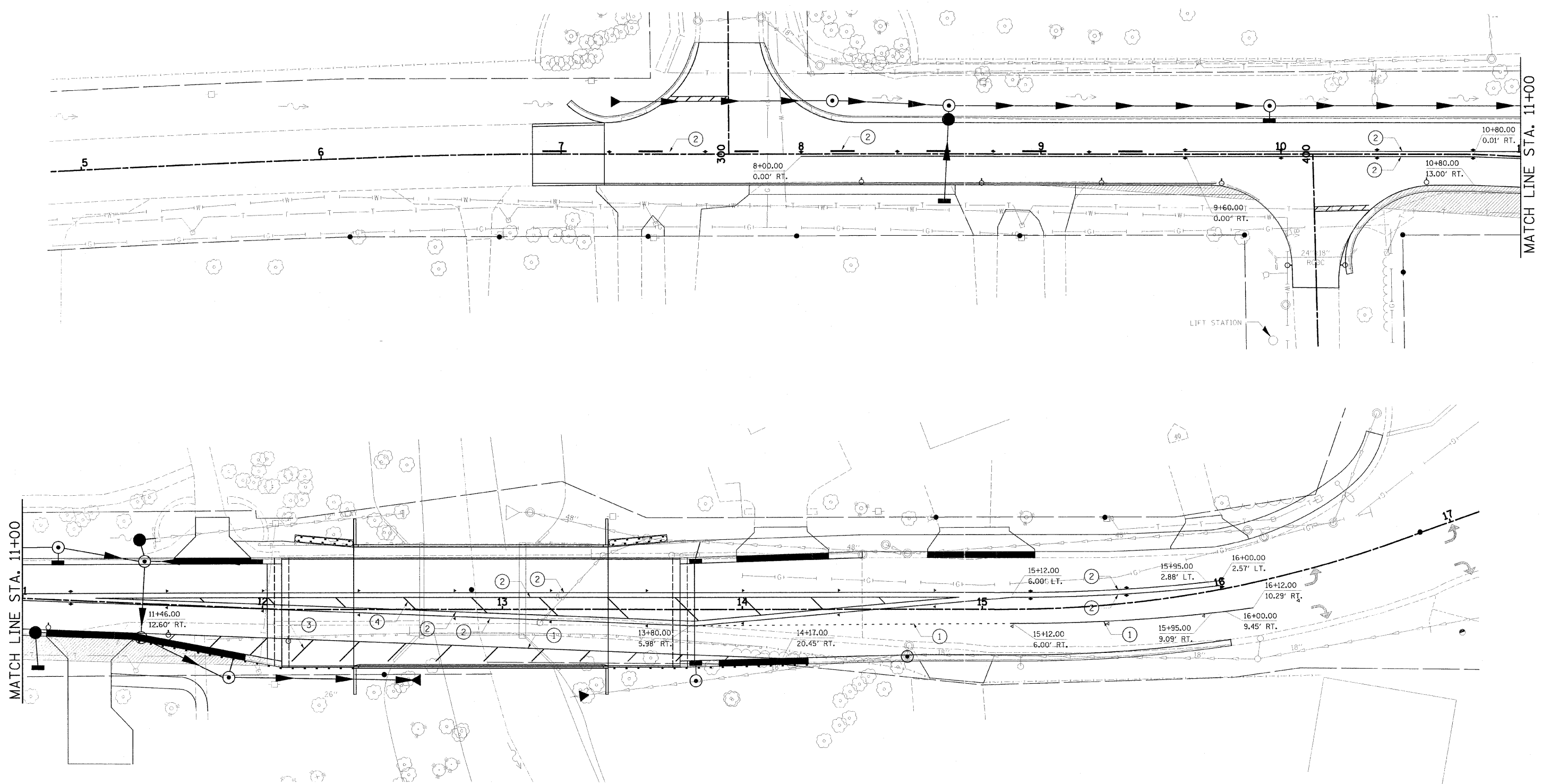

MATCH LINE STA. 11+00

MATCH LINE STA. 11+00

TEMPORARY PAVEMENT MARKING LEGEND

- 1 TEMPORARY PAINT PAVEMENT MARKING LINE 4" (WHITE)
- 2 TEMPORARY PAINT PAVEMENT MARKING LINE 4" (YELLOW)
- 3 TEMPORARY PAINT PAVEMENT MARKING LINE 12" (SOLID WHITE DIAGONAL @ 20' CENTERS)
- 4 TEMPORARY PAINT PAVEMENT MARKING LINE 12" (SOLID YELLOW DIAGONAL @ 20' CENTERS)
- 5 BARRICADE OR DRUM WITH MONODIRECTIONAL STEADY BURNING LIGHTS @ 50' CENTERS
- 6 VERTICAL PANEL @ 50' CENTERS
- 7 TYPE III BARRICADE

LEGEND



HAMPTON, LENZINI & RENWICK, INC.
CIVIL & STRUCTURAL ENGINEERS

HLR

3085 STEVENSON DRIVE, SUITE 201
SPRINGFIELD, ILLINOIS 62703
(217) 546-3400

ELGIN • SPRINGFIELD

PROJECT NUMBER: 12-06-0029-i DATE: 06/01/07
DESIGNED: LFS CHECKED: DRAWN: TWK

STAGING PLANS & TRAFFIC CONTROL

STAGE 3

SECTION (35) BR-2

IL 25 OVER WAUBONSEE CREEK

KENDALL COUNTY