

STATE OF ILLINOIS
DEPARTMENT OF TRANSPORTATION

ROUTE NO.	SECTION	COUNTY	TOTAL SHEETS	SHEET NO.
FAU 2503	(35) BR-2	KENDALL	129	33
FED. ROAD DIST. NO. 7		ILLINOIS	FED. AID PROJECT	
Contract No. 66399				

EAST CURB LINE

Location	Station	Offset	Theoretical Grade Elevations
End of N. Approach Pymt.	12+08.00	-21.00	625.919
A	12+18.00	-21.00	625.968
B	12+28.00	-21.00	626.017
Bk. N. Abutment	12+38.00	-21.00	626.066

EAST EDGE OF PAVEMENT

Location	Station	Offset	Theoretical Grade Elevations
End of N. Approach Pymt.	12+08.00	-13.00	626.079
A	12+18.00	-13.00	626.128
B	12+28.00	-13.00	626.177
Bk. N. Abutment	12+38.00	-13.00	626.226

STAGE CONSTRUCTION LINE

Location	Station	Offset	Theoretical Grade Elevations
End of N. Approach Pymt.	12+08.00	-0.50	626.329
A	12+18.00	-0.50	626.378
B	12+28.00	-0.50	626.427
Bk. N. Abutment	12+38.00	-0.50	626.476

ROADWAY & P.G.

Location	Station	Offset	Theoretical Grade Elevations
End of N. Approach Pymt.	12+08.00	0	626.339
A	12+18.00	0	626.388
B	12+28.00	0	626.437
Bk. N. Abutment	12+38.00	0	626.486

WEST EDGE OF PAVEMENT

Location	Station	Offset	Theoretical Grade Elevations
End of N. Approach Pymt.	12+08.00	13.00	626.079
A	12+18.00	13.00	626.128
B	12+28.00	13.00	626.177
Bk. N. Abutment	12+38.00	13.00	626.226

WEST CURB LINE

Location	Station	Offset	Theoretical Grade Elevations
End of N. Approach Pymt.	12+08.00	23.00	625.879
A	12+18.00	23.00	625.928
B	12+28.00	23.00	625.977
Bk. N. Abutment	12+38.00	23.00	626.026

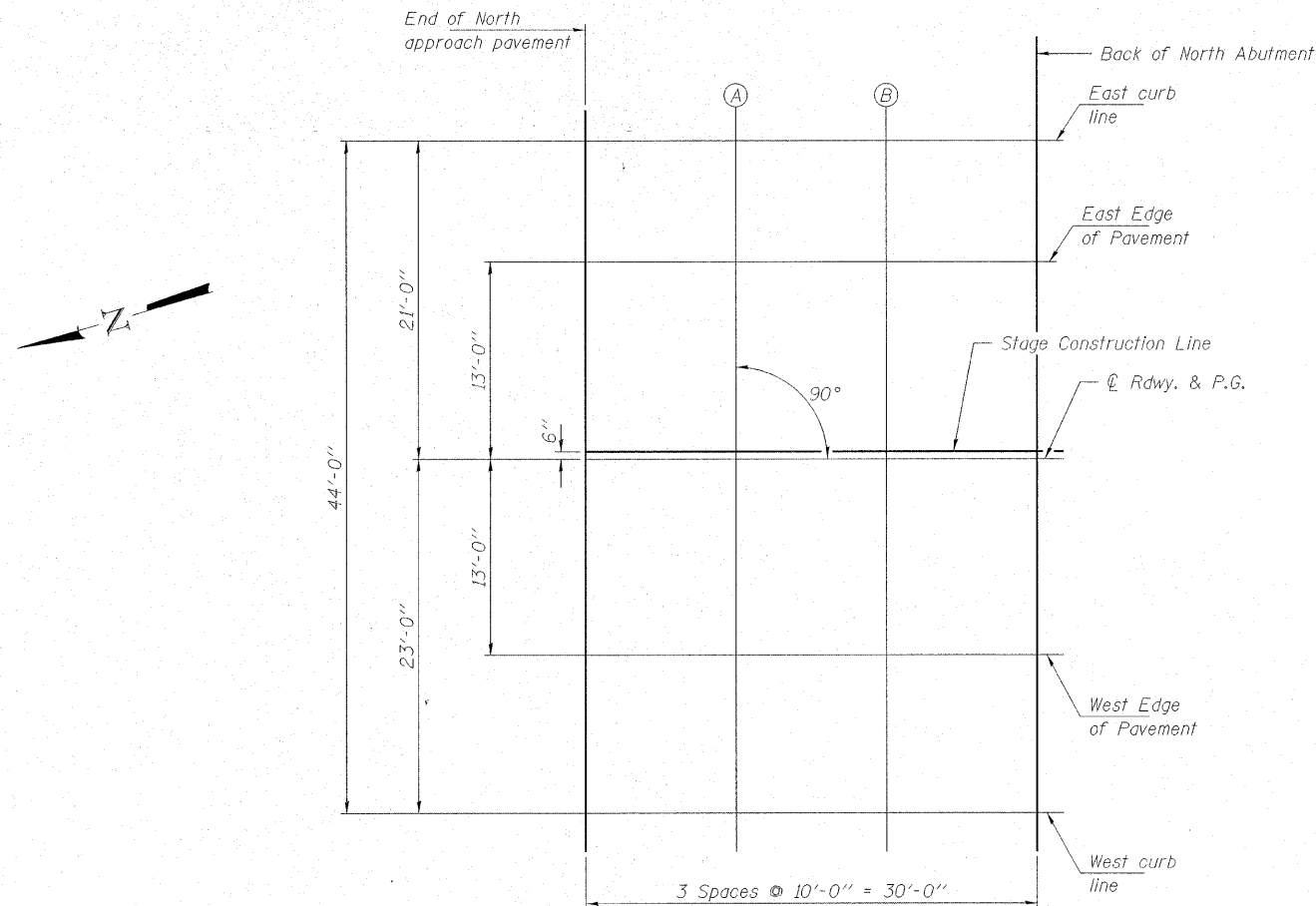

PLAN

HAMPTON, LENZINI & RENWICK, INC.
CIVIL & STRUCTURAL ENGINEERS
LAND SURVEYORS

3085 STEVENSON DRIVE, SUITE 201
SPRINGFIELD, ILLINOIS 62703
(217) 546-3400

ELGIN • SPRINGFIELD

PROJECT NUMBER: 12-06-0029-1 DATE: 01/14/08
DESIGNED: P.S.L. CHECKED: M.D.C. DRAWN: D.A.B.

NORTH APPROACH SLAB ELEVATIONS

IL 25 OVER WAUBONSEE CREEK
F.A.U. ROUTE 2503 / SECTION (35) BR-2
KENDALL COUNTY
STATION 12+91.00
STRUCTURE NO. 047-0062