

STATE OF ILLINOIS
DEPARTMENT OF TRANSPORTATION

ROUTE NO.	SECTION	COUNTY	TOTAL SHEETS	SHEET NO.
FAU 2503	(35) BR-2	KENDALL	129	35
FED. ROAD DIST. NO. 7	ILLINOIS	FED. AID PROJECT		

Contract No. 66399

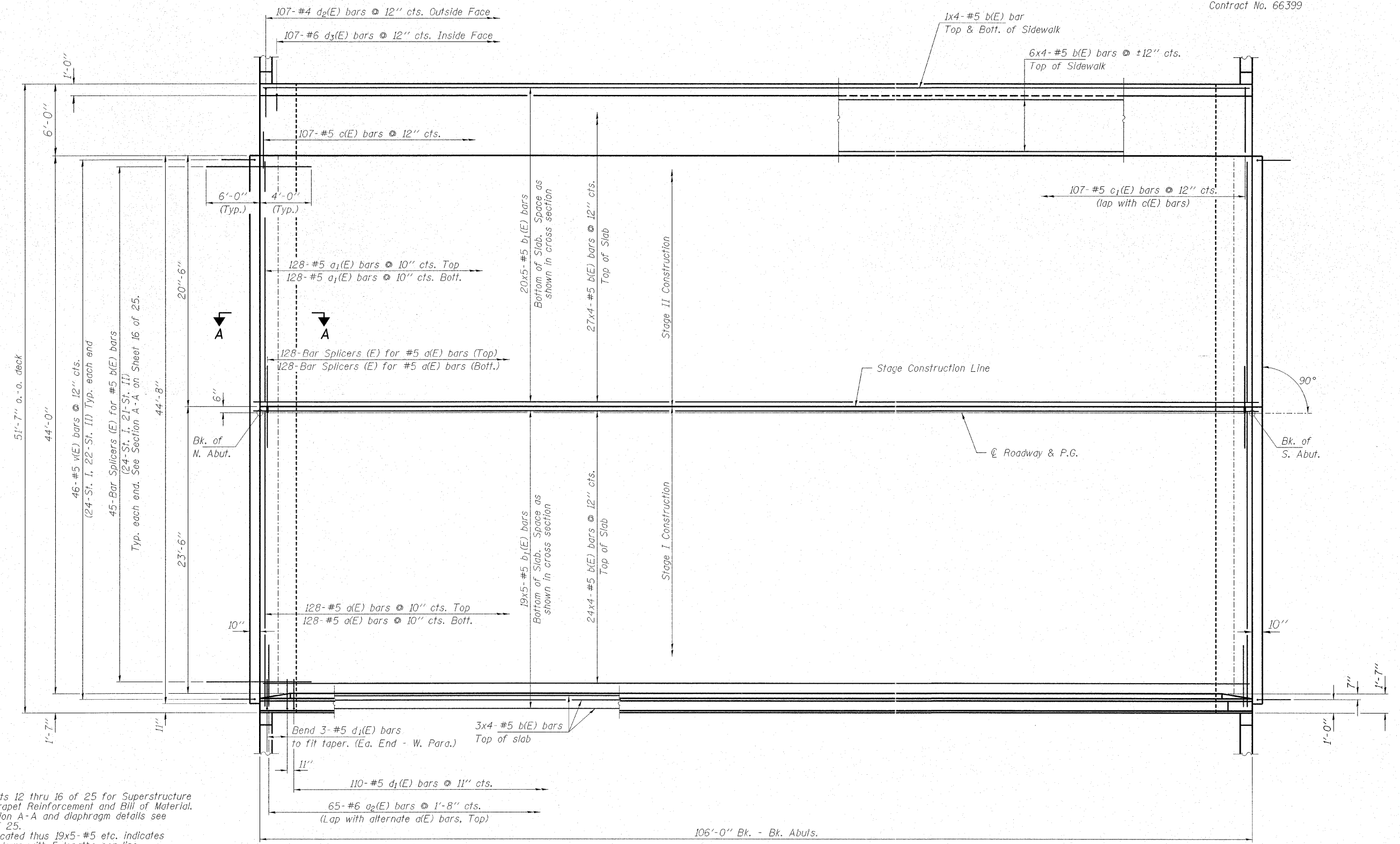

Notes:
See sheets 12 thru 16 of 25 for Superstructure Details, Parapet Reinforcement and Bill of Material. For Section A-A and diaphragm details see sheet 16 of 25.
Bars indicated thus 19x5-#5 etc. indicates 19 lines of bars with 5 lengths per line. See sheet 23 of 25 for bar splicer details.

MIN. BAR LAP
#5 Bar = 1'-8"

PLAN

HAMPTON, LENZINI & RENWICK, INC.
CIVIL & STRUCTURAL ENGINEERS
LAND SURVEYORS

HLR

3085 STEVENSON DRIVE, SUITE 201
SPRINGFIELD, ILLINOIS 62703
(217) 546-3400

ELGIN • SPRINGFIELD

PROJECT NUMBER: 12-06-0029-1	DATE: 01/14/08
DESIGNED: P.S.L.	CHECKED: M.D.C.
DRAWN: D.A.B.	

SUPERSTRUCTURE
IL 25 OVER WAUBONSEE CREEK
F.A.U. ROUTE 2503 / SECTION (35) BR-2
KENDALL COUNTY
STATION 12+91.00
STRUCTURE NO. 047-0062