

FAU	SECTION	COUNTY	TOTAL SHEETS	SHEET NO.
2503	(35)BR-2	KENDALL	129	73
STA. 13+50.00		TO STA. 13+50.00		
FED. ROAD DIST. NO.		ILLINOIS FED. AID PROJECT		
65	70	75	80	

80 75 70 65 60 55 50 45 40 35 30 25 20 15 10 5 0 5 10 15 20 25 30 35 40 45 50 55 60

DATE	BY	DESCRIPTION

DATE	BY	DESCRIPTION

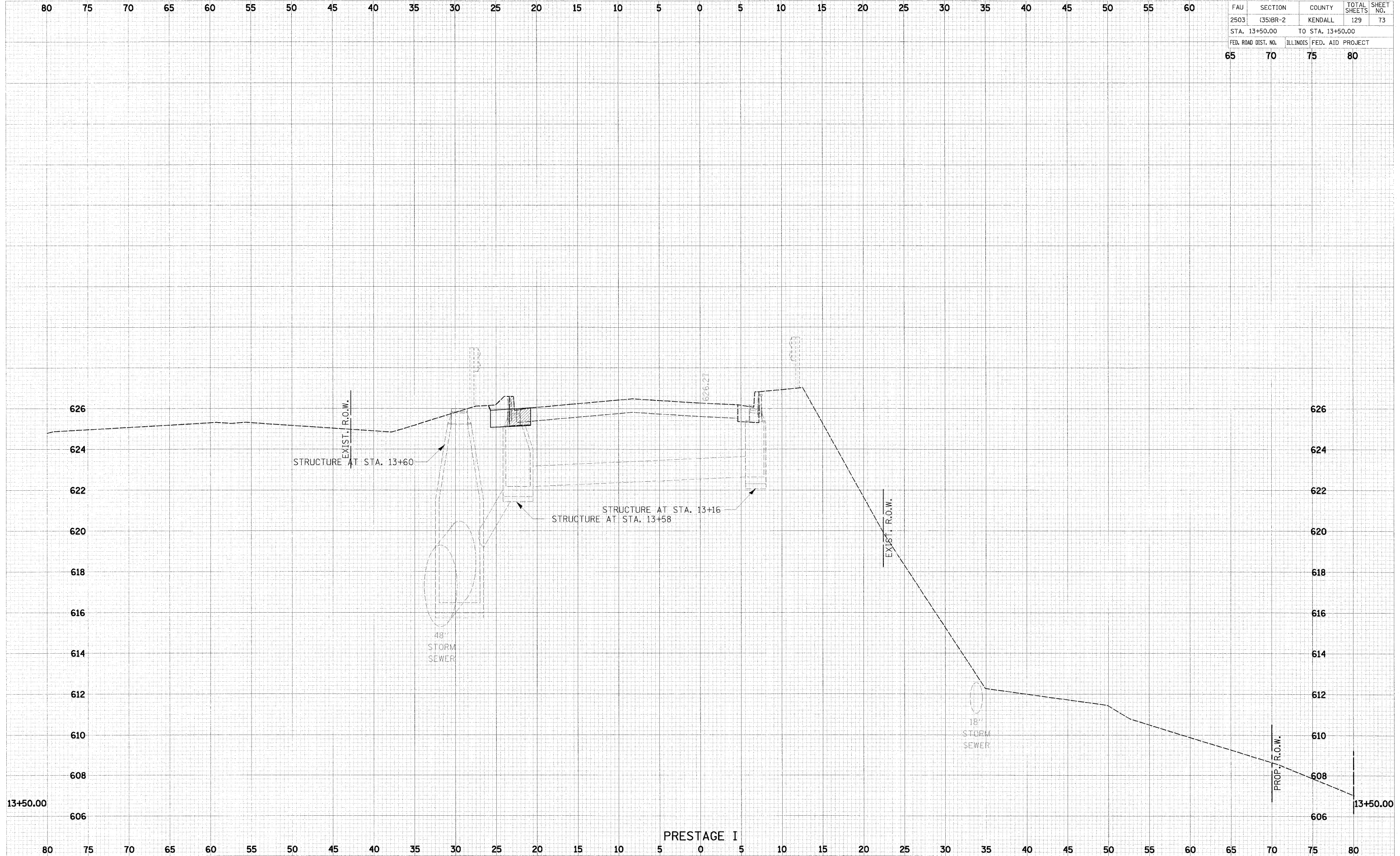

PRESTAGE I