

** EXISTING LONGITUDINAL REINFORCEMENT SHALL BE CUT TO EXTEND INTO REMOVAL AREA TO PROVIDE REQUIRED LAP DISTANCE WITH NEW REINFORCEMENT.
 REQUIRED LAP DISTANCE = 2'-2" MIN.

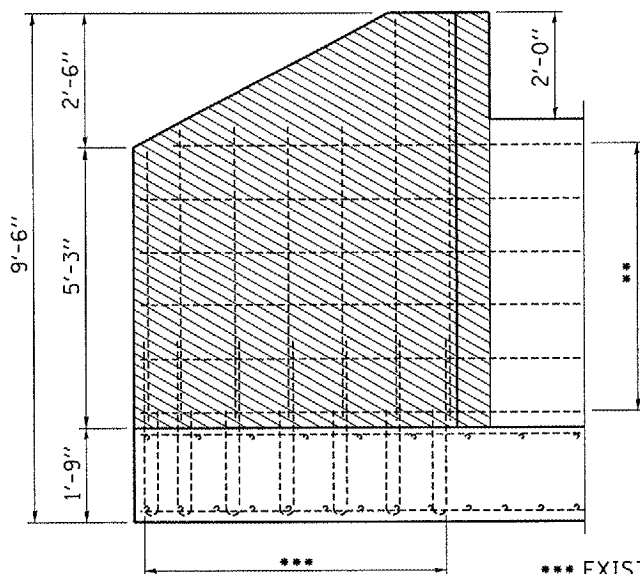

WING ELEVATION

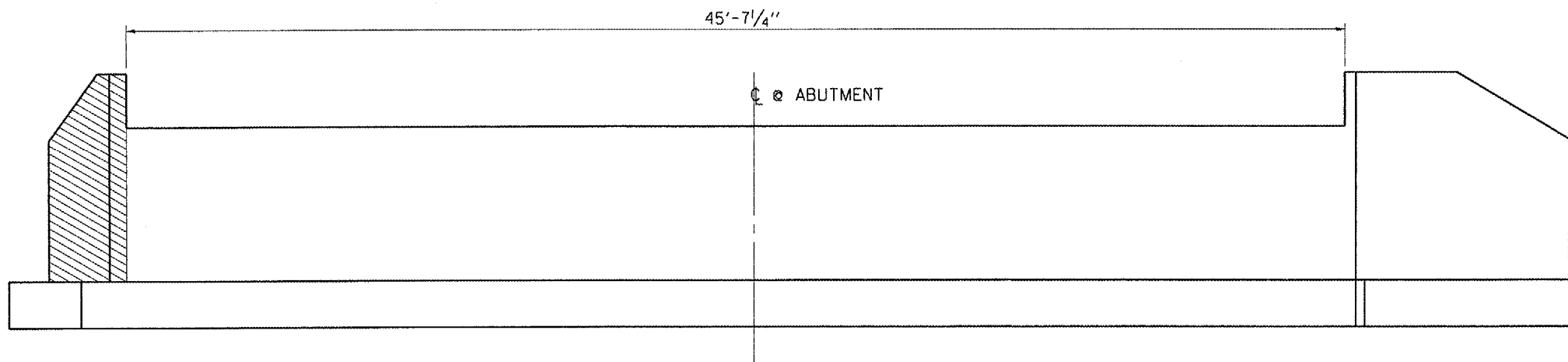

ELEVATION

*** EXISTING VERTICAL REINFORCEMENT EXTENDING INTO REMOVAL AREA SHALL BE CUT OFF FLUSH WITH EXISTING CONCRETE FOOTING.

 CONCRETE REMOVAL LIMITS

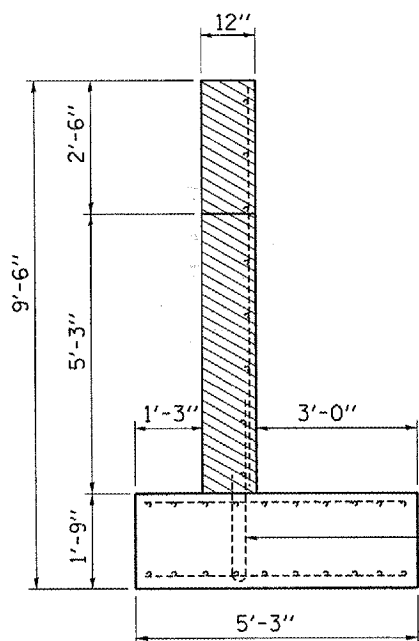

END SECTION

EXISTING REINFORCEMENT TO BE CUT OFF FLUSH WITH EXISTING CONCRETE FOOTING

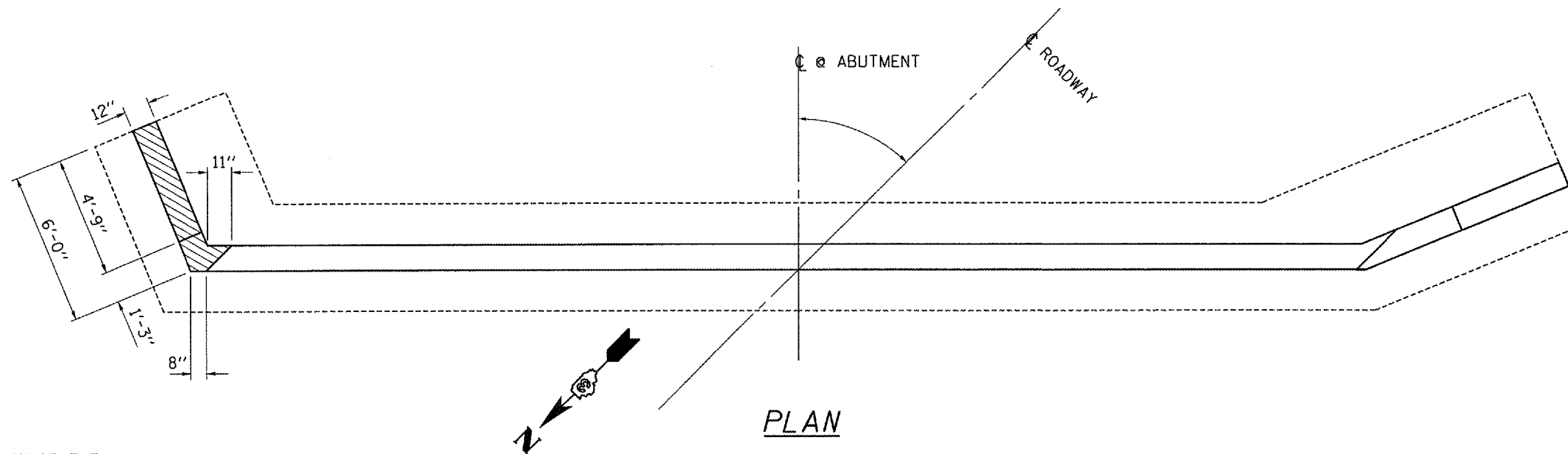

PLAN

BILL OF MATERIAL

Concrete Removal Cu. Yd. 2.4

F.A.P. ROUTE 796 (IL 115)
 SECTION (104-B)
 KANKAKEE COUNTY
 STA. 986+00
 S.N. 046-0066

FILE NAME =	USER NAME = vaninger_jr	DESIGNED -	REVISED -
ca:\projects\mchd07\0460066\0450066.dgn		DRAWN -	REVISED -
	PLOT SCALE = 103.4829 / IN.	CHECKED -	REVISED -
	PLOT DATE = Feb 11, 2008 - 09:24:59 AM	DATE -	REVISED -

STATE OF ILLINOIS
 DEPARTMENT OF TRANSPORTATION

CONCRETE REMOVAL

SCALE: SHEET NO. 3 OF 7 SHEETS STA. TO STA.

F.A.P. RTE.	SECTION	COUNTY	TOTAL SHEETS	SHEET NO.
796	(104B)	KANKAKEE	12	8
CONTRACT NO. 66759				
FED. ROAD DIST. NO. ILLINOIS FED. AID PROJECT				