

F.A.S. RTE.	SECTION	COUNTY	TOTAL SHEETS	SHEET NO.
2244	(107B)BR	STARK	39	1

STATE OF ILLINOIS
DEPARTMENT OF TRANSPORTATION
DIVISION OF HIGHWAYS

**PROPOSED
HIGHWAY PLANS**

FAS ROUTE 2244
SECTION (107B)BR
PROJECT ACRS-2244 (101)
STARK COUNTY
C-94-143-00

D-94-101-00

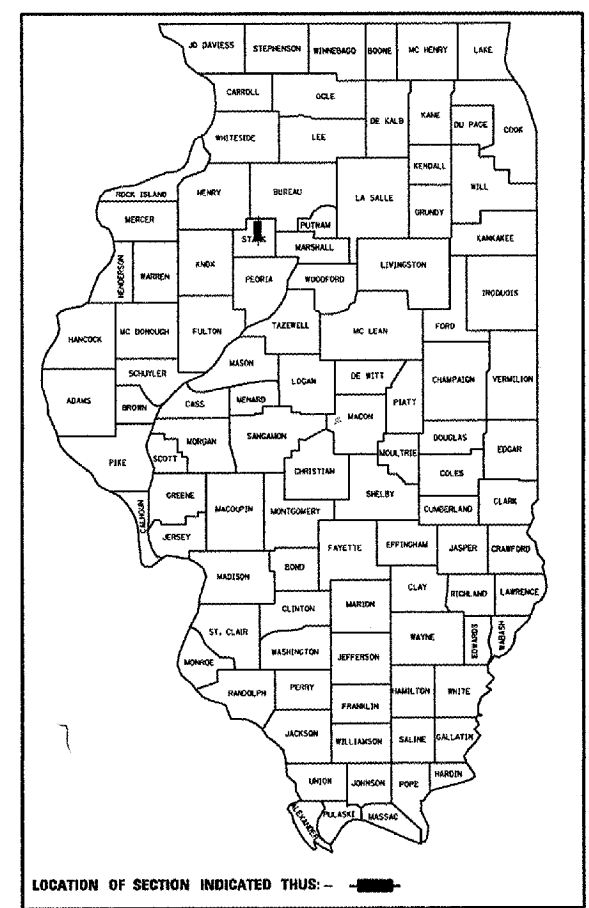

PROJECT ENGINEER: JIM MILLER (309) 671-3451

- INDEX OF SHEETS**
- 1 COVER SHEET
 - 2 GENERAL NOTES, AND COMMITMENTS
 - 3 SUMMARY OF QUANTITIES
 - 4 SCHEDULES
 - 5-6 TYPICAL SECTIONS
 - 7 DETOUR PLAN
 - 8-9 PLAN & PROFILE SHEETS
 - 10 RIGHT OF WAY PLANS
 - 11-12 TYPE B GUTTER (INLET & OUTLET)
 - 13 EROSION CONTROL PLAN
 - 14-23 BRIDGE PLANS
 - 24-31 DISTRICT CADD STANDARD DETAILS
 - 32-39 CROSS SECTIONS

- STANDARDS**
- 280001-04 631032-03 BLR22-5
 - 482001-02 635006-02 406101-D4
 - 515001-02 665001-01 406201-D4
 - 606201-01 666001 406401-D4
 - 630001-07 701901 440001-D4
 - 630301-04 780001-01 630101-D4

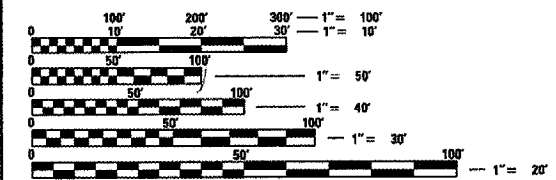
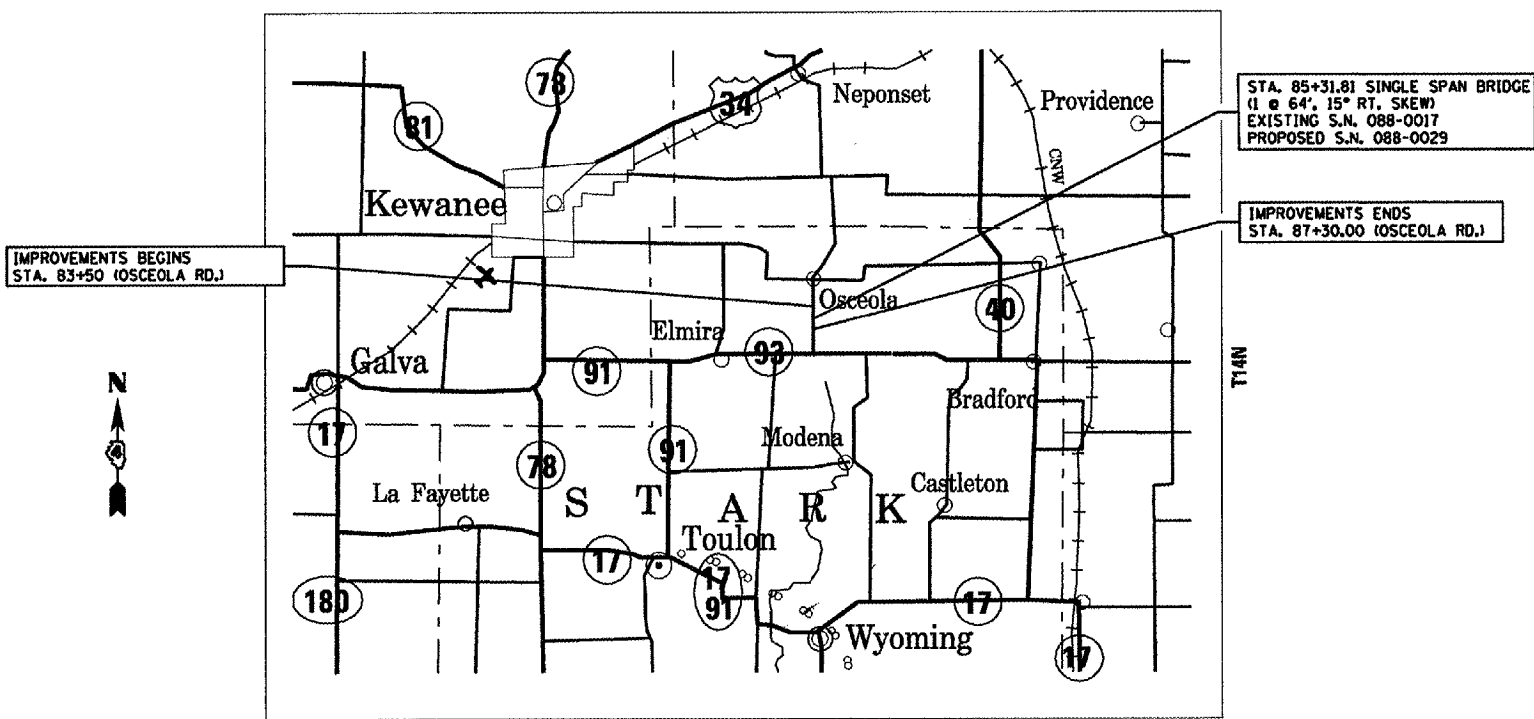

FULL SIZE PLANS HAVE BEEN PREPARED USING STANDARD ENGINEERING SCALES. REDUCED SIZED PLANS WILL NOT CONFORM TO STANDARD SCALES. IN MAKING MEASUREMENTS ON REDUCED PLANS, THE ABOVE SCALES MAY BE USED.

J.U.L.I.E.
JOINT UTILITY LOCATION INFORMATION FOR EXCAVATION
1-800-892-0123

CONTRACT NO. 68115

CLASSIFICATION: MAJOR COLLECTOR (NON-URBAN)
ADT: 275 (2002), 335 (2014)
DESIGN SPEED: 55 MPH
POSTED SPEED: 55 MPH



Prepared By
**7500 NORTH HARKER DRIVE
PEORIA, ILLINOIS 61615
PHONE: (309) 691-5300
FAX: (309) 691-1892
DESIGN FIRM REGISTRATION NO. 184-003283**

JAMES F. SCHMUDE
REGISTERED PROFESSIONAL ENGINEER
ILLINOIS
36931
JAMES F. SCHMUDE, P.E.
IL REG. NO. # 062-036930F
LICENSE EXPIRES 11-30-09

STATE OF ILLINOIS
DEPARTMENT OF TRANSPORTATION
DIVISION OF HIGHWAYS

SUBMITTED **JAN 31, 2008**

[Signature]
DEPUTY DIRECTOR OF HIGHWAYS, REGION ENGINEER

March 21, 2008
[Signature]
ENGINEER OF DESIGN AND ENVIRONMENT

March 21, 2008
[Signature]
DIRECTOR OF HIGHWAYS, CHIEF ENGINEER

**PRINTED BY THE AUTHORITY
OF THE STATE OF ILLINOIS**