

F.A.P. RTE.	SECTION	COUNTY	TOTAL SHEETS	SHEET NO.
310	(39-B)I	McDONOUGH	38	1

STATE OF ILLINOIS
 DEPARTMENT OF TRANSPORTATION
 DIVISION OF HIGHWAYS
**PROPOSED
 HIGHWAY PLANS**

FAP 310 (US 67)
 SECTION (39B)I
 PROJECT BHF-0310 (127)
 McDONOUGH COUNTY
 C-94-024-07

SHEET NO.	INDEX OF SHEETS
1	TITLE SHEET
2	GENERAL NOTES, PROJECT SPECIFIC NOTES AND COMMITMENTS
3-4	SUMMARY OF QUANTITIES
5	TYPICAL SECTIONS
6	SCHEDULE OF QUANTITIES
7	PLAN & PROFILE
8-9	TRAFFIC CONTROL PLAN - STAGING
10-21	STRUCTURE DETAILS
22-34	ROADWAY DETAILS
35-38	CROSS SECTIONS

LIST OF ILLINOIS DOT HIGHWAY STANDARDS

000001-05	701201-02
280001-04	701301-02
353001-04	701311-02
420001-07	701321-09
515001-02	701326-02
630001-07	701901
630301-04	704001-04
631032-03	780001-01
635006-02	781001-02
635011-01	
701001-01	
701006-02	
701011-01	

D-94-021-07

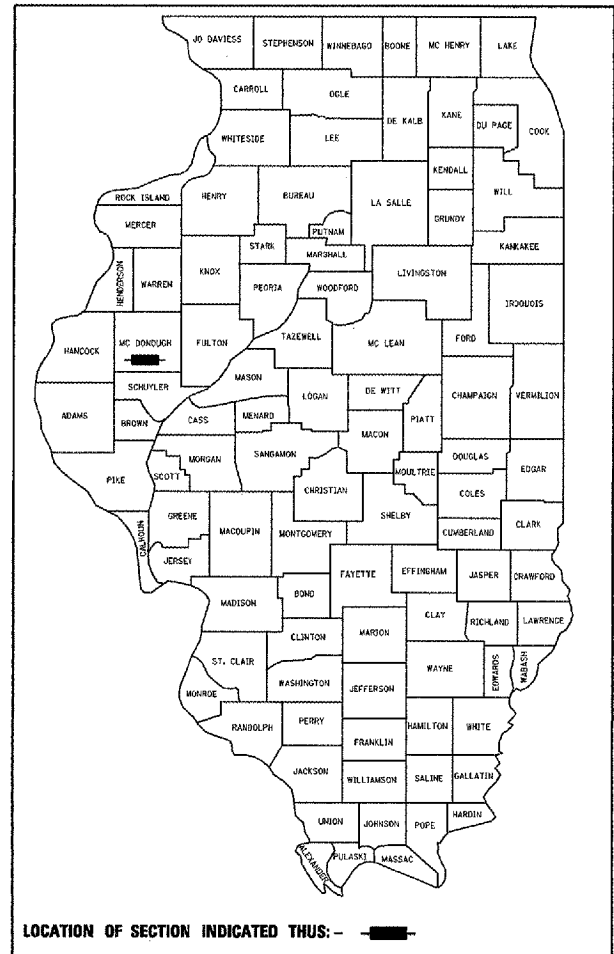

ADT = 2950 (2005); 3803 (2020)
 %SU = 6.8 (2005)
 %MU = 8.5 (2005)
 TOWNSHIP: SCOTLAND
 FUNCTIONAL CLASSIFICATION: 30 OTHER
 PRINCIPLE ARTERIAL

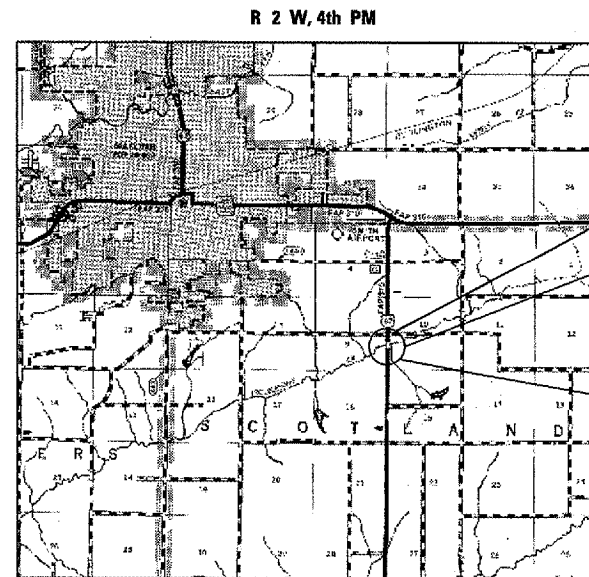

PROPOSED PROJECT BEGINS
 STA. 85 + 20

PROPOSED PRECAST PRESTRESSED
 CONCRETE DECK BEAM SUPERSTRUCTURE
 ON EXISTING DOUBLE SPAN SUBSTRUCTURE
 76'-0" BK-BK ABUTMENTS, 33'-0" CLEAR DECK
 WIDTH WITH STEEL RAILING, TYPE
 SM., 0° SKEW S.N. 055-0005 @ STA. 88 + 17

PROPOSED PROJECT ENDS
 STA. 91 + 40

SUPERSTRUCTURE REPLACEMENT
 OVER TROUBLESOME CREEK

LOCATION MAP

NET LENGTH OF PROJECT = 620 FT. = 0.12 MI.

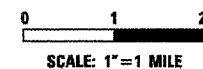

QA/QC CONCRETE



Martin J. Silvester
 01-22-08
 MARTIN SILVESTER, P.E.
 LICENSE EXP. DATE 11-30-09

STATE OF ILLINOIS
 DEPARTMENT OF TRANSPORTATION
 DIVISION OF HIGHWAYS

SUBMITTED JAN 30 20 08

[Signature]
 DEPUTY DIRECTOR OF HIGHWAYS, REGION ENGINEER

March 21 20 08
[Signature]
 ENGINEER OF DESIGN AND ENVIRONMENT

March 21 20 08
[Signature]
 DIRECTOR OF HIGHWAYS, CHIEF ENGINEER

PRINTED BY THE AUTHORITY
 OF THE STATE OF ILLINOIS

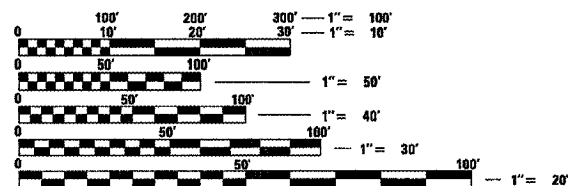

FULL SIZE PLANS HAVE BEEN PREPARED USING STANDARD
 ENGINEERING SCALES. REDUCED SIZED PLANS WILL NOT
 CONFORM TO STANDARD SCALES. IN MAKING MEASUREMENTS
 ON REDUCED PLANS, THE ABOVE SCALES MAY BE USED.

J.U.L.I.E.
 JOINT UTILITY LOCATION INFORMATION FOR EXCAVATION
 1-800-892-0123

CONTRACT NO. 68692