

F.A.P. RTE.	SECTION	COUNTY	TOTAL SHEETS	SHEET NO.
698	1271	WOODFORD	7	1

STATE OF ILLINOIS
DEPARTMENT OF TRANSPORTATION
DIVISION OF HIGHWAYS

PROPOSED HIGHWAY PLANS

FAP 698, ROUTE IL 89
SECTION 1271
PROJECT ACHSIP-0698 (026)
WOODFORD COUNTY
C-94-007-08

FOR INDEX OF SHEETS, SEE SHEET NO. 2

NPDES PERMIT REQUIRED

QC/QA HOT-MIX ASPHALT

LIST OF STANDARDS

- 280001-04
- 701011-01
- 701306-01
- 701311-02
- 701326-02

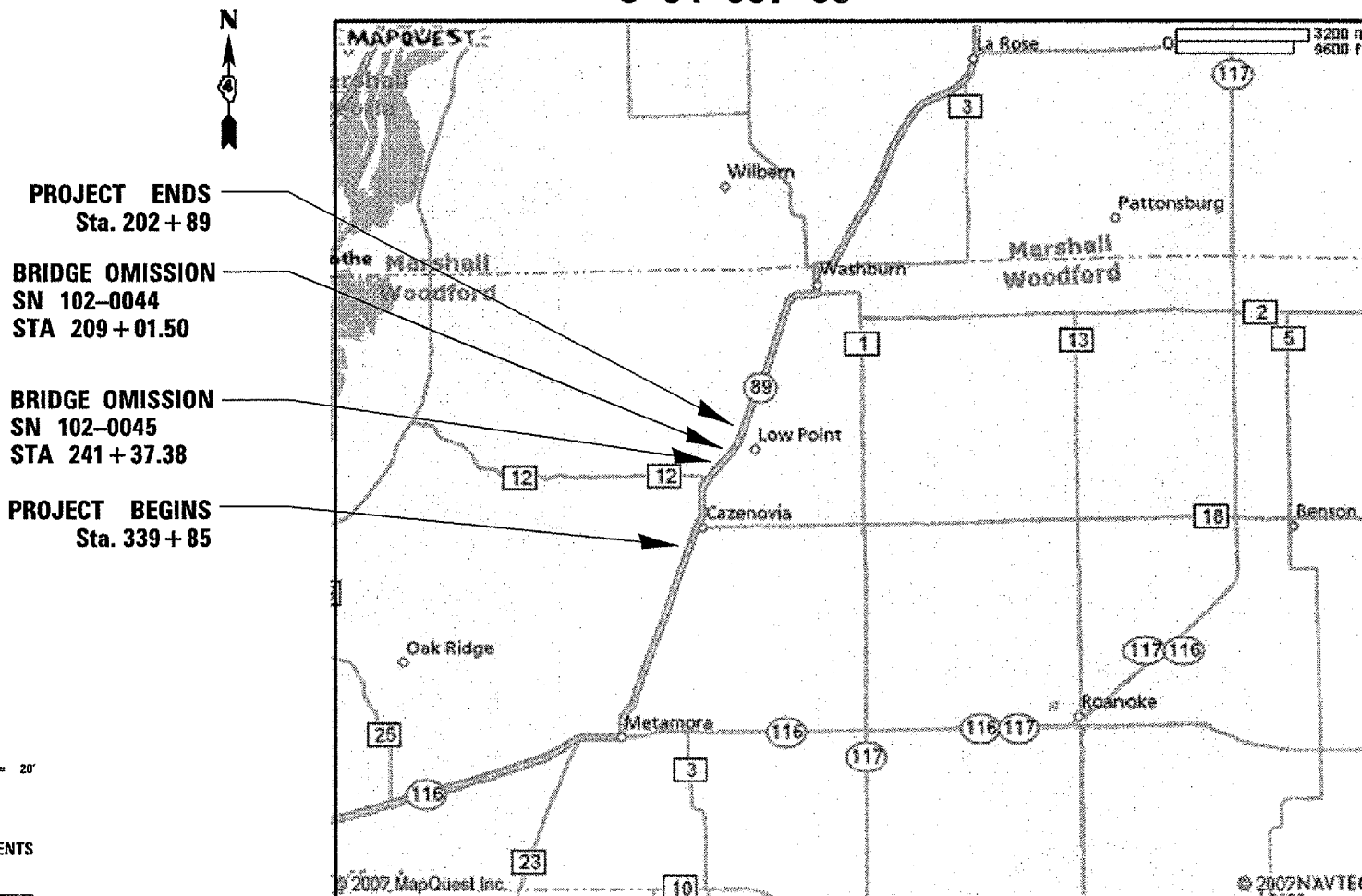
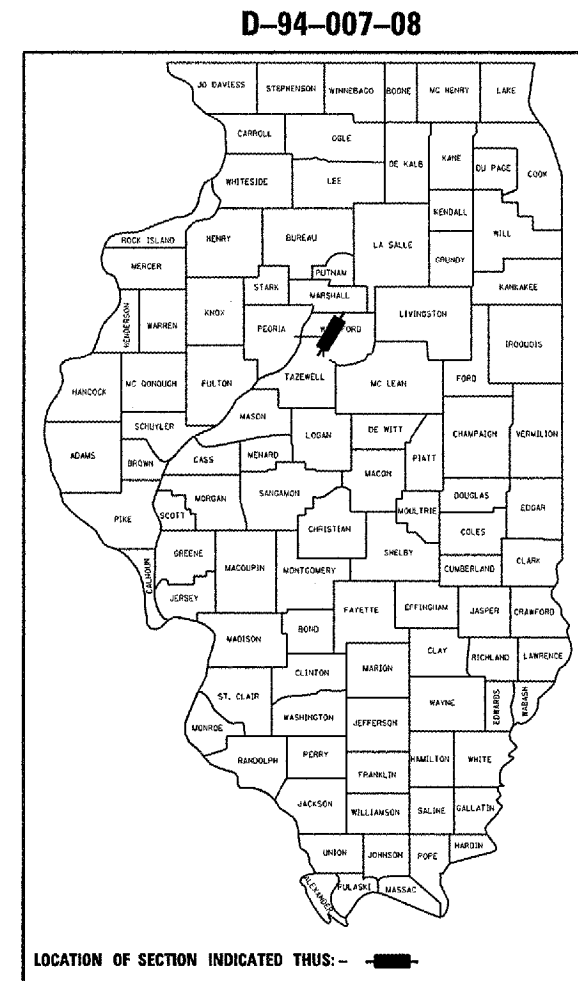

PROJECT ENDS
Sta. 202 + 89

BRIDGE OMISSION
SN 102-0044
STA 209 + 01.50

BRIDGE OMISSION
SN 102-0045
STA 241 + 37.38

PROJECT BEGINS
Sta. 339 + 85

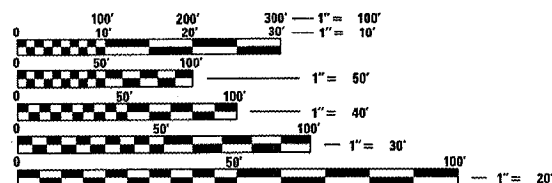

FULL SIZE PLANS HAVE BEEN PREPARED USING STANDARD ENGINEERING SCALES. REDUCED SIZED PLANS WILL NOT CONFORM TO STANDARD SCALES. IN MAKING MEASUREMENTS ON REDUCED PLANS, THE ABOVE SCALES MAY BE USED.

J.U.L.I.E.
JOINT UTILITY LOCATION INFORMATION FOR EXCAVATION
1-800-892-0123

GROSS LENGTH OF THE SECTION = 13,696.00 FT = 2.59 MILES
NET LENGTH OF THE SECTION = 13,696.00 FT = 2.59 MILES

CONTRACT NO. 68770

STATE OF ILLINOIS
DEPARTMENT OF TRANSPORTATION
DIVISION OF HIGHWAYS

SUBMITTED JAN 31 20 08

[Signature]
DEPUTY DIRECTOR OF HIGHWAYS, REGION ENGINEER

March 21 20 08
[Signature]
Eric C. Horn
Interim ENGINEER OF DESIGN AND ENVIRONMENT

March 21 20 08
[Signature]
Christine M. Reed
DIRECTOR OF HIGHWAYS, CHIEF ENGINEER

PRINTED BY THE AUTHORITY
OF THE STATE OF ILLINOIS

Project Engineer: Sean P. Coyle (309) 671-3456

Designer: Michael J. Boyer (309) 671-3457

F.A. RTE.	SECTION	COUNTY	TOTAL SHEETS	SHEET NO.
698	127I	WOODFORD	7	2
STA.		TO STA.		
FED. ROAD DIST. NO.		ILLINOIS FED. AID PROJECT		

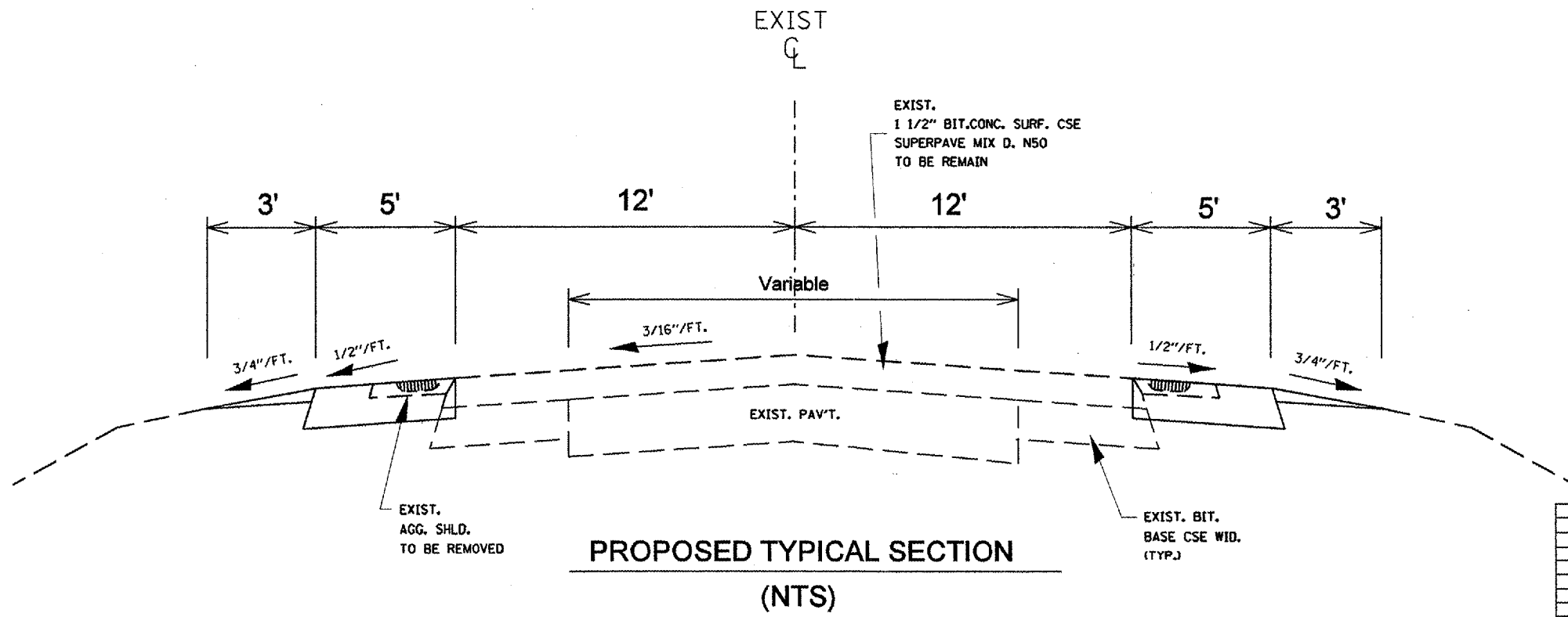
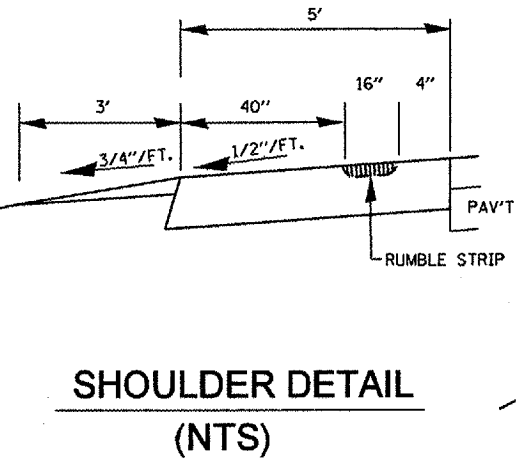
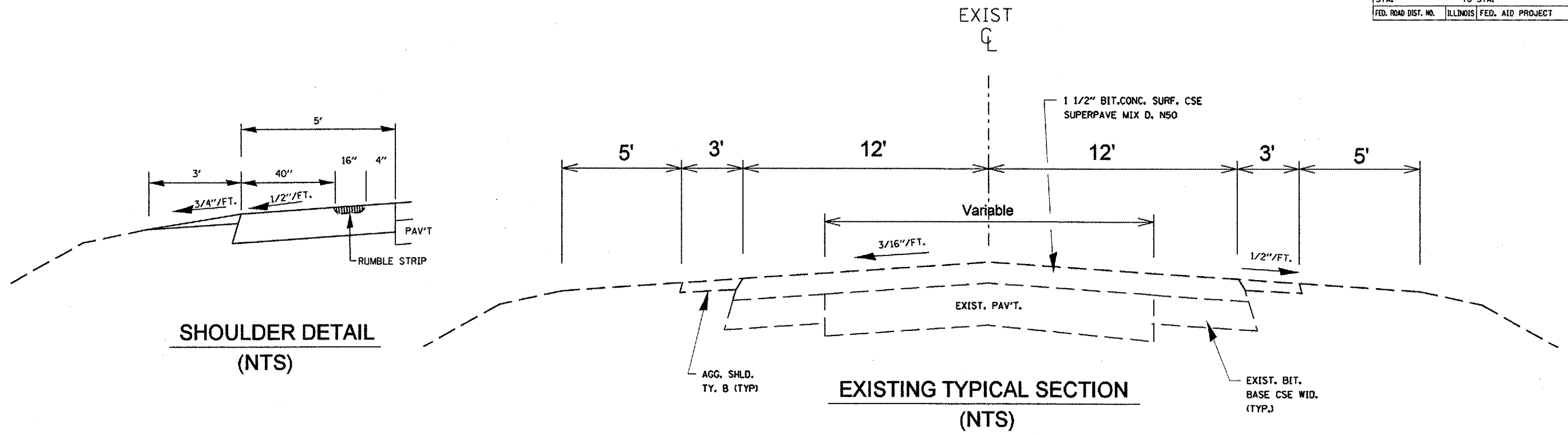

REVISIONS	
NAME	DATE

ILLINOIS DEPARTMENT OF TRANSPORTATION

TYPICAL SECTIONS

SCALE: VERT. DATE
HORIZ. DRAWN BY
CHECKED BY

PLT DATE = 1/21/2009
FILE NAME = S:\GEN\DRY\SYSTEM\PLANS\68770\68770.dgn
PLT SCALE = 1/8"=1' / IN.
USER NAME = boggerm

F.A. RTE.	SECTION	COUNTY	TOTAL SHEETS	SHEET NO.
69B	1271	WOODFORD	7	3
STA.		TO STA.		
FED. ROAD DIST. NO.	ILLINOIS	FED. AID PROJECT		

GENERAL NOTES :

INDEX OF SHEETS

Sheet NO.	Title
1	Cover Sheet
2	Summary of Quantities
3	Sheet index, General Notes, Commitments
4	Typical Sections
5	Line Diagram /SWPPP
6	Standards
7	Details

COMMITMENTS

Commitments are not to be altered without the written approval of all parties to which the commitment was made.

COMMITMENTS:

There are no commitments for this project.

PROPERTY OWNER ACCESS REQUIREMENT

Access must be maintained to all existing properties during construction per Article 107.09 unless arrangements are made in writing by the Contractor with the property owners with a copy to the Engineer for short-term closures.

AGGREGATE SHOULDERS, TYPE B

Aggregate Shoulders, Type B shall be required for all granular construction of side roads, entrances, and mailbox turnouts, whether or not portions of the surfaces thus constructed are to be covered with a bituminous surface, except where noted differently in the plans.

HOT-MIX ASPHALT MIXTURE REQUIREMENTS

Mixture Use(s):	Shoulders (Bottom Lifts)	Shoulders (Surface Lift)
RAP % (MAX)**:	30%	30%
AC/PG:	64-22	64-22
Design Air Voids:	4.0 % @ N = 30	3.0 % @ N = 30
Mixture Coposition:	IL 19.0 L	IL 9.5 L
Friction Aggregate:	N.A.	Mix C

** If the RAP option is selected, the asphalt cement grade may need to be adjusted; this will be determined by the Engineer.

REVISIONS		ILLINOIS DEPARTMENT OF TRANSPORTATION GENERAL NOTES / COMMITMENTS SCALE: VERT. _____ HORIZ. _____ DATE _____	DRAWN BY _____ CHECKED BY _____
NAME	DATE		

F.A.P. RTE.	SECTION	COUNTY	TOTAL SHEETS	SHEET NO.
698	1271	WOODFORD	7	6
STA.		TO STA.		
FED. ROAD DIST. NO.		ILLINOIS FED. AID PROJECT		

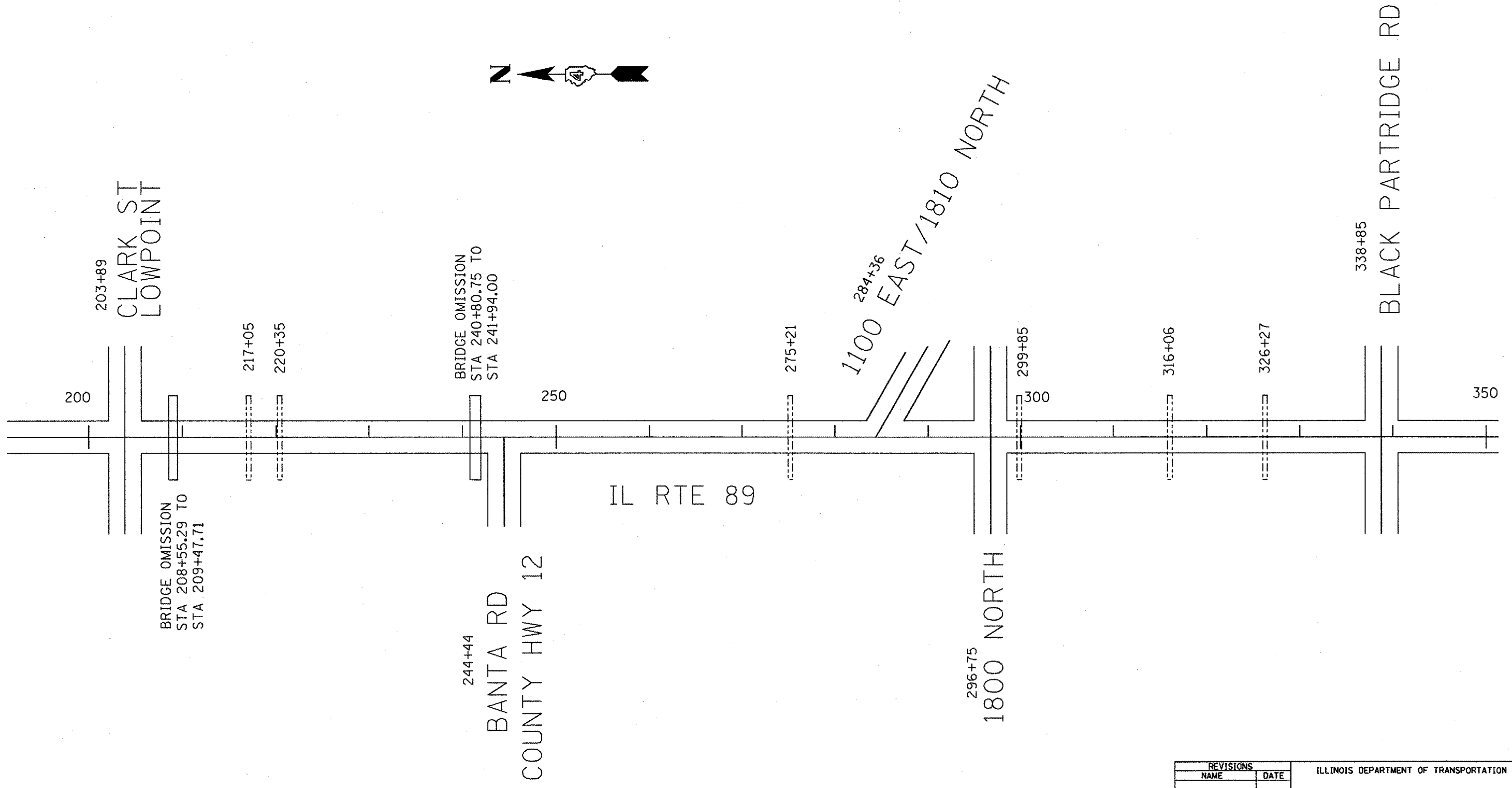
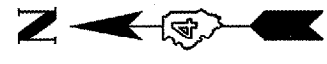

PLOT DATE = 1/21/2009
 FILE NAME = S:\GENERAL\PROJECTS\108\PLUS\SUB\613\68770\68770.dgn
 PLOT SCALE = 1/8" = 100' / IN.
 USER NAME = boymrj

REVISIONS	
NAME	DATE

ILLINOIS DEPARTMENT OF TRANSPORTATION

LINE DIAGRAM / SWPPP

SCALE: VERT. DATE DRAWN BY CHECKED BY

F.A.P. RTE.	SECTION	COUNTY	TOTAL SHEETS	SHEET NO.
698	1271	WOODFORD	7	7
STA.		TO STA.		
FED. ROAD DIST. NO.		ILLINOIS FED. AID PROJECT		

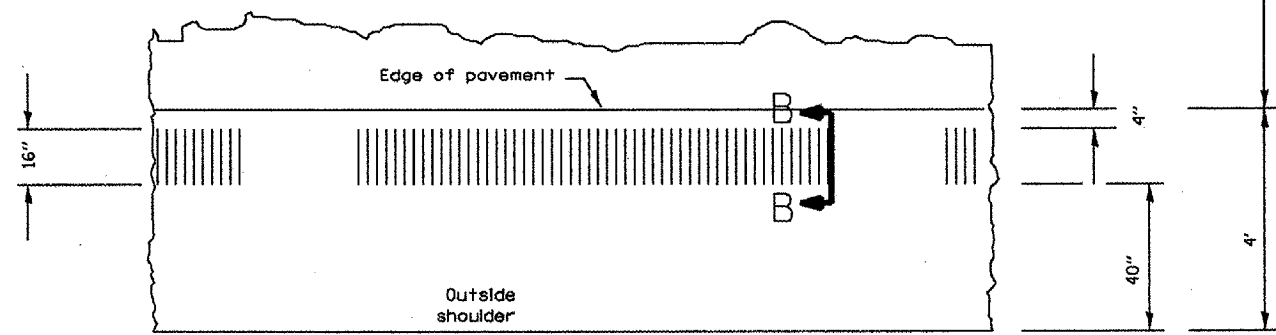
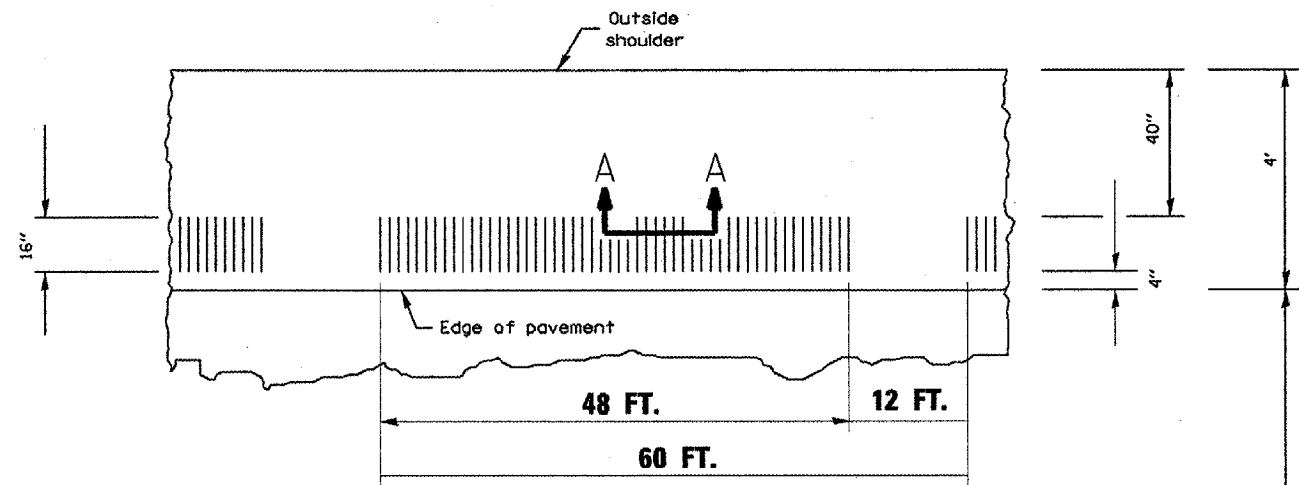

PLAN
INTERMITTENT RUMBLE STRIP
(NTS)

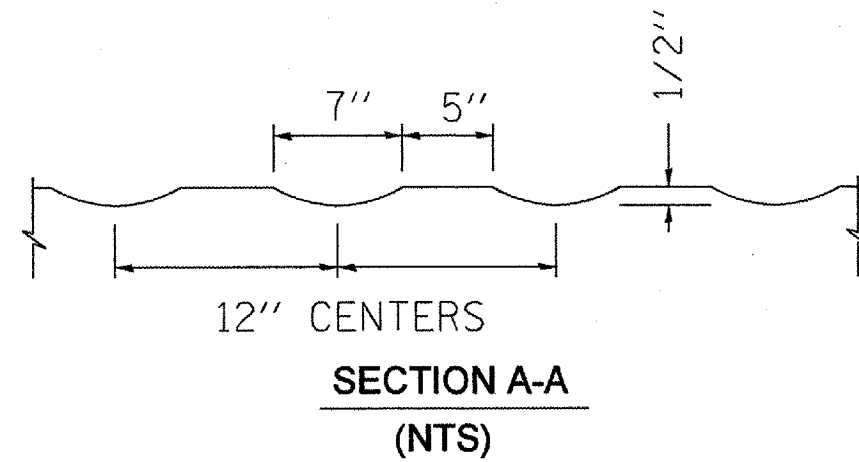

SECTION A-A
(NTS)

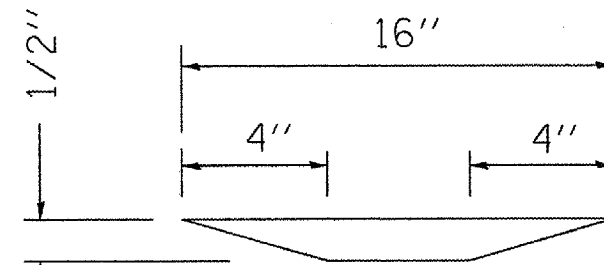

SECTION B-B
(NTS)

DT DATE = 1/31/2008
 C:\WORK\ST108\PLUS\68770\68770.dgn
 DT SCALE = 1/8" = 1' IN.
 DES NAME = boqerou

REVISIONS	
NAME	DATE

ILLINOIS DEPARTMENT OF TRANSPORTATION

INTERMITTENT RUMBLE STRIP

SCALE: VERT. DATE

DRAWN BY CHECKED BY