

PROPOSED CONCRETE MEDIAN SURFACE REMOVAL
TOTAL = 37.27 SQ FT

PROPOSED PCC SIDEWALK, 4" (TOTAL = 33.53 SQ FT) WITH 6" SIDEWALK CURBING AND 3/4" HOT-MIX ASPHALT SURFACE

PROPOSED DETECTABLE WARNINGS (TOTAL = 10.00 SQ FT)

PROPOSED COMBINATION CONCRETE CURB & GUTTER REMOVAL TOTAL = 7.00'

PROPOSED COMBINATION CONCRETE CURB & GUTTER, M-6.24 (DEPRESSED) TOTAL = 7.00'

SOUTHWEST ISLAND DETAIL

PROPOSED CONCRETE MEDIAN SURFACE REMOVAL
TOTAL = 43.58 SQ FT

PROPOSED PCC SIDEWALK, 4" (TOTAL = 36.43 SQ FT) WITH 6" SIDEWALK CURBING AND 3/4" HOT-MIX ASPHALT SURFACE

PROPOSED DETECTABLE WARNINGS (TOTAL = 10.00 SQ FT)

PROPOSED COMBINATION CONCRETE CURB & GUTTER REMOVAL TOTAL = 7.00'

PROPOSED COMBINATION CONCRETE CURB & GUTTER, M-6.24 (DEPRESSED) TOTAL = 7.00'

NORTHWEST ISLAND DETAIL

STATION EQUATION:
P.T. STA. 37+85.06 BACK =
P.O.T. STA. 37+90.25 AHEAD

SEE CONSTRUCTION DETAIL ABOVE

STA 40+34.914 DIRKSEN PARKWAY =
STA 10+00.00 HORIZON DRIVE

FAP 663 (DIRKSEN PARKWAY) 37 38 39 40+00 41 42

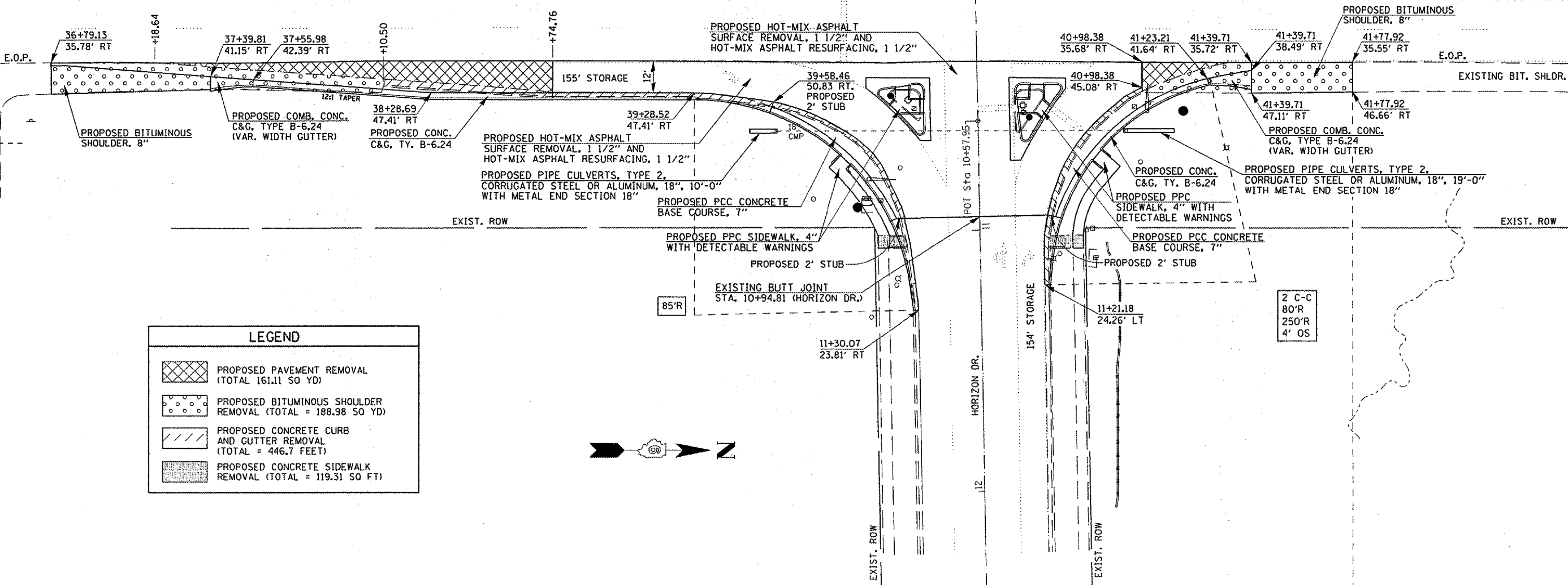

LEGEND

- PROPOSED PAVEMENT REMOVAL (TOTAL 161.11 SQ YD)
- PROPOSED BITUMINOUS SHOULDER REMOVAL (TOTAL = 188.98 SQ YD)
- PROPOSED CONCRETE CURB AND GUTTER REMOVAL (TOTAL = 446.7 FEET)
- PROPOSED CONCRETE SIDEWALK REMOVAL (TOTAL = 119.31 SQ FT)

