

F.A.P. RTE.	SECTION	COUNTY	TOTAL SHEETS	SHEET NO.
592	121-1R, 121HV8	ST. CLAIR	239	51
STA.	TO STA.			
FED. ROAD DIST. NO.	ILLINOIS	FED. AID PROJECT		

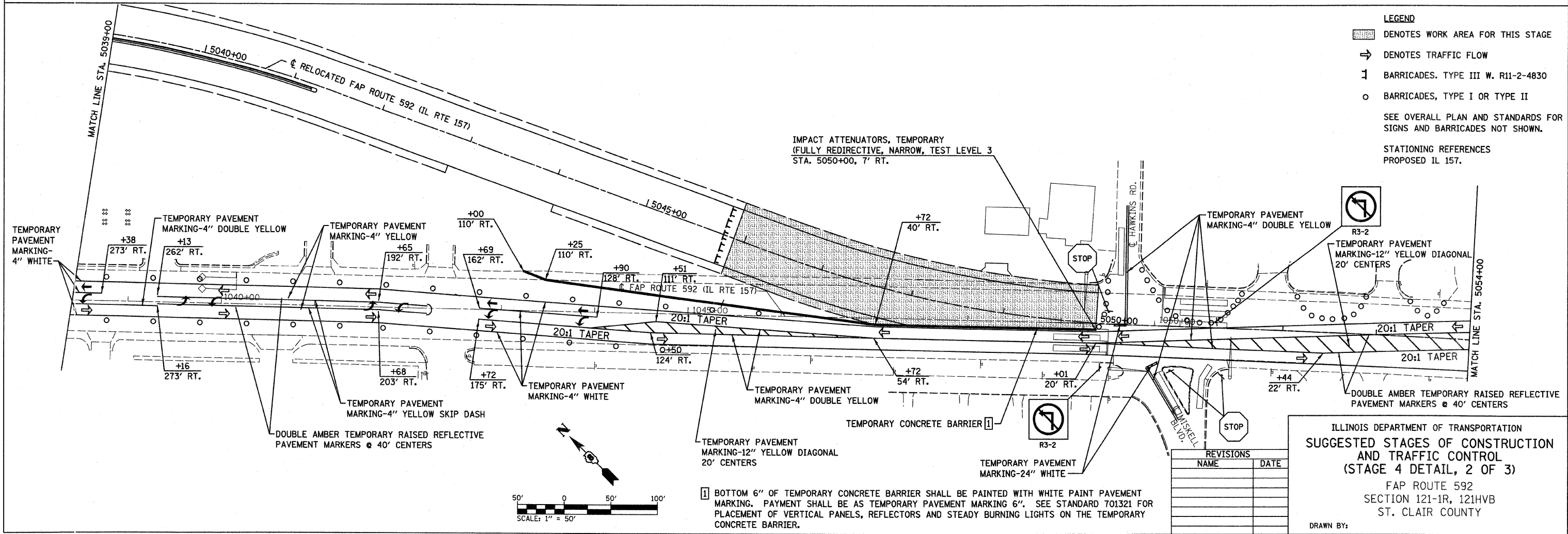
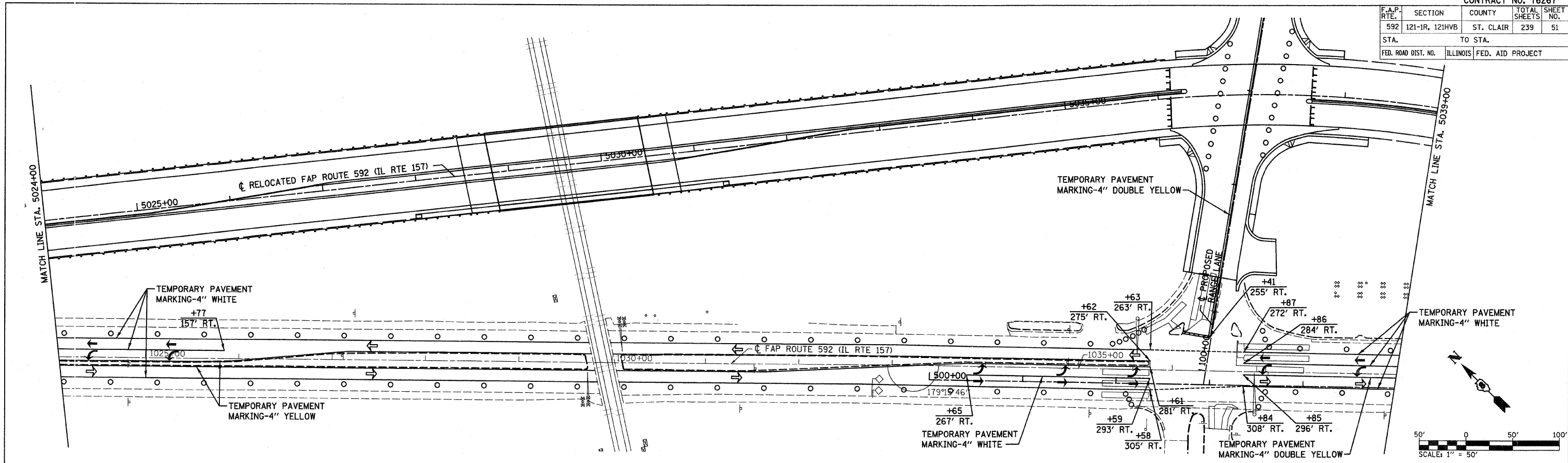

- LEGEND**
- DENOTES WORK AREA FOR THIS STAGE
 - DENOTES TRAFFIC FLOW
 - BARRICADES, TYPE III W. R11-2-4830
 - BARRICADES, TYPE I OR TYPE II
 - SEE OVERALL PLAN AND STANDARDS FOR SIGNS AND BARRICADES NOT SHOWN.
 - STATIONING REFERENCES PROPOSED IL 157.

ILLINOIS DEPARTMENT OF TRANSPORTATION
SUGGESTED STAGES OF CONSTRUCTION AND TRAFFIC CONTROL
 (STAGE 4 DETAIL, 2 OF 3)
 FAP ROUTE 592
 SECTION 121-1R, 121HV8
 ST. CLAIR COUNTY
 DRAWN BY:

REVISIONS	
NAME	DATE

1 BOTTOM 6" OF TEMPORARY CONCRETE BARRIER SHALL BE PAINTED WITH WHITE PAVEMENT MARKING. PAYMENT SHALL BE AS TEMPORARY PAVEMENT MARKING 6". SEE STANDARD 701321 FOR PLACEMENT OF VERTICAL PANELS, REFLECTORS AND STEADY BURNING LIGHTS ON THE TEMPORARY CONCRETE BARRIER.

PLOT DATE = 1/30/2008
 FILE NAME = H:\P\21015\MicroStation\Drawings\2008a.dgn
 PLOT SCALE = 50.0000 / IN
 USER NAME = USER#