

F.A.P. RTE.	SECTION	COUNTY	TOTAL SHEETS	SHEET NO.
304	5BR-2	CALHOUN	68	8
STA.		TO STA.		
FED. ROAD DIST. NO.		ILLINOIS FED. AID PROJECT		

ALL TIES MAG
NAILIN EOP

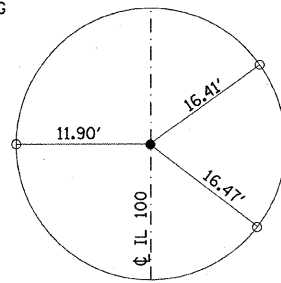

TIE POINT
PT STA 460+04.56
MAG NAIL (SET)

ALL TIES MAG
NAILIN EOP

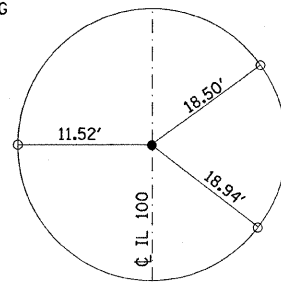

TIE POINT
PT STA 462+20.81
MAG NAIL (SET)



ALL TIES MAG
NAILIN EOP

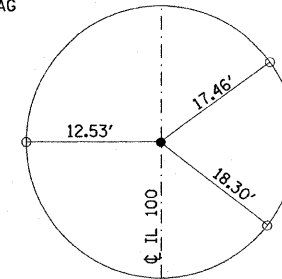

TIE POINT
PT STA 467+16.30
MAG NAIL (SET)

ALL TIES MAG
NAILIN EOP

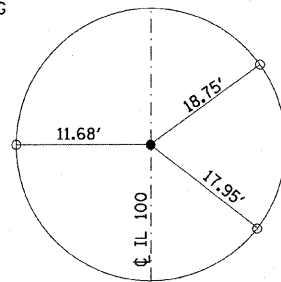

TIE POINT
PT STA 463+25.21
MAG NAIL (SET)

ALL TIES MAG
NAILIN EOP

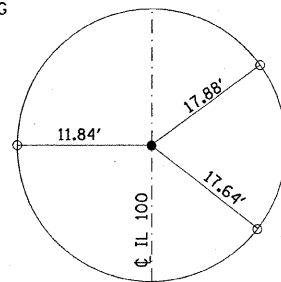

TIE POINT
PT STA 463+66.65
MAG NAIL (SET)

BENCHMARKS

BM 205 - RR SPIKE IN WEST SIDE OF GUY POLE ON EAST SIDE OF
RT 100 @ STA 493+50
ELEVATION = 435.89

BM 206 - CHISELED " " ON TOP OF THE NORTH END OF WEST
CONCRETE BRIDGE CURB FOR RTE 100 BRIDGE (SN
007-0004) OVER CRAWFORD CREEK
ELEVATION = 438.26

NOTE: ALL TIES PULLED DIRECT

REVISIONS	
NAME	DATE

ILLINOIS DEPARTMENT OF TRANSPORTATION
TIES & BENCHMARKS
FAP ROUTE 304
SECTION 5BR-2
CALHOUN COUNTY

SCALE: VERT.
HORIZ.
DATE

DRAWN BY
CHECKED BY