

DATE	
BY	
REVISIONS	
NO.	DESCRIPTION
1	AS NOTED
2	AS NOTED
3	AS NOTED
4	AS NOTED
5	AS NOTED
6	AS NOTED
7	AS NOTED
8	AS NOTED
9	AS NOTED
10	AS NOTED
11	AS NOTED
12	AS NOTED
13	AS NOTED
14	AS NOTED
15	AS NOTED
16	AS NOTED
17	AS NOTED
18	AS NOTED
19	AS NOTED
20	AS NOTED
21	AS NOTED
22	AS NOTED
23	AS NOTED
24	AS NOTED
25	AS NOTED
26	AS NOTED
27	AS NOTED
28	AS NOTED
29	AS NOTED
30	AS NOTED
31	AS NOTED
32	AS NOTED
33	AS NOTED
34	AS NOTED
35	AS NOTED
36	AS NOTED
37	AS NOTED
38	AS NOTED
39	AS NOTED
40	AS NOTED
41	AS NOTED
42	AS NOTED
43	AS NOTED
44	AS NOTED
45	AS NOTED
46	AS NOTED
47	AS NOTED
48	AS NOTED
49	AS NOTED
50	AS NOTED

DATE	
BY	
REVISIONS	
NO.	DESCRIPTION
1	AS NOTED
2	AS NOTED
3	AS NOTED
4	AS NOTED
5	AS NOTED
6	AS NOTED
7	AS NOTED
8	AS NOTED
9	AS NOTED
10	AS NOTED
11	AS NOTED
12	AS NOTED
13	AS NOTED
14	AS NOTED
15	AS NOTED
16	AS NOTED
17	AS NOTED
18	AS NOTED
19	AS NOTED
20	AS NOTED
21	AS NOTED
22	AS NOTED
23	AS NOTED
24	AS NOTED
25	AS NOTED
26	AS NOTED
27	AS NOTED
28	AS NOTED
29	AS NOTED
30	AS NOTED
31	AS NOTED
32	AS NOTED
33	AS NOTED
34	AS NOTED
35	AS NOTED
36	AS NOTED
37	AS NOTED
38	AS NOTED
39	AS NOTED
40	AS NOTED
41	AS NOTED
42	AS NOTED
43	AS NOTED
44	AS NOTED
45	AS NOTED
46	AS NOTED
47	AS NOTED
48	AS NOTED
49	AS NOTED
50	AS NOTED

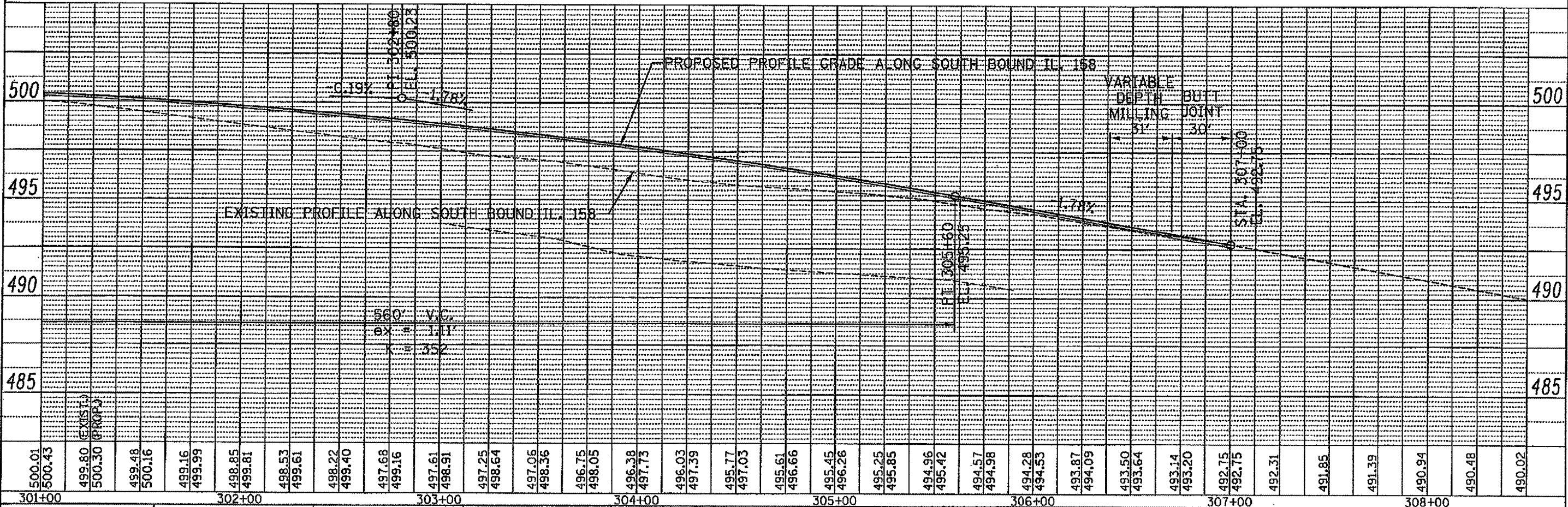
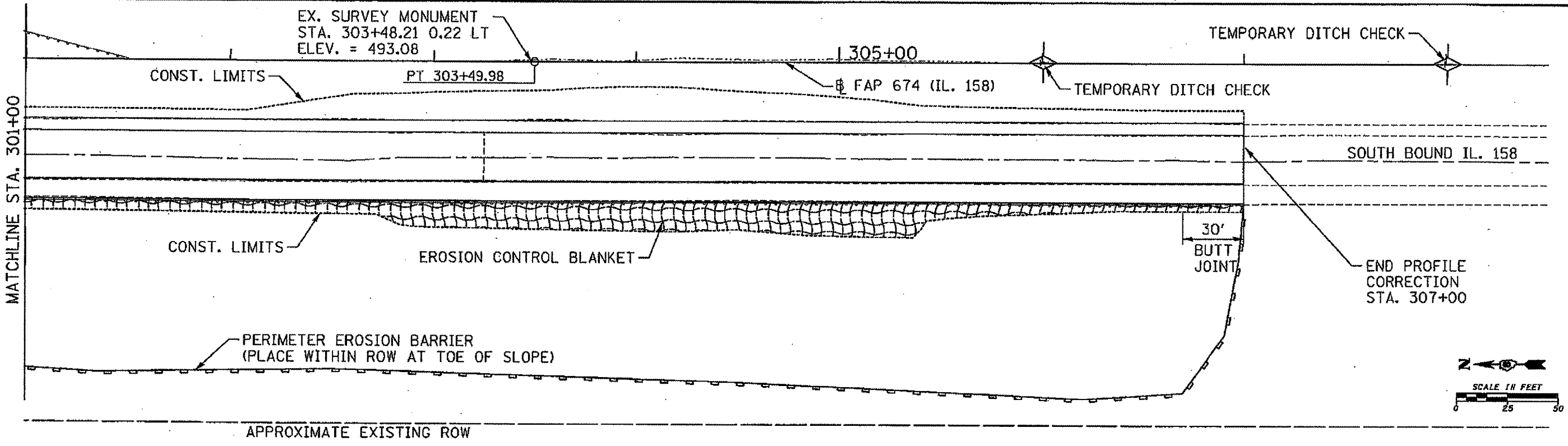

FILE NAME = c28_pp03_sb11188.dgn	USER NAME = ljackson	DESIGNED - DHP	REVISED - 03/12/08	STATE OF ILLINOIS DEPARTMENT OF TRANSPORTATION	PLAN & PROFILE IL. 158 SOUTH BOUND	F.A.P. RITE	SECTION	COUNTY	TOTAL SHEETS	SHEET NO.	
		DRAWN - EDW	REVISED -			674	410, 410-1-1	ST. CLAIR	41	20	
		CHECKED - SAR	REVISED -			SCALE: SHEET NO. OF SHEETS STA. TO STA.		FED. ROAD DIST. NO. ILLINOIS FED. AID PROJECT			
		DATE - 01/30/08	REVISED -			CONTRACT NO. 76614					